

FAP NO.	SECTION	COUNTY	TOTAL SHEETS	SHEET NO.
693	(119B-3)I	TAZEWELL	34	5
STA.	TO STA.			

EXISTING CONDITIONS:
CONTRACT NO. 68415

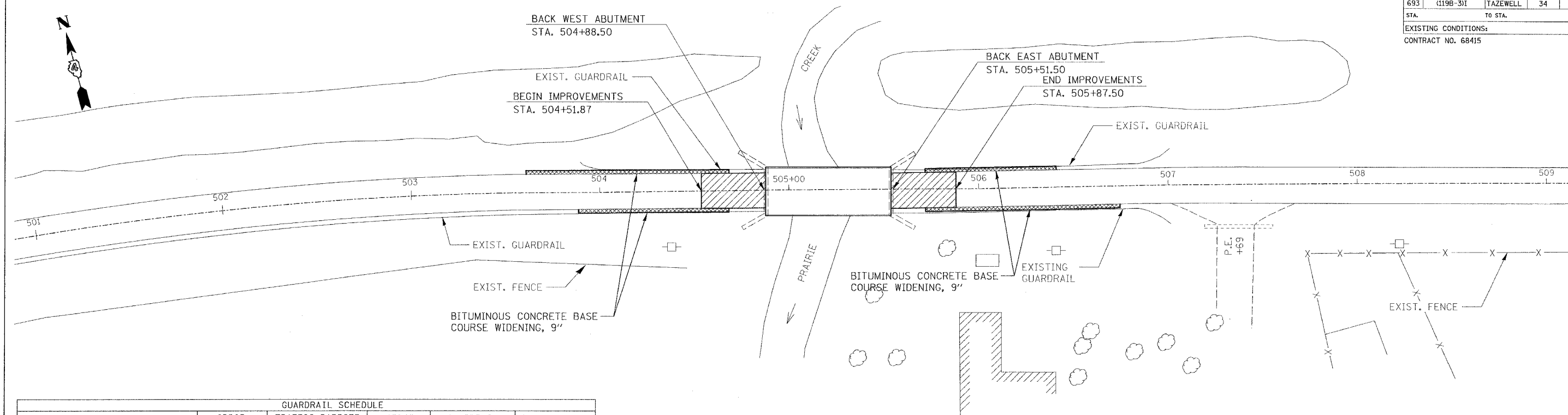

GENERAL SITE PLAN

GUARDRAIL SCHEDULE					
STATION TO STATION	SPBGR TYPE A (FOOT)	TRAFFIC BARRIER TERMINAL, TYPE 6A (EACH)	SPBGR REMOVAL (FOOT)	GUARDRAIL MARKERS T-A (EACH)	BARRIER WALL MARKER T-A (EACH)
504+37.25 LT. TO 504+68.50 LT.			31.25		
504+37.25 RT. TO 504+68.50 RT.			31.25		
505+71.50 LT. TO 506+02.75 LT.			31.25		
505+71.50 RT. TO 506+02.75 RT.			31.25		
504+37.25 RT. TO 504+68.50 RT.		1		2	
505+71.50 RT. TO 506+02.75 RT.		1		2	
504+37.25 LT. TO 504+68.50 LT.		1		2	
505+71.50 LT. TO 506+02.75 LT.		1		2	
504+68.50 RT. TO 505+71.50 RT.					2
504+68.50 LT. TO 505+71.50 LT.					2
TOTAL:		4	125	8	4

PAVING SCHEDULE						
STATION TO STATION	BITUMINOUS MATERIALS PRIME COAT (GALLON)	AGGREGATE PRIME COAT (TON)	BITUMINOUS SURFACE REMOVAL (SQ. YD.)	AGGREGATE SHOULDERS (TON)	BITUMINOUS CONCRETE SURFACE COURSE SUPERPAVE MIX D (TON)	BINDER COURSE SUPERPAVE N50 (TON)
504+51.87 TO 504+88.00	17.5	0.5		1.5	10	10.5
505+52.00 TO 505+87.50	17.5	0.5		1.5	10	10.5
504+87.87 TO 505+51.50			92		33	
504+51.87 TO 505+87.50						
TOTAL:	35	1	92	3	53	21

PAVEMENT MARKING SCHEDULE						
STATION TO STATION	SHORT TERM PAVEMENT MARKINGS (FOOT)	TEMPORARY PAVEMENT MARKING LINE 4" (FT.)	WORK ZONE PAVEMENT MARKING REMOVAL (SQ. FT.)	EPOXY PAVEMENT MARKING LINE 4" (FOOT)		PAVEMENT MARKING REMOVAL (SQ. FT.)
				WHITE	YELLOW	
501+51.00 C TO 508+60.00 C	144		48		1418	473
501+51.00 RT. TO 508+60.00 RT.			236.3			
501+51.00 LT. TO 508+60.00 LT.			236.3			
501+51.00 RT. TO 508+60.00 RT. (STAGE 1 & 2)		1418	236.3			
501+51.00 LT. TO 508+60.00 LT. (STAGE 1 & 2)		1418	236.3			
504+51.87 RT. TO 505+87.50 RT.		135.6	45.2	135.6		
504+51.87 LT. TO 505+87.50 LT.		135.6	45.2	135.6		
STOP BAR (2 LOCATIONS)			48			
SUB TOTAL:		3107	1132	271.2	1418	
TOTAL:	144	3107	1132	1689		473

EARTH EXCAVATION (WIDENING)		
STATION TO STATION		EXCAVATION (CU YD)
503+60.00, LT. TO 504+67.95, LT.		15
505+71.42, LT. TO 506+40.00, LT.		10
503+90.00, RT. TO 504+67.95, RT.		11
505+71.42, RT. TO 506+70.00, RT.		14
TOTAL:		50

BITUMINOUS BASE COURSE WIDENING, 9"		
STATION TO STATION		WIDENING (SQ YD)
503+60.00, LT. TO 504+67.95, LT.		60
505+71.42, LT. TO 506+40.00, LT.		38
503+90.00, RT. TO 504+67.95, RT.		43
505+71.42, RT. TO 506+70.00, RT.		55
TOTAL:		196

REVISIONS	
NAME	DATE

ILLINOIS DEPARTMENT OF TRANSPORTATION
GENERAL SITE PLAN AND SCHEDULES
 F.A.P. RTE. 693
 SECTION (119B-3)I
 TAZEWELL COUNTY

SCALE: NONE
 DATE: 03/24/2006
 DRAWN BY: KBF
 CHECKED BY: AJE

DATE: 03/24/2006
 TIME: 7:55:21 AM
 FILE: \\plnsheets\PrairieCreek_add1.dgn