

SEC. 28, T. 14 N., R. 13 W., 3RD P. M.

SEC. 27, T. 14 N., R. 13 W., 3RD P. M.

F.A.P. RTE.	SECTION	COUNTY	TOTAL SHEETS	SHEET NO.
749	*	EDGAR	75	25
STA.		TO STA.		
FED. ROAD DIST. NO.	ILLINOIS	FED. AID PROJECT		

CONTRACT NO. 70134
 • 14RS-2, 122RS-3 & (123NRS,14)BR

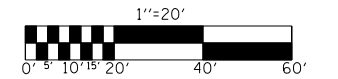

PLAN	DATE
SURVEYED	
GRADES CHECKED	
ALIGNED	
ADJUSTED	
RT. OF WAY CHECKED	
PAID FILE NAME	
NOTE BOOK NO.	

PROFILE	DATE
SURVEYED	
GRADES CHECKED	
B.M. NOTED	
STRUCTURE NOTATIONS OK'D	
NOTE BOOK NO.	

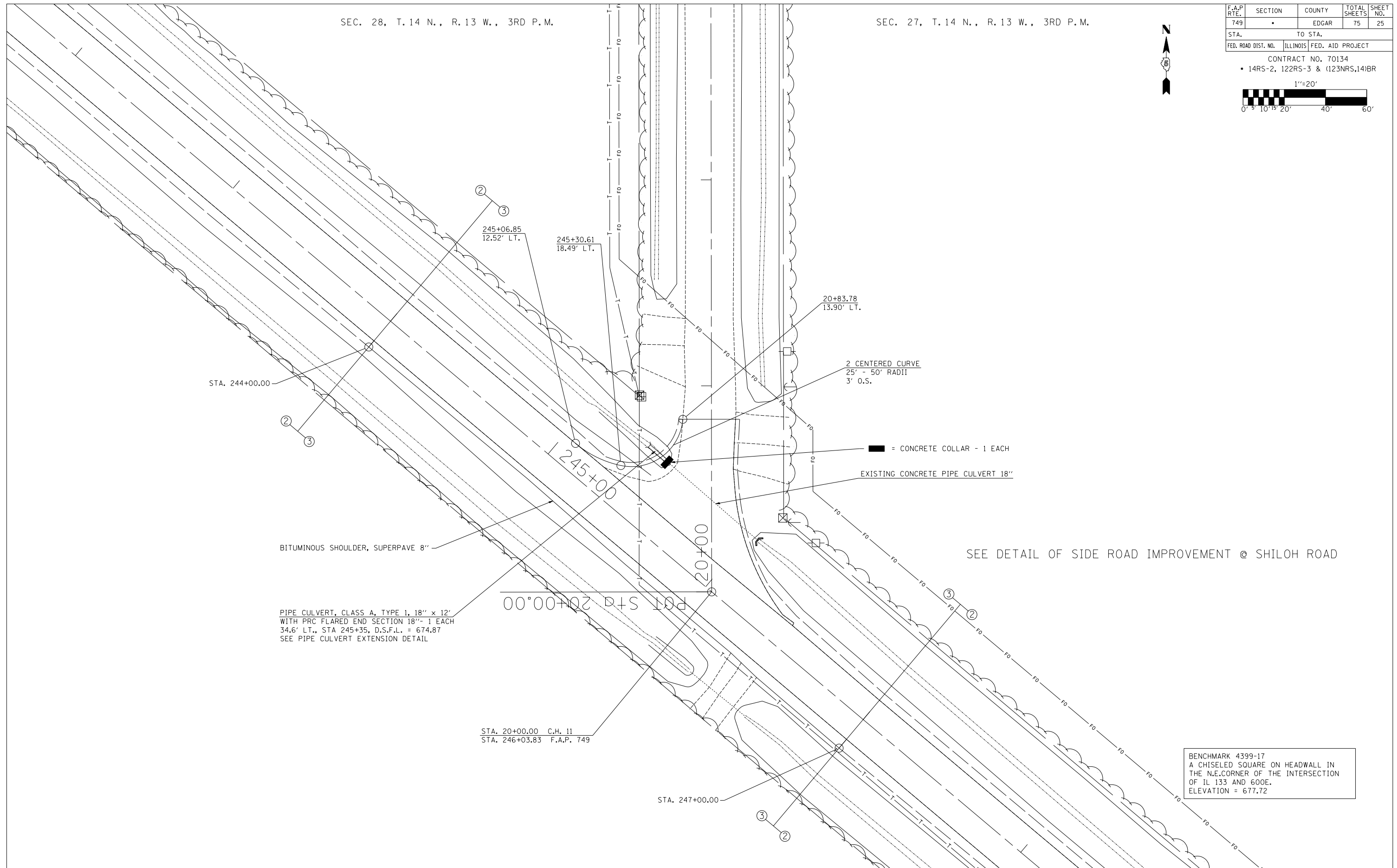

BITUMINOUS SHOULDER, SUPERPAVE 8"

PIPE CULVERT, CLASS A, TYPE 1, 18" x 12'
 WITH PRC FLARED END SECTION 18"- 1 EACH
 34.6' LT., STA 245+35, D.S.F.L. = 674.87
 SEE PIPE CULVERT EXTENSION DETAIL

STA. 20+00.00 C.H. 11
 STA. 246+03.83 F.A.P. 749

■ = CONCRETE COLLAR - 1 EACH
 EXISTING CONCRETE PIPE CULVERT 18"

SEE DETAIL OF SIDE ROAD IMPROVEMENT @ SHILOH ROAD

BENCHMARK 4399-17
 A CHISELED SQUARE ON HEADWALL IN
 THE N.E. CORNER OF THE INTERSECTION
 OF IL 133 AND 600E.
 ELEVATION = 677.72