

F.A.P. RTE.	SECTION	COUNTY	TOTAL SHEETS	SHEET NO.
*	**	MACOUPIN	231	25
STA.		TO STA.		
FED. ROAD DIST. NO.	ILLINOIS	FED. AID PROJECT		

\* FAP 325 & FAP 604  
 \*\* 14R; 115RS-2; 116RS-4; 101RS-2

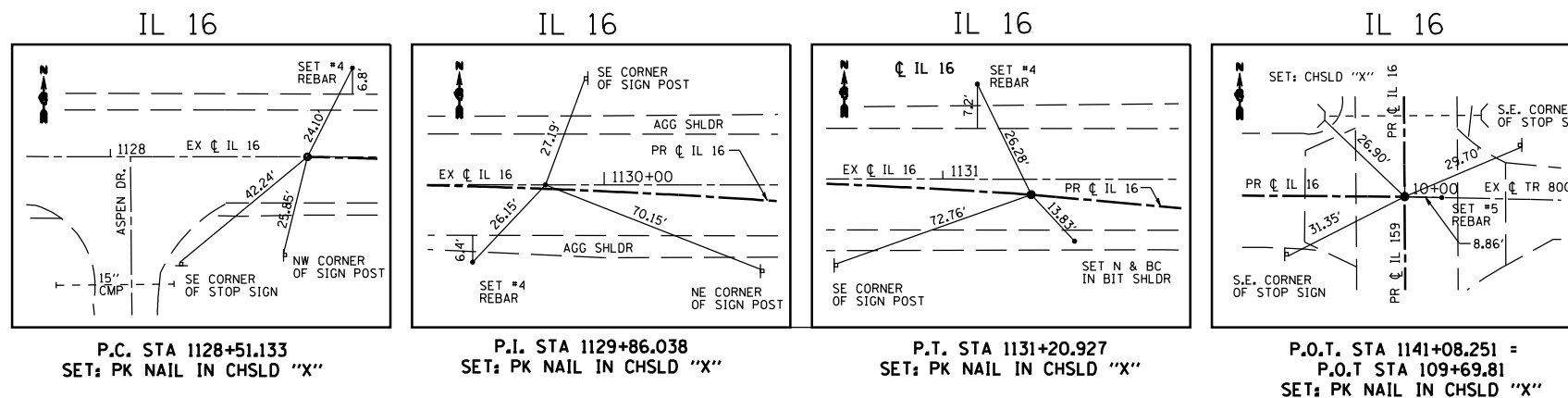

BM WAS 3 : SET CHSLD "□" ON NORTH END OF CONC. PIPE 15" - UNDER FIELD ENT. STA. 36+40 IL-16 NAVD '88 = 646.043 FT.

BM WAS 4 : SET CHSLD "□" ON SOUTH END OF 2 x 15 CONC. HDWL. STA. 9+00 & 27' RT. (IL-16) NAVD '88 = 652.704 FT.

BM WAS 6 : FOUND CHSLD "□" ON WEST END OF 2 x 15 CONC. HDWL. STA. 9+84 & 19' LT. (AT INTERSECTION OF CAVENY RD.) NAVD '88 = 653.456 FT.

BM WAS 7 : SET CHSLD "□" ON EAST END OF 3 x 3 CULVERT STA. 1153+87 & 47' LT. (IL-159) NAVD '88 = 645.284 FT.

BM WAS 8 : SET CHSLD "□" ON WEST END OF 7 x 7 CULVERT STA. 1168+37 & 52' RT. (IL-159) NAVD '88 = 629.250 FT.

BM WAS 9 : SET CHSLD "□" ON WEST END OF 4 x 4 CULVERT STA. 1178+76 & 48.7' RT. (IL-159) NAVD '88 = 632.564 FT.

BM WAS 11 : FOUND CHSLD "□" ON NO. HDWL. OF CULV. FOR FIELD ENT. STA. 1194+68.7 & 34' LT. (S.E. QUAD. OF JCT. IL-159/TR700N) NAVD '88 = 640.665 FT.

BM 27B : 0.65 MI. - 60d NAIL SET IN W. SIDE UTIL. POLE (MJM ELEC. COOP #29375), 35' E. OF RT. 159 & 0.38 MI. N. OF INT. RT. 159 & PRARIE DELL RD. ELEV. = 640.458 STA. = 1174+56.5 ; OFF. = 40.2 LT.

BM 28B : 0.97 MI. - BOX CUT ON TOP W. CONC. HDWL. OF A 2' x 3' BOX CULVERT UNDER RT. 159, 25' W. OF RT. 4 & 0.08 MI. N. OF INT. RT. 159 & PRARIE DELL RD. ELEV. = 641.846 STA. = 1190+80 ; OFF. = 29.5 RT.

BM 29B : 1.31 MI. - TOP OF CONC. RT. 159 R.O.W. MARKER @ A FIELD LINE, 35' E. OF RT. 159 & 0.60 MI. N. OF INT. RT. 159 & ROLLO LN. ELEV. = 651.809 STA. = 1208+90.4 ; OFF. = 39.8 LT.

BM 30B : 1.70 MI. - 60d NAIL SET IN E. SIDE UTIL. POLE (NO\*), 37' W. OF RT. 159 & 0.20 MI. N. OF INT. RT. 159 & ROLLO LN. ELEV. = 660.173 STA. = 1228+87.5 ; OFF. = 40.0 RT.

BM 31B : 2.03 MI. - 60d NAIL SET IN E. SIDE UTIL. POLE (NO\*), 39' W. OF RT. 159 & 0.10 MI. S. OF INT. RT. 159 & ROLLO LN. ELEV. = 665.188 STA. = 1245+20.3 ; OFF. = 38.9 RT.

BM 32B : 2.39 MI. - IL. POWER CAP (IDOT #7000) 34' W. OF RT. 159 & 285' S. OF RT. 159 MILE MARKER 6.00 ELEV. = 662.574

BM 33B : 2.70 MI. - IL. POWER CAP (IDOT #103) 41' E. OF RT. 159 & 0.10 MI. S. OF INT. RT. 159 & FAHRENKROG RD. ELEV. = 658.710

BM 34B : 3.05 MI. - 60d NAIL SET IN E. SIDE UTIL. POLE (NO\*), 48' W. OF RT. 159 & 230' N. OF INT. RT. 159 & MILES STATION RD. ELEV. = 658.571 STA. = 1296+69.8 ; OFF. = 48.5 RT.

BM 35B : 3.35 MI. - N.N.E. BONNET BOLT OF A FIRE HYDRANT W. OF RT. 159 & 170' N. OF RT. 159 MILE MARKER 5.00 ELEV. = 669.550 STA. = 113+02 ; OFF. = 50.9 RT.

BM 36B : 3.71 MI. - 60d NAIL SET IN E. SIDE UTIL. POLE (NO\*), 40' W. OF RT. 159 & 0.40 MI. N. OF INT. RT. 159 & DETOUR RD. ELEV. = 663.792 STA. = 131+94 ; OFF. = 40.0 RT.

BM 37B : 4.09 MI. - 60d (SLIGHTLY BENT) NAIL SET IN W. SIDE UTIL. POLE (NO\*), 40' W. OF RT. 159 & 260' N. OF INT. RT. 159 & DETOUR RD. (RESET NEW ELEV. 7/17/2001) ELEV. = 656.960

BM 38B : 4.40 MI. - IN BUNKER HILL, N.N.W. BONNET BOLT OF FIRE HYDRANT, 48' E. OF RT. 159 & 0.22 MI. N. OF NEW LAKE RD. @ RT. 159 MILE MARKER 4.00 ELEV. = 650.762 STA. = 166+61.8 ; OFF. = 48.2 LT.

BM 39B : 4.76 MI. - IN BUNKER HILL, RR SPIKE IN E. SIDE OF UTIL. POLE (NO\*) @ S.W. QUAD. OF THE INT. OF RT. 159 & W. PLEASANT ST. EAST, W. OF RT. 159, 30' S. OF W. PLEASANT ST. EAST ELEV. = 637.095 STA. = 184+57.9 ; OFF. = 23.0 RT.

BM 40B : 0.0 MI. - IN BUNKER HILL, TOP IRON ROD WITH BRASS DISK FOUND ON THE TOP W. SIDE OF MARBLE LINCOLN MON. @ INT. RT. 159 (N. WASHINGTON ST.) & FAYETTE ST. EAST ELEV. = 668.013 STA. = 201+58.4 ; OFF. = 1.5 RT.

BM 41B : 0.03 MI. - IN BUNKER HILL, 60d NAIL SET IN E. SIDE OF UTIL. POLE (NO\*), 25' W. OF RT. 159 (S. WASHINGTON ST.) & IN FRONT OF HOUSE #418 S. WASHINGTON ST. ELEV. = 640.040 STA. = 12+40 ; OFF. = 25.3 RT.

BM 42B : 0.06 MI. - IN BUNKER HILL, 60d NAIL SET IN E. SIDE OF UTIL. POLE (NO\*), 22' S. OF RT. 159 (S. WASHINGTON ST.) & S. ALTON ST. EAST @ GRAVEL DRIVE TO LANDER'S FUNERAL HOME. ELEV. = 638.223 STA. = 28+72.4 ; OFF. = 36.3 RT.

BM 43B : 0.95 MI. - IN BUNKER HILL, 60d NAIL SET IN W. SIDE OF UTIL. POLE (\*P15), 22' E. OF RT. 159 & 169' N. OF INT. RT. 159 & WORTH AVE., IN FRONT OF RED TOP INN ELEV. = 636.826 STA. = 45+64.5 ; OFF. = 22.0 LT.

BM 44B : 1.22 MI. - IN BUNKER HILL, 60d NAIL SET IN W. SIDE OF UTIL. POLE (NO\*), E. OF RT. 159 & 0.18 MI. N. OF INT. RT. 159 & BARTHS LAKE RD. ELEV. = 636.144 STA. = 62+02.5 ; OFF. = 39.5 LT.

BM 45B : 1.55 MI. - IN BUNKER HILL, 60d NAIL SET IN W. SIDE OF UTIL. POLE (MJM ELEC. COOP #32161), E. OF RT. 159 & 0.18 MI. S. OF INT. RT. 159 & BARTHS LAKE RD. ELEV. = 633.021 STA. = 78+10.3 ; OFF. = 38.8 LT.

BM 46B : 1.8 MI. - BOX CUT ON TOP N.E. CORNER OF THE N. CONC. HDWL. OF A 15" RCP CULVERT UNDER A FARM ROAD, E. OF RT. 159 & 200' S. OF INT. RT. 159 & RUST RD. ELEV. = 630.008 STA. = 91+28 ; OFF. = 28.5 LT.

BM 48B : 2.50 MI. - 60d NAIL SET IN W. SIDE OF UTIL. POLE (MJM ELEC. COOP #32350), @ N.E. QUAD. INT. RT. 159 & A GRAVEL FARM RD. @ ADDRESS #799 RT. 159, E. OF RT. 159 & 0.35 MI. N. OF INT. RT. 159 & CATHOLIC SPRINGS RD. ELEV. = 621.253 STA. = 127+08 ; OFF. = 39.5 LT.

BM 49B : 2.75 MI. - 60d NAIL SET IN W. SIDE OF UTIL. POLE (MJM ELEC. COOP #32356), 40' E. OF RT. 159 & 0.11 MI. N. OF INT. RT. 159 & CATHOLIC SPRINGS RD. ELEV. = 619.808 STA. = 139+03 ; OFF. = 40.0 LT.

BM 50B : 3.05 MI. - BOX CUT ON TOP S.W. CORNER OF THE N. HDWL. OF A 12" RCP CULVERT UNDER A DIRT ROAD TO A FARM FIELD, 29' W. OF RT. 159 & 0.40 MI. N. OF MADISON/MACOUPIN CO. LINE, OPPOSITE ADDRESS #316 RT. 159 ELEV. = 616.594 STA. = 153+38.5 ; OFF. = 29.0 RT.

BM 51B : 3.35 MI. - 60d NAIL SET IN W. SIDE OF UTIL. POLE (MJM ELEC. COOP #32396), 70' E. OF RT. 159 & 0.10 MI. N. OF THE MADISON/MACOUPIN CO. LINE ELEV. = 606.835 STA. = 169+78.5 ; OFF. = 70.0 LT.

NOTE : BM 27B THROUGH BM 39B

MILEAGES AS SHOWN ARE ALONG IL-RT. 159 FROM THE INTERSECTION OF IL RT. 159/16 AND CAVENY RD. AT THE "Y" INTERSECTION ON IL RT. 16 AND IL RT. 159.

NOTE : BM 40B THROUGH BM 51B

MILEAGES AS SHOWN ARE SOUTH ALONG IL RT. 159 FROM THE LINCOLN MONUMENT IN THE CENTER OF BUNKER HILL.

SHEET 3 OF 3

ILLINOIS DEPARTMENT OF TRANSPORTATION  
 CROSS TIES & BENCHMARKS  
 FAP 325 (IL 16) & FAP 604 (IL 159)  
 SECTION 14R; 115RS-2; 116RS-4; 101RS-2  
 MACOUPIN COUNTY

SCALE: VERT. \_\_\_\_\_ DRAWN BY \_\_\_\_\_  
 HORIZ. \_\_\_\_\_ CHECKED BY \_\_\_\_\_  
 DATE \_\_\_\_\_