

F.A.P. RTE.	SECTION	COUNTY	TOTAL SHEETS	SHEET NO.
•	••	MACOUPIN	231	54
STA. 179+00		TO STA. 184+90		
FED. ROAD DIST. NO.		ILLINOIS	FED. AID PROJECT	
• FAP 325 & FAP 604				
•• 14R; 115RS-2; 116RS-4; 101RS-2				

SEE NORTH STREET PLAN AND PROFILE SHEET FOR ADDITIONAL INFORMATION

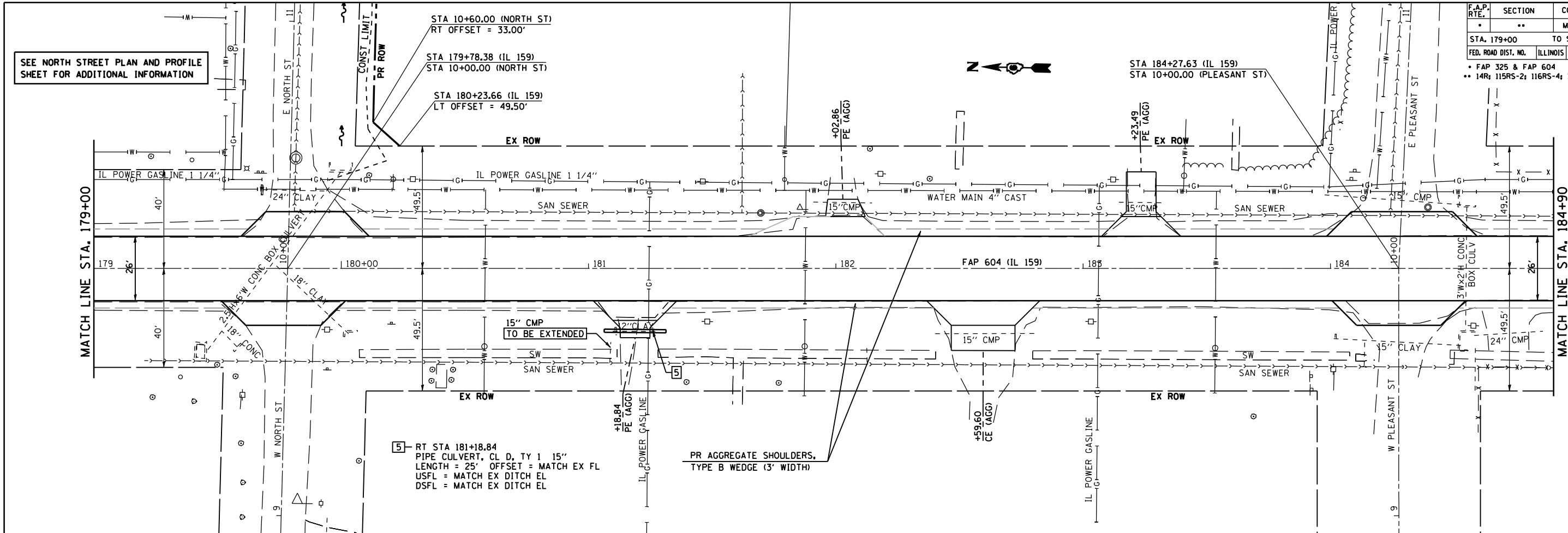

PLAN	SURVEYED	BY	DATE
NO.	NO.		

PROFILE	SURVEYED	BY	DATE
NO.	NO.		

NOTE: FOR ENTRANCES, MAILBOX TURNOUTS, AND SIDE ROADS ON PART C, SEE DISTRICT SIX ENTRANCE DETAIL FOR '3R' PROJECTS

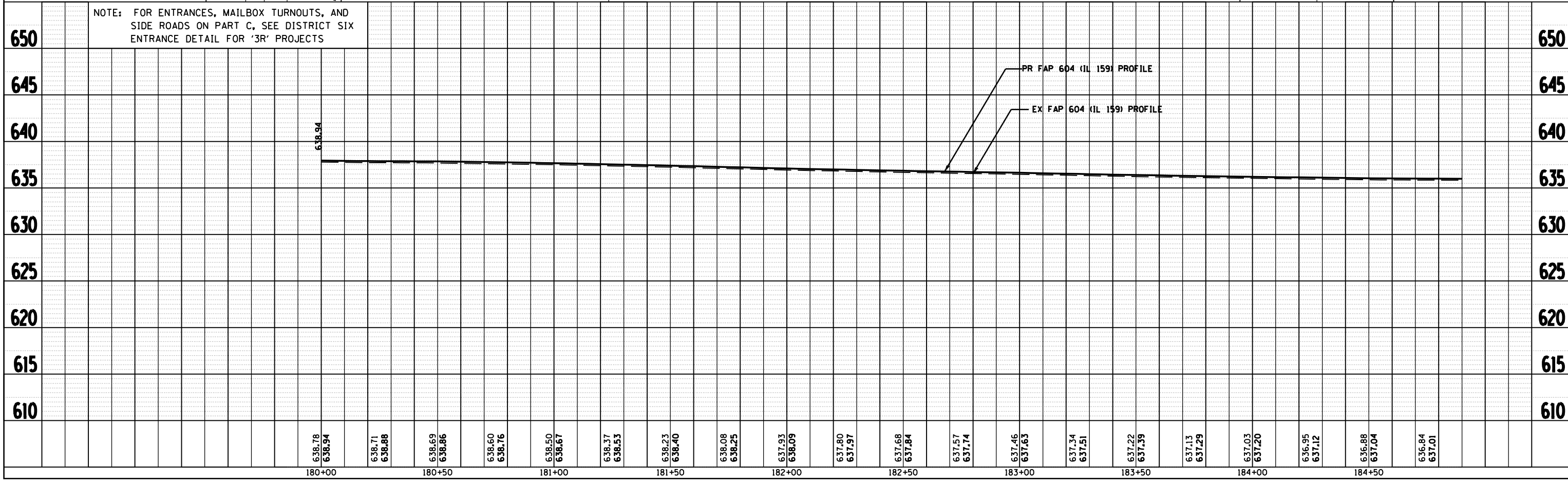

PLOT DATE = #DATES
 FILE NAME = #FILES
 PLOT SCALE = #SCALES
 USER NAME = #USERS