

F.A.P. RTE.	SECTION	COUNTY	TOTAL SHEETS	SHEET NO.
*	**	MACOUPIN	231	66
STA. 95+50		TO STA. 127+50		
FED. ROAD DIST. NO.		ILLINOIS	FED. AID PROJECT	
* FAP 325 & FAP 604				
** 14R; 115RS-2; 116RS-4; 101RS-2				

NOTE: FOR ENTRANCES, MAILBOX TURNOUTS, AND SIDE ROADS ON PART B, SEE DISTRICT SIX ENTRANCE DETAIL FOR 'PPP' PROJECTS

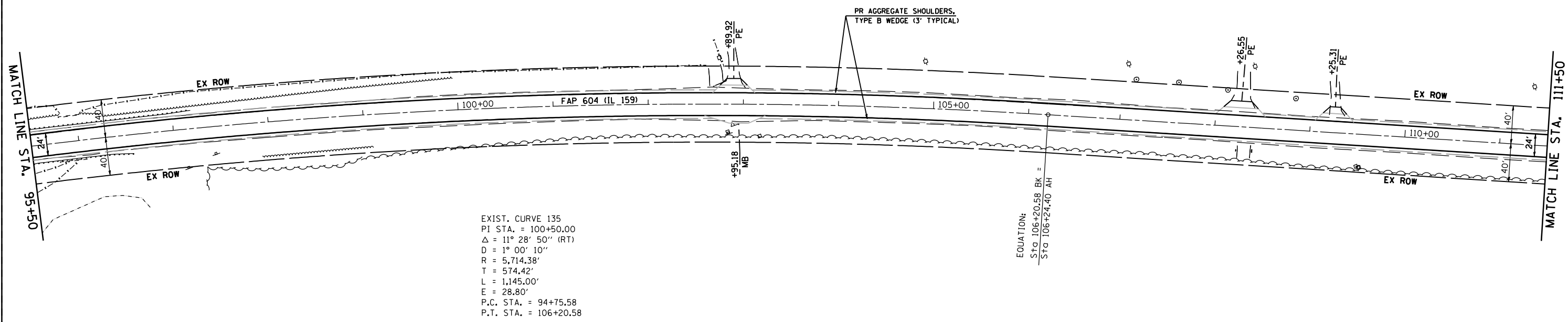

EXIST. CURVE 135  
 PI STA. = 100+50.00  
 $\Delta = 11^\circ 28' 50''$  (RT)  
 $D = 1^\circ 00' 10''$   
 $R = 5,714.38'$   
 $T = 574.42'$   
 $L = 1,145.00'$   
 $E = 28.80'$   
 P.C. STA. = 94+75.58  
 P.T. STA. = 106+20.58

EQUATION:  
 $Sta\ 106+20.58\ BK =$   
 $Sta\ 106+24.40\ AH$

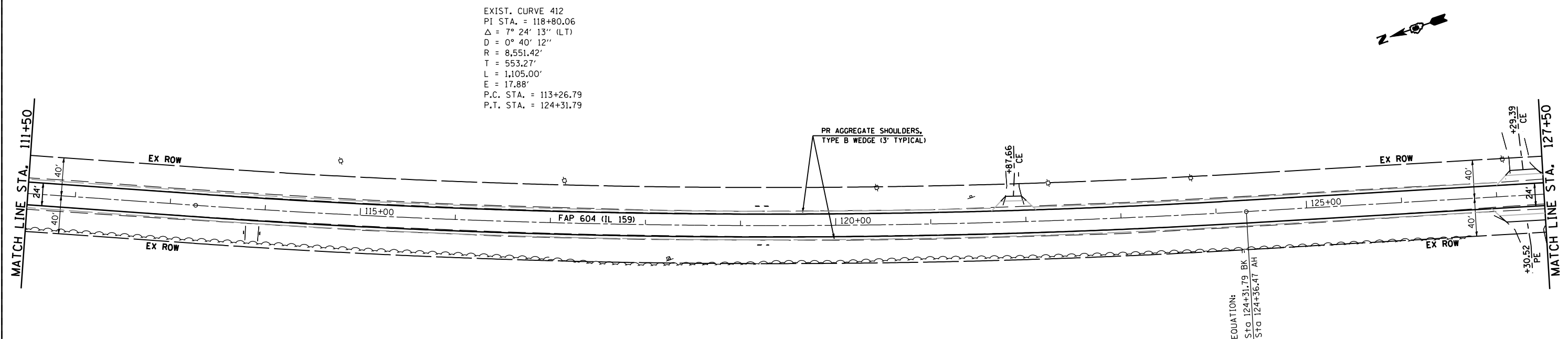

EXIST. CURVE 412  
 PI STA. = 118+80.06  
 $\Delta = 7^\circ 24' 13''$  (LT)  
 $D = 0^\circ 40' 12''$   
 $R = 8,551.42'$   
 $T = 553.27'$   
 $L = 1,105.00'$   
 $E = 17.88'$   
 P.C. STA. = 113+26.79  
 P.T. STA. = 124+31.79

EQUATION:  
 $Sta\ 124+31.79\ BK =$   
 $Sta\ 124+36.47\ AH$

PLOT DATE = #DATE#  
 PLOT SCALE = #SCALE#

REVISIONS	
NAME	DATE

ILLINOIS DEPARTMENT OF TRANSPORTATION  
**PLAN VIEW**  
 FAP 325 (IL 16) & FAP 604 (IL 159)  
 SECTION 14R; 115RS-2; 116RS-4; 101RS-2  
 MACOUPIN COUNTY  
 SCALE: 1" = 50'  
 DATE: \*\*DATE\*\*  
 DRAWN BY: \_\_\_\_\_  
 CHECKED BY: \_\_\_\_\_