

| F.A.P. RTE. | SECTION | COUNTY | TOTAL SHEETS | SHEET NO. |
|----------------------------------------------------------|---------|----------------|------------------|-----------|
| * | ** | MACOUPIN | 231 | 68 |
| STA. 159+50 | | TO STA. 183+67 | | |
| FED. ROAD DIST. NO. | | ILLINOIS | FED. AID PROJECT | |
| • FAP 325 & FAP 604 •• 14R; 115RS-2; 116RS-4; 101RS-2 | | | | |

NOTE: FOR ENTRANCES, MAILBOX TURNOUTS, AND SIDE ROADS ON PART B, SEE DISTRICT SIX ENTRANCE DETAIL FOR 'PPP' PROJECTS

EXIST. CURVE 136
 PI STA. = 159+96.40
 $\Delta = 14^\circ 45' 04''$ (RT)
 $D = 1^\circ 19' 33''$
 $R = 4,321.12'$
 $T = 559.34'$
 $L = 1,112.50'$
 $E = 36.05'$
 P.C. STA. = 154+37.06
 P.T. STA. = 165+49.56

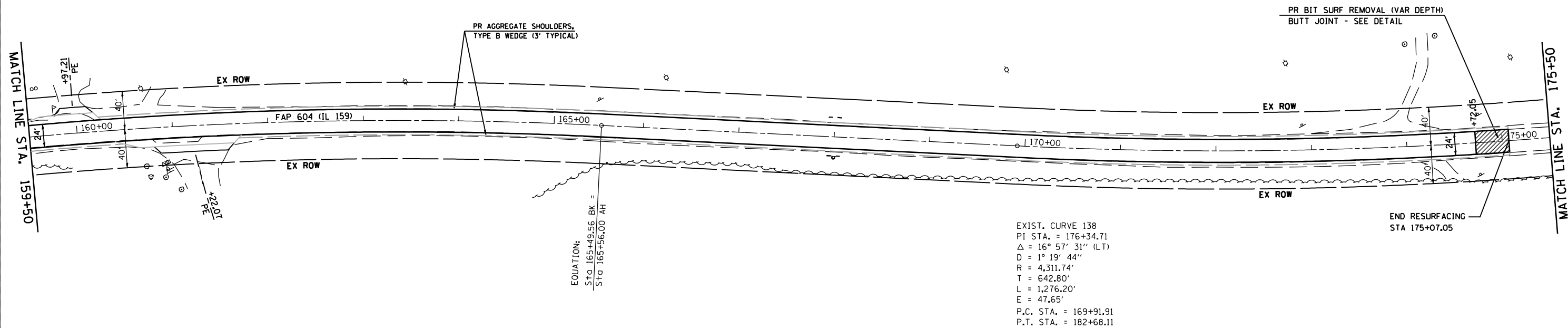

EXIST. CURVE 138
 PI STA. = 176+34.71
 $\Delta = 16^\circ 57' 31''$ (LT)
 $D = 1^\circ 19' 44''$
 $R = 4,311.74'$
 $T = 642.80'$
 $L = 1,276.20'$
 $E = 47.65'$
 P.C. STA. = 169+91.91
 P.T. STA. = 182+68.11

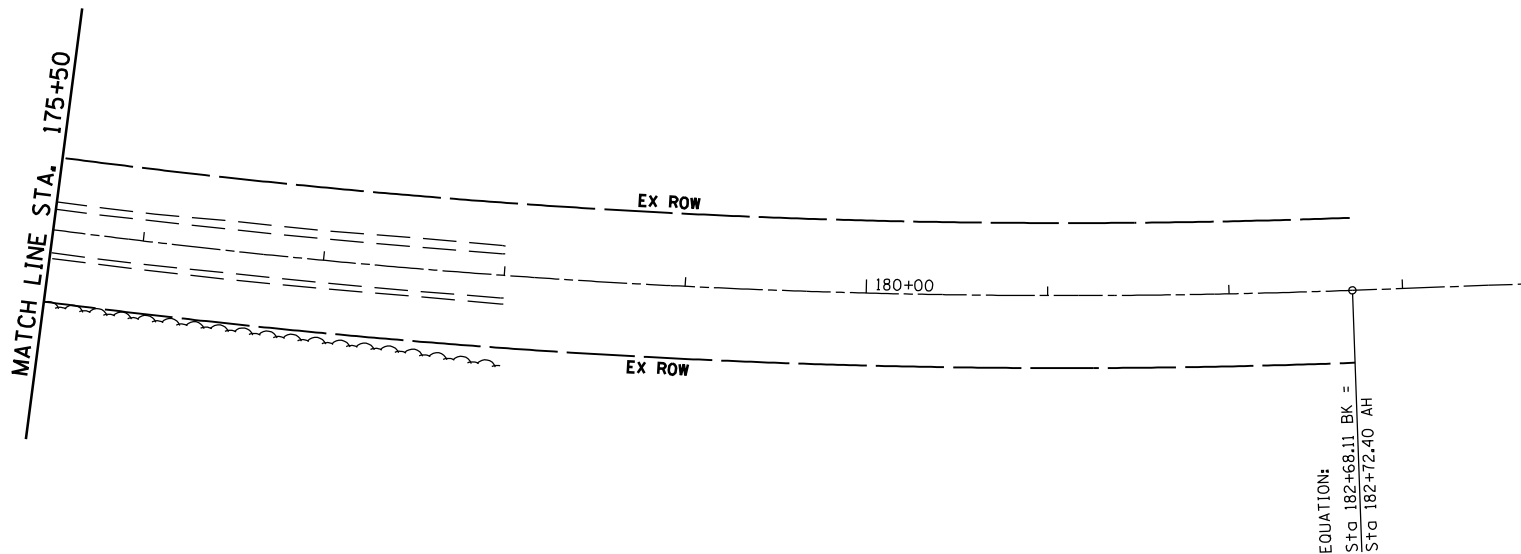

| REVISIONS | |
|-----------|------|
| NAME | DATE |
| | |
| | |
| | |
| | |
| | |
| | |
| | |
| | |
| | |
| | |

ILLINOIS DEPARTMENT OF TRANSPORTATION
PLAN VIEW
 FAP 325 (IL 16) & FAP 604 (IL 159)
 SECTION 14R; 115RS-2; 116RS-4; 101RS-2
 MACOUPIN COUNTY

SCALE: 1" = 50'
 DATE: **DATE**
 DRAWN BY: _____
 CHECKED BY: _____

PLOT DATE: **DATE**
 PLOT SCALE: **SCALE**