

F.A.P. RTE.	SECTION	COUNTY	TOTAL SHEETS	SHEET NO.
*	**	MACOUPIN	231	81
STA.		TO STA.		
FED. ROAD DIST. NO.	ILLINOIS	FED. AID PROJECT		
* FAP 325 & FAP 604				
** 14R; 115RS-2; 116RS-4; 104RS-2				

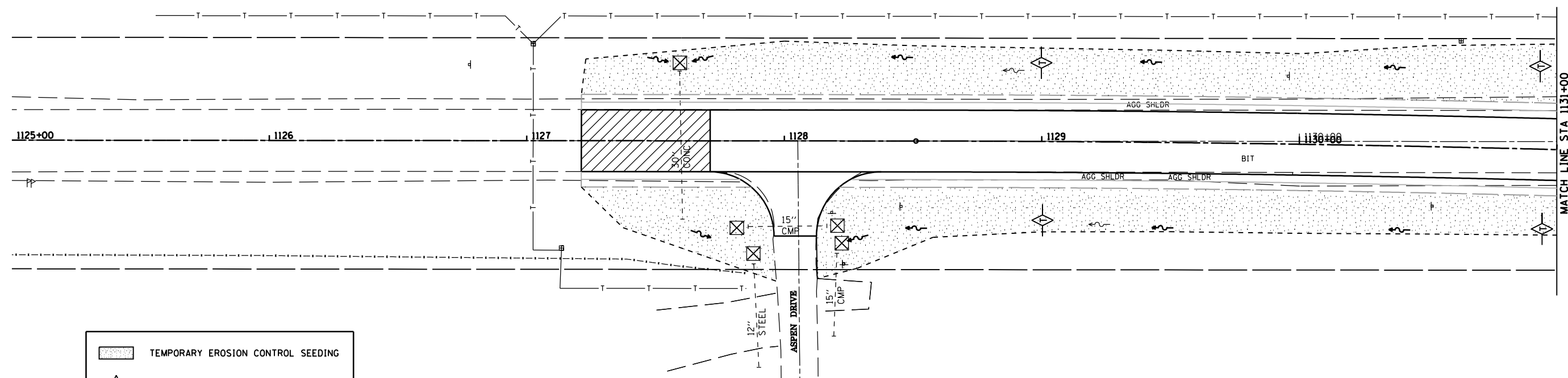

	TEMPORARY EROSION CONTROL SEEDING
	TEMPORARY DITCH CHECK
	INLET AND PIPE PROTECTION

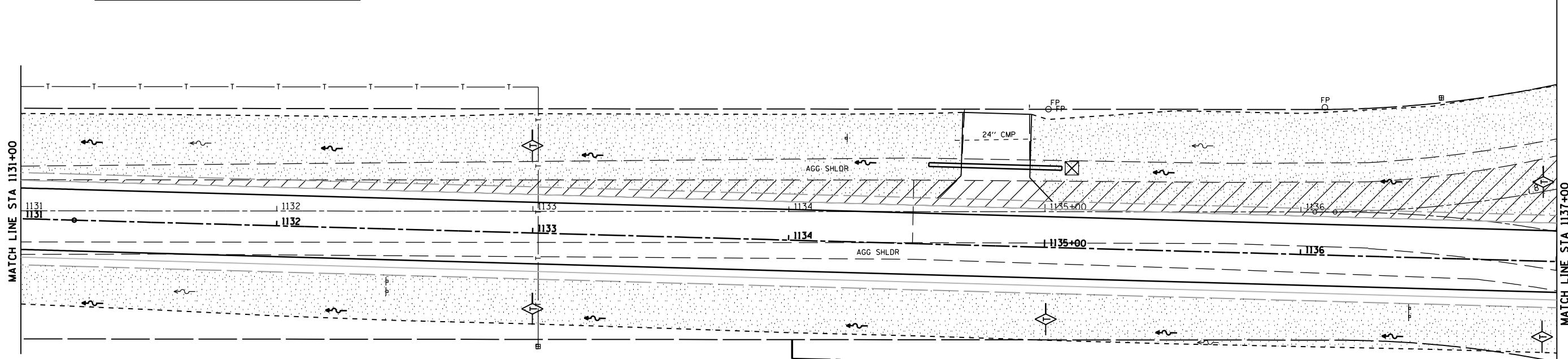

PLOT DATE \* STATES  
 FILE NAME \* #FILES  
 PLOT SCALE \* #SCALE#  
 REFERENCE \* #REF#

REVISIONS	
NAME	DATE

ILLINOIS DEPARTMENT OF TRANSPORTATION  
**STORM WATER POLLUTION PREVENTION PLAN**  
 FAP 325 (IL 16) & FAP 604 (IL 159)  
 SECTION 14R; 115RS-2; 116RS-4; 101RS-2  
 MACOUPIN COUNTY  
 SCALE: VERT. \_\_\_\_\_  
 DATE \_\_\_\_\_ HORIZ. \_\_\_\_\_  
 DRAWN BY \_\_\_\_\_  
 CHECKED BY \_\_\_\_\_