

F.A.P. RTE.	SECTION	COUNTY	TOTAL SHEETS	SHEET NO.
*	**	MACOUPIN	231	100
STA.		TO STA.		
FED. ROAD DIST. NO.	ILLINOIS	FED. AID PROJECT		

\* - FAP 325 & FAP 604  
 \*\* - 14R, 115RS-2, 116RS-4, 101RS-2

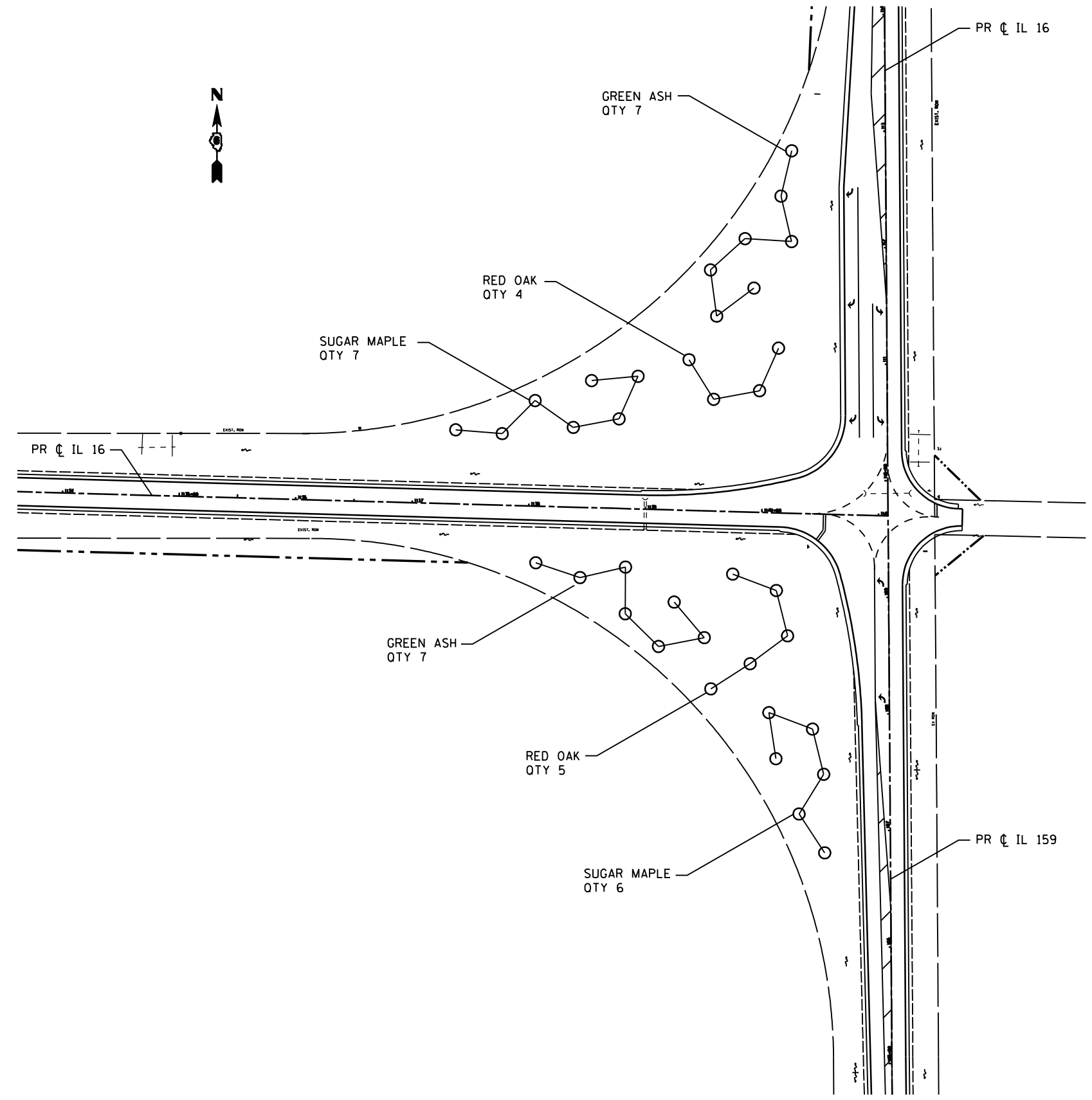

○ PROPOSED SHADE TREE

- NOTE:
1. THE PROPOSED LANDSCAPING WILL BE INCLUDED AS PART OF THIS CONTRACT.
  2. ALL TREES TO BE SPACED APPROXIMATELY 40-50 FEET APART.
  3. ALL TREES TO BE STAKED BY DISTRICT LANDSCAPE ARCHITECT PRIOR TO PLANTING.

REVISIONS	
NAME	DATE

ILLINOIS DEPARTMENT OF TRANSPORTATION  
**LANDSCAPING DETAILS**  
 FAP 325 (IL 16) & FAP 604 (IL 159)  
 SECTION 14R, 115RS-2, 116RS-4, 101RS-2  
 MACOUPIN COUNTY

SCALE: VERT. \_\_\_\_\_  
 HORIZ. \_\_\_\_\_  
 DATE \_\_\_\_\_

DRAWN BY \_\_\_\_\_  
 CHECKED BY \_\_\_\_\_

\*DGN-SPEC\*  
 \*DATE-TIME\*  
 \*REF01