

F.A.P. RTE.	SECTION	COUNTY	TOTAL SHEETS	SHEET NO.
*	**	MACOUPIN	231	196
STA. 6+35.22		TO STA. 7+00.00		
FED. ROAD DIST. NO.	ILLINOIS	FED. AID PROJECT		

- \* FAP 325 & FAP 604
- \*\* 14R 115RS-2; 116RS-4; 10IRS-2

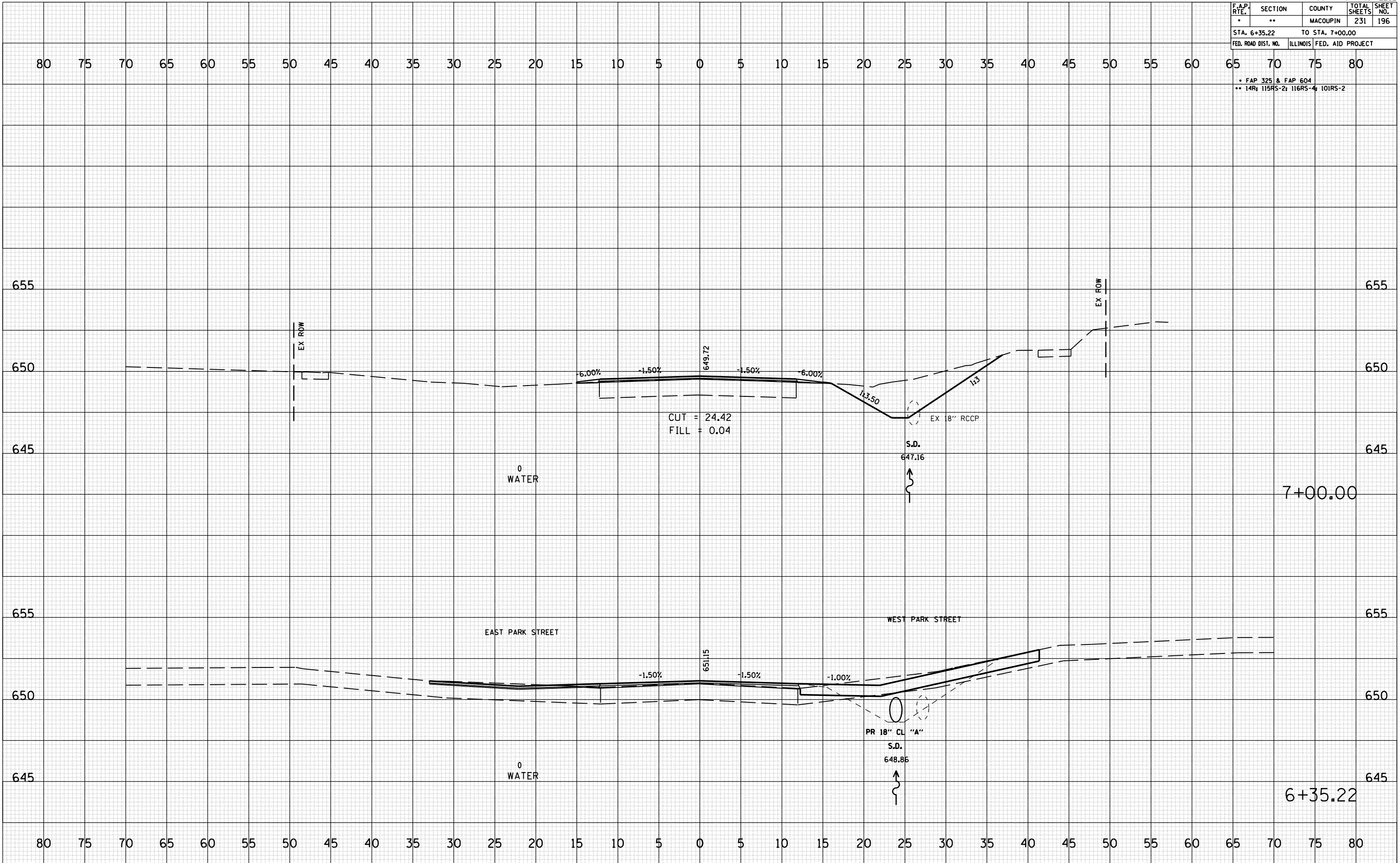

DATE	BY	SURVEYED	PLOTTED	NOTE BOOK NO.	AREAS CHECKED

DATE	BY	SURVEYED	PLOTTED	NOTE BOOK NO.	AREAS CHECKED

PLOT DATE \* DATE \*  
 PLOT NAME \* FILE \*  
 PLOT SCALE \* SCALE \*  
 USER NAME \* USER \*