

F.A.P. RTE.	SECTION	COUNTY	TOTAL SHEETS	SHEET No.
315	34-5	HANCOCK	612	66
STA. 1174+00.00 TO STA. 1212+00				
FED. ROAD DIST. No.		ILLINOIS	FED. AID PROJECT	

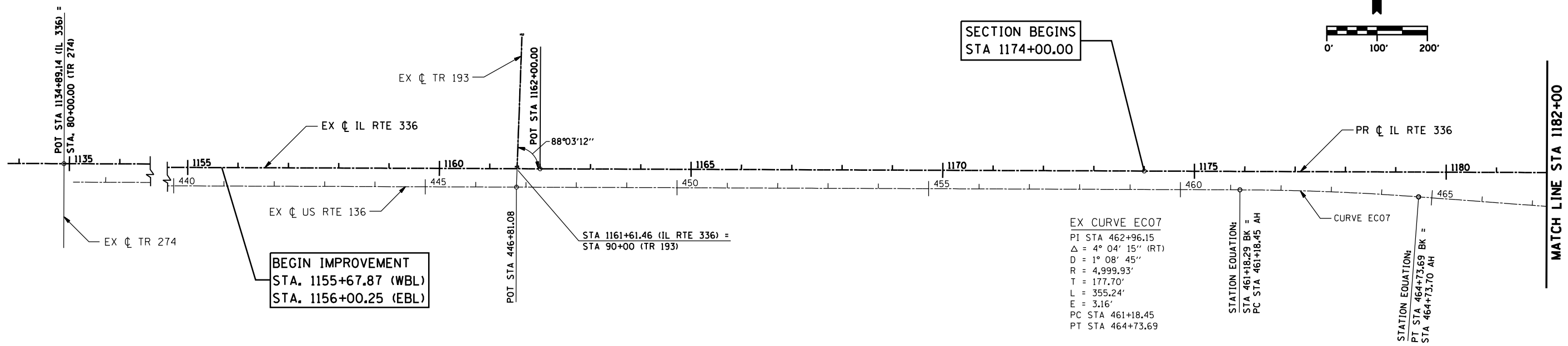
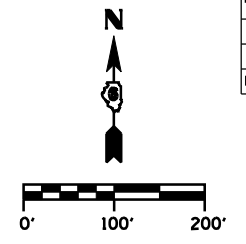

SECTION BEGINS
STA 1174+00.00

BEGIN IMPROVEMENT
STA. 1155+67.87 (WBL)
STA. 1156+00.25 (EBL)

EX CURVE EC07
PI STA 462+96.15
 $\Delta = 4^\circ 04' 15''$ (RT)
D = $1^\circ 08' 45''$
R = 4,999.93'
T = 177.70'
L = 355.24'
E = 3.16'
PC STA 461+18.45
PT STA 464+73.69

STATION EQUATION:
STA 461+18.29 BK =
PC STA 461+18.45 AH

STATION EQUATION:
PT STA 464+73.69 BK =
STA 464+73.70 AH

B.M. *TA-234 FOUND 60D SPIKE NAIL
IN P.P. 0.20 MILES EAST ALONG
US RTE 136 FROM EAST END OF
BRIDGE *034-0066, SOUTH OF CL
EL 547.87

B.M. *TA-235 SET 60D SPIKE NAIL
IN P.P. 0.40 MILES EAST ALONG
US RTE 136 FROM EAST END OF
BRIDGE *034-0066, SOUTH OF CL
EL 547.15

EX CURVE EC09
PI STA 469+97.78
 $\Delta = 4^\circ 03' 08''$ (LT)
D = $1^\circ 08' 12''$
R = 5,041.10'
T = 178.34'
L = 356.54'
E = 3.15'
PC STA 468+19.44
PT STA 471+75.98

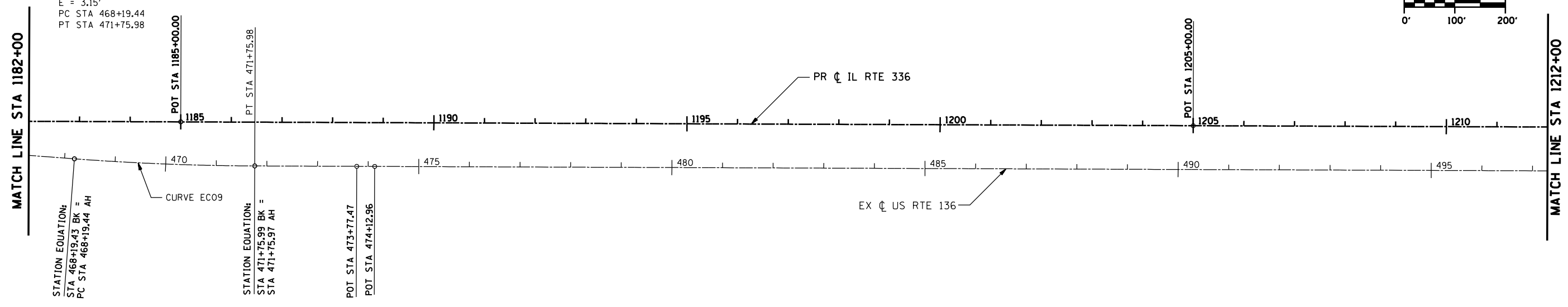

MATCH LINE STA 1182+00

MATCH LINE STA 1212+00

B.M. *TA-236 FOUND CHISELED "□" IN
SE CORNER OF SOUTH HEADWALL
FOR CULVERT, 0.70 MILES EAST
ALONG US RTE 136 FROM EAST END
BRIDGE *034-0066, EL 556.49

B.M. *TA-237 SET 60D SPIKE IN
P.P. 0.90 MILES EAST ALONG
US RTE 136 FROM EAST END OF
BRIDGE *034-0066, SOUTH OF CL
EL 559.14

NOTE:
CONTROL POINTS WILL BE LATHED OR
PAINTED ON PAVEMENT, BY IDOT, IN THE
FIELD PRIOR TO CONSTRUCTION.

DGN-SPEC
DATE-TIME
*REF01