

F.A.P. RTE.	SECTION	COUNTY	TOTAL SHEETS	SHEET No.
315	34-5	HANCOCK	612	68
STA. 1242+00		TO STA. 1273+00		
FED. ROAD DIST. No.		ILLINOIS	FED. AID PROJECT	

B.M. *TA-242 FOUND 60D SPIKE NAIL
IN GUY POLE 0.80 MILES EAST
ALONG US RTE 136 FROM TR 302,
NORTH OF C EL 568.50

B.M. *TA-243 SET CHISELED "□" IN
CENTER OF NORTH CONCRETE
HEADWALL 1.0 MILES EAST ALONG
US RTE 136 FROM TR 302,
EL 588.57

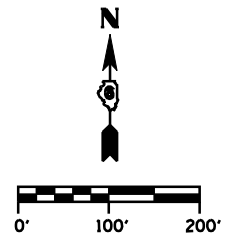

CURVE C1 DATA
PI STA 1238+44.42
Δ = 38° 15' 04" (LT)
D = 2° 43' 40"
R = 2,100.46'
T = 728.40'
L = 1,402.28'
E = 122.71'
PC STA 1231+16.02
PT STA 1245+18.30

EX CURVE EC11
PI STA 522+21.74
Δ = 38° 16' 02" (LT)
D = 2° 19' 31"
R = 2,463.99'
T = 854.85'
L = 1,645.67'
E = 144.08'
PC STA 513+66.89
PT STA 530+12.56

CURVE C2 DATA
PI STA 1267+15.31
Δ = 56° 48' 10" (RT)
D = 2° 43' 40"
R = 2,100.46'
T = 1,135.78'
L = 2,082.38'
E = 287.41'
PC STA 1255+79.53
PT STA 1276+61.92

EX CURVE EC13
PI STA 553+25.67
Δ = 56° 47' 35" (RT)
D = 3° 00' 00"
R = 1,909.83'
T = 1,032.49'
L = 1,893.07'
E = 261.23'
PC STA 542+93.18
PT STA 561+86.25

CURVE PE-2B DATA
PI STA 202+35.18
Δ = 68° 04' 43" (RT)
D = 76° 23' 40"
R = 75.00'
T = 50.66'
L = 89.11'
E = 15.51'
PRC STA 201+84.51
PT STA 202+73.63

CURVE PE-2A DATA
PI STA 201+46.06
Δ = 68° 04' 43" (LT)
D = 76° 23' 40"
R = 75.00'
T = 50.66'
L = 89.11'
E = 15.51'
PC STA 200+95.40
PRC STA 201+84.51

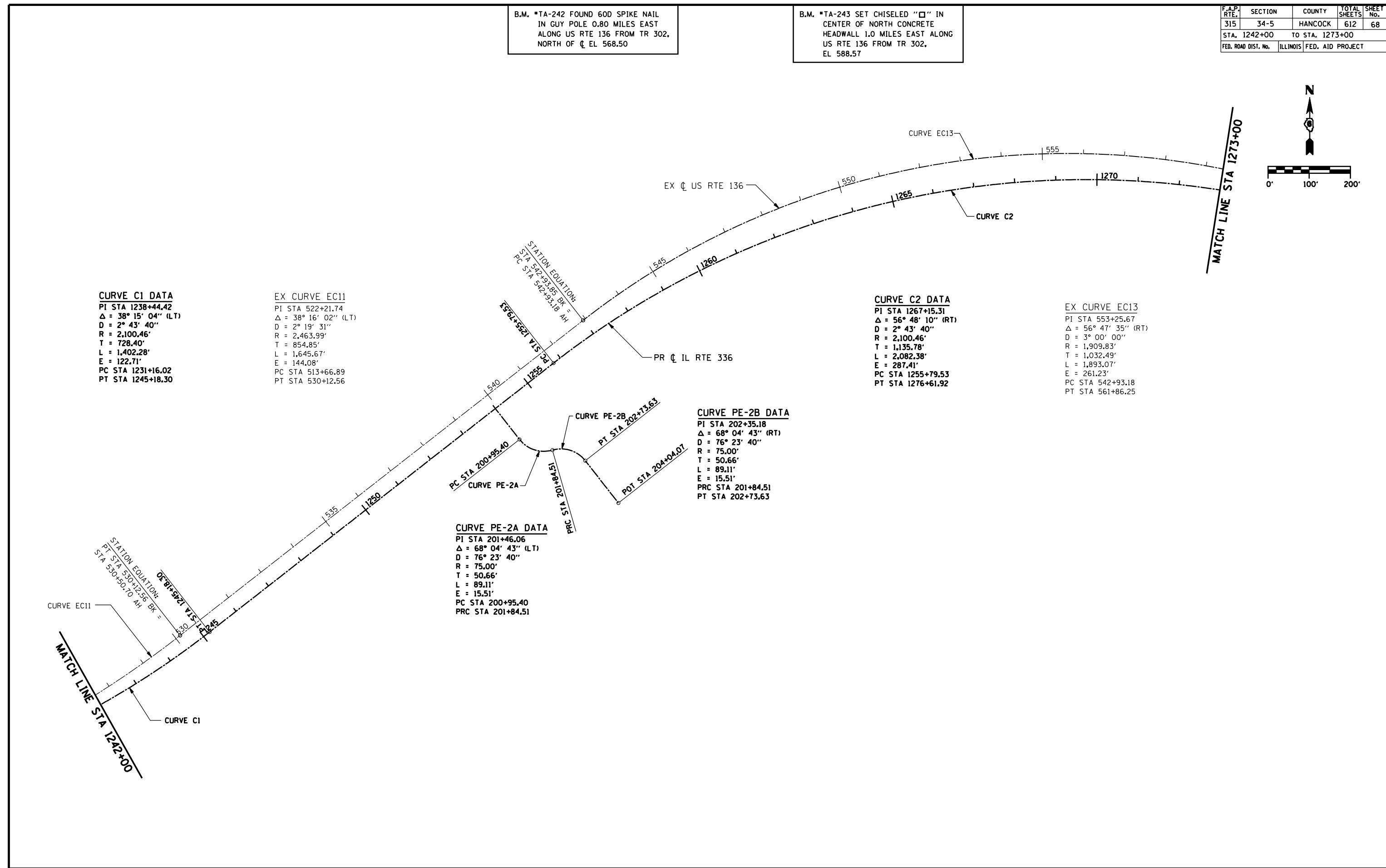

DGN-SPEC
DATE-TIME
*REF01