

F.A.P. RTE.	SECTION	COUNTY	TOTAL SHEETS	SHEET No.
315	34-5	HANCOCK	612	70
STA. 1332+00 TO STA. 1363+00				
FED. ROAD DIST. No. ILLINOIS FED. AID PROJECT				

2.40 B.M. *TA-249 SET CHISELED "□"
IN CENTER OF NORTH CONCRETE
EXTENSION FOR CULVERT
2.40 MILES EAST ALONG US RTE
136 FROM TR 302, EL 548.60

B.M. *TA-250 TOP OF R.O.W. MARKER
2.65 MILES EAST ALONG US RTE
136 FROM TR 302, NORTH OF C
EL 586.73

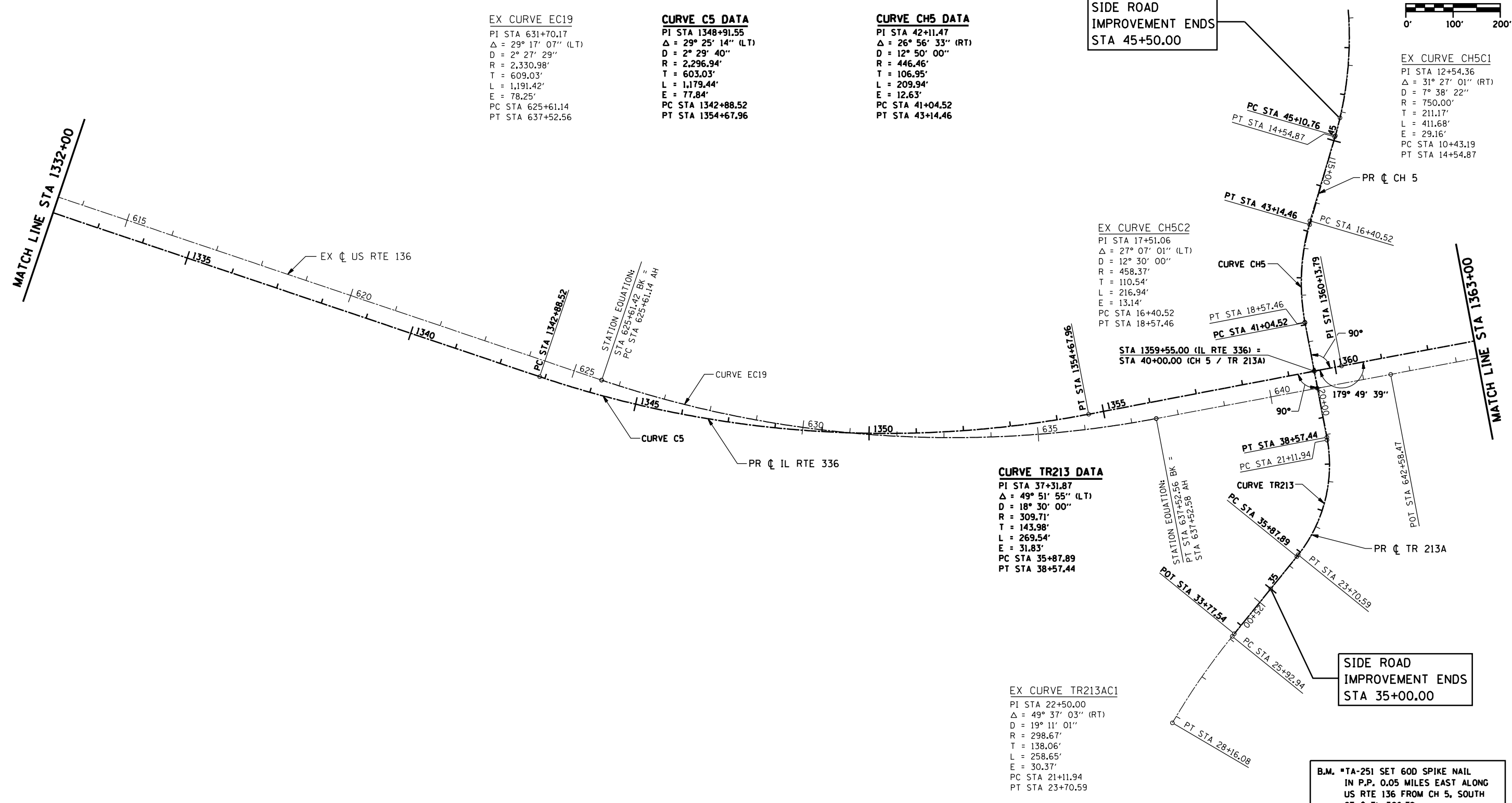
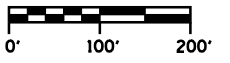

EX CURVE EC19
PI STA 631+70.17
 $\Delta = 29^\circ 17' 07''$ (LT)
D = 2° 27' 29"
R = 2,330.98'
T = 609.03'
L = 1,191.42'
E = 78.25'
PC STA 625+61.14
PT STA 637+52.56

CURVE C5 DATA
PI STA 1348+91.55
 $\Delta = 29^\circ 25' 14''$ (LT)
D = 2° 29' 40"
R = 2,296.94'
T = 603.03'
L = 1,179.44'
E = 77.84'
PC STA 1342+88.52
PT STA 1354+67.96

CURVE CH5 DATA
PI STA 42+11.47
 $\Delta = 26^\circ 56' 33''$ (RT)
D = 12° 50' 00"
R = 446.46'
T = 106.95'
L = 209.94'
E = 12.63'
PC STA 41+04.52
PT STA 43+14.46

SIDE ROAD
IMPROVEMENT ENDS
STA 45+50.00

EX CURVE CH5C1
PI STA 12+54.36
 $\Delta = 31^\circ 27' 01''$ (RT)
D = 7° 38' 22"
R = 750.00'
T = 211.17'
L = 411.68'
E = 29.16'
PC STA 10+43.19
PT STA 14+54.87

EX CURVE CH5C2
PI STA 17+51.06
 $\Delta = 27^\circ 07' 01''$ (LT)
D = 12° 30' 00"
R = 458.37'
T = 110.54'
L = 216.94'
E = 13.14'
PC STA 16+40.52
PT STA 18+57.46

STA 1359+55.00 (IL RTE 336) =
STA 40+00.00 (CH 5 / TR 213A)

CURVE TR213 DATA
PI STA 37+31.87
 $\Delta = 49^\circ 51' 55''$ (LT)
D = 18° 30' 00"
R = 309.71'
T = 143.98'
L = 269.54'
E = 31.83'
PC STA 35+87.89
PT STA 38+57.44

EX CURVE TR213AC1
PI STA 22+50.00
 $\Delta = 49^\circ 37' 03''$ (RT)
D = 19° 11' 01"
R = 298.67'
T = 138.06'
L = 258.65'
E = 30.37'
PC STA 21+11.94
PT STA 23+70.59

SIDE ROAD
IMPROVEMENT ENDS
STA 35+00.00

B.M. *TA-251 SET 60D SPIKE NAIL
IN P.P. 0.05 MILES EAST ALONG
US RTE 136 FROM CH 5, SOUTH
OF C EL 596.39

DGN-SPEC
DATE-TIME
*REF01

D6 PROJECT: FILE: