

F.A.P. RTE.	SECTION	COUNTY	TOTAL SHEETS	SHEET No.
315	34-5	HANCOCK	612	71
STA. 1363+00		TO STA. 1393+00		
FED. ROAD DIST. No.		ILLINOIS	FED. AID PROJECT	

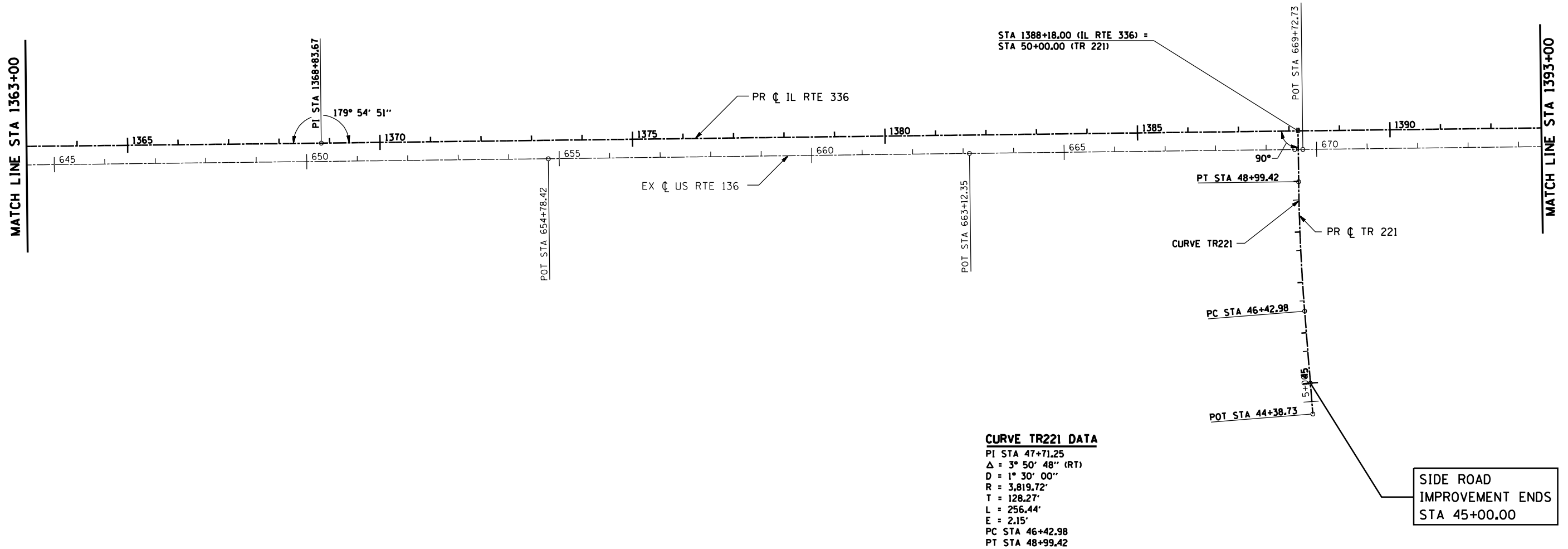
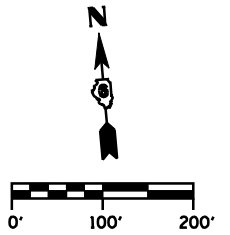

CURVE TR221 DATA
 PI STA 47+71.25
 $\Delta = 3^\circ 50' 48''$ (RT)
 $D = 1^\circ 30' 00''$
 $R = 3,819.72'$
 $T = 128.27'$
 $L = 256.44'$
 $E = 2.15'$
 PC STA 46+42.98
 PT STA 48+99.42

SIDE ROAD
 IMPROVEMENT ENDS
 STA 45+00.00

DGN-SPEC
 DATE-TIME
 *REF01

B.M. *TA-252 SET RR SPIKE P.P.
 0.20 MILES EAST ALONG US RTE
 136 FROM CH 5, SOUTH OF CL
 EL 575.09

B.M. *TA-253 SET 60D SPIKE NAIL IN
 P.P. 0.45 MILES EAST ALONG
 US RTE 136 FROM CH 5, SOUTH
 OF CL EL 526.21

B.M. *TA-254 SET CHISELED "C" IN
 CENTER OF SOUTH CONCRETE
 HEADWALL SE CORNER JCT.
 US RTE 136 & TR 3000 E, EL 527.87