

F.A.P. RTE.	SECTION	COUNTY	TOTAL SHEETS	SHEET No.
315	34-5	HANCOCK	612	77
STA. 1153+00		TO STA. 1167+00		
FED. ROAD DIST. No.	ILLINOIS	FED. AID PROJECT		

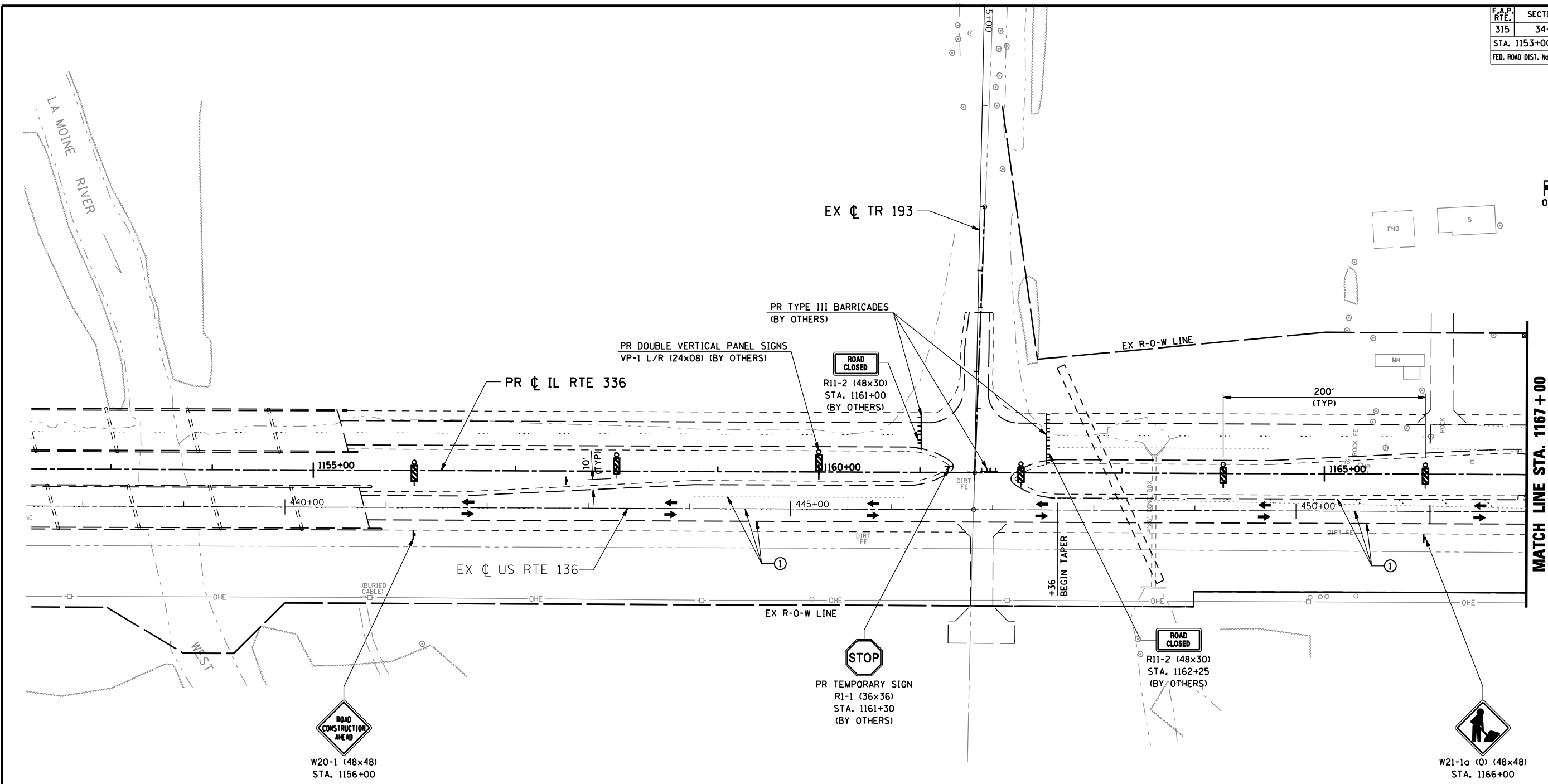
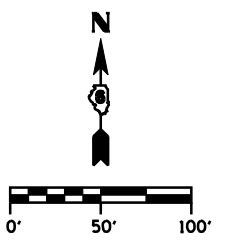

LEGEND

- DIRECTION OF TRAFFIC
- TT TYPE III BARRICADE W/ PROPER ROAD CLOSURE SIGNS
- ~ PERMANENT ROADWAY DITCH FLOW
- TEMPORARY STAGE DITCH FLOW
- - - EXISTING ROADWAY DITCH FLOW
- | Z Z | STAGE CONSTRUCTION LIMITS
- █ STAGE CONSTRUCTION
- XXXXX REMOVAL
- ① EXISTING PAVEMENT MARKING
- ② TEMP PAINT PAVEMENT MARKING - LINE 5"
- ③ TEMP PAINT PAVEMENT MARKING - LINE 6"
- ④ TEMP PAINT PAVEMENT MARKING - LINE 12"
- ⑤ TEMP PAINT PAVEMENT MARKING - LINE 24"
- ⑥ TEMP PAINT PAVEMENT MARKING - LETTERS & SYMBOLS

PR TRAFFIC CONTROL & PROTECTION (BY OTHERS)
 NOTE: PROVIDE ADVANCE "ROAD CONSTRUCTION AHEAD" SIGN IN ACCORDANCE WITH STANDARD 701011, IF NOT PROVIDED BY OTHER CONTRACTOR.

REVISIONS	
NAME	DATE

ILLINOIS DEPARTMENT OF TRANSPORTATION
MAINTENANCE OF TRAFFIC
IL RTE 336 (STAGE 1)
STA. 1153+00 TO STA. 1167+00
 SCALE: DATE: MARCH 10, 2006
 DRAWN BY: RG
 CHECKED BY: JAC

•DGN-SPEC•
 •DATE-TIME•
 •REF01