

F.A.P. RTE.	SECTION	COUNTY	TOTAL SHEETS	SHEET No.
315	34-5	HANCOCK	612	105
STA. 1231+50		TO STA. 1244+00		
FED. ROAD DIST. No.		ILLINOIS	FED. AID PROJECT	

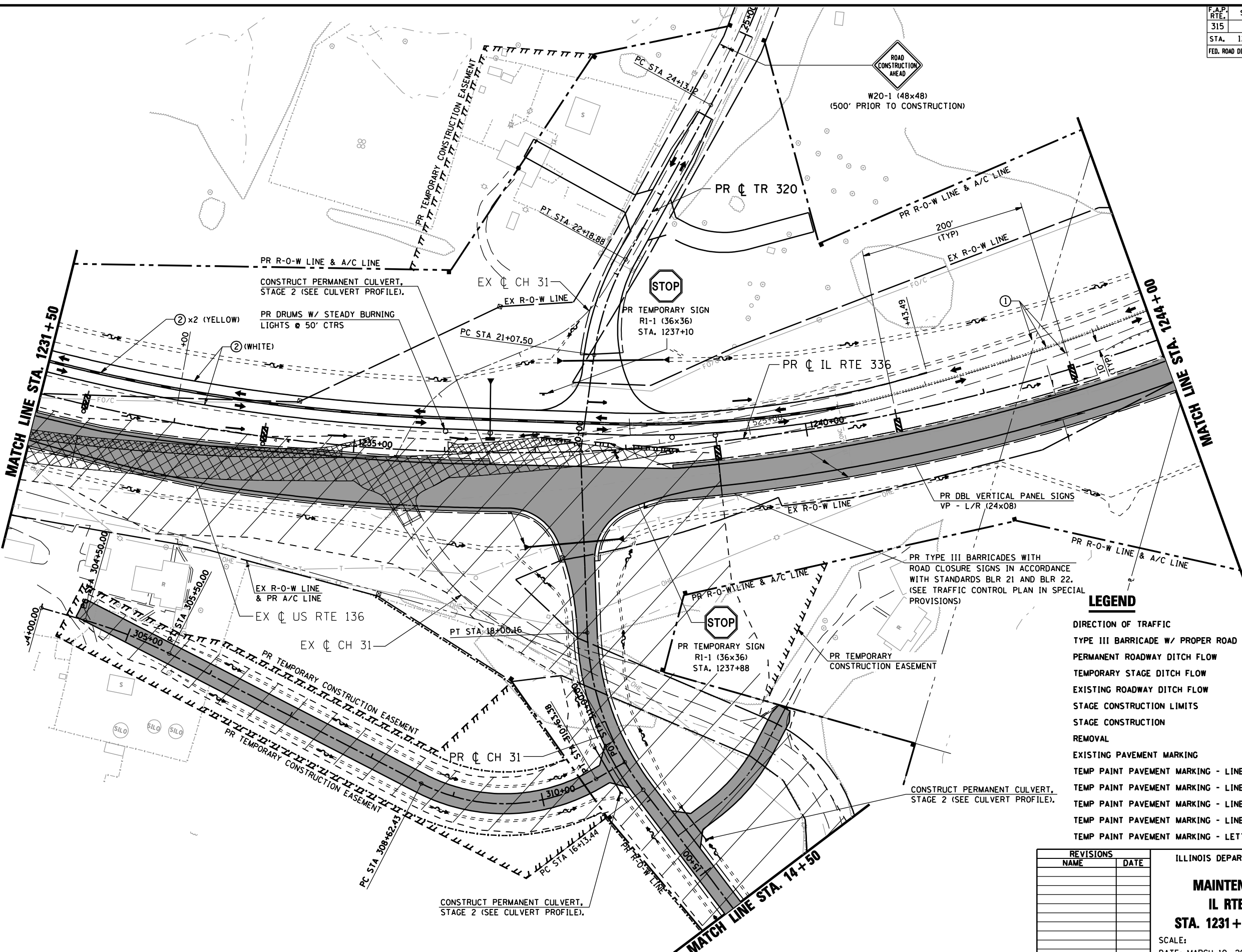
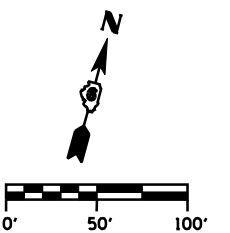

LEGEND

- DIRECTION OF TRAFFIC
- TYPE III BARRICADE W/ PROPER ROAD CLOSURE SIGNS
- PERMANENT ROADWAY DITCH FLOW
- TEMPORARY STAGE DITCH FLOW
- EXISTING ROADWAY DITCH FLOW
- STAGE CONSTRUCTION LIMITS
- STAGE CONSTRUCTION
- REMOVAL
- EXISTING PAVEMENT MARKING
- TEMP PAINT PAVEMENT MARKING - LINE 5"
- TEMP PAINT PAVEMENT MARKING - LINE 6"
- TEMP PAINT PAVEMENT MARKING - LINE 12"
- TEMP PAINT PAVEMENT MARKING - LINE 24"
- TEMP PAINT PAVEMENT MARKING - LETTERS & SYMBOLS

REVISIONS	
NAME	DATE

ILLINOIS DEPARTMENT OF TRANSPORTATION
MAINTENANCE OF TRAFFIC
IL RTE 336 (STAGE 2)
STA. 1231+50 TO STA. 1244+00
 SCALE: DATE: MARCH 10, 2006
 DRAWN BY: RG
 CHECKED BY: JAC

DGN-SPEC
 DATE-TIME
 *REF01