

| F.A.P. RTE.         | SECTION  | COUNTY           | TOTAL SHEETS | SHEET No. |
|---------------------|----------|------------------|--------------|-----------|
| 315                 | 34-5     | HANCOCK          | 612          | 129       |
| STA. 1244+00        |          | TO STA. 1256+00  |              |           |
| FED. ROAD DIST. No. | ILLINOIS | FED. AID PROJECT |              |           |

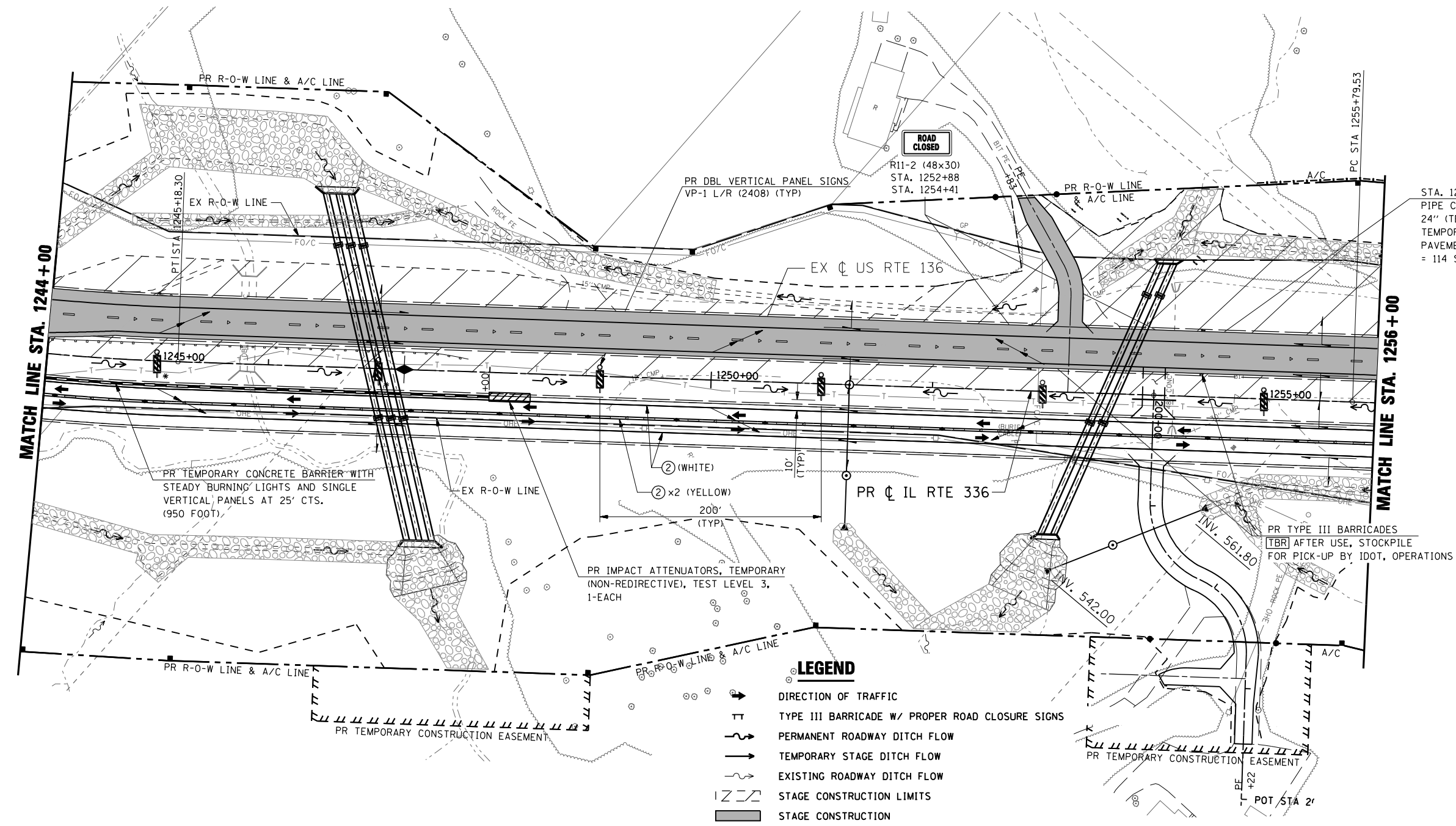
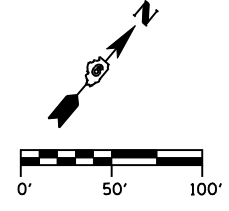

STA. 1254+00  
 PIPE CULVERTS, CL D, TY 2  
 24" (TEMPORARY) x 60'  
 TEMPORARY CONNECTOR  
 PAVEMENT (AGGREGATE)  
 = 114 SQ YD

- LEGEND**
- ➔ DIRECTION OF TRAFFIC
  - TT TYPE III BARRICADE W/ PROPER ROAD CLOSURE SIGNS
  - ~ PERMANENT ROADWAY DITCH FLOW
  - TEMPORARY STAGE DITCH FLOW
  - ~ EXISTING ROADWAY DITCH FLOW
  - STAGE CONSTRUCTION LIMITS
  - █ STAGE CONSTRUCTION
  - ⊗ REMOVAL
  - ① EXISTING PAVEMENT MARKING
  - ② TEMP PAINT PAVEMENT MARKING - LINE 5"
  - ③ TEMP PAINT PAVEMENT MARKING - LINE 6"
  - ④ TEMP PAINT PAVEMENT MARKING - LINE 12"
  - ⑤ TEMP PAINT PAVEMENT MARKING - LINE 24"
  - ⑥ TEMP PAINT PAVEMENT MARKING - LETTERS & SYMBOLS

\* INSTALL AFTER EMBANKMENT IS COMPLETED  
 (NO SIDE OF THE ROAD HAZARDS EXISTS),  
 THEN REMOVE CONCRETE BARRIER AND IMPACT  
 ATTENUATORS.

| REVISIONS |      |
|-----------|------|
| NAME      | DATE |
|           |      |
|           |      |
|           |      |
|           |      |
|           |      |
|           |      |
|           |      |
|           |      |
|           |      |
|           |      |

ILLINOIS DEPARTMENT OF TRANSPORTATION  
**MAINTENANCE OF TRAFFIC**  
**IL 336 (STAGE 3)**  
**STA. 1244+00 TO STA. 1256+00**  
 SCALE: DATE: MARCH 10, 2006  
 DRAWN BY: RG  
 CHECKED BY: JAC

•DGN: SPEC•  
 •DATE: TIME•  
 •REF: 01