

F.A.P. RTE.	SECTION	COUNTY	TOTAL SHEETS	SHEET No.
315	34-5	HANCOCK	612	168
STA. 1284+00 TO STA. 1297+00				
FED. ROAD DIST. No.		ILLINOIS	FED. AID PROJECT	

NW 1/4, SW 1/4, SEC. 15 T5N R5W

NE 1/4, SW 1/4, SEC. 15 T5N R5W

WHITE, ELEANOR L TR
PARCEL NO. 6033117

WHITE, ELEANOR L TR
PARCEL NO. 6033117

WHITE, ELEANOR L TR
PARCEL NO. 6033117

WHITE, ELEANOR L TR
PARCEL NO. 6033114

CLAYBURN, PATSY P, CRAIG A,
WARREN E & CLINE, JODI L
PARCEL NO. 6033119

WHITE, ELEANOR L TR
PARCEL NO. 6033114

GRAY, BRITTEN JR

CURVE C3 DATA

PI STA 1293+06.01
Δ = 16° 17' 26" (RT)
D = 2° 43' 40"
R = 2,100.46'
T = 300.63'
L = 597.21'
E = 21.41'
e = 0.067'
T.R. = 39'
S.E. RUN = 270'
PC STA 1290+05.38
PT STA 1296+02.59
WEST BOUND S.E. ATTAINED FROM STA 1287+86.38 TO 1290+95.38
WEST BOUND S.E. REMOVED FROM STA 1295+12.59 TO 1298+21.59
SEE "SUPPLEMENTAL DETAILS" FOR EAST BOUND LAYOUT AND S.E. TRANSITIONS

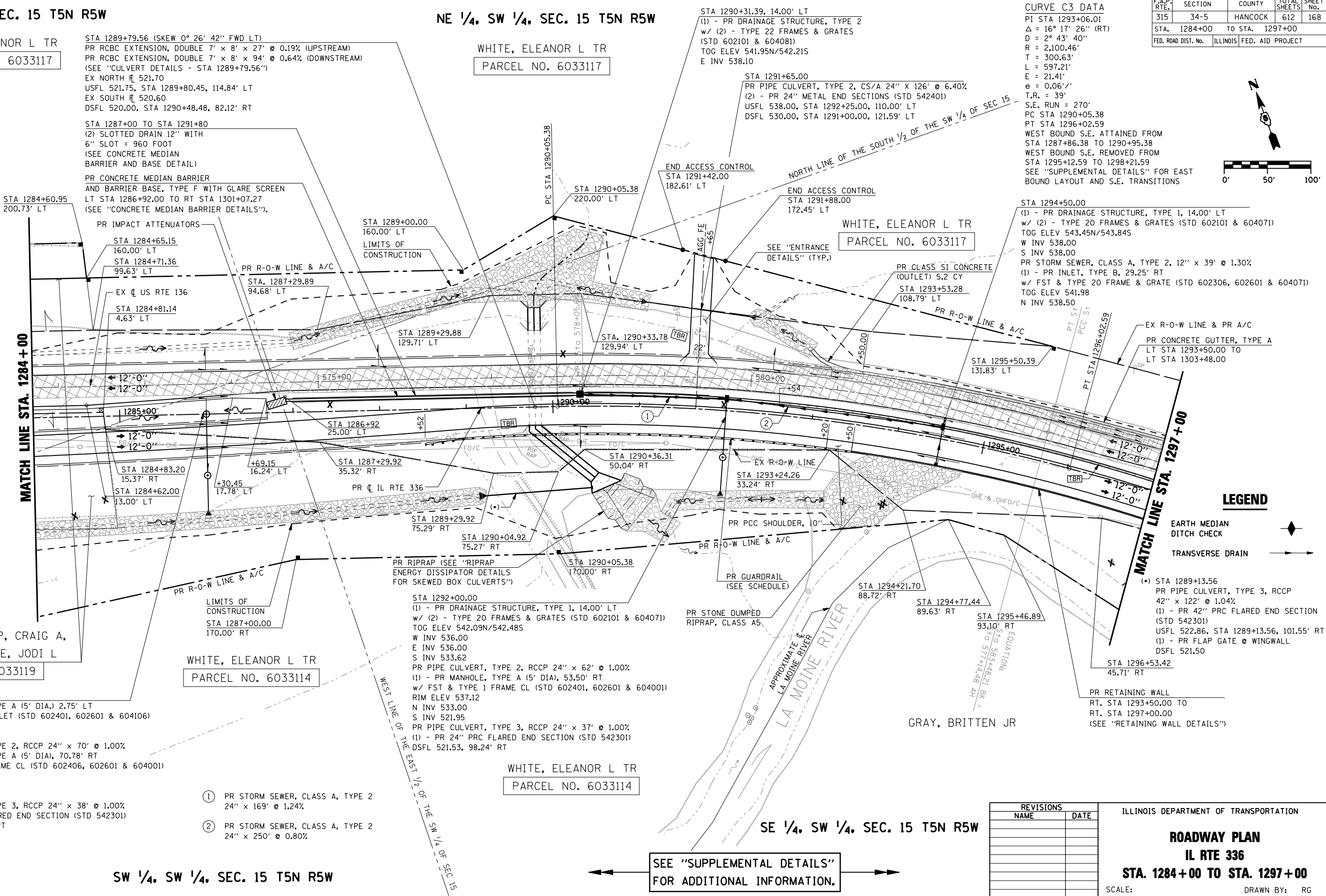
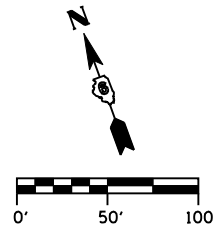

LEGEND

- EARTH MEDIAN
- DITCH CHECK
- TRANSVERSE DRAIN

- (*) STA 1289+13.56
PR PIPE CULVERT, TYPE 3, RCCP 42" x 122" @ 1.04%
- (1) - PR 42" PRC FLARED END SECTION (STD 542301)
USFL 522.86, STA 1289+13.56, 101.55' RT
(1) - PR FLAP GATE @ WINGWALL
DSFL 521.50

STA 1286+00.00
(1) - PR MANHOLE, TYPE A (5' DIA.) 2.75' LT
W/FST AND MEDIAN INLET (STD 602401, 602601 & 604106)
TOG ELEV 542.05
S INV 536.74
PR PIPE CULVERT, TYPE 2, RCCP 24" x 70" @ 1.00%
(1) - PR MANHOLE, TYPE A (5' DIA), 70.78' RT
W/ FST & TYPE 1 FRAME CL (STD 602406, 602601 & 604001)
RIM ELEV 539.85
N INV 536.03
S INV 524.37
PR PIPE CULVERT, TYPE 3, RCCP 24" x 38" @ 1.00%
(1) - PR 24" PRC FLARED END SECTION (STD 542301)
DSFL 523.93, 116.72' RT

- ① PR STORM SEWER, CLASS A, TYPE 2 24" x 169" @ 1.24%
- ② PR STORM SEWER, CLASS A, TYPE 2 24" x 250" @ 0.80%

STA 1292+00.00
(1) - PR DRAINAGE STRUCTURE, TYPE 1, 14.00' LT
W/ (2) - TYPE 20 FRAMES & GRATES (STD 602101 & 604071)
TOG ELEV 542.09N/542.48S
W INV 536.00
E INV 536.00
S INV 533.62
PR PIPE CULVERT, TYPE 2, RCCP 24" x 62" @ 1.00%
(1) - PR MANHOLE, TYPE A (5' DIA), 53.50' RT
W/ FST & TYPE 1 FRAME CL (STD 602401, 602601 & 604001)
RIM ELEV 537.12
N INV 533.00
S INV 521.95
PR PIPE CULVERT, TYPE 3, RCCP 24" x 37" @ 1.00%
(1) - PR 24" PRC FLARED END SECTION (STD 542301)
DSFL 521.53, 98.24' RT

STA 1290+31.39, 14.00' LT
(1) - PR DRAINAGE STRUCTURE, TYPE 2
W/ (2) - TYPE 22 FRAMES & GRATES (STD 602101 & 604081)
TOG ELEV 541.95N/542.21S
E INV 538.10

STA 1291+65.00
PR PIPE CULVERT, TYPE 2, CS/A 24" x 126" @ 6.40%
(2) - PR 24" METAL END SECTIONS (STD 542401)
USFL 538.00, STA 1292+25.00, 110.00' LT
DSFL 530.00, STA 1291+00.00, 121.59' LT

STA 1294+50.00
(1) - PR DRAINAGE STRUCTURE, TYPE 1, 14.00' LT
W/ (2) - TYPE 20 FRAMES & GRATES (STD 602101 & 604071)
TOG ELEV 543.45N/543.84S
W INV 538.00
S INV 538.00
PR STORM SEWER, CLASS A, TYPE 2, 12" x 39" @ 1.30%
(1) - PR INLET, TYPE B, 29.25' RT
W/ FST & TYPE 20 FRAME & GRATE (STD 602306, 602601 & 604071)
TOG ELEV 541.98
N INV 538.50

STA 1295+46.89
93.10' RT
EQUATION:
Sta 583+48.21 BK =
Sta 577+14.48 AH

SEE "SUPPLEMENTAL DETAILS"
FOR ADDITIONAL INFORMATION.

REVISIONS	
NAME	DATE

ILLINOIS DEPARTMENT OF TRANSPORTATION
ROADWAY PLAN
IL RTE 336
STA. 1284+00 TO STA. 1297+00
SCALE: DATE: MARCH 10, 2006
DRAWN BY: RG
CHECKED BY: JAC