

F.A.P. RTE.	SECTION	COUNTY	TOTAL SHEETS	SHEET No.
315	34-5	HANCOCK	612	199
STA.	N/A	TO STA.	N/A	
FED. ROAD DIST. No.	ILLINOIS	FED. AID PROJECT		

CURVE TR320 DATA

PI STA. 21+63.82
 $\Delta = 20^\circ 55' 18''$ (RT)
 $D = 18^\circ 47' 08''$
 $R = 305.00'$
 $T = 56.31'$
 $L = 111.37'$
 $E = 5.15'$
 $e = 0.041'$
 $T.R. = 27'$
 $S.E. RUN = 73'$
 PC STA. 21+07.50
 PT STA. 22+18.88

CONTROL POINTS	
(A)	STA. 1236+00.00, 49.00' LT (IL RTE 336)
(B)	STA. 1237+17.54, 62.40' LT (IL RTE 336)
(C)	STA. 21+02.42, 11.00' LT (TR 320)
(D)	STA. 22+18.88, 11.00' LT (TR 320)
(E)	STA. 1236+50.00, 25.00' LT (IL RTE 336)
(F)	STA. 1236+92.75, 12.35' LT (IL RTE 336)

CONTROL POINTS	
(G)	STA. 22+18.88, 11.00' RT (TR 320)
(H)	STA. 21+13.63, 27.62' RT (TR 320)
(I)	STA. 1238+51.85, 61.00' LT (IL RTE 336)
(J)	STA. 1238+07.49, 0.35' LT (IL RTE 336)
(K)	STA. 1238+50.00, 13.00' LT (IL RTE 336)

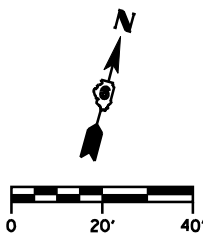

CURVE C1 DATA

PI STA. 1238+44.42
 $\Delta = 38^\circ 15' 04''$ (LT)
 $D = 2^\circ 43' 40''$
 $R = 2,100.46'$
 $T = 728.40'$
 $L = 1,402.28'$
 $E = 122.71'$
 $e = 0.061'$
 $T.R. = 39'$
 $S.E. RUN = 270'$
 PC STA. 1231+16.02
 PT STA. 1245+18.30
 S.E. ATTAINED FROM STA. 1228+97.02 TO 1232+06.02
 S.E. REMOVED FROM STA. 1244+28.30 TO 1247+37.30

PR ϕ IL RTE 336

PR ϕ TR 320

PR 2 CC
 50' - 400'
 OFFSET = 12.0'

PR 2 CC
 50' - 150'
 OFFSET = 13.3'

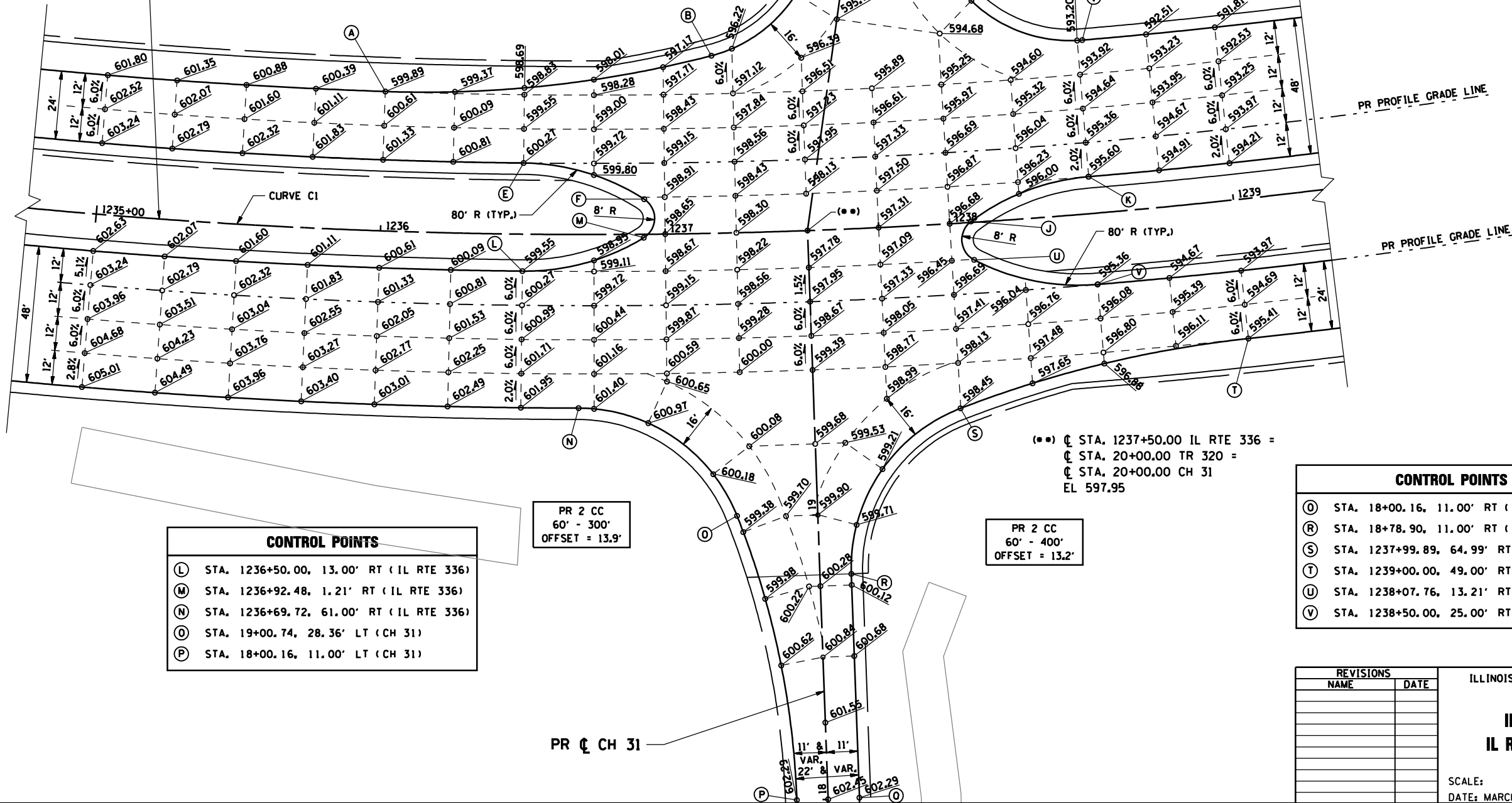

CONTROL POINTS	
(L)	STA. 1236+50.00, 13.00' RT (IL RTE 336)
(M)	STA. 1236+92.48, 1.21' RT (IL RTE 336)
(N)	STA. 1236+69.72, 61.00' RT (IL RTE 336)
(O)	STA. 19+00.74, 28.36' LT (CH 31)
(P)	STA. 18+00.16, 11.00' LT (CH 31)

CONTROL POINTS	
(Q)	STA. 18+00.16, 11.00' RT (CH 31)
(R)	STA. 18+78.90, 11.00' RT (CH 31)
(S)	STA. 1237+99.89, 64.99' RT (IL RTE 336)
(T)	STA. 1239+00.00, 49.00' RT (IL RTE 336)
(U)	STA. 1238+07.76, 13.21' RT (IL RTE 336)
(V)	STA. 1238+50.00, 25.00' RT (IL RTE 336)

(**)
 ϕ STA. 1237+50.00 IL RTE 336 =
 ϕ STA. 20+00.00 TR 320 =
 ϕ STA. 20+00.00 CH 31
 EL 597.95

PR 2 CC
 60' - 300'
 OFFSET = 13.9'

PR 2 CC
 60' - 400'
 OFFSET = 13.2'

REVISIONS	
NAME	DATE

ILLINOIS DEPARTMENT OF TRANSPORTATION

INTERSECTION DETAILS
 IL RTE 336 / TR 320 / CH 31

SCALE:
 DATE: MARCH 10, 2006

DRAWN BY: RG
 CHECKED BY: JAC