

F.A.P. RTE.	SECTION	COUNTY	TOTAL SHEETS	SHEET No.
315	34-5	HANCOCK	612	201
STA. N/A		TO STA. N/A		
FED. ROAD DIST. No.	ILLINOIS	FED. AID PROJECT		

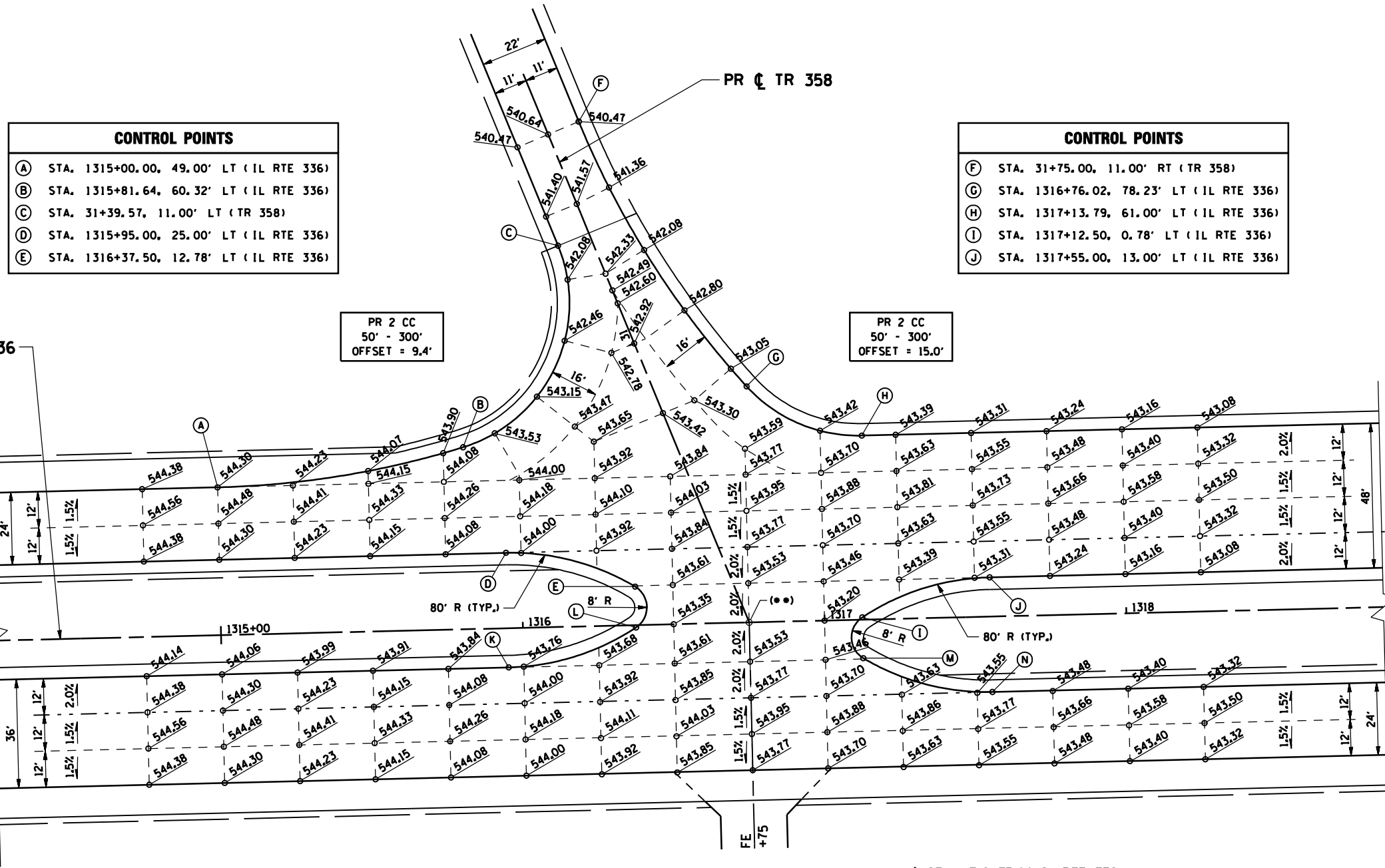
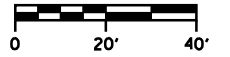

(A)	STA. 1315+00.00, 49.00' LT (IL RTE 336)
(B)	STA. 1315+81.64, 60.32' LT (IL RTE 336)
(C)	STA. 31+39.57, 11.00' LT (TR 358)
(D)	STA. 1315+95.00, 25.00' LT (IL RTE 336)
(E)	STA. 1316+37.50, 12.78' LT (IL RTE 336)

(F)	STA. 31+75.00, 11.00' RT (TR 358)
(G)	STA. 1316+76.02, 78.23' LT (IL RTE 336)
(H)	STA. 1317+13.79, 61.00' LT (IL RTE 336)
(I)	STA. 1317+12.50, 0.78' LT (IL RTE 336)
(J)	STA. 1317+55.00, 13.00' LT (IL RTE 336)

(K)	STA. 1315+95.00, 13.00' RT (IL RTE 336)
(L)	STA. 1316+37.50, 0.78' RT (IL RTE 336)
(M)	STA. 1317+12.50, 12.78' RT (IL RTE 336)
(N)	STA. 1317+55.00, 25.00' RT (IL RTE 336)

(••) CL STA. 1316+75.00 IL RTE 336 =
CL STA. 30+00.00 TR 358
EL 543.27

NAME	DATE

ILLINOIS DEPARTMENT OF TRANSPORTATION

INTERSECTION DETAILS
IL RTE 336 / TR 358

SCALE: DATE: MARCH 10, 2006

DRAWN BY: RG
CHECKED BY: JAC

DGN-SPEC
DATE-TIME
*REF01