

F.A.P. RTE.	SECTION	COUNTY	TOTAL SHEETS	SHEET No.
315	34-5	HANCOCK	612	203
STA. N/A		TO STA. N/A		
FED. ROAD DIST. No.		ILLINOIS FED. AID PROJECT		

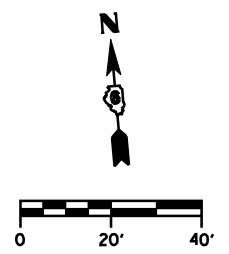

**CURVE CH5 DATA**

PI STA. 42+11.47  
 $\Delta = 26^\circ 56' 33''$  (RT)  
 D = 12° 50' 00"  
 R = 446.46'  
 T = 106.95'  
 L = 209.94'  
 E = 12.63'  
 $e = 0.37'$   
 T.R. = 27'  
 S.E. RUN = 67'  
 PC STA. 41+04.52  
 PT STA. 43+14.46

CONTROL POINTS	
(A)	STA. 1357+65.00, 49.00' LT (IL RTE 336)
(B)	STA. 1358+97.56, 63.83' LT (IL RTE 336)
(C)	STA. 41+19.90, 11.00' LT (CH 5)
(D)	STA. 1358+75.00, 25.00' LT (IL RTE 336)
(E)	STA. 1359+17.50, 12.78' LT (IL RTE 336)

CONTROL POINTS	
(F)	STA. 42+10.00, 14.77' RT (CH 5)
(G)	STA. 40+95.39, 30.84' RT (CH 5)
(H)	STA. 1360+33.03, 61.00' LT (IL RTE 336)
(I)	STA. 1360+17.50, 0.78' LT (IL RTE 336)
(J)	STA. 1360+60.00, 13.00' LT (IL RTE 336)

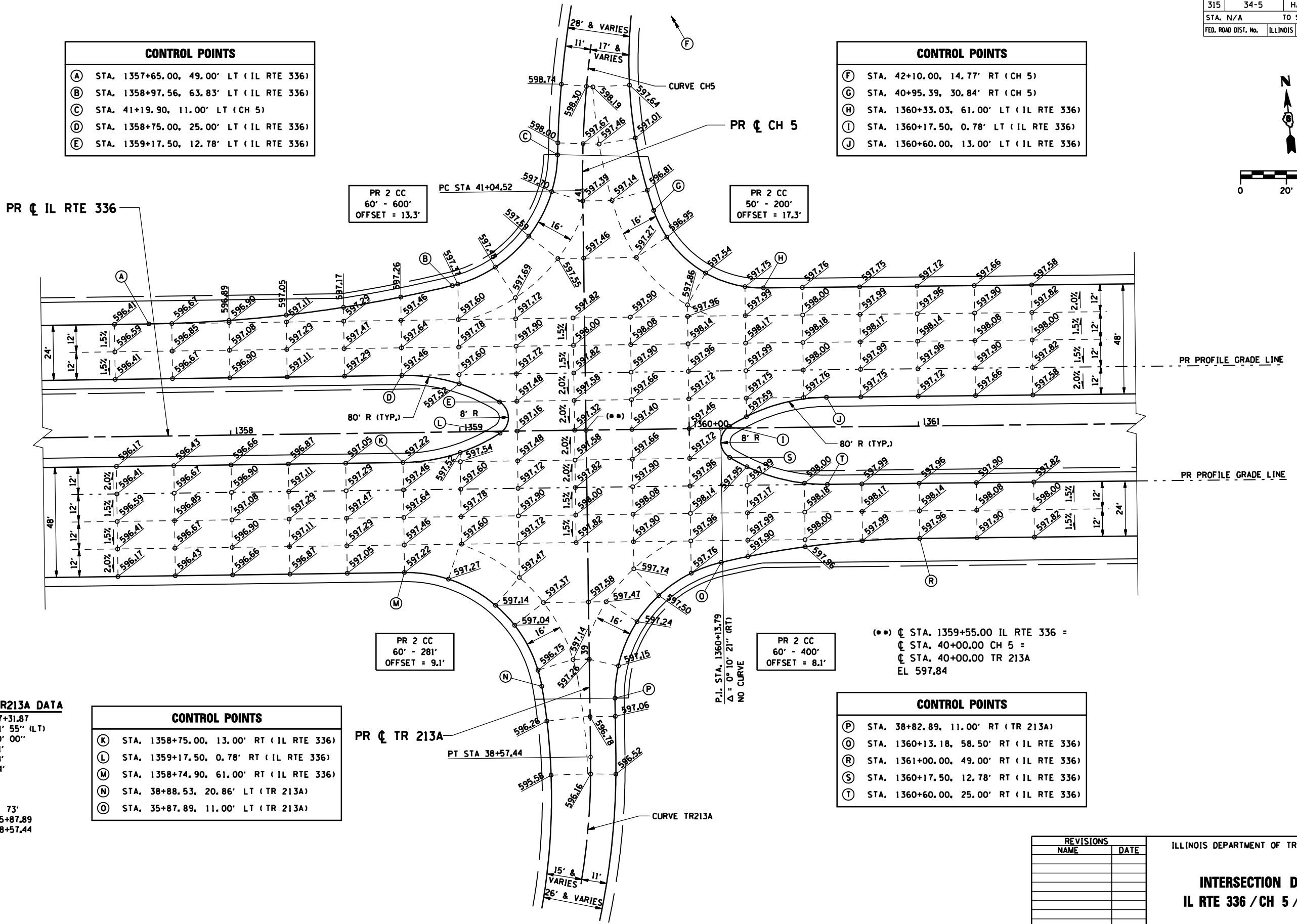

PI STA. 37+31.87  
 $\Delta = 49^\circ 51' 55''$  (LT)  
 D = 18° 30' 00"  
 R = 309.71'  
 T = 143.98'  
 L = 269.54'  
 E = 31.83'  
 $e = 4.0'$   
 T.R. = 27'  
 S.E. RUN = 73'  
 PC STA. 35+87.89  
 PT STA. 38+57.44

CONTROL POINTS	
(K)	STA. 1358+75.00, 13.00' RT (IL RTE 336)
(L)	STA. 1359+17.50, 0.78' RT (IL RTE 336)
(M)	STA. 1358+74.90, 61.00' RT (IL RTE 336)
(N)	STA. 38+88.53, 20.86' LT (TR 213A)
(O)	STA. 35+87.89, 11.00' LT (TR 213A)

CONTROL POINTS	
(P)	STA. 38+82.89, 11.00' RT (TR 213A)
(Q)	STA. 1360+13.18, 58.50' RT (IL RTE 336)
(R)	STA. 1361+00.00, 49.00' RT (IL RTE 336)
(S)	STA. 1360+17.50, 12.78' RT (IL RTE 336)
(T)	STA. 1360+60.00, 25.00' RT (IL RTE 336)

(\*\*\*) CL STA. 1359+55.00 IL RTE 336 =  
 CL STA. 40+00.00 CH 5 =  
 CL STA. 40+00.00 TR 213A  
 EL 597.84

REVISIONS	
NAME	DATE

ILLINOIS DEPARTMENT OF TRANSPORTATION

**INTERSECTION DETAILS  
 IL RTE 336 / CH 5 / TR 213A**

SCALE:  
 DATE: MARCH 10, 2006

DRAWN BY: RG  
 CHECKED BY: JAC