

F.A.P. RTE.	SECTION	COUNTY	TOTAL SHEETS	SHEET No.
315	34-5	HANCOCK	612	204
STA. N/A	TO STA. N/A			
FED. ROAD DIST. No.	ILLINOIS	FED. AID PROJECT		

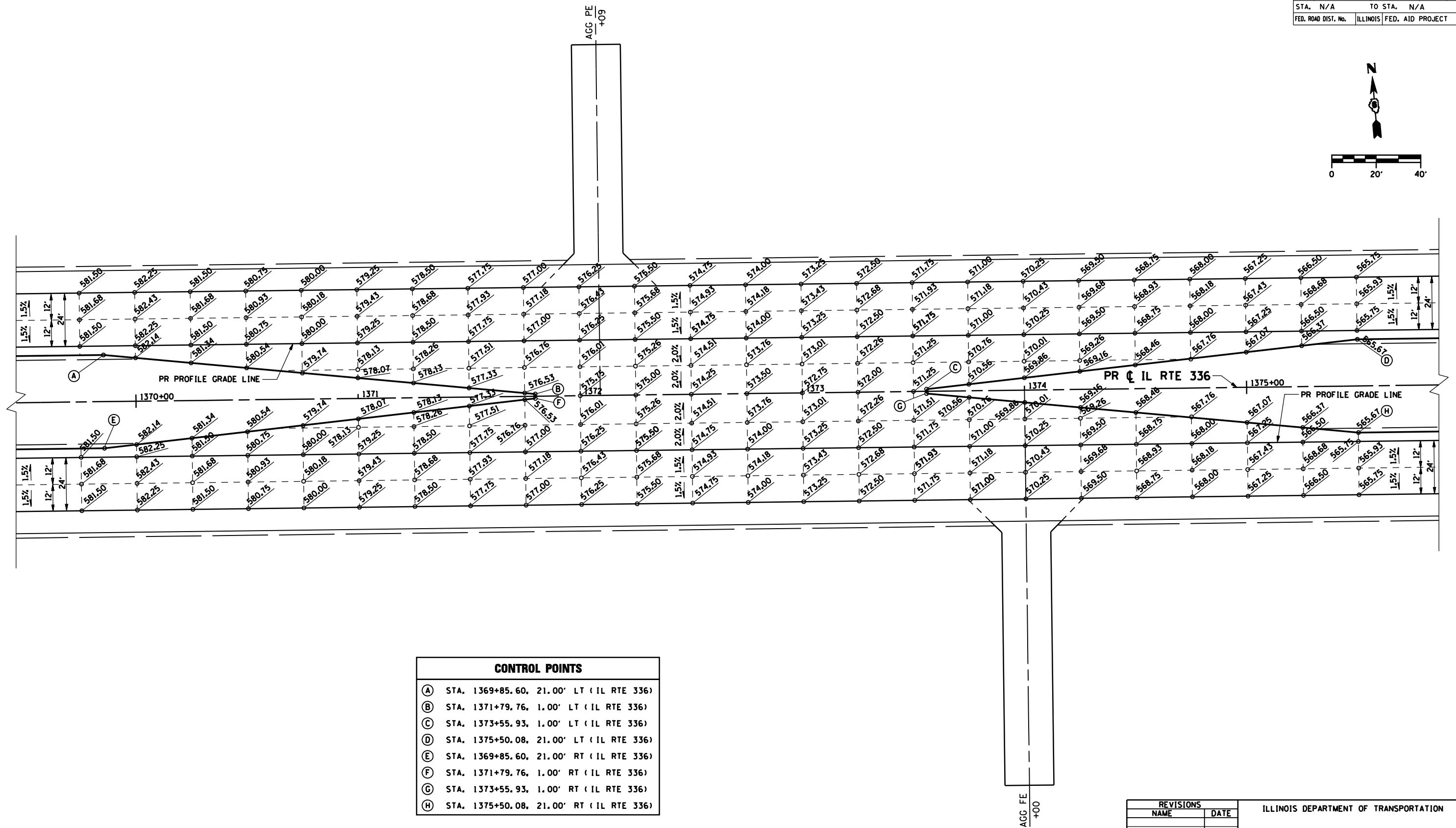
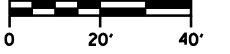

CONTROL POINTS	
(A)	STA. 1369+85.60, 21.00' LT (IL RTE 336)
(B)	STA. 1371+79.76, 1.00' LT (IL RTE 336)
(C)	STA. 1373+55.93, 1.00' LT (IL RTE 336)
(D)	STA. 1375+50.08, 21.00' LT (IL RTE 336)
(E)	STA. 1369+85.60, 21.00' RT (IL RTE 336)
(F)	STA. 1371+79.76, 1.00' RT (IL RTE 336)
(G)	STA. 1373+55.93, 1.00' RT (IL RTE 336)
(H)	STA. 1375+50.08, 21.00' RT (IL RTE 336)

REVISIONS	
NAME	DATE

ILLINOIS DEPARTMENT OF TRANSPORTATION

**INTERSECTION DETAILS**  
**IL RTE 336 / STA 1372+67.84**

SCALE: \_\_\_\_\_ DRAWN BY: RG  
 DATE: MARCH 10, 2006 CHECKED BY: JAC

\*DGN-SPEC\*  
 \*DATE-TIME\*  
 \*REF01

D6 PROJECT: FILE: .