

F.A.P. RTE.	SECTION	COUNTY	TOTAL SHEETS	SHEET No.
315	34-5	HANCOCK	612	207
STA.		TO STA.		
FED. ROAD DIST. No.	ILLINOIS	FED. AID PROJECT		

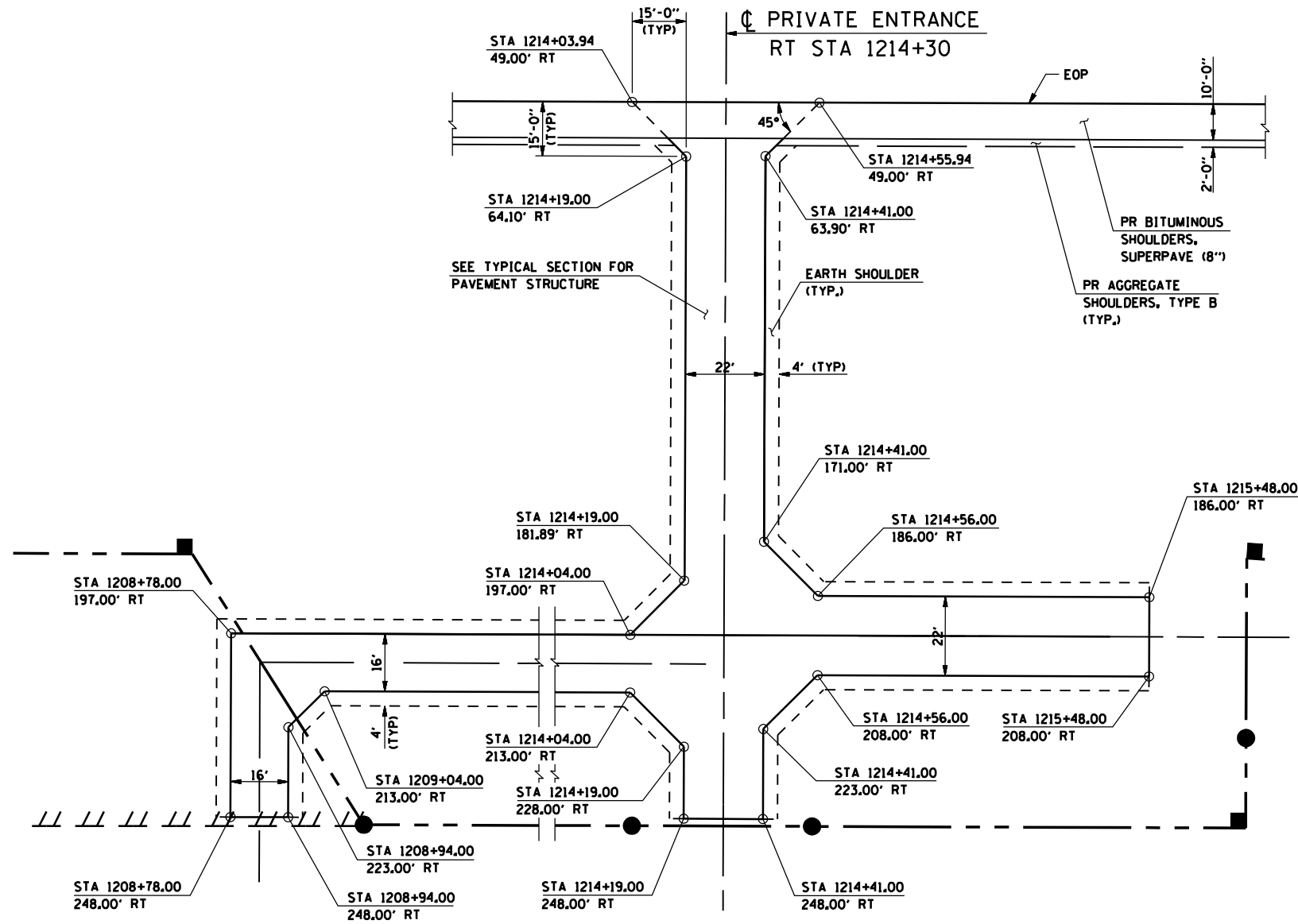

PLAN - PRIVATE ENTRANCE (PE)
RT STA 1214+30.00 (IL RTE 336)

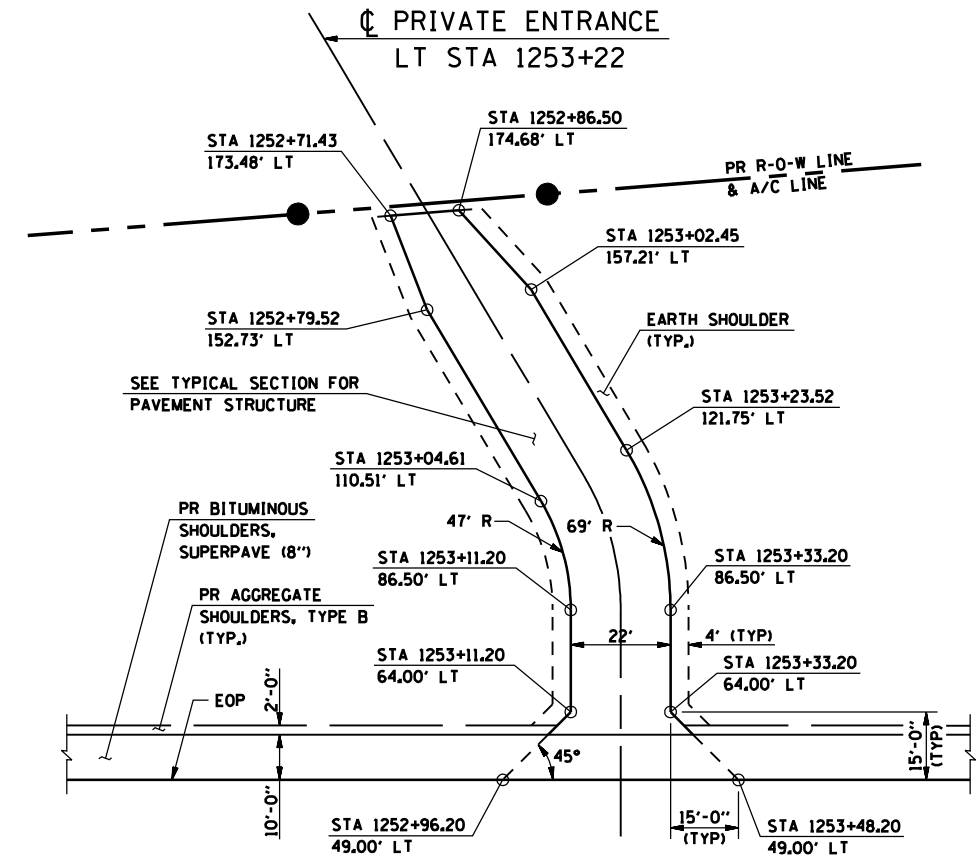

PLAN - PRIVATE ENTRANCE (PE)
LT STA 1253+22.00 (IL RTE 336)

•DGN-SPEC•
•DATE-TIME•
•REF01

D6 PROJECT: FILE:

REVISIONS	
NAME	DATE

ILLINOIS DEPARTMENT OF TRANSPORTATION

**ENTRANCE DETAILS
IL ROUTE 336**

SCALE:
DATE: MARCH 10, 2006

DRAWN BY: RG
CHECKED BY: JAC