

F.A.P. RTE.	SECTION	COUNTY	TOTAL SHEETS	SHEET No.
315	34-5	HANCOCK	612	223
STA. 1196+00		TO STA. 1208+00		
FED. ROAD DIST. No.	ILLINOIS	FED. AID PROJECT		

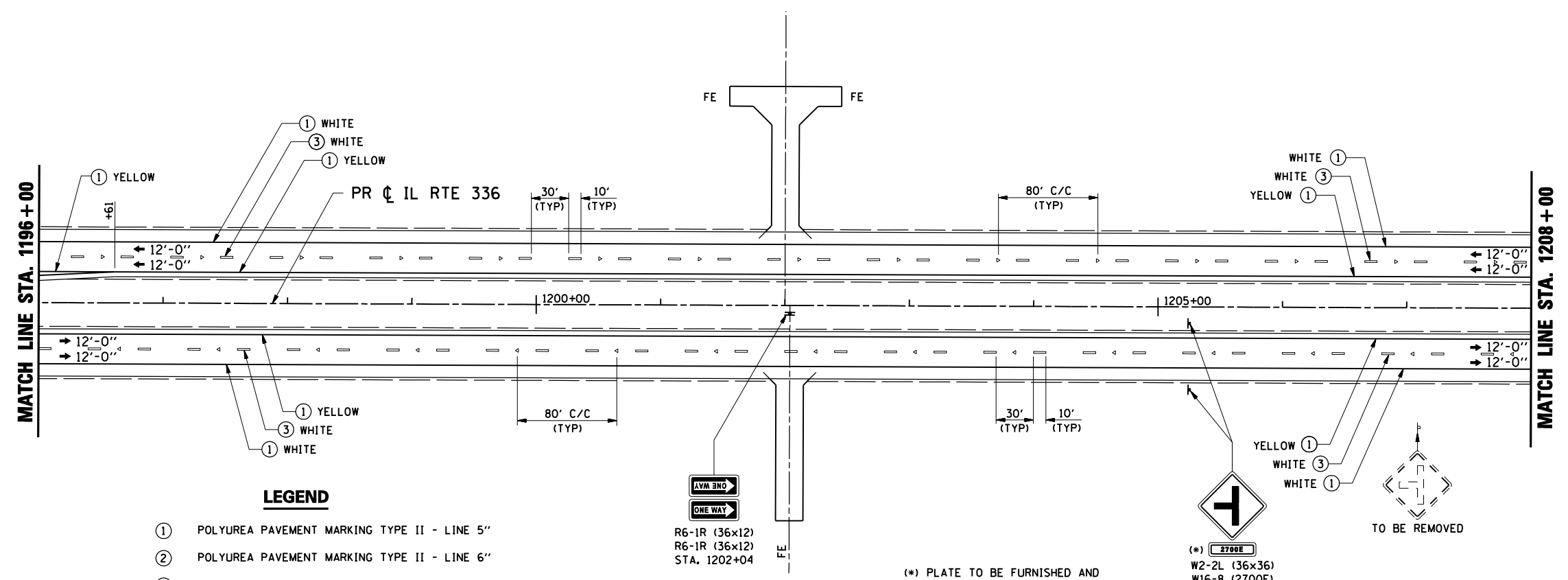

**LEGEND**

- ① POLYUREA PAVEMENT MARKING TYPE II - LINE 5"
- ② POLYUREA PAVEMENT MARKING TYPE II - LINE 6"
- ③ PREFORMED PLASTIC PAVEMENT MARKING, TYPE B - LINE 5"
- ④ PREFORMED PLASTIC PAVEMENT MARKING, TYPE B - LINE 24"
- ⑤ POLYUREA PAVEMENT MARKING, TYPE II - LETTERS & SYMBOLS
- ◁ RAISED REFLECTIVE PAVEMENT MARKER (ONE-WAY CRYSTAL)
- ◄ RAISED REFLECTIVE PAVEMENT MARKER (ONE-WAY AMBER)
- ◆ RAISED REFLECTIVE PAVEMENT MARKER (TWO-WAY AMBER)
- SIGN PANEL AND POST
- PERMANENT TYPE III BARRICADE

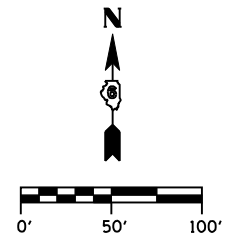
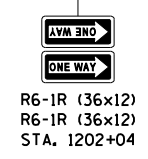

(\*) PLATE TO BE FURNISHED AND INSTALLED LATER BY DISTRICT SIGN SHOP.

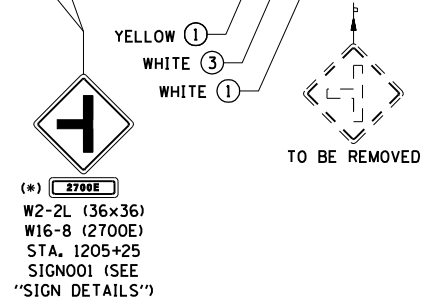

\*DGN-SPEC\*  
 \*DATE-TIME\*  
 \*REF01

D6 PROJECT: FILE:

REVISIONS	
NAME	DATE

ILLINOIS DEPARTMENT OF TRANSPORTATION  
**PAVEMENT MARKING & SIGNING PLAN**  
**IL RTE 336**  
**STA. 1196+00 TO STA. 1208+00**  
 SCALE: DATE: MARCH 10, 2006  
 DRAWN BY: RG  
 CHECKED BY: JAC