

Bench Mark: TA-245 chiseled "□" center of south concrete headwall of double box 1.45 miles east along US Route 136 from TR 2700 E., Elev. 529.90.

F.A.P. RTE.	SECTION	COUNTY	TOTAL SHEETS	SHEET NO.	SHEET NO. 1
315	34-5(5B)	HANCOCK	612	249	18 SHEETS

FED. ROAD DIST. NO. 7 ILLINOIS FED. AID PROJECT-
Contract No: 72682

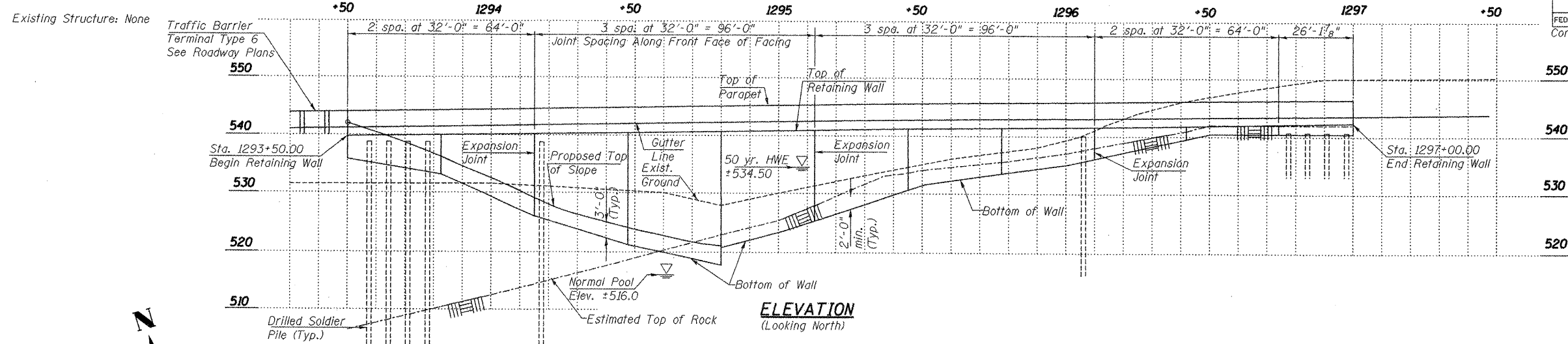

CURVE DATA

P.I. STA. 1293+06.01
 $\Delta = 16^\circ 17' 26''$ (RT.)
 $D = 2^\circ 43' 40''$
 $R = 2100.46'$
 $T = 300.63'$
 $L = 597.21'$
 $E = 21.41'$
 $e = 6.0\%$
 $T.R. = 39'$
 $S.E. RUN = 270'$
 P.C. STA. 1290+05.38
 P.T. STA. 1296+02.59

INDEX OF SHEETS

- 1 General Plan and Elevation
- 2 General Notes and Total Bill of Material
- 3-4 Retaining Wall Details
- 5-6 Soldier Pile Layout
- 7-8 C.I.P. Concrete Facing
- 9-11 Parapet and Anchorage Slab Details
- 12-18 Boring Logs and Rock Cores

LOADING

Equilvant Fluid Lateral
 Soil Pressure = 40 lb/ft²/ft
 (Wall Height)
 Live Load Surcharge =
 80 lb/ft²/ft Length of Wall

DESIGN SPECIFICATIONS

2002 AASHTO

DESIGN STRESSES

f_y Structural Steel = 36 ksi
 f_y Reinforcement = 60 ksi
 f'_c Concrete = 3.5 ksi (28 day)

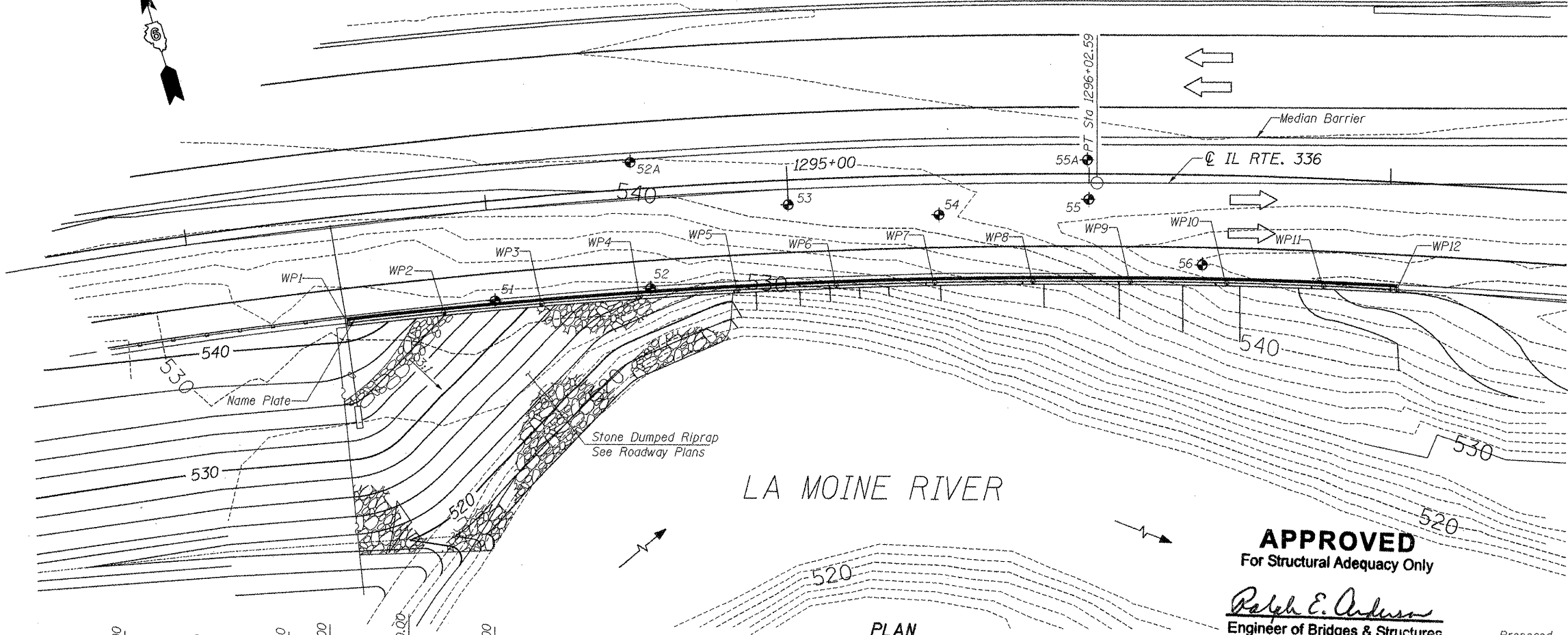

PLAN

APPROVED
 For Structural Adequacy Only

Ralph E. Anderson
 Engineer of Bridges & Structures

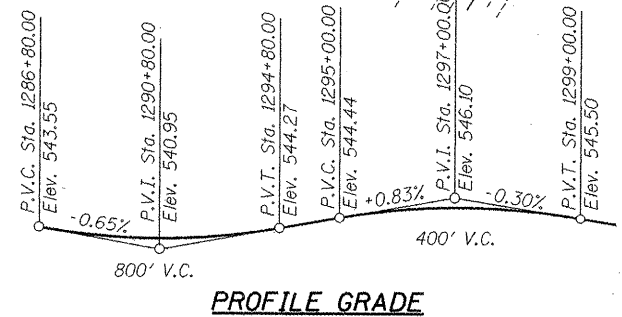

PROFILE GRADE

STA. 1293+50.00 TO 1297+00.00
 BUILT 20__ BY
 STATE OF ILLINOIS
 FAP ROUTE 315 SEC. 34-5(5B)
 STR. NO. 034-2521

NAME PLATE
 See Std. 515001

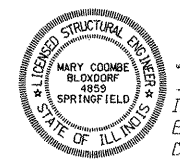

Mary Coombe Bloxdorf
 ILLINOIS STRUCTURAL NO. 4839
 EXPIRES: 11/30/06
 DATE: 5-3-06

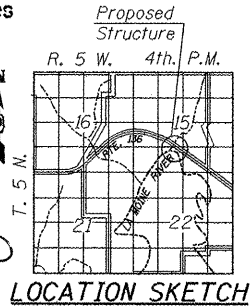

LOCATION SKETCH

ILLINOIS DEPARTMENT OF TRANSPORTATION	
SHEET TITLE GENERAL PLAN & ELEVATION	
PROJECT FAP ROUTE 315 (IL 336/US 136) SECTION 34-5(5B) HANCOCK COUNTY STA. 1293+50.00(R) TO STA. 1297+00.00(R) STRUCTURE NUMBER 034-2521	PROJECT NO. 02076-R SCALE DATE 12/22/05 DRAWN BY TFG CHECKED BY BD/MCB DRAWING NO.
COOMBE-BLOXDORF P.C. Engineers / Land Surveyors Springfield, Illinois Design Firm License No. 184-002703	
1	
OF 18 SHTS	