

ROUTE NO.	SECTION	COUNTY	TOTAL SHEETS	SHEET NO.
FAP 315	34-5(5B)	HANCOCK	612	275
FED. ROAD DIST. NO. 7	ILLINOIS	FED. AID PROJECT-		

SHEET NO. 5
7 SHEETS

CONTRACT NO. 72682

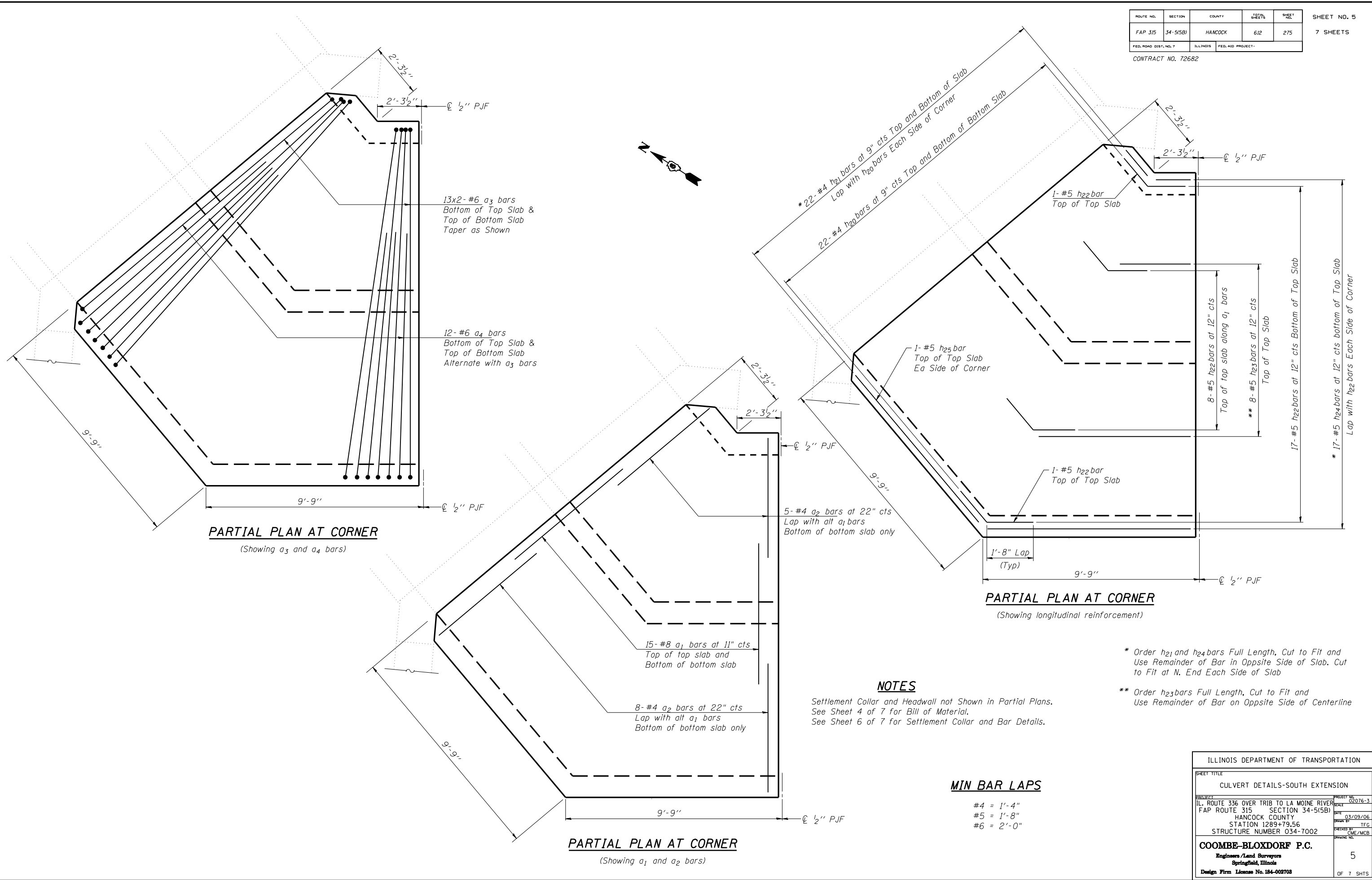

NOTES

Settlement Collar and Headwall not Shown in Partial Plans. See Sheet 4 of 7 for Bill of Material. See Sheet 6 of 7 for Settlement Collar and Bar Details.

* Order h_{21} and h_{24} bars Full Length, Cut to Fit and Use Remainder of Bar in Opposite Side of Slab. Cut to Fit at N. End Each Side of Slab

** Order h_{23} bars Full Length, Cut to Fit and Use Remainder of Bar on Opposite Side of Centerline

MIN BAR LAPS

- #4 = 1'-4"
- #5 = 1'-8"
- #6 = 2'-0"

PLOT DATE = 5/1/2006
 FILE NAME = 24-055522.dwg
 PLOT SCALE = 0.250000
 USER NAME = laughtonr1

ILLINOIS DEPARTMENT OF TRANSPORTATION	
SHEET TITLE CULVERT DETAILS-SOUTH EXTENSION	
PROJECT NO. 02076-3	DATE 03/09/06
ILL. ROUTE 336 OVER TRIB TO LA MOINE RIVER FAP ROUTE 315 SECTION 34-5(5B)	STATION 1289+79.56
HANCOCK COUNTY	STRUCTURE NUMBER 034-7002
DESIGNED BY TFG	CHECKED BY CME/MCB
DRAWING NO.	
COOMBE-BLOXDORF P.C. Engineers/Land Surveyors Springfield, Illinois	
Design Firm License No. 184-002708	5 OF 7 SHTS