

ROUTE NO.	SECTION	COUNTY	TOTAL SHEETS	SHEET NO.
FAP 315	34-5(5B)	HANCOCK	612	282
FED. ROAD DIST. NO. 7		ILLINOIS	FED. AID PROJECT-	

SHEET NO. 5  
8 SHEETS

CONTRACT NO. 72682

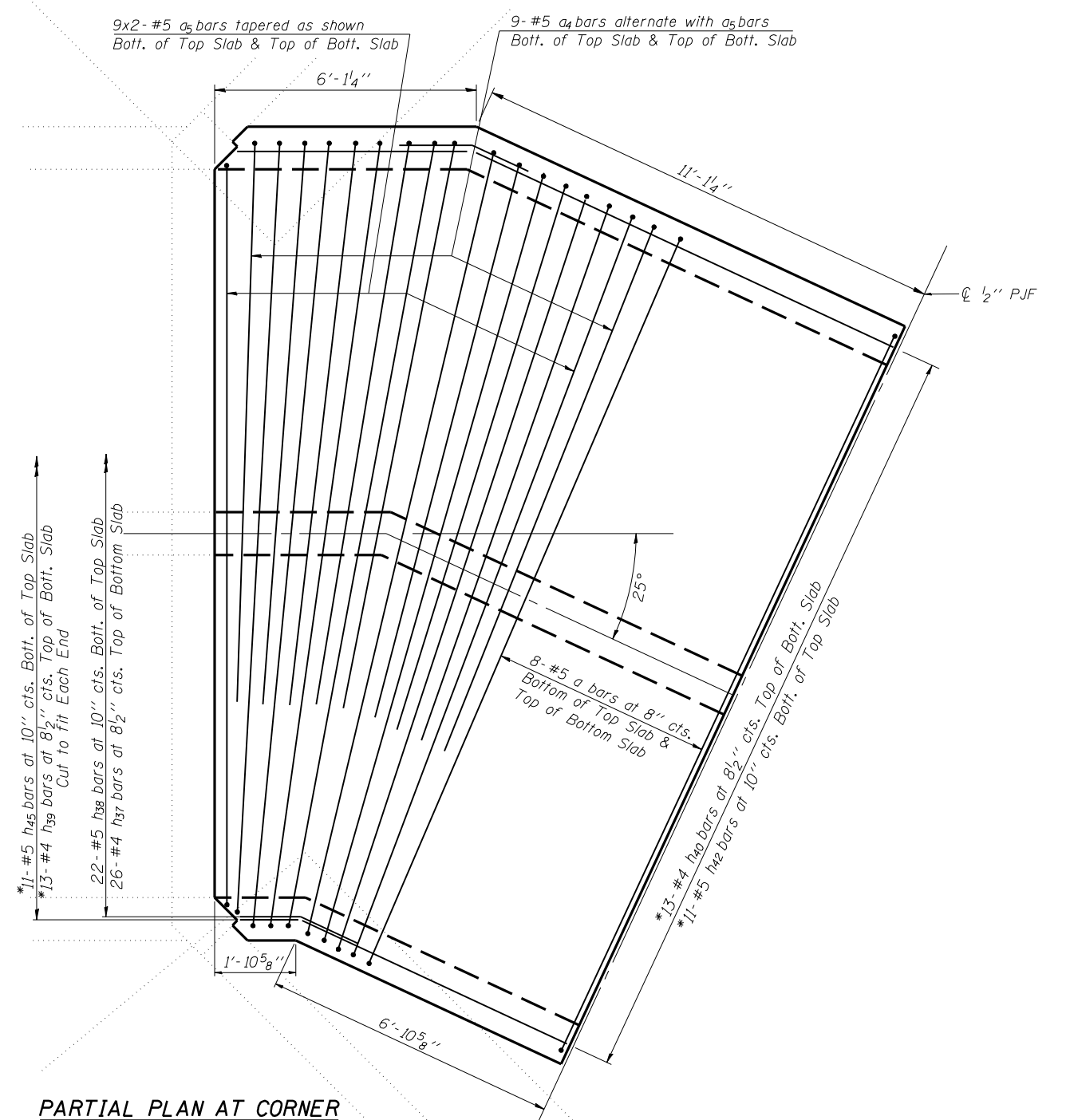
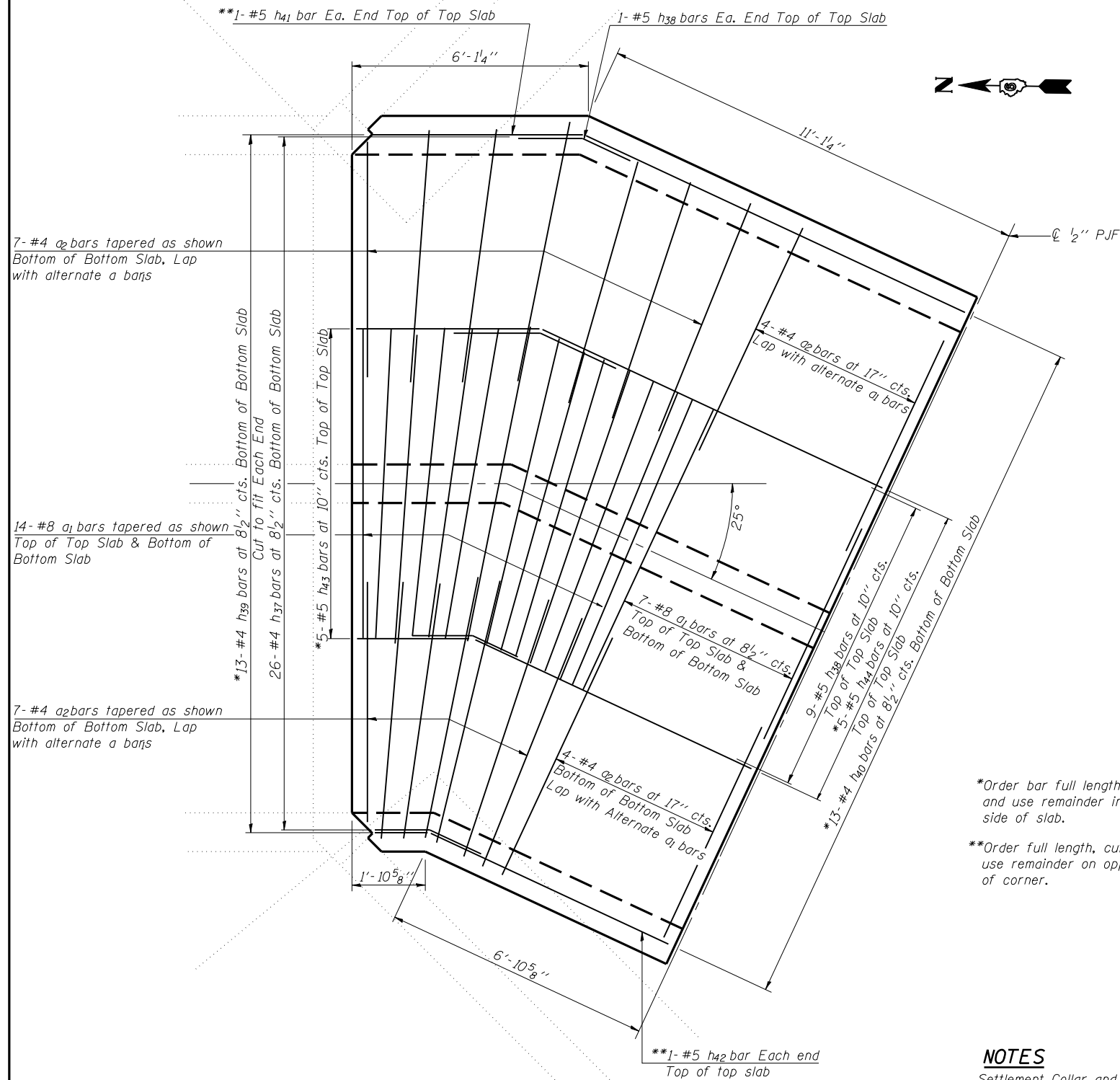

\*Order bar full length, cut to fit and use remainder in opposite side of slab.  
\*\*Order full length, cut to fit and use remainder on opposite side of corner.

**NOTES**  
Settlement Collar and Headwall not shown in Partial Plans.  
See Sheet 6 of 8 for Bill of Material.  
See Sheet 7 of 8 for Settlement Collar and Bar Details.

**MIN. BAR LAPS**

- #4 = 1'-4"
- #5 = 1'-8"
- #6 = 2'-0"

PLOT DATE = 5/1/2006  
 FILE NAME = 24...  
 PLOT SCALE = 0.250000  
 USER NAME = laughtinr1

ILLINOIS DEPARTMENT OF TRANSPORTATION	
SHEET TITLE CULVERT DETAILS-S, EXTENSION	
PROJECT IL. RTE. 336 OVER TRIB TO LA MOINE RIVER	PROJECT NO. 02076-4
FAP ROUTE 315 SECTION 34-5 (5B)	SCALE 03/20/06
HANCOCK COUNTY	DRAWN BY TFG
STATION 1318+53.88	CHECKED BY CME/MCB
STRUCTURE NUMBER 034-7001	DRAWING NO.
<b>COOMBE-BLOXDORF P.C.</b> Engineers/Land Surveyors Springfield, Illinois	5
Design Firm License No. 184-002708	OF 8 SHTS