

F.A.P. RTE.	SECTION	COUNTY	TOTAL SHEETS	SHEET No.
315	34-5	HANCOCK	612	503
STA. TO STA.			ILLINOIS FED. AID PROJECT	
130			140	150
			160	

NOTE: THE CONTRACTOR MUST COMPLETE ALL CULVERT WORK, ESTABLISH NEW DRAINAGE PATTERN AND FILL THE EXISTING 30" RCP @ STA 1341+47.23 BEFORE COMPLETING STAGE 3 ROADWAY WORK AT THIS LOCATION.

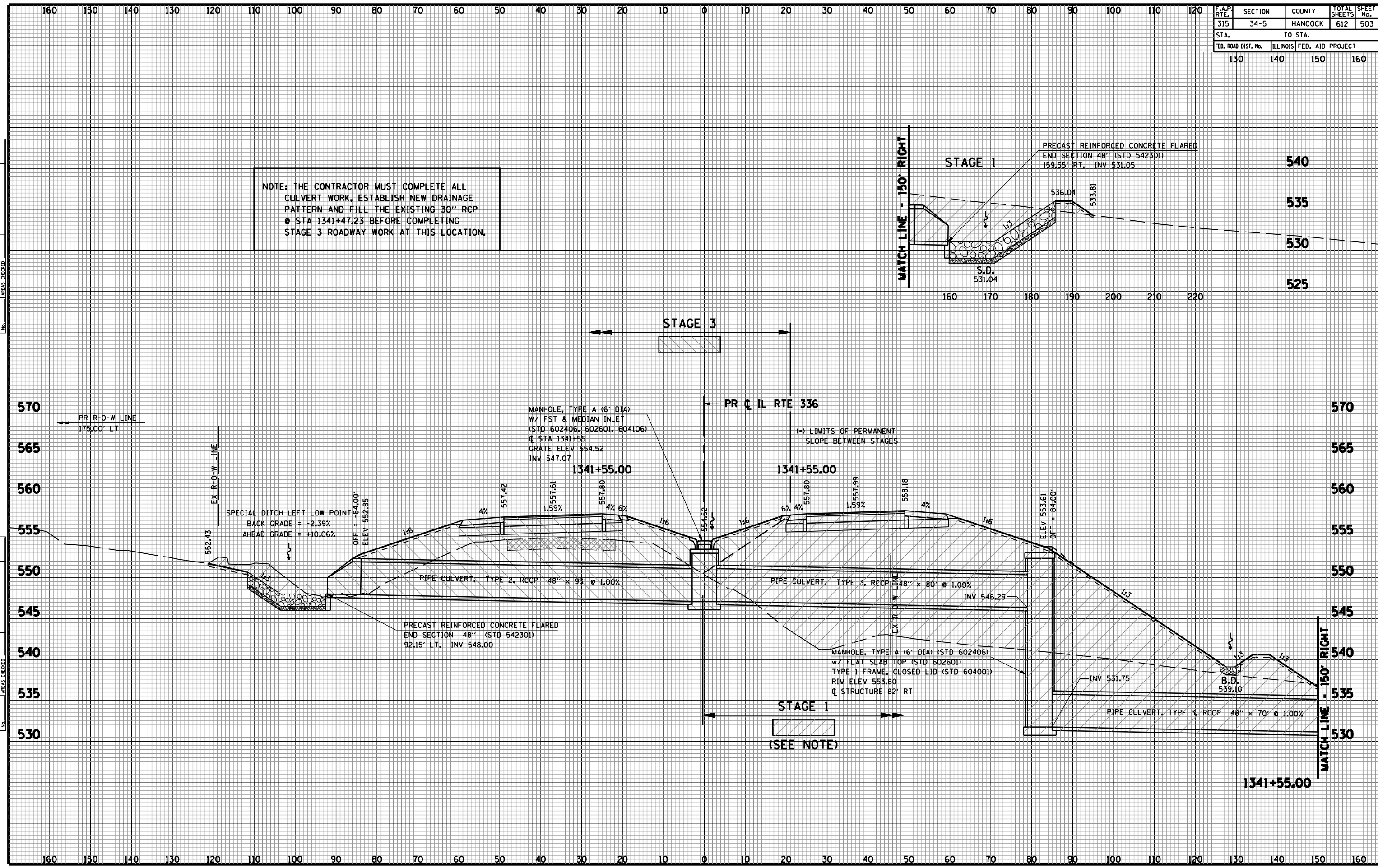
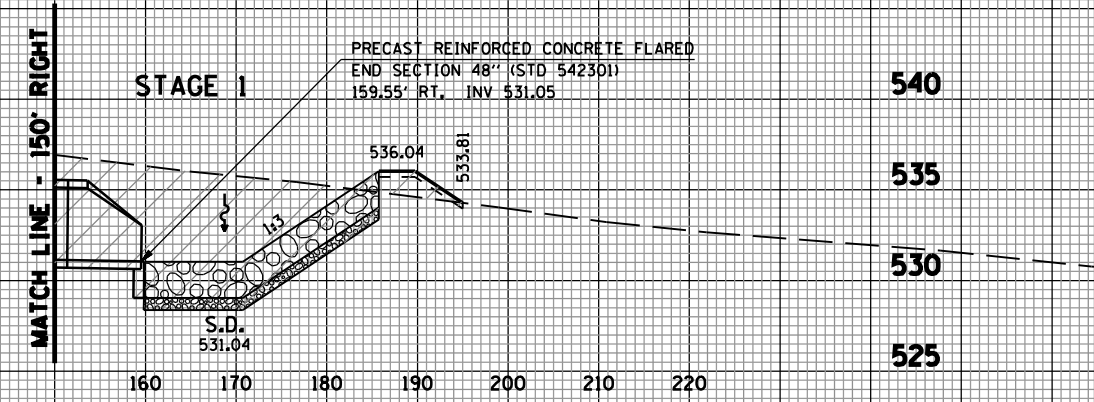

DATE	BY
NO.	NO.
AREAS CHECKED	AREAS CHECKED
TEMPLATE	TEMPLATE
PLOTTED	PLOTTED
SURVEY	SURVEY
FINAL	FINAL
NO.	NO.

DATE	BY
NO.	NO.
AREAS CHECKED	AREAS CHECKED
TEMPLATE	TEMPLATE
PLOTTED	PLOTTED
SURVEY	SURVEY
ORIGINAL	ORIGINAL
NO.	NO.