

F.A.P. RTE.	SECTION	COUNTY	TOTAL SHEETS	SHEET NO.
75		CHRISTIAN	9	1

D-6 TS VIDEO INSTALL 2006

STATE OF ILLINOIS
DEPARTMENT OF TRANSPORTATION
DIVISION OF HIGHWAYS

PROPOSED HIGHWAY PLANS

FAP ROUTE 75 (IL 29)
SECTION D-6 TS VIDEO INSTALL 2006
CHRISTIAN COUNTY
PROJECT
C-96-525-06

D-96-515-06

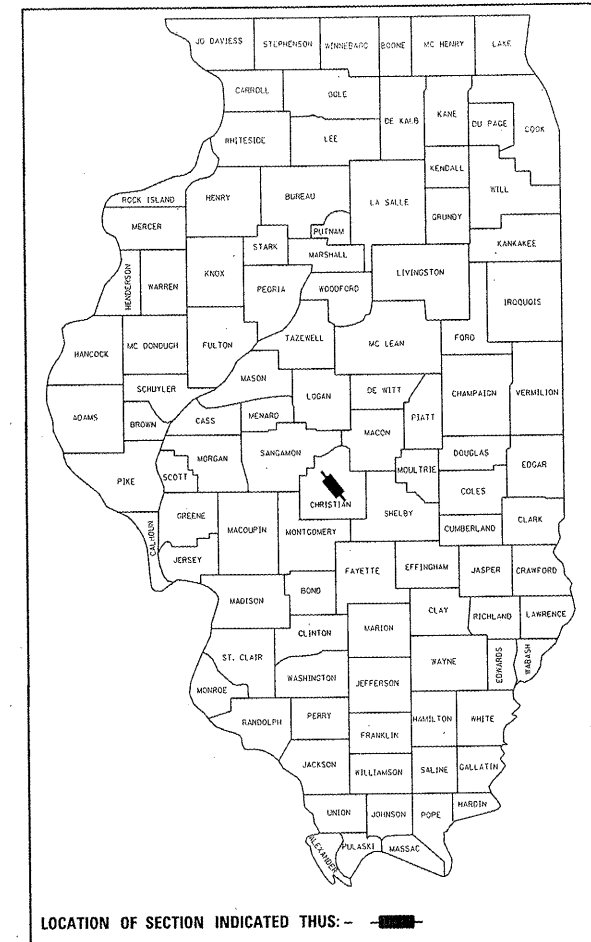

INDEX OF SHEETS

- COVERSHEET
- GENERAL NOTES
- SUMMARY OF QUANTITIES
- PROPOSED TRAFFIC SIGNALS - IL 29 & CHENEY
- PROPOSED CABLE DIAGRAM - IL 29 & CHENEY
- PROPOSED TRAFFIC SIGNALS - IL 29 & WEBSTER
- PROPOSED CABLE DIAGRAM - IL 29 & WEBSTER
- VIDEO DETECTION SYSTEM INSTALLATION DETAIL
- TRAFFIC SIGNAL LEGEND

HIGHWAY STANDARDS

- 000001-04
- 701701-04
- 702001-06

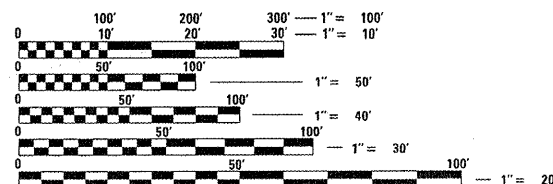
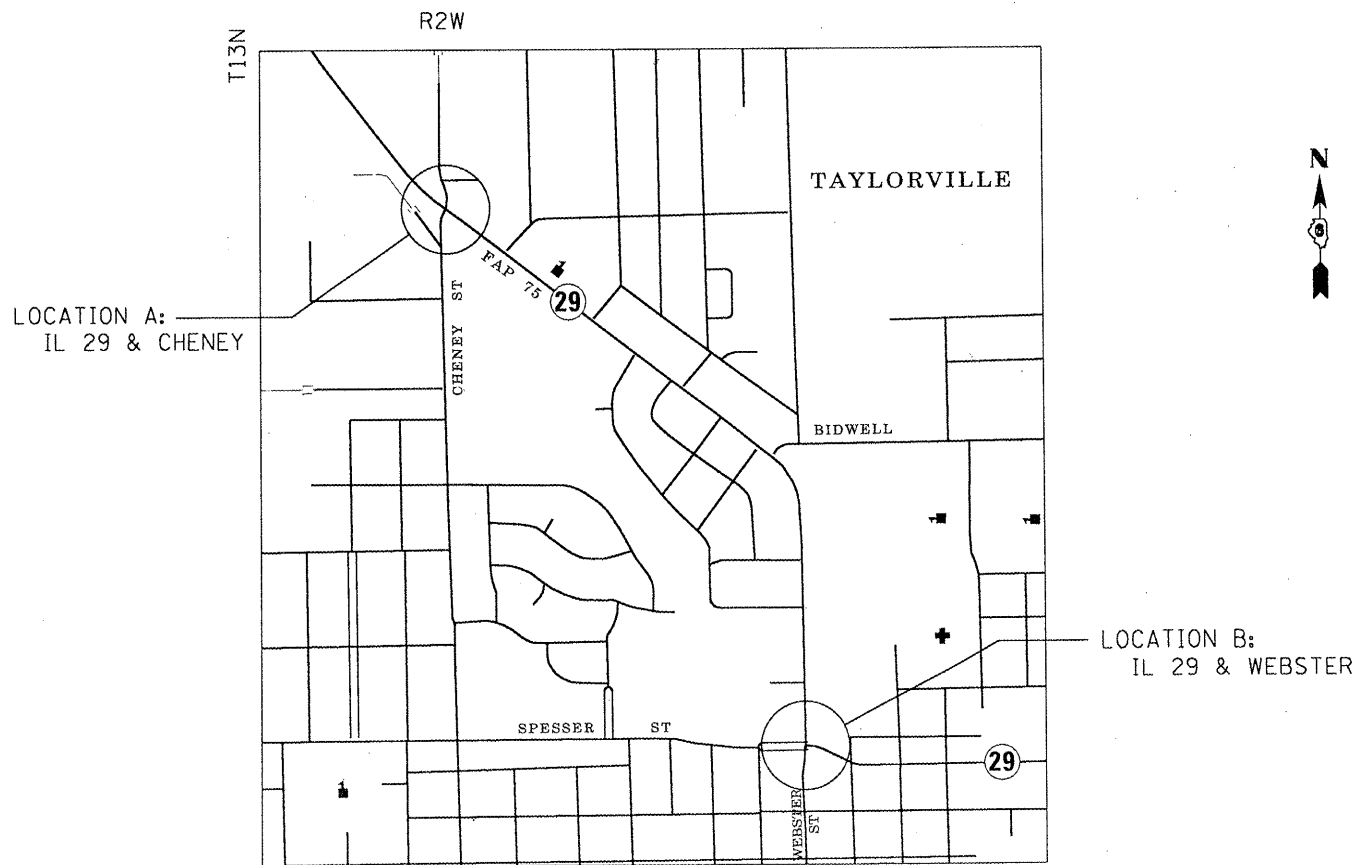

FULL SIZE PLANS HAVE BEEN PREPARED USING STANDARD ENGINEERING SCALES. REDUCED SIZED PLANS WILL NOT CONFORM TO STANDARD SCALES. IN MAKING MEASUREMENTS ON REDUCED PLANS, THE ABOVE SCALES MAY BE USED.

J.U.L.I.E.
JOINT UTILITY LOCATION INFORMATION FOR EXCAVATION
1-800-892-0123

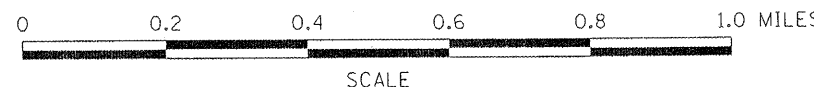

CONTRACT NO. 72A35

STATE OF ILLINOIS
DEPARTMENT OF TRANSPORTATION
DIVISION OF HIGHWAYS

SUBMITTED *March 21, 2006*
Chris M. Reed
DEPUTY DIRECTOR OF HIGHWAYS, REGION ENGINEER

May 12, 2006
Mike Hine
ENGINEER OF DESIGN AND ENVIRONMENT

May 12, 2006
Milton R. Sees P.E.
DIRECTOR OF HIGHWAYS, CHIEF ENGINEER

PRINTED BY THE AUTHORITY
OF THE STATE OF ILLINOIS

PROJECT ENGINEER: SAL MADONIA (217) 782-4761
SQUAD LEADER: ED KERN (217) 524-7940

CONTRACT NO. 72A35

F.A.P. RTE.	SECTION	COUNTY	TOTAL SHEETS	SHEET NO.
75	*	CHRISTIAN	9	2
STA.		TO STA.		
FED. ROAD DIST. NO.		ILLINOIS FED. AID PROJECT		

* D-6 TS VIDEO INSTALL 2006

GENERAL NOTES

1. THE CONTRACTOR SHALL BE RESPONSIBLE FOR PROTECTING UTILITY PROPERTY FROM CONSTRUCTION OPERATIONS AS OUTLINED IN ARTICLE 107.31 OF THE STANDARD SPECIFICATIONS. THE JULIE NUMBER IS 800-892-0123. A MINIMUM OF FORTY-EIGHT HOURS ADVANCE NOTICE IS REQUIRED. ANY DAMAGE TO THE UNDERGROUND FACILITIES, CAUSED BY THE CONTRACTOR, SHALL BE REPAIRED TO THE SATISFACTION OF THE DEPARTMENT AT THE CONTRACTOR'S EXPENSE, INCLUDING TEMPORARY REPAIRS WHICH MAY BE REQUIRED TO KEEP THE FACILITY OPERATIONAL WHILE MATERIALS IS BEING OBTAINED TO MAKE PERMANENT REPAIRS.
2. ANY REFERENCE TO A STANDARD IN THESE PLANS SHALL BE INTERPRETED TO MEAN THE EDITION AS INDICATED BY THE SUBNUMBER LISTED ON THE INDEX OF SHEETS OR THE COPY OF THE STANDARD INCLUDED IN THESE PLANS.
3. ALL STATION REFERENCES ARE TO THE ROADWAY CENTERLINE OR BASELINE.

COMMITMENTS

THERE ARE NO COMMITMENTS ON THIS PROJECT.

DISTRICT SIX	
EXAMINED <u>March 2</u>	<u>2006</u>
<i>Louis J. Adams</i>	
OPERATIONS ENGINEER	
EXAMINED <u>March 16</u>	<u>2006</u>
<i>L.R. Jones</i>	
PROGRAM IMPLEMENTATION ENGINEER	
EXAMINED <u>March 21</u>	<u>2006</u>
<i>William E. Porter</i>	
PROGRAM DEVELOPMENT ENGINEER	

REVISIONS	
NAME	DATE

ILLINOIS DEPARTMENT OF TRANSPORTATION
 GENERAL NOTES
 FAP 75 (IL 29)
 SECTION D-6 TS VIDEO INSTALL 2006
 CHRISTIAN COUNTY
 SCALE: VERT. _____ DRAWN BY _____
 DATE _____ CHECKED BY _____

PLOT DATE = 3/22/2006
 PLOT SCALE = 1/8" = 100'
 USER NAME = myers.p

F.A.P. RTE.	SECTION	COUNTY	TOTAL SHEETS	SHEET NO.
75	*	CHRISTIAN	9	3
STA.		TO STA.		
FED. ROAD DIST. NO.		ILLINOIS FED. AID PROJECT		

ILLINOIS DEPARTMENT OF TRANSPORTATION SUMMARY OF QUANTITIES

*URBAN
100% STATE*

LOCATION OF WORK				LOCATION A IL 29 @ CHENEY	LOCATION B IL 29 @ WEBSTER/ SPRESSER
SUMMARY OF QUANTITIES				CONSTRUCTION TYPE CODE	CONSTRUCTION TYPE CODE
CODE NO.	ITEM	UNIT	TOTAL QUANTITY	Y031 - 1F	Y031 - 1F
87301525	ELECTRIC CABLE IN CONDUIT, LEAD-IN, NO. 18 6 PAIR	FOOT	1299	597	702
89502300	REMOVE ELECTRIC CABLE FROM CONDUIT	FOOT	1777	332	1445
89502375	REMOVE EXISTING TRAFFIC SIGNAL EQUIPMENT	EACH	2	1	1
X0320872	VIDEO VEHICLE DETECTION SYSTEM	EACH	2	1	1
X0322929	CAMERA MOUNTING ASSEMBLY	EACH	6	2	4
67100100	MOBILIZATION	L SUM	1	0.5	0.5
70102635	TRAFFIC CONTROL AND PROTECTION, STANDARD 701701	L SUM	1	0.5	0.5

PLOT DATE = #DATE#
 FILE NAME = #FILE#
 PLOT SCALE = #SCALE#
 USER NAME = #USER#

REVISIONS	
NAME	DATE

ILLINOIS DEPARTMENT OF TRANSPORTATION

SUMMARY OF QUANTITIES
 FAP 75 (IL 29)
 SECTION D-6 TS VIDEO INSTALL 2006
 CHRISTIAN COUNTY

SCALE: VERT. _____
 HORIZ. _____
 DATE _____

DRAWN BY _____
 CHECKED BY _____

F.A.P. RTE.	SECTION	COUNTY	TOTAL SHEETS	SHEET NO.
75	.	CHRISTIAN	9	4
STA.		TO STA.		
FED. ROAD DIST. NO.	ILLINOIS	FED. AID PROJECT		

D-6 VIDEO INSTALL 2006

TRAFFIC SIGNAL QUANTITIES

LOCATION: IL 29 & CHENEY ST

QUANTITY	UNIT	ITEM
597.0	FOOT	ELECTRIC CABLE IN CONDUIT, LEAD-IN, NO. 18, 6 PAIR
331.5	FOOT	REMOVE ELECTRIC CABLE FROM CONDUIT
1	EACH	REMOVE EXISTING TRAFFIC SIGNAL EQUIPMENT
1	EACH	VIDEO VEHICLE DETECTION SYSTEM
2	EACH	CAMERA MOUNTING ASSEMBLY

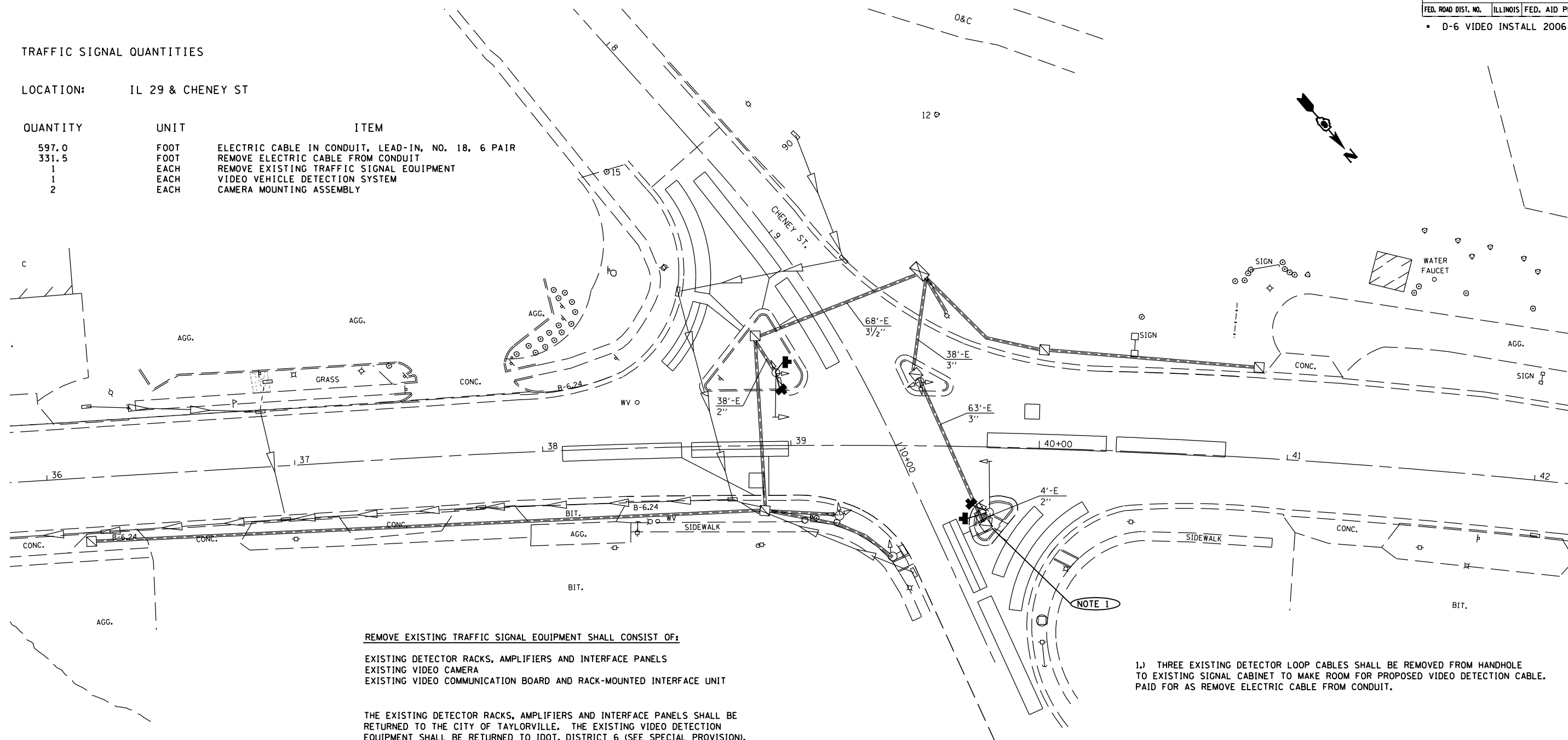

REMOVE EXISTING TRAFFIC SIGNAL EQUIPMENT SHALL CONSIST OF:
 EXISTING DETECTOR RACKS, AMPLIFIERS AND INTERFACE PANELS
 EXISTING VIDEO CAMERA
 EXISTING VIDEO COMMUNICATION BOARD AND RACK-MOUNTED INTERFACE UNIT

THE EXISTING DETECTOR RACKS, AMPLIFIERS AND INTERFACE PANELS SHALL BE RETURNED TO THE CITY OF TAYLORVILLE. THE EXISTING VIDEO DETECTION EQUIPMENT SHALL BE RETURNED TO IDOT, DISTRICT 6 (SEE SPECIAL PROVISION).

1.) THREE EXISTING DETECTOR LOOP CABLES SHALL BE REMOVED FROM HANDHOLE TO EXISTING SIGNAL CABINET TO MAKE ROOM FOR PROPOSED VIDEO DETECTION CABLE. PAID FOR AS REMOVE ELECTRIC CABLE FROM CONDUIT.

NOTE 1

PLOT DATE = 04/15/06
 PLOT SCALE = 1\"/>

REVISIONS	
NAME	DATE

ILLINOIS DEPARTMENT OF TRANSPORTATION
 PROPOSED TRAFFIC SIGNALS
 IL 29 & CHENEY ST
 FAP 75 (IL 29)
 SECTION D-6 VIDEO INSTALL 2006
 CHRISTIAN COUNTY

SCALE: VERT. 1\"/>

DRAWN BY KDA
 CHECKED BY

F.A.P. RTE.	SECTION	COUNTY	TOTAL SHEETS	SHEET NO.
75		CHRISTIAN	9	6
STA.		TO STA.		
FED. ROAD DIST. NO.		ILLINOIS FED. AID PROJECT		

D-6 VIDEO INSTALL 2006

TRAFFIC SIGNAL QUANTITIES

LOCATION: IL 29 & WEBSTER ST

QUANTITY	UNIT	ITEM
702.0	FOOT	ELECTRIC CABLE IN CONDUIT, LEAD-IN, NO. 18, 6 PAIR
1445.0	FOOT	REMOVE ELECTRIC CABLE FROM CONDUIT
1	EACH	REMOVE EXISTING TRAFFIC SIGNAL EQUIPMENT
1	EACH	VIDEO VEHICLE DETECTION SYSTEM
4	EACH	CAMERA MOUNTING ASSEMBLY

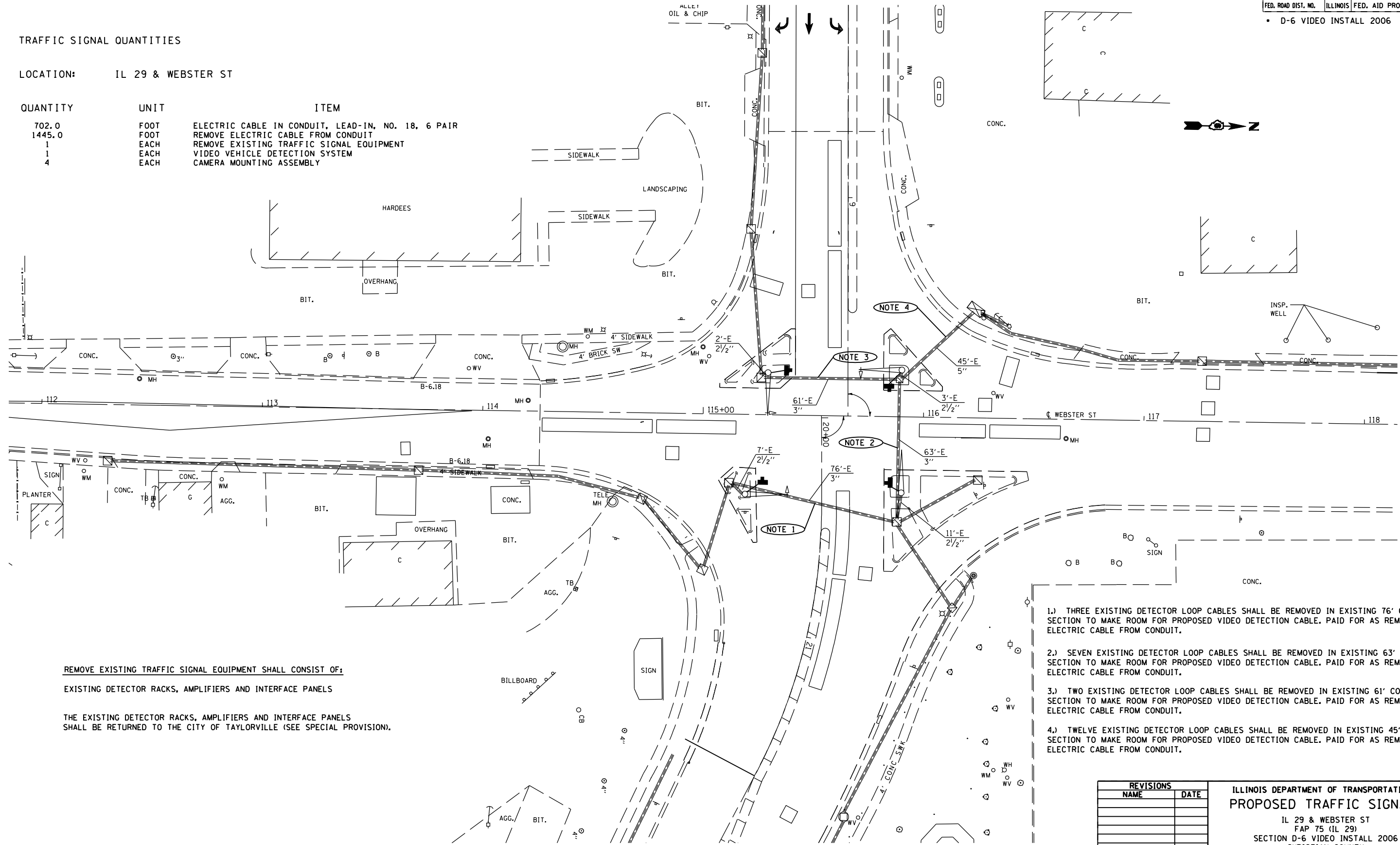

REMOVE EXISTING TRAFFIC SIGNAL EQUIPMENT SHALL CONSIST OF:

EXISTING DETECTOR RACKS, AMPLIFIERS AND INTERFACE PANELS

THE EXISTING DETECTOR RACKS, AMPLIFIERS AND INTERFACE PANELS SHALL BE RETURNED TO THE CITY OF TAYLORVILLE (SEE SPECIAL PROVISION).

- 1.) THREE EXISTING DETECTOR LOOP CABLES SHALL BE REMOVED IN EXISTING 76' CONDUIT SECTION TO MAKE ROOM FOR PROPOSED VIDEO DETECTION CABLE. PAID FOR AS REMOVE ELECTRIC CABLE FROM CONDUIT.
- 2.) SEVEN EXISTING DETECTOR LOOP CABLES SHALL BE REMOVED IN EXISTING 63' CONDUIT SECTION TO MAKE ROOM FOR PROPOSED VIDEO DETECTION CABLE. PAID FOR AS REMOVE ELECTRIC CABLE FROM CONDUIT.
- 3.) TWO EXISTING DETECTOR LOOP CABLES SHALL BE REMOVED IN EXISTING 61' CONDUIT SECTION TO MAKE ROOM FOR PROPOSED VIDEO DETECTION CABLE. PAID FOR AS REMOVE ELECTRIC CABLE FROM CONDUIT.
- 4.) TWELVE EXISTING DETECTOR LOOP CABLES SHALL BE REMOVED IN EXISTING 45' CONDUIT SECTION TO MAKE ROOM FOR PROPOSED VIDEO DETECTION CABLE. PAID FOR AS REMOVE ELECTRIC CABLE FROM CONDUIT.

REVISIONS	
NAME	DATE

ILLINOIS DEPARTMENT OF TRANSPORTATION
PROPOSED TRAFFIC SIGNALS
 IL 29 & WEBSTER ST
 FAP 75 (IL 29)
 SECTION D-6 VIDEO INSTALL 2006
 CHRISTIAN COUNTY

SCALE: VERT. HORIZ. DATE: FEB '06 DRAWN BY: KDA CHECKED BY:

F.A.P. RTE.	SECTION	COUNTY	TOTAL SHEETS	SHEET NO.
75	.	CHRISTIAN	9	7

STA.	TO STA.
FED. ROAD DIST. NO.	ILLINOIS FED. AID PROJECT

D-6 VIDEO INSTALL 2006

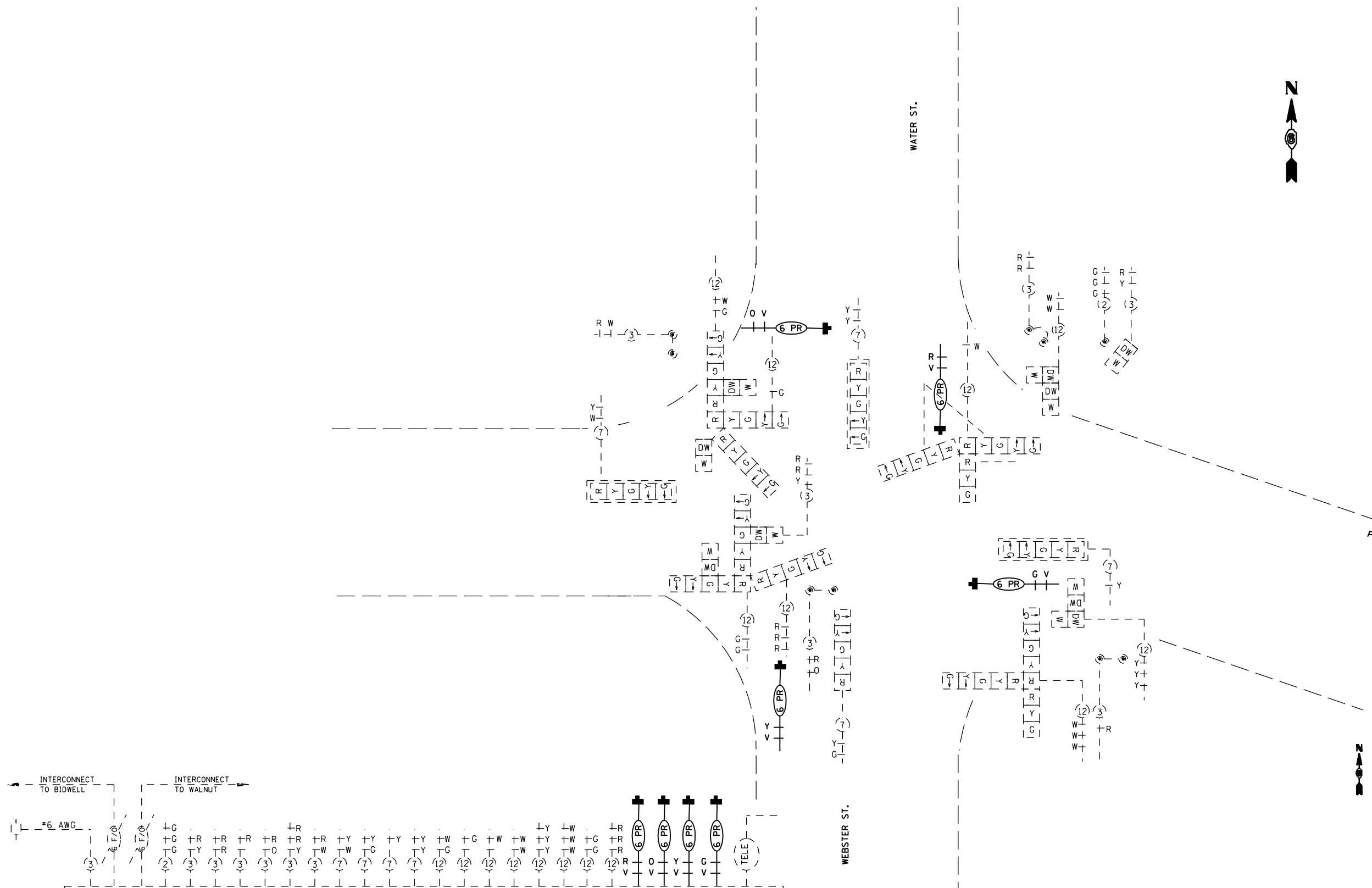

PHASE DESIGNATION DIAGRAM

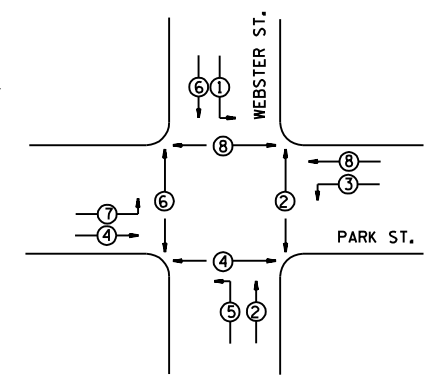

REVISIONS	
NAME	DATE

ILLINOIS DEPARTMENT OF TRANSPORTATION
PROPOSED CABLE DIAGRAM
 IL 29 & WEBSTER ST
 FAP 75 (IL 29)
 SECTION D-6 VIDEO INSTALL 2006
 CHRISTIAN COUNTY

SCALE: VERT. 1" = 100'
 HORIZ. 1" = 100'
 DATE: FEB '06

DRAWN BY: KDA
 CHECKED BY:

PLOT DATE:
 DATE:
 PLOT SCALE:
 SCALE:

F.A.P. RTE.	SECTION	COUNTY	TOTAL SHEETS	SHEET NO.
75	.	CHRISTIAN	9	8
STA.		TO STA.		
FED. ROAD DIST. NO.	ILLINOIS	FED. AID PROJECT		

D-6 VIDEO INSTALL 2006

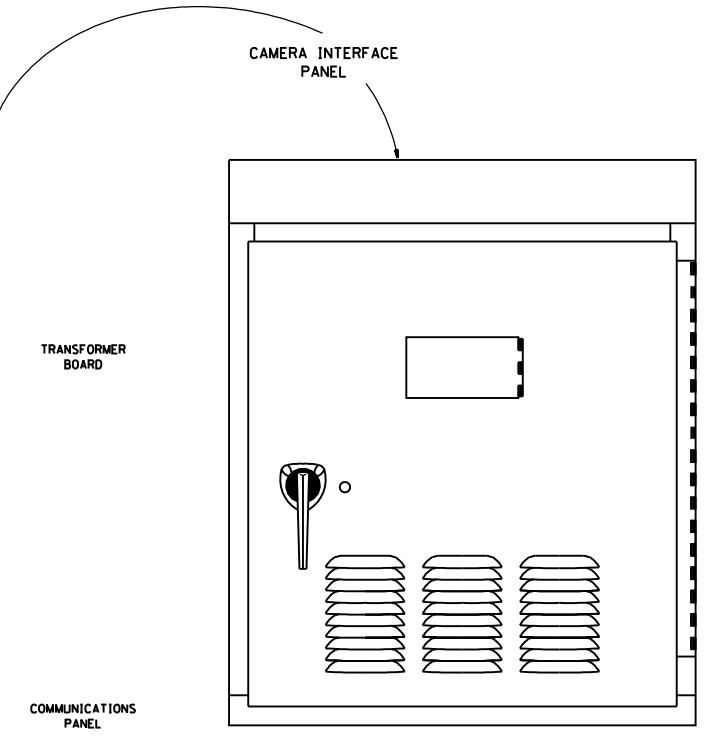
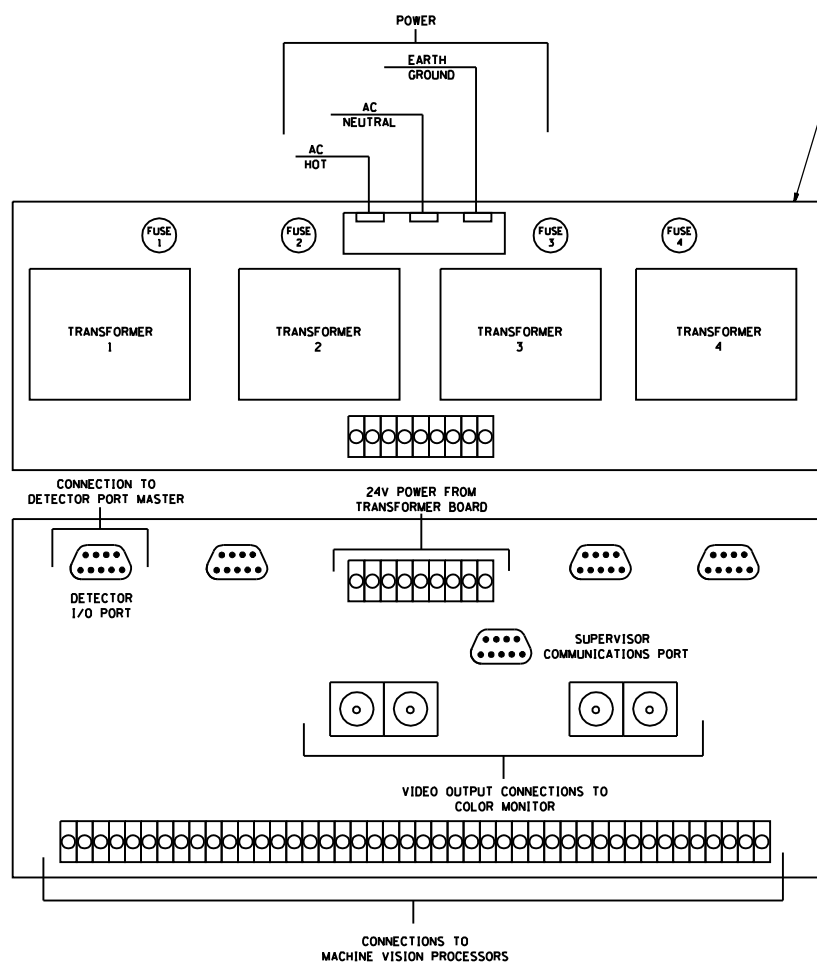
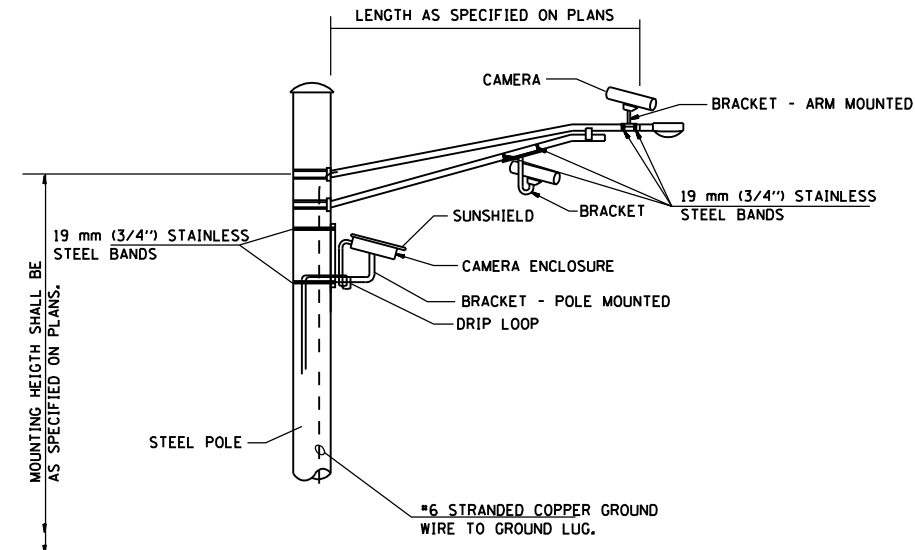
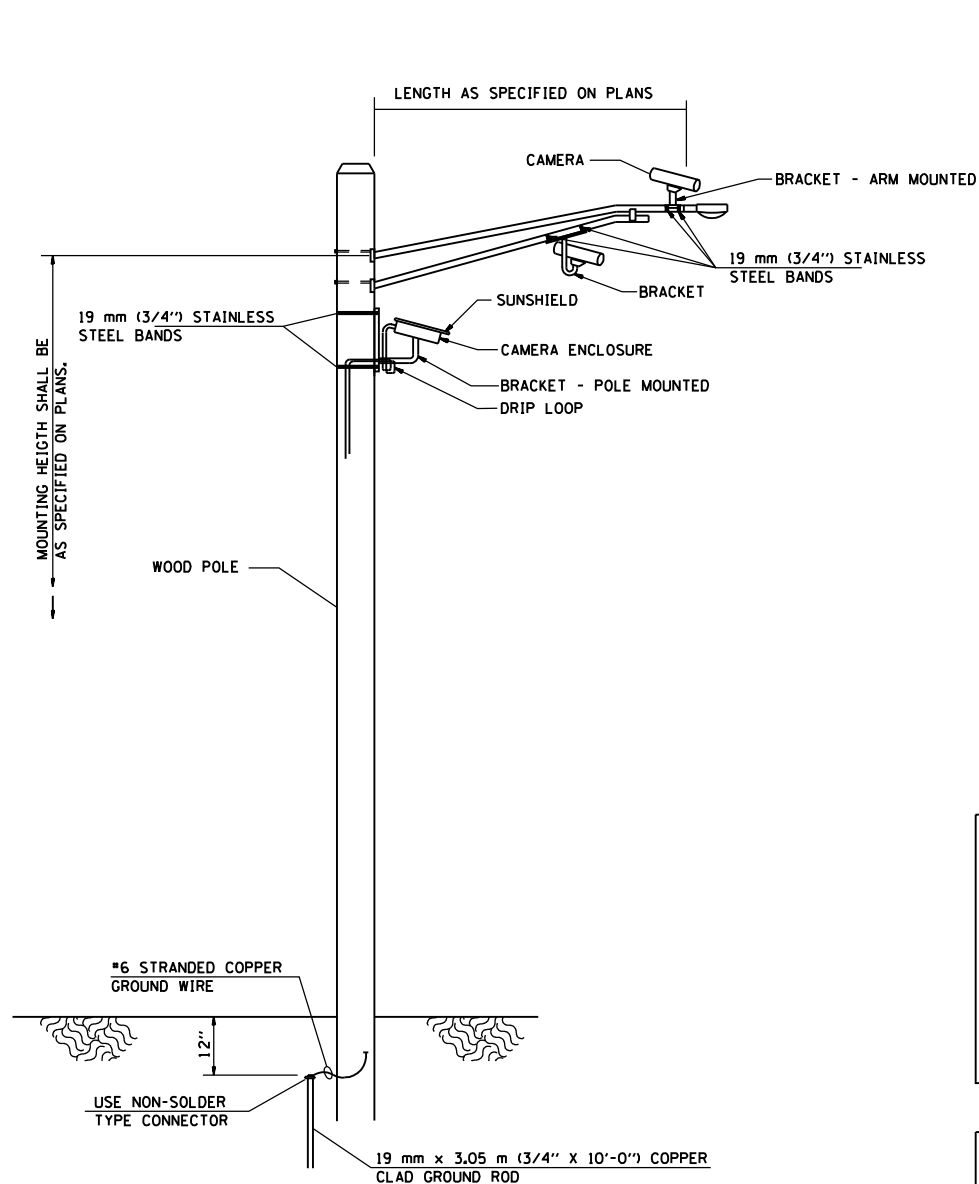

**VIDEO DETECTION SYSTEM INSTALLATION
ARM MOUNTED OR POLE MOUNTED CAMERA**

PLOT DATE = #DATE#
PLOT SCALE = #SCALE#

VCAMERA

REVISIONS	
NAME	DATE
WCD	31OCT97

ILLINOIS DEPARTMENT OF TRANSPORTATION
**VIDEO DETECTION SYSTEM
 INSTALLATION DETAIL**
 FAP 75 (IL 29)
 SECTION D-6 VIDEO INSTALL 2006
 CHRISTIAN COUNTY
 SCALE: VERT. _____
 HORIZ. _____
 DATE: MARCH 12, 1996
 DRAWN BY CADD
 CHECKED BY WCD

F.A.P. RTE.	SECTION	COUNTY	TOTAL SHEETS	SHEET NO.
75	*	CHRISTIAN	9	9
STA.		TO STA.		
FED. ROAD DIST. NO.	ILLINOIS	FED. AID PROJECT		

* D-6 VIDEO INSTALL 2006

TRAFFIC SIGNAL PLAN LEGEND

EXISTING	PROPOSED	DESCRIPTION
		SIGNAL HEAD
		SIGNAL HEAD WITH BACKPLATE
		TEMPORARY SIGNAL HEAD
		PEDESTRIAN SIGNAL HEAD
		PEDESTRIAN PUSHBUTTON DETECTOR
		DETECTOR LOOP
		QUADRAPOLE DETECTOR LOOP
		SIGNAL POST
		ALUMINUM MAST ARM ASSEMBLY AND POLE
		STEEL MAST ARM ASSEMBLY AND POLE
		WOOD POLE
		WOOD POLE WITH GUY
		SERVICE INSTALLATION
		CONTROLLER
		HANDHOLE
		HEAVY DUTY HANDHOLE
		DOUBLE HANDHOLE
		JUNCTION BOX
		GULFBBOX JUNCTION
		AERIAL CABLE
		CONDUIT
		CONDUIT SPLICE
		SPAN WIRE / TETHER WIRE
		21 SIDEWALK REMOVAL IN SO FT
		9 PC CONC SDWLK 4 IN. IN SO FT
		12 PC CONC SDWLK 4 IN. SPECIAL IN SO FT

LENGTH - CONSTRUCTION (T=TRENCH P=PUSHED A=AUGERED E=EXISTING)
 SIZE - TYPE (S=STEEL P=PVC F=FIBER DUCT U=UNI-DUCT)

TRAFFIC SIGNAL WIRING DIAGRAM LEGEND

EXISTING	PROPOSED	DESCRIPTION
		8" SIGNAL SECTION
		12" SIGNAL SECTION
		DIRECTIONAL SIGNAL SECTION
		9" PEDESTRIAN SIGNAL FACE
		12" PEDESTRIAN SIGNAL FACE
		SIGNAL FACE WITH BACKPLATE
		PROGRAMMED SIGNAL SECTION
		SIGNAL SECTION WITH LOUVRE
		DUAL-INDICATION SIGNAL SECTION
		INDUCTION DETECTOR LOOP
		QUADRAPOLE DETECTOR LOOP
		DIRECT-CONNECTED LOOP LEAD-IN (TWISTED)
		ELECTRIC CABLE DENOTING NUMBER OF CONDUCTORS
		ELECTRIC CABLE TO BE REMOVED
		ELECTRIC CABLE IDENTIFIER TAPE CODES (R= RED W= WHITE Y= YELLOW G= GREEN B= BLUE O= ORANGE)
		PEDESTRIAN PUSHBUTTON DETECTOR

PLOT DATE = 04/26/06
 PLOT SCALE = 1"=20'
 PLOT SCALE = 1"=20'

VCAMERA

REVISIONS	
NAME	DATE
WCD	31OCT97

ILLINOIS DEPARTMENT OF TRANSPORTATION
TRAFFIC SIGNAL LEGEND
 FAP 75 (IL 29)
 SECTION D-6 VIDEO INSTALL 2006
 CHRISTIAN COUNTY
 SCALE: VERT. DRAWN BY CADD
 HORIZ. CHECKED BY WCD
 DATE: MARCH 12, 1996