







F.A. RTE.	SECTION	COUNTY	TOTAL SHEETS	SHEET NO.
	*	EFFINGHAM	12	5
STA. TO STA.		FED. ROAD DIST. NO. ILLINOIS FED. AID PROJECT		

* D7 SIGNAL MODERNIZATION 2006-1

LEGEND

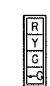
-  EXISTING PEDESTRIAN SIGNAL HEAD
-  LED RETROFIT PEDESTRIAN SIGNAL HEAD
-  EXISTING TRAFFIC SIGNAL W/BACKPLATE
-  LED RETROFIT TRAFFIC SIGNAL W/BACKPLATE
-  PROPOSED TRAFFIC SIGNAL W/BACKPLATE
-  EXISTING PEDESTRIAN PUSH-BUTTON
-  PROPOSED PEDESTRIAN PUSH-BUTTON

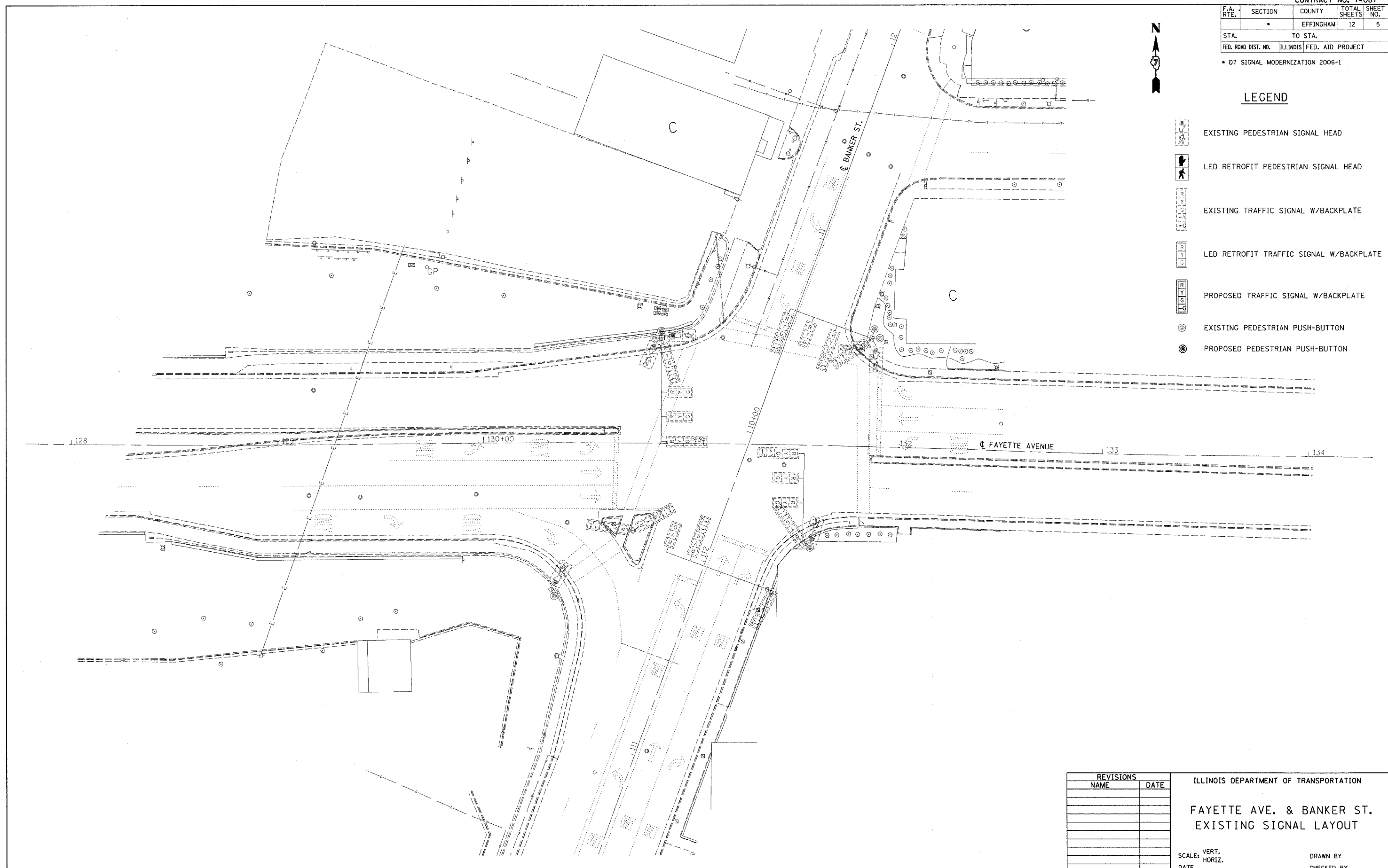

REVISIONS		ILLINOIS DEPARTMENT OF TRANSPORTATION
NAME	DATE	
		FAYETTE AVE. & BANKER ST. EXISTING SIGNAL LAYOUT
SCALE:	VERT. HORIZ.	DRAWN BY
DATE		CHECKED BY

PLOT DATE = 3/24/2006
 FILE NAME = #FILE#
 PLOT SCALE = #SCALE#
 USER NAME = #USER#