

F.A.P. RTE.	SECTION	COUNTY	TOTAL SHEETS	SHEET NO.
774	107 WRS-2, L	EFFINGHAM	127	25
FED. ROAD DIST. NO.	ILLINOIS	FED. AID PROJECT		

CONTRACT NO. 74130

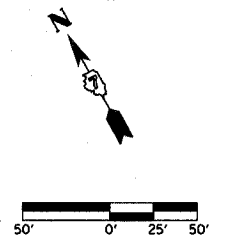

TYPICAL SECTION ⑦
SHEET 10

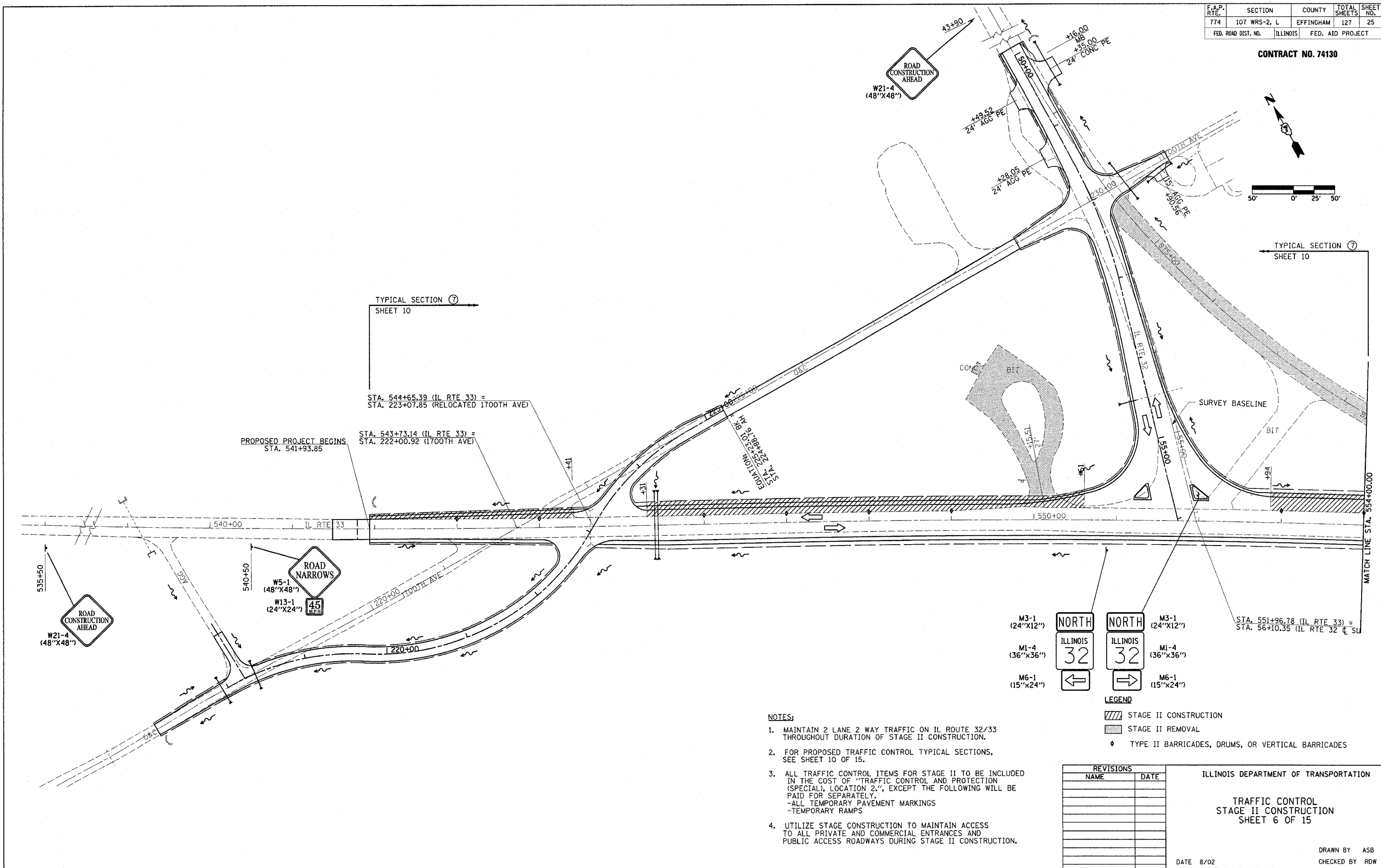

TYPICAL SECTION ⑦
SHEET 10

STA. 544+65.39 (IL RTE 33) =
STA. 223+07.85 (RELOCATED 1700TH AVE)

PROPOSED PROJECT BEGINS
STA. 541+93.85

STA. 543+73.14 (IL RTE 33) =
STA. 222+00.92 (1700TH AVE)

STA. 551+96.78 (IL RTE 33) =
STA. 56+10.35 (IL RTE 32 @ SU)

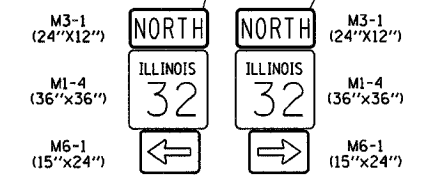

- LEGEND**
- STAGE II CONSTRUCTION (hatched area)
 - STAGE II REMOVAL (stippled area)
 - TYPE II BARRICADES, DRUMS, OR VERTICAL BARRICADES (diamond symbol)

- NOTES:**
1. MAINTAIN 2 LANE 2 WAY TRAFFIC ON IL ROUTE 32/33 THROUGHOUT DURATION OF STAGE II CONSTRUCTION.
 2. FOR PROPOSED TRAFFIC CONTROL TYPICAL SECTIONS, SEE SHEET 10 OF 15.
 3. ALL TRAFFIC CONTROL ITEMS FOR STAGE II TO BE INCLUDED IN THE COST OF "TRAFFIC CONTROL AND PROTECTION (SPECIAL), LOCATION 2.", EXCEPT THE FOLLOWING WILL BE PAID FOR SEPARATELY.
 - ALL TEMPORARY PAVEMENT MARKINGS
 - TEMPORARY RAMPS
 4. UTILIZE STAGE CONSTRUCTION TO MAINTAIN ACCESS TO ALL PRIVATE AND COMMERCIAL ENTRANCES AND PUBLIC ACCESS ROADWAYS DURING STAGE II CONSTRUCTION.

REVISIONS	
NAME	DATE

ILLINOIS DEPARTMENT OF TRANSPORTATION

TRAFFIC CONTROL
STAGE II CONSTRUCTION
SHEET 6 OF 15

DATE 8/02

DRAWN BY ASB
CHECKED BY RDW

4/19/06