

| F.A.P. RTE.                                   | SECTION      | COUNTY            | TOTAL SHEETS | SHEET NO. |
|-----------------------------------------------|--------------|-------------------|--------------|-----------|
| 774                                           | 107 WRS-2, L | EFFINGHAM         | 127          | 35        |
| STA. 537+00.00                                |              | TO STA. 549+00.00 |              |           |
| FED. ROAD DIST. NO. ILLINOIS FED. AID PROJECT |              |                   |              |           |

CONTRACT NO. 74130

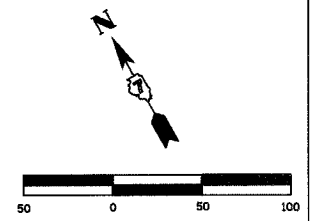

PROP. CURVE C1A  
 P.I. STA. = 539+99.97  
 $\Delta = 3^\circ 53' 00''$  (LT)  
 $D = 0^\circ 24' 00''$   
 $R = 14,323.90'$   
 $T = 485.59'$   
 $L = 970.81'$   
 $E = 8.23'$   
 $e = 1.56\%$   
 P.C. STA. = 535+14.38  
 P.T. STA. = 544+85.19  
 SE REMOVED STA. 544+00.00 TO STA. 547+00.00

BITUMINOUS SURFACE REMOVAL - BUTT JOINT  
 STA. 541+48.85 - STA. 541+88.85 107 SQ YD

EQUATION:  
 STA. 225+23.01 BK =  
 STA. 224+88.76 AH  
 END CONSTRUCTION

PROP. CURVE C-1  
 P.I. STA. = 551+75.52  
 $\Delta = 3^\circ 52' 10''$  (RT)  
 $D = 0^\circ 24' 01''$   
 $R = 14317.15'$   
 $T = 483.62'$   
 $L = 966.87'$   
 $E = 8.17'$   
 $e = 1.56\%$   
 P.C. STA = 546+91.90  
 P.T. STA = 556+58.77  
 SE ATTAINED STA. 547+00.00 TO STA. 549+50.00  
 SE REMOVED STA. 549+50.00 TO STA. 550+00.00

PERMANENT SURVEY MARKERS, TYPE I  
 PT STA. 544+85.19 1 EACH  
 PC STA. 546+91.90 1 EACH  
 TOTAL 2 EACH

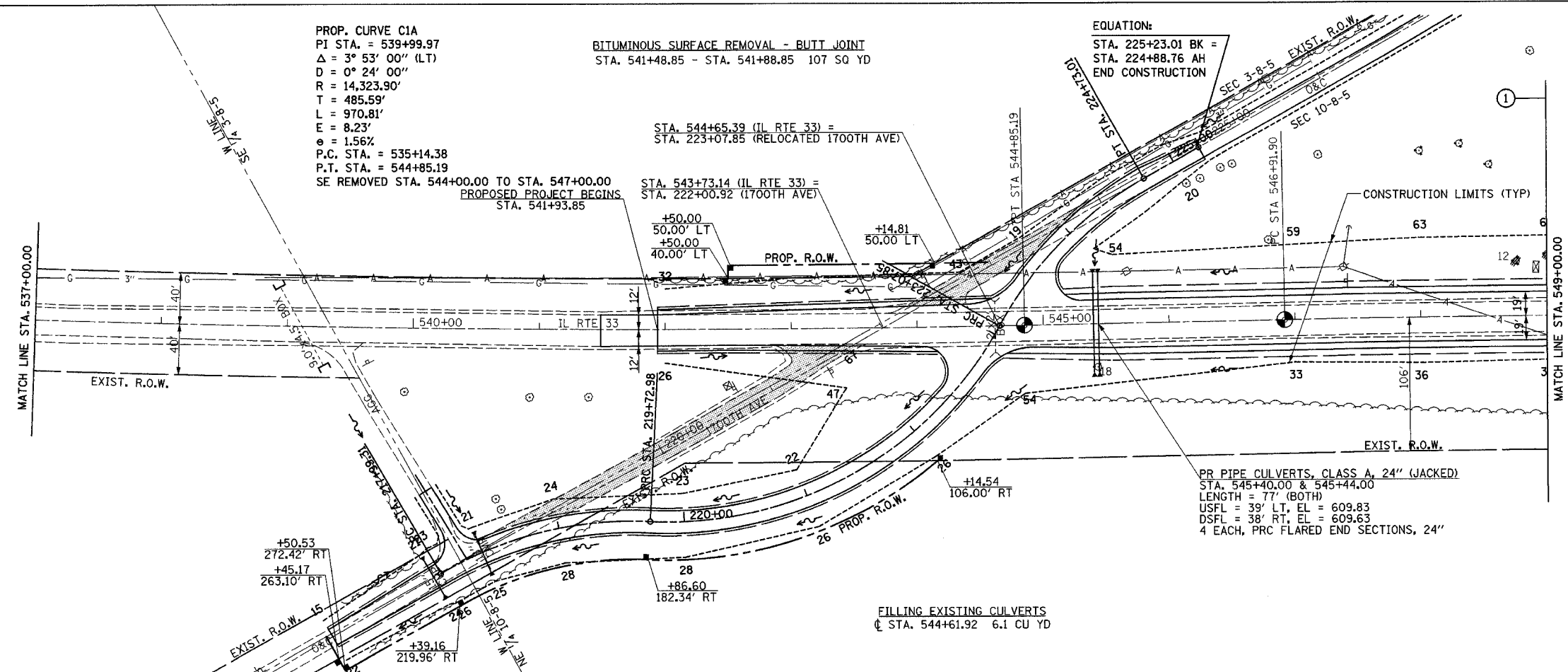

| DATE | BY | REVISION |
|------|----|----------|
|      |    |          |
|      |    |          |

| DATE | BY | REVISION |
|------|----|----------|
|      |    |          |
|      |    |          |

