

F.A.P. RTE.	SECTION	COUNTY	TOTAL SHEETS	SHEET NO.
774	107 WRS-2, L	EFFINGHAM	127	47
FED. ROAD DIST. NO.	ILLINOIS	FED. AID PROJECT		

CONTRACT NO. 74130

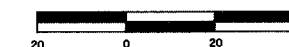

PROP. CURVE C92 (RT EOP)  
 PI STA. = 10.01' RT 52+79.66  
 $\Delta = 13^\circ 08' 46''$  (RT)  
 $D = 6^\circ 01' 52''$   
 $R = 950.00'$   
 $T = 109.47'$   
 $L = 217.97'$   
 $E = 6.29'$   
 P.C. STA. = 15.50' RT 51+67.70  
 P.T. STA. = 15.33' RT 53+89.40

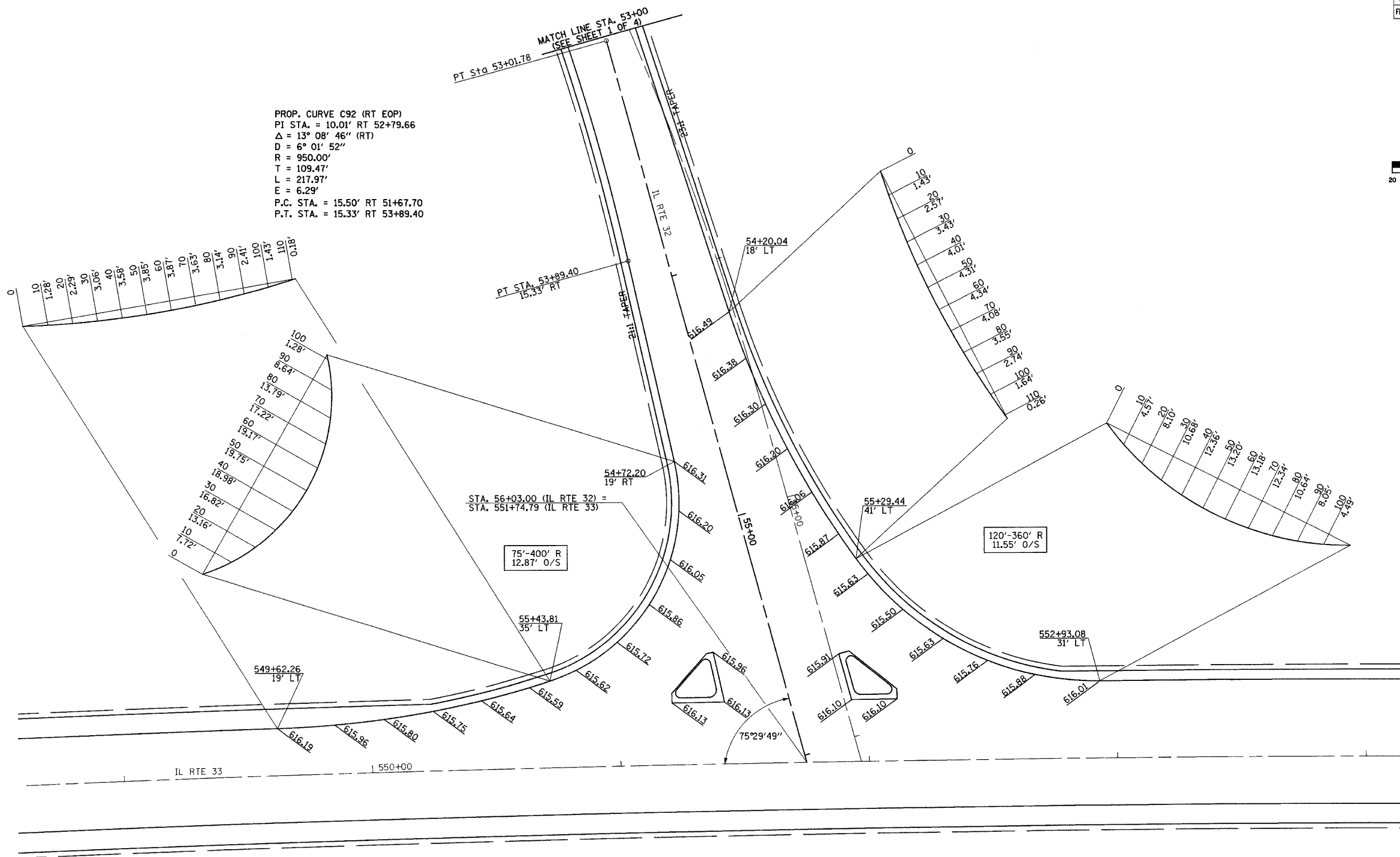

LEGEND

XXXXXX INDICATES PROPOSED GRADE ELEVATION INTERVAL AROUND CURVES IS 20' UNLESS NOTED

REVISIONS	
NAME	DATE

ILLINOIS DEPARTMENT OF TRANSPORTATION  
 INTERSECTION GEOMETRICS  
 SHEET 2 OF 4

IL RTE 32

DATE 8/02 DRAWN BY MLO CHECKED BY SJK