

F.A.P. RTE.	SECTION	COUNTY	TOTAL SHEETS	SHEET NO.
774	(107) N	EFFINGHAM	27	9
STA.		TO STA.		
FED. ROAD DIST. NO.	ILLINOIS	FED. AID PROJECT		

CONTRACT NO. 74131

STA. 201+32.60 (RELOCATED 1200TH ST) =
STA. 300+00.00 (1200TH ST CONNECTOR)

STA. 1015+03.93 (IL RTE 32/33) =
STA. 200+00.00 (RELOCATED 1200TH ST)

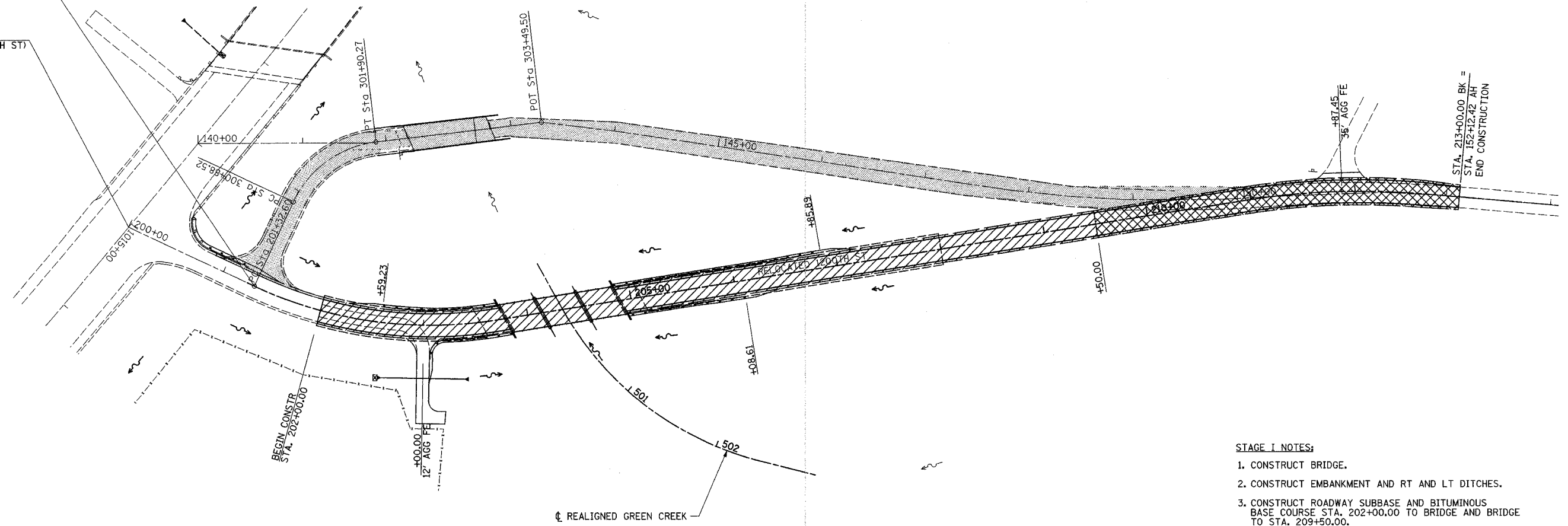

- STAGE I NOTES:**
1. CONSTRUCT BRIDGE.
 2. CONSTRUCT EMBANKMENT AND RT AND LT DITCHES.
 3. CONSTRUCT ROADWAY SUBBASE AND BITUMINOUS BASE COURSE STA. 202+00.00 TO BRIDGE AND BRIDGE TO STA. 209+50.00.
- STAGE II NOTES:**
1. CLOSE 1200TH STREET.
 2. CONSTRUCT EMBANKMENT, SUBBASE, BASE COURSE STA. 209+50.00 TO 213+00.00.
 3. CONSTRUCT SURFACING 202+00.00 TO BRIDGE AND BRIDGE TO STA. 213+00.00.
 4. REMOVE EXISTING BRIDGE AND EXISTING ROADWAY.

LEGEND

	STAGE I
	STAGE II
	REMOVAL, STAGE III

REVISIONS		ILLINOIS DEPARTMENT OF TRANSPORTATION
NAME	DATE	
		TRAFFIC CONTROL PLAN

SCALE: VERT. _____
HORIZ. _____
DATE _____

DRAWN BY _____
CHECKED BY _____