

F.A.P. RTE.	SECTION	COUNTY	TOTAL SHEETS	SHEET NO.
774	*	EFFINGHAM	15	6
STA.	TO STA.			
FED. ROAD DIST. NO.	ILLINOIS	FED. AID PROJECT		
* D-7 WETLAND MITIGATION - 1				

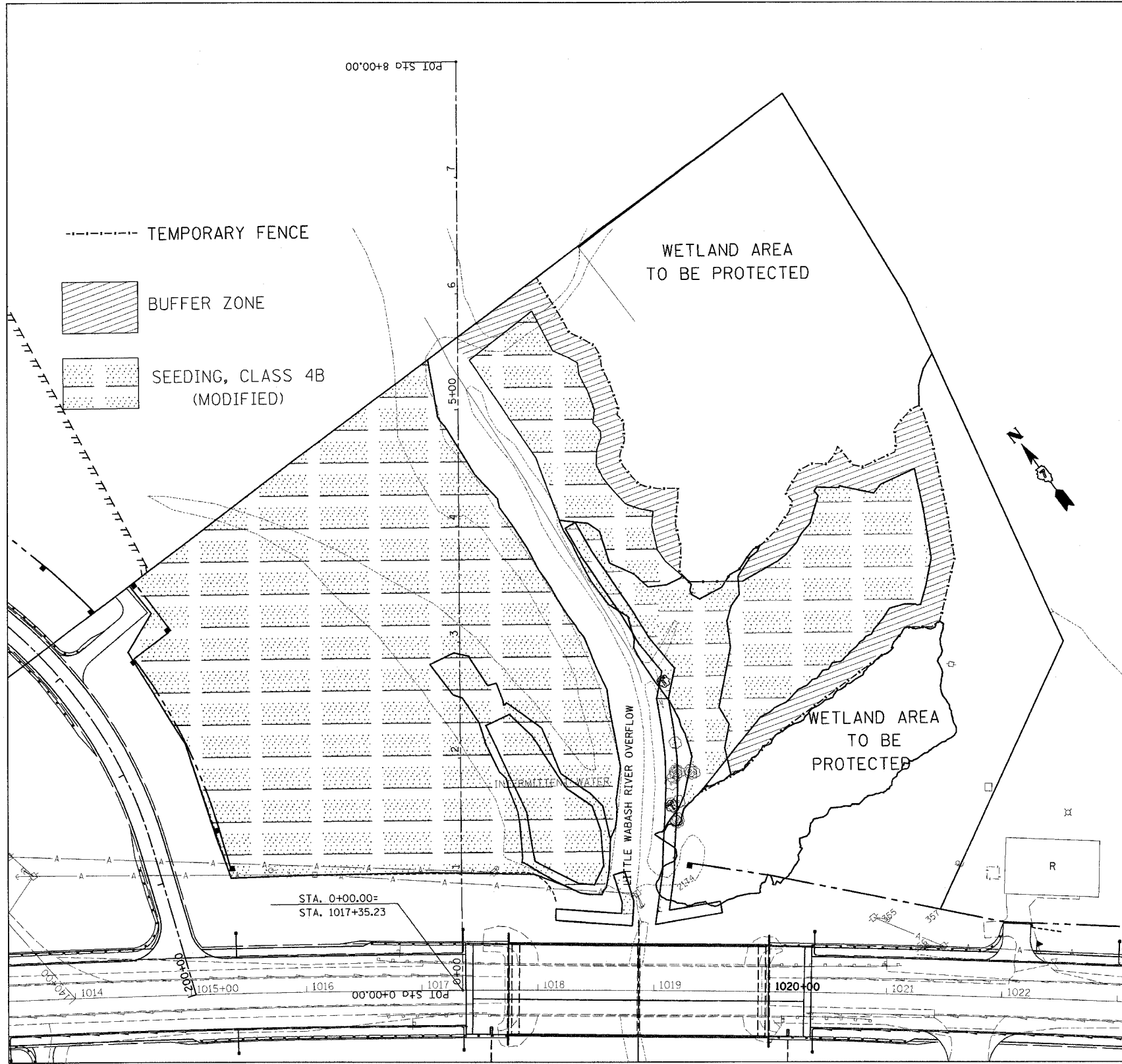

SEEDING SCHEDULE

SEEDING, CLASS 4B (MODIFIED)	4.60	ACRE
MULCH, METHOD 2*	4.60	ACRE
TEMPORARY EROSION CONTROL SEEDING	460	LBS

* USE PROCEDURE 2

MAINTENANCE MOWING	6.8	ACRE
WEED CONTROL, NON-SELECTIVE AND NON-RESIDUAL	3.2	GALLON

REVISIONS	
NAME	DATE

ILLINOIS DEPARTMENT OF TRANSPORTATION

SEEDING, MOWING, SPRAYING DETAIL AND SCHEDULES

SCALE: VERT. DATE: HORIZ. DRAWN BY: CHECKED BY:

PLOT DATE = 4/12/2006
 FILE NAME = #FILEL#
 USER NAME = #USER#