

F.A.I. RTE.	SECTION	COUNTY	TOTAL SHEETS	SHEET NO.
64	82-8RS-1	ST. CLAIR	39	14
STA. 1065+00		TO STA. 1080+00		
FED. ROAD DIST. NO.		ILLINOIS FED. AID PROJECT		

PLAN	DATE
BY	
REVISIONS	
NOTED	
ALIGNED	
CHECKED	
FILED	
NO.	

PROFILE	DATE
BY	
GRADES CHECKED	
STRUCTURE NOTATIONS OK'D	
NO.	

PLOT DATE = 5/29/2006  
 PLOT SCALE = 50.0000 / IN.  
 REFERENCE = REF#

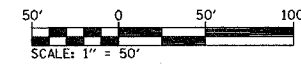
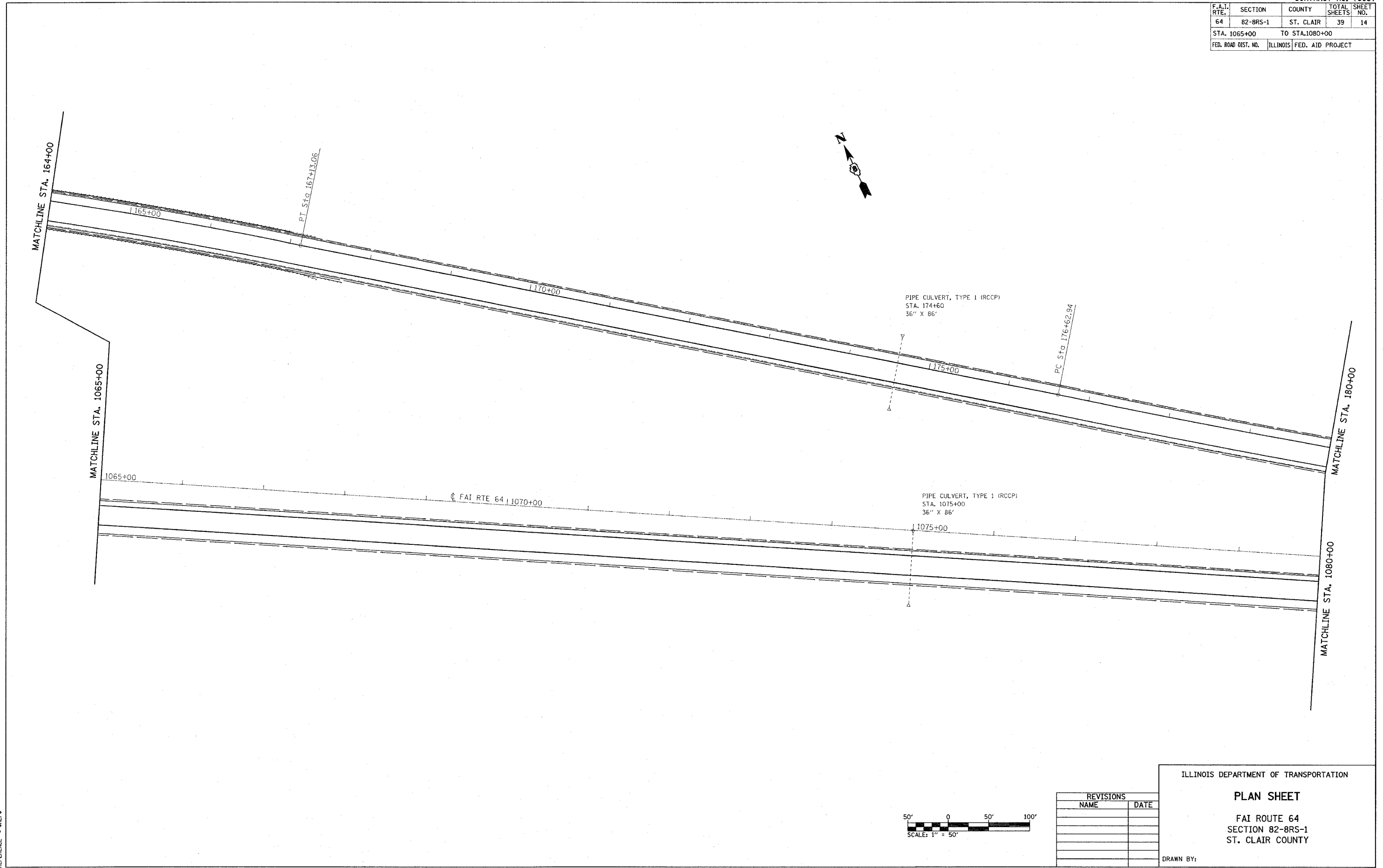

REVISIONS	
NAME	DATE

ILLINOIS DEPARTMENT OF TRANSPORTATION

**PLAN SHEET**

FAI ROUTE 64  
 SECTION 82-8RS-1  
 ST. CLAIR COUNTY

DRAWN BY: