

STATE OF ILLINOIS  
DEPARTMENT OF TRANSPORTATION

**INDEX OF SHEETS**

Sheet No.	Description
1	Gen. Plan, Gen. Notes & Total Bill of Mat'l
2	Superstructure
3	Substructure Details

SHEET 1  
OF 3

F.A.I. RTE.	SECTION	COUNTY	TOTAL SHEETS	SHEET NO.
64	82-8B	ST. CLAIR	39	35
FED. ROAD DIST. NO.		ILLINOIS	FED. AID PROJECT	
CONTRACT NO. T6037				

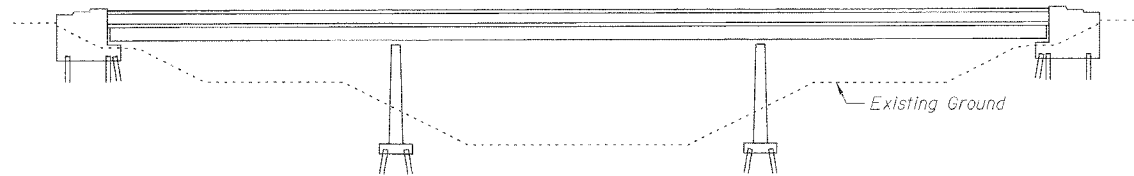

**ELEVATION**

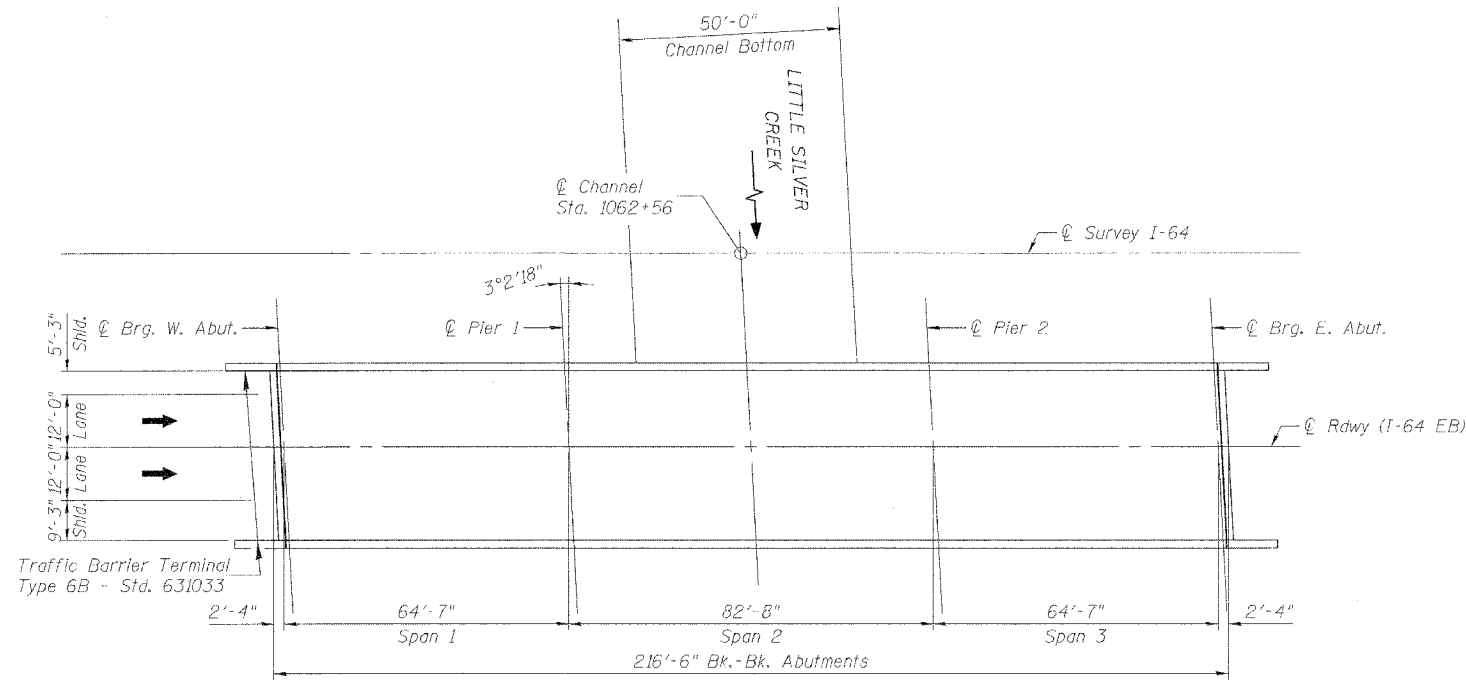

**PLAN**

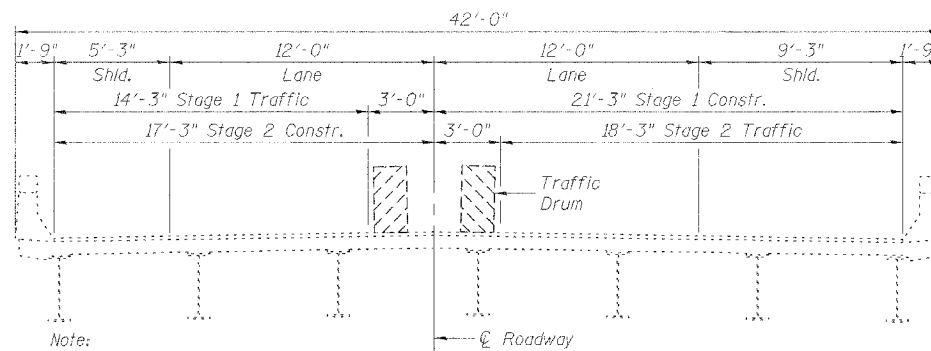

**CROSS SECTION**  
(Looking East)

Note:  
Staging is for information only, to be coordinated with roadway staging.

**GENERAL NOTES**

Plan dimensions and details relative to existing structure have been taken from existing plans and are subject to nominal construction variations. It shall be the Contractor's responsibility to verify such dimensions and details in the field and make necessary approved adjustments prior to construction or ordering of materials. Such variations shall not be cause for additional compensation for a change in the scope of the work, however, the Contractor will be paid for the quantity actually furnished at the unit price for the work.

Reinforcement bars shall conform to the requirements of AASHTO M 31 or M 322 Grade 60. Reinforcement bars designated (E) shall be epoxy coated.

All epoxy grouted bars shall have a minimum embedment as shown on the plans and shall be placed according to Section 584 of the Standard Specifications. Cost of hole drilling and epoxy grouting is included with "Reinforcement Bars, Epoxy Coated".

A Concrete Sealer shall be applied to the surfaces of the deck and parapets (See Special Provisions for BRIDGE DECK CONCRETE SEALER).

**TOTAL BILL OF MATERIAL**

ITEM	UNIT	SUPER	SUB	TOTAL
Stone Riprap, Class A5	Sq Yd	--	292	292
Filter Fabric	Sq Yd	--	292	292
Joint or Crack Filling	Pound	--	313	313
Concrete Structures	Cu Yd	--	0.2	0.2
Reinforcement Bars, Epoxy Coated	Pound	--	40	40
Silicone Joint Sealer, 2"	Foot	41	--	41
Concrete Sealer	Sq Yd	1122	--	1122
Silicone Joint Sealer, 1 3/4"	Foot	41	--	41

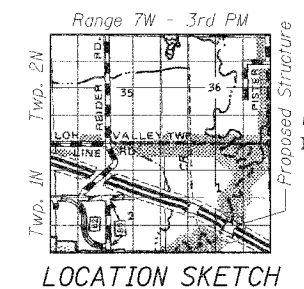

**LOCATION SKETCH**

**GENERAL PLAN**  
FAI 64 (EB) OVER  
LITTLE SILVER CREEK  
FAI ROUTE 64 SECTION 82-8B  
ST. CLAIR COUNTY  
STATION 1062+56  
STRUCTURE NO. 082-0189



Signed: *David Depp*  
Date: 3-10-2006  
Lic. Expires: 11-30-2006

DATE: 02/10/2006 10:52:34 USER: P. Roy FILE: F:\01039\_IL-DBVW\4 I-64 Bridge Repairs (Set 2)\5-SN089-LittleSilverCr-EB\01plan.dgn

**Johnson, Depp & Quisenberry**  
CONSULTING ENGINEERS  
Springfield, Illinois

DESIGNED: CDB	DRAWN: P. Roy
CHECKED: DCD	CHECKED: CDB/DCD