

7612

TR.	SECTION	COUNTY	TOTAL SHEETS	SHEET NO.
336A	31BR	MADISON	11	1

STATE OF ILLINOIS  
DEPARTMENT OF TRANSPORTATION  
DIVISION OF HIGHWAYS

**PROPOSED  
HIGHWAY PLANS**

TR 336A (TROY ROAD  
OVER CANTEEN CREEK)  
SECTION 31BR  
STRUCTURE REPLACEMENT  
MADISON COUNTY  
C-98-002-02

**INDEX OF SHEETS**

- 1 COVER SHEET
- 2 QUANTITIES
- 3 TYPICAL SECTIONS/ GENERAL NOTES
- 4 PLAN/PROFILE SHEET
- 5 DETOUR SIGNING
- 6 CULVERT - GENERAL PLAN
- 7 CULVERT - CULVERT DETAILS
- 8 CULVERT - GUARDRAIL DETAILS
- 9-11 CROSS SECTIONS

**STANDARDS**

000001-04	630001-06
280001-02	630301-03
482001	665001-01
542101	666001
542301	702001-06
	780001-01

D-98-010-04

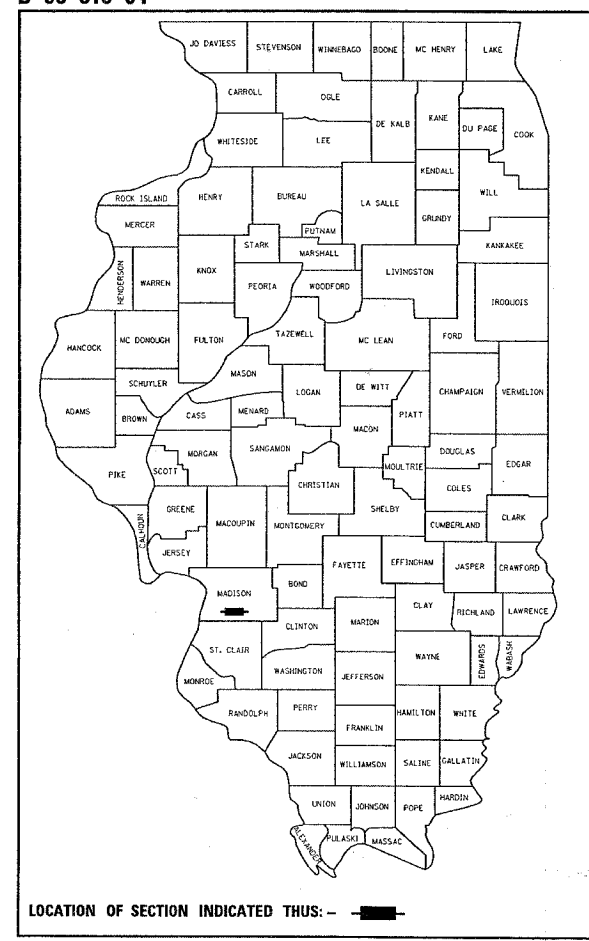

LOCATION OF SECTION INDICATED THUS: — ■ —

MICROFILMED \_\_\_\_\_  
REEL NUMBER \_\_\_\_\_  
AWARDED \_\_\_\_\_  
RESIDENT ENGINEER \_\_\_\_\_  
AS BUILT CHANGES WERE MADE  
ON THE FOLLOWING SHEETS

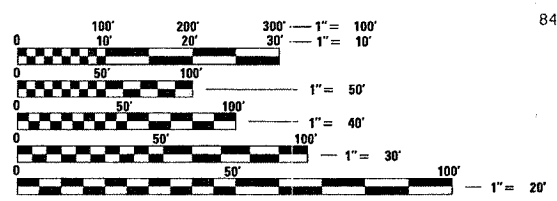

FULL SIZE PLANS HAVE BEEN PREPARED USING STANDARD  
ENGINEERING SCALES. REDUCED SIZED PLANS WILL NOT  
CONFORM TO STANDARD SCALES. IN MAKING MEASUREMENTS  
ON REDUCED PLANS, THE ABOVE SCALES MAY BE USED.

J.U.L.I.E.  
JOINT UTILITY LOCATION INFORMATION FOR EXCAVATION  
1-800-892-0123

**DESIGN DESIGNATION**  
843 (05) LOCAL STREET (URBAN) 0.007 (FD-20)

**TRAFFIC DATA**  
ADT: 1100 (2006)  
ADT: 1500 (2026)  
SU: 1.8%  
MU: 0.5%

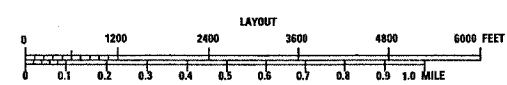
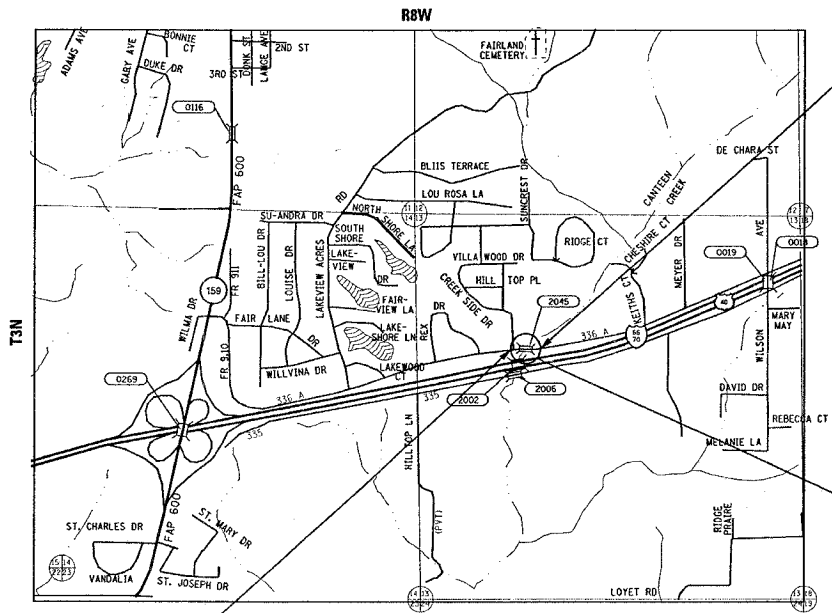

GROSS LENGTH = 200.0 FT = 0.0379 MILES  
NET LENGTH = 200.0 FT = 0.0379 MILES

LATITUDE: 38.701118 LONGITUDE: 89.941444

END PROJECT  
STA. 44 + 20.00

EXISTING S.N. 060-0270  
BEING REPLACED WITH  
DOUBLE 11'x11' BOX CULVERT

STATE OF ILLINOIS  
DEPARTMENT OF TRANSPORTATION  
DIVISION OF HIGHWAYS

SUBMITTED March 27, 2006  
Man Chami  
DEPUTY DIRECTOR OF HIGHWAYS  
REGION FIVE ENGINEER

May 12, 2006  
Mike Stone  
ENGINEER OF DESIGN AND ENVIRONMENT

May 12, 2006  
William P. Sees P.E.  
DIRECTOR, DIVISION OF HIGHWAYS

**PRINTED BY THE AUTHORITY  
OF THE STATE OF ILLINOIS**

PROJECT ENGINEER: PATTI LeBEAU (618) 346-3179  
SQUAD CONTACT: ART MUEHLFELD (618) 346-3209

CONTRACT NO. 76121