

T.R. RTE.	SECTION	COUNTY	TOTAL SHEETS	SHEET NO.
336A	31 BR	MADISON	11	4
STA. N/A	TO STA. N/A			
FED. ROAD DIST. NO.	ILLINOIS	FED. AID PROJECT		

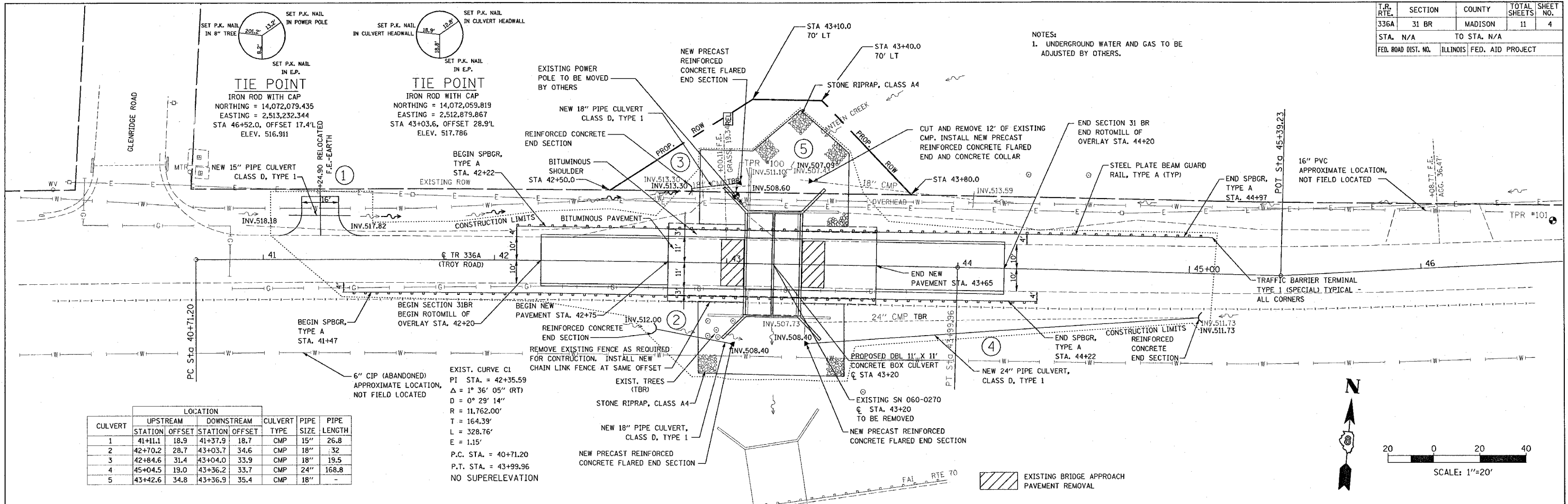

CULVERT	LOCATION				CULVERT TYPE	PIPE SIZE	PIPE LENGTH
	UPSTREAM STATION	UPSTREAM OFFSET	DOWNSTREAM STATION	DOWNSTREAM OFFSET			
1	41+11.1	18.9	41+37.9	18.7	CMP	15"	26.8
2	42+70.2	28.7	43+03.7	34.6	CMP	18"	32
3	42+84.6	31.4	43+04.0	33.9	CMP	18"	19.5
4	45+04.5	19.0	43+36.2	33.7	CMP	24"	168.8
5	43+42.6	34.8	43+36.9	35.4	CMP	18"	-

EXIST. CURVE C1
 PI STA. = 42+35.59
 $\Delta = 1^\circ 36' 05''$ (RT)
 $D = 0^\circ 29' 14''$
 $R = 11,762.00'$
 $T = 164.39'$
 $L = 328.76'$
 $E = 1.15'$
 P.C. STA. = 40+71.20
 P.T. STA. = 43+99.96
 NO SUPERELEVATION

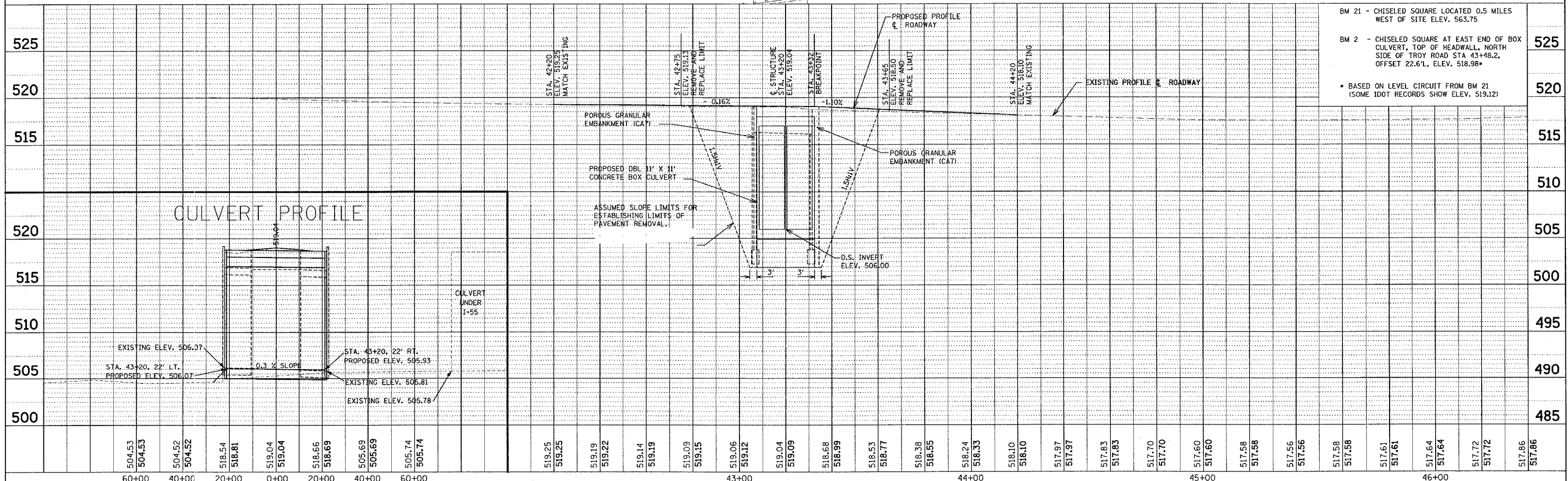
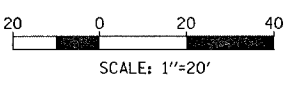

BM 21 - CHISELED SQUARE LOCATED 0.5 MILES WEST OF SITE ELEV. 563.75
 BM 2 - CHISELED SQUARE AT EAST END OF BOX CULVERT, TOP OF HEADWALL, NORTH SIDE OF TROY ROAD STA 43+48.2, OFFSET 22.6'L, ELEV. 518.98*
 * BASED ON LEVEL CIRCUIT FROM BM 21 (SOME IDOT RECORDS SHOW ELEV. 519.12)

PLAN SURVEYED, PLOTTED, CHECKED, REVISIONS, DATE, BY, NO. OF SHEETS, DATE OF WAY CREATION, CAD FILE NAME

PROFILE SURVEYED, PLOTTED, CHECKED, REVISIONS, DATE, BY, NO. OF SHEETS, DATE OF WAY CREATION, STRUCTURE NOTATIONS CHECKED