

F.A.P. RTE.	SECTION	COUNTY	TOTAL SHEETS	SHEET NO.
310		MADISON	452	44
STA. 1+275.000		TO STA. 1+550.000		
FED. ROAD DIST. NO.		ILLINOIS FED. AID PROJECT		
SECTION 60-14		SECTION 60-14-1B		
CONTRACT NO. 76321				

**CURVE P-RMP3MNL-1**  
 PI Sta. 1+308.272  
 $\Delta = 23^\circ 21' 15.2''$  (RT)  
 T = 53.735 m  
 R = 260.000 m  
 L = 105.978 m  
 E = 5.495 m  
 PC Sta. 1+254.537  
 PT Sta. 1+360.515  
 SE 3.0%  
 TR = 18.375m  
 SE RUN = 39.578m  
 SE ATTAINED Sta. 1+200.937 TO Sta. 1+280.937  
 SE REMOVED Sta. 1+320.515 TO Sta. 1+400.515

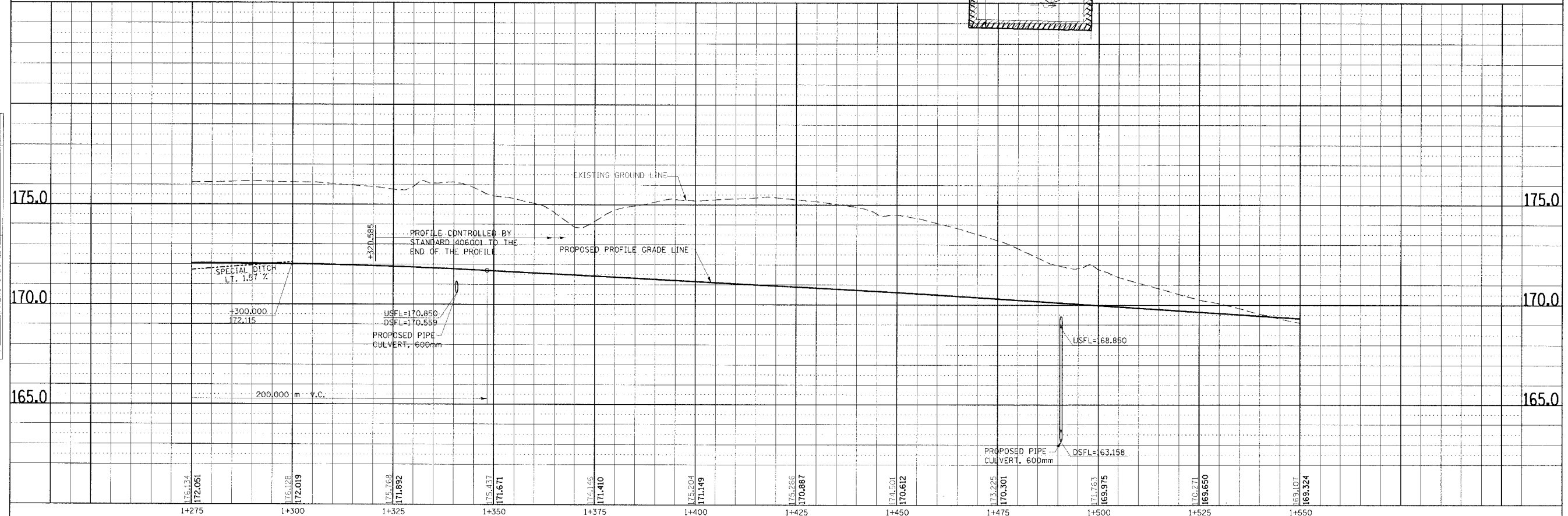
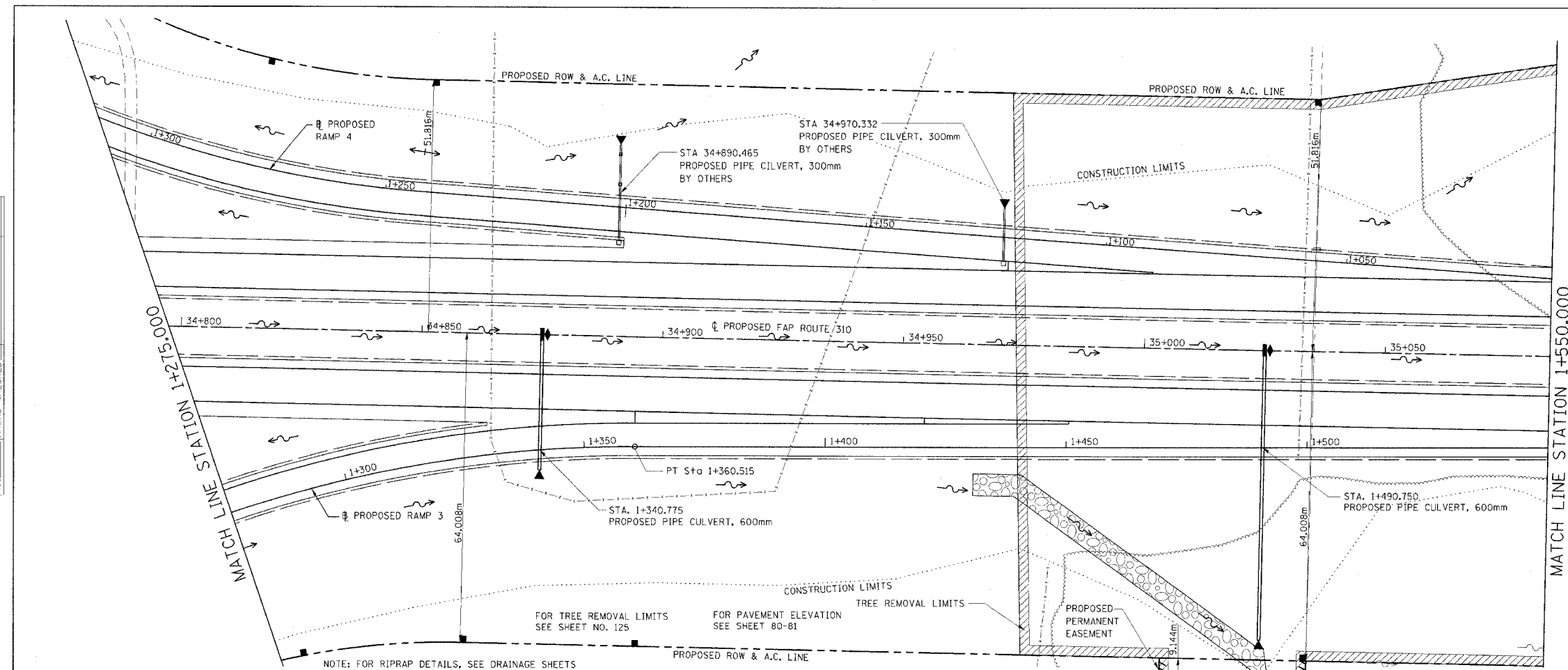

PLAN & PROFILE, RAMP 3, STA. 1+275.000 TO STA. 1+550.000

FINAL SURVEY	BY	DATE
SURVEY PLOTTED		
NOTE BOOK TEMPLATE		
AREAS CHECKED		
NO.		

ORIGINAL SURVEY	BY	DATE
SURVEY PLOTTED		
NOTE BOOK TEMPLATE		
AREAS CHECKED		
NO.		