

F.A.P. RTE.	SECTION	COUNTY	TOTAL SHEETS	SHEET NO.
310		MADISON	452	71
STA.		TO STA.		
FED. ROAD DIST. NO.		ILLINOIS FED. AID PROJECT		

SECTION 60-14
SECTION 60-14-1B
CONTRACT NO. 76321

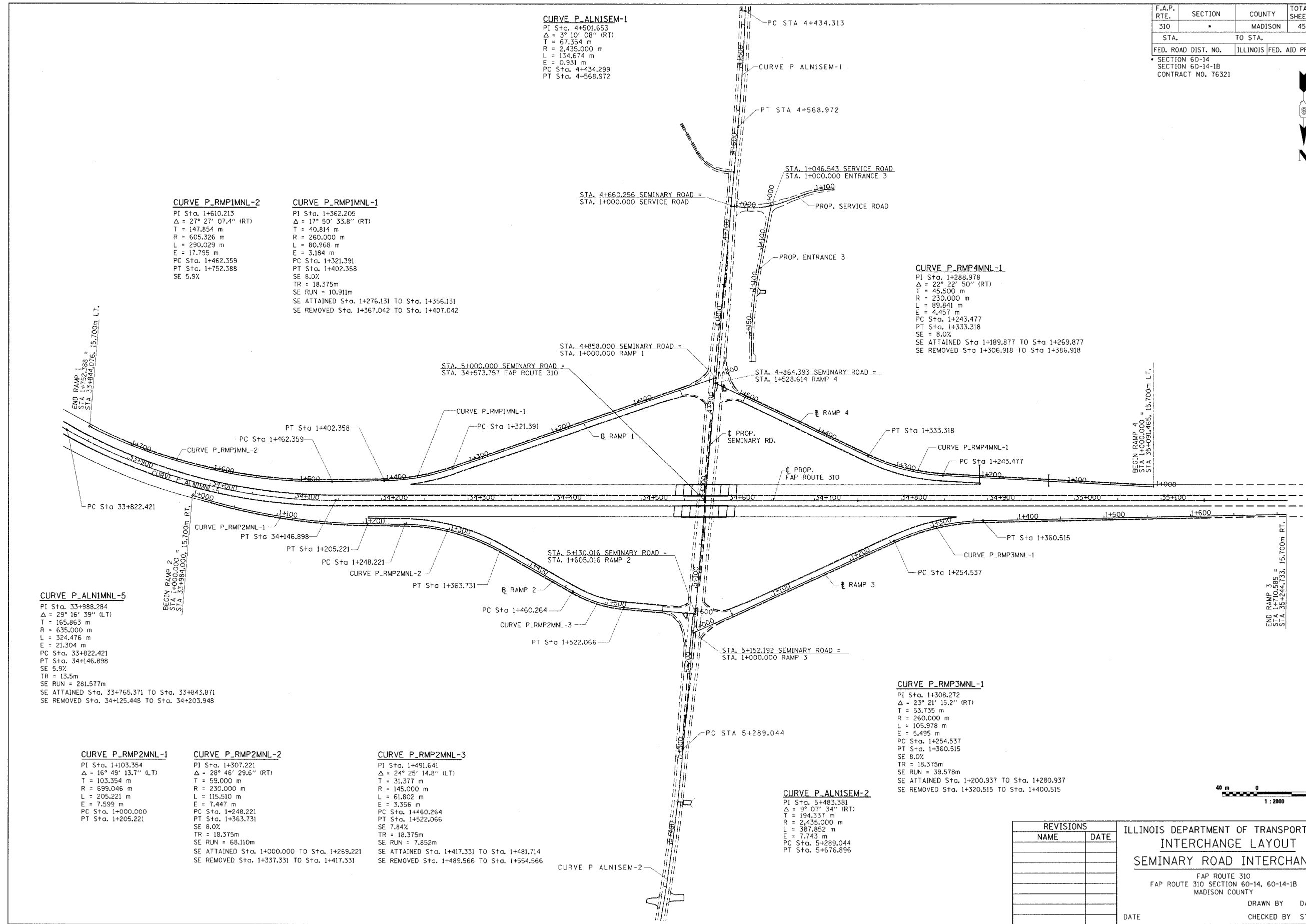

CURVE P_RMP1MNL-2
PI Sta. 1+610.213
Δ = 27° 27' 07.4" (RT)
T = 147.854 m
R = 605.326 m
L = 290.029 m
E = 17.795 m
PC Sta. 1+462.359
PT Sta. 1+752.388
SE 5.9%

CURVE P_RMP1MNL-1
PI Sta. 1+362.205
Δ = 17° 50' 33.8" (RT)
T = 40.814 m
R = 260.000 m
L = 80.968 m
E = 3.184 m
PC Sta. 1+321.391
PT Sta. 1+402.358
SE 8.0%
TR = 18.375m
SE RUN = 10.911m
SE ATTAINED Sta. 1+276.131 TO Sta. 1+356.131
SE REMOVED Sta. 1+367.042 TO Sta. 1+407.042

CURVE P_RMP4MNL-1
PI Sta. 1+288.978
Δ = 22° 22' 50" (RT)
T = 45.500 m
R = 230.000 m
L = 89.841 m
E = 4.457 m
PC Sta. 1+243.477
PT Sta. 1+333.318
SE 8.0%
SE ATTAINED Sta 1+189.877 TO Sta 1+269.877
SE REMOVED Sta 1+306.918 TO Sta 1+386.918

CURVE P_ALNIMNL-5
PI Sta. 33+988.284
Δ = 29° 16' 39" (LT)
T = 165.863 m
R = 635.000 m
L = 324.476 m
E = 21.304 m
PC Sta. 33+822.421
PT Sta. 34+146.898
SE 5.9%
TR = 13.5m
SE RUN = 281.577m
SE ATTAINED Sta. 33+765.371 TO Sta. 33+843.871
SE REMOVED Sta. 34+125.448 TO Sta. 34+203.948

CURVE P_RMP2MNL-1
PI Sta. 1+103.354
Δ = 16° 48' 13.7" (LT)
T = 103.354 m
R = 699.046 m
L = 205.221 m
E = 7.599 m
PC Sta. 1+000.000
PT Sta. 1+205.221

CURVE P_RMP2MNL-2
PI Sta. 1+307.221
Δ = 28° 46' 29.6" (RT)
T = 59.000 m
R = 230.000 m
L = 115.510 m
E = 7.447 m
PC Sta. 1+248.221
PT Sta. 1+363.731
SE 8.0%
TR = 18.375m
SE RUN = 68.110m
SE ATTAINED Sta. 1+000.000 TO Sta. 1+269.221
SE REMOVED Sta. 1+337.331 TO Sta. 1+417.331

CURVE P_RMP2MNL-3
PI Sta. 1+491.641
Δ = 24° 25' 14.8" (LT)
T = 31.377 m
R = 145.000 m
L = 61.802 m
E = 3.356 m
PC Sta. 1+460.264
PT Sta. 1+522.066
SE 7.84%
TR = 18.375m
SE RUN = 7.852m
SE ATTAINED Sta. 1+417.331 TO Sta. 1+481.714
SE REMOVED Sta. 1+489.566 TO Sta. 1+554.566

CURVE P_ALNISEM-2
PI Sta. 5+483.381
Δ = 9° 07' 34" (RT)
T = 194.337 m
R = 2,435.000 m
L = 387.852 m
E = 7.743 m
PC Sta. 5+289.044
PT Sta. 5+676.896

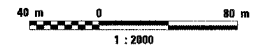

REVISIONS	
NAME	DATE

ILLINOIS DEPARTMENT OF TRANSPORTATION
INTERCHANGE LAYOUT
SEMINARY ROAD INTERCHANGE
FAP ROUTE 310
FAP ROUTE 310 SECTION 60-14, 60-14-1B
MADISON COUNTY
DRAWN BY DAVID
CHECKED BY STEUART
DATE

INTERCHANGE LAYOUT, SEMINARY ROAD INTERSECTION