

F.A.P. RTE.	SECTION	COUNTY	TOTAL SHEETS	SHEET NO.
310		MADISON	452	125
STA. 32+850.000		TO STA. 35+650.000		
FED. ROAD DIST. NO.		ILLINOIS FED. AID PROJECT		

SECTION 60-14
SECTION 60-14-1B
TREE REMOVAL
(BY OTHERS)
SECTION 60-14-1

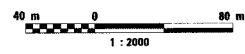
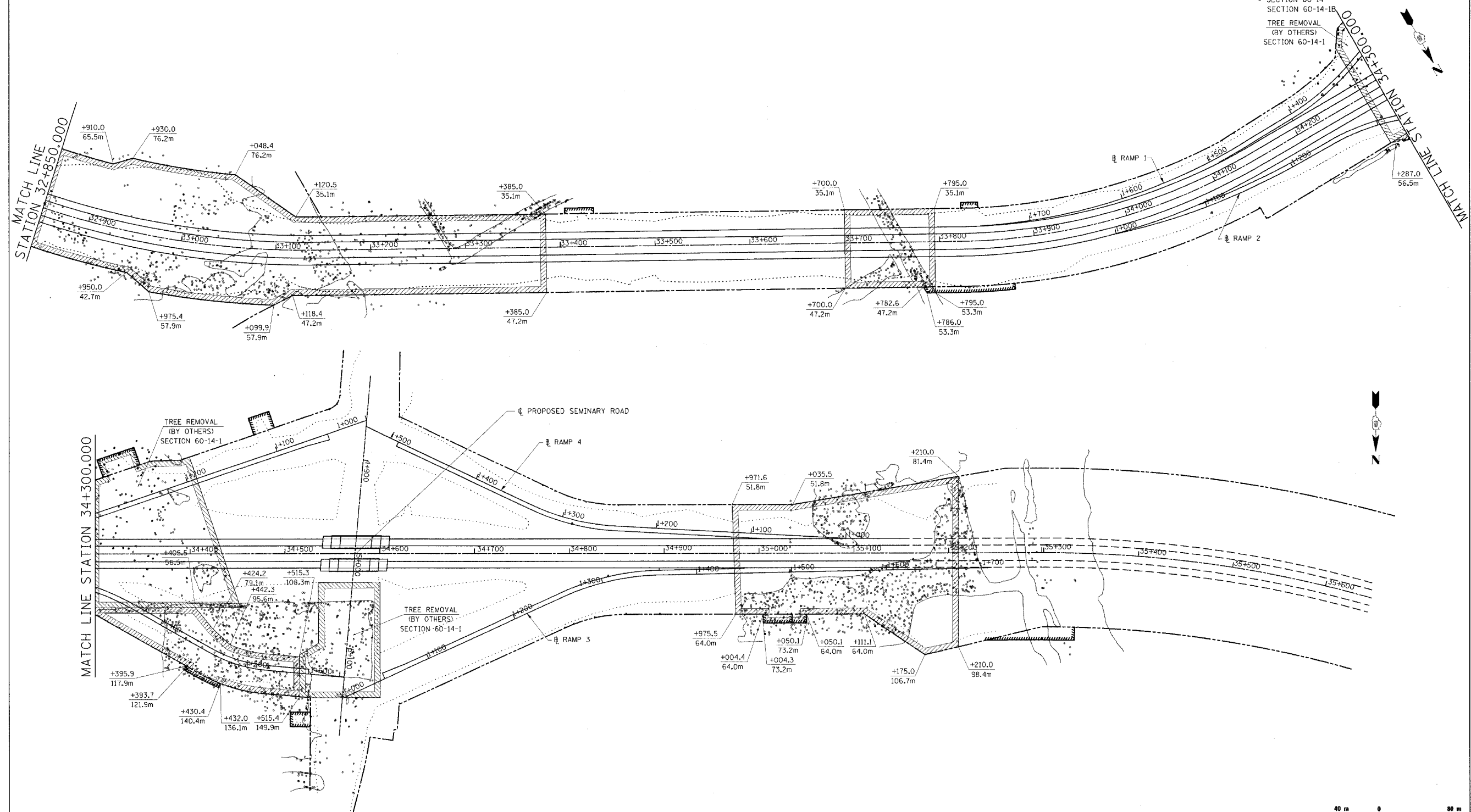

LIMITS OF TREE REMOVAL

REVISIONS	
NAME	DATE

ILLINOIS DEPARTMENT OF TRANSPORTATION
TREE REMOVAL AREAS
FAP ROUTE 310
FAP ROUTE 310 SECTION 60-14
MADISON COUNTY
DRAWN BY BANDY
CHECKED BY STEUART
DATE

TREE REMOVAL AREAS, FAP 310, STA. 32+850.000 TO STA. 35+650.000