

F.A.P. RTE.	SECTION	COUNTY	TOTAL SHEETS	SHEET NO.
310		MADISON	452	189
STA. 32+935.000		TO STA.		
FED. ROAD DIST. NO.	ILLINOIS	FED. AID PROJECT		
* SECTION 60-14				
SECTION 60-14-1B				

FINAL
 SURVEY
 FOR ROAD
 WORKS
 NO.

ORIGINAL
 SURVEY
 FOR ROAD
 WORKS
 NO.

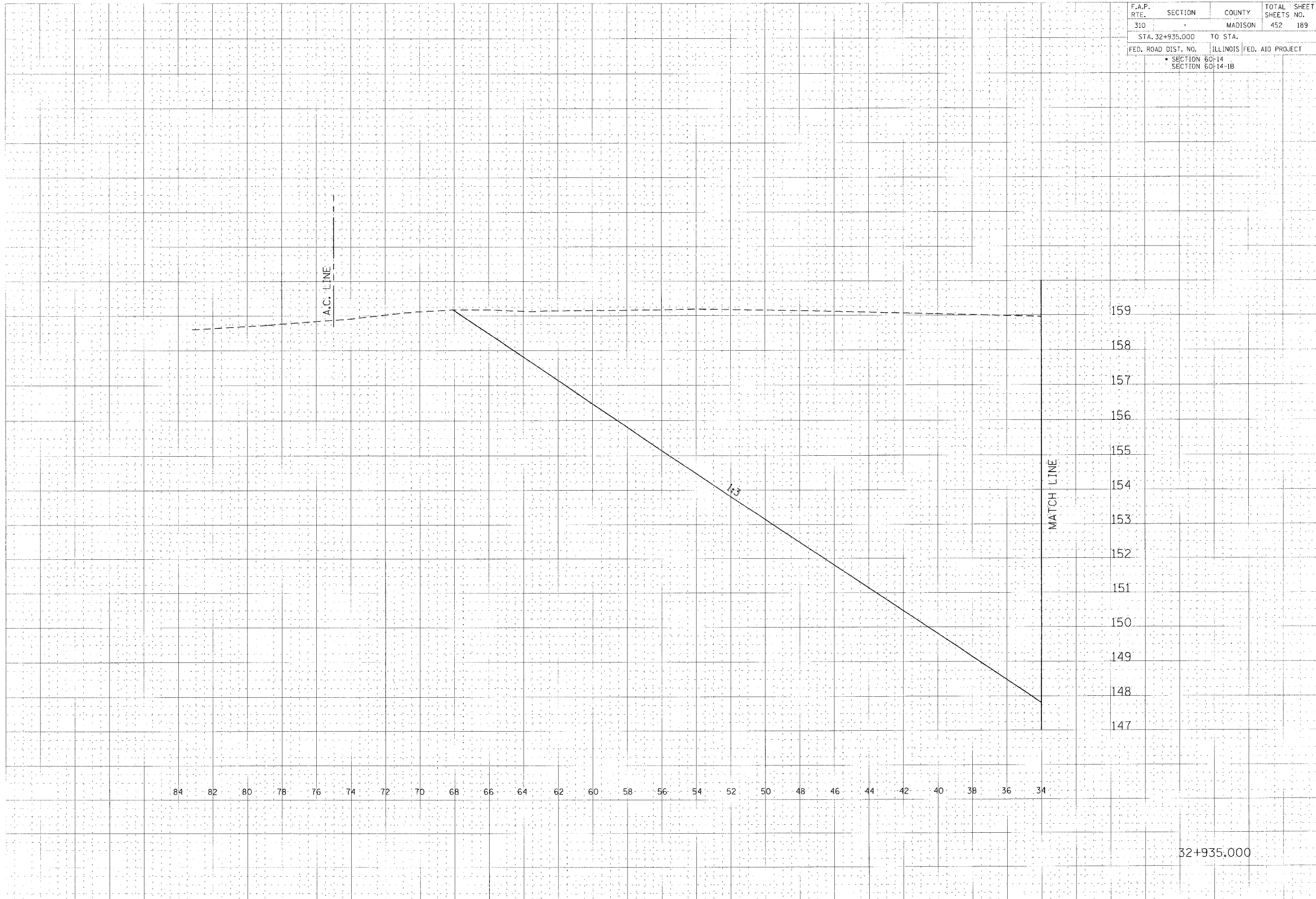

CULVERT PROFILE, FAP ROUTE 310, STA 32+935.000