

36 34 32 30 28 26 24 22 20 18 16 14 12 10 8 6 4 2 0 2 4 6 8 10 12 14 16 18 20 22 24 26

| | | | | |
|---------------------|------------------|------------------|--------------|-----------|
| F.A.P. RTE. | SECTION | COUNTY | TOTAL SHEETS | SHEET NO. |
| 310 | | MADISON | 452 | 200 |
| STA. 33+800.000 | | TO STA. | | |
| FED. ROAD DIST. NO. | ILLINOIS | FED. AID PROJECT | | |
| | SECTION 60-14 | | | |
| | SECTION 60-14-1B | | | |

| | |
|---------|--|
| DATE | |
| BY | |
| PROJECT | |
| SCALE | |
| DATE | |
| BY | |
| PROJECT | |
| SCALE | |

| | |
|---------|--|
| DATE | |
| BY | |
| PROJECT | |
| SCALE | |
| DATE | |
| BY | |
| PROJECT | |
| SCALE | |

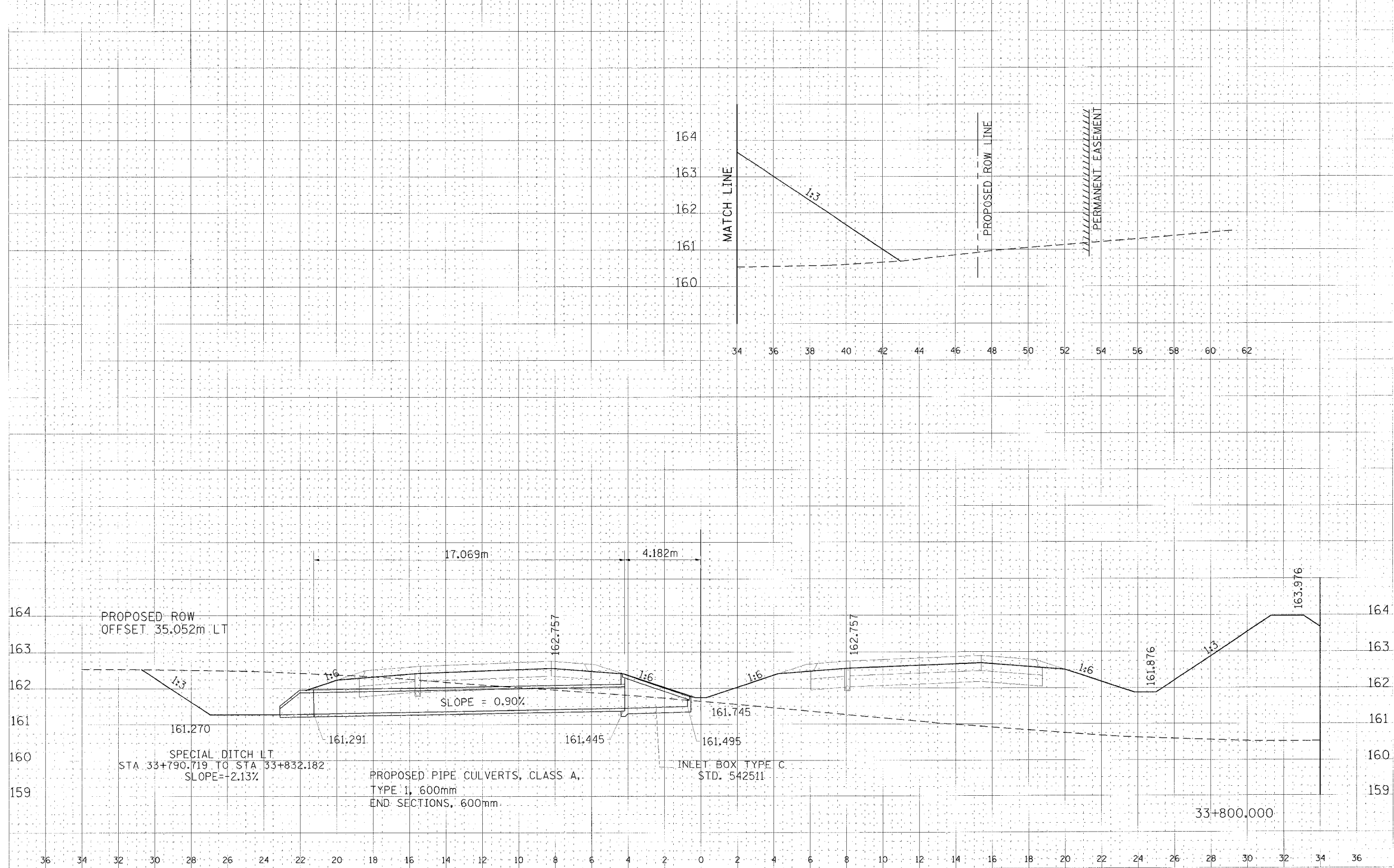

CULVERT PROFILE, FAP ROUTE 310, STA 33+800.000

33+800.000