

SUMMARY OF QUANTITIES

FED. ROUTE	SECTION	COUNTY	TOTAL SHEETS	SHEET NO.
314	110-1VBR-1	MADISON	77	3
STA.		TO STA.		
CONTRACT NO.: 76549				

SUMMARY OF QUANTITIES			CONSTRUCTION TYPE CODE		
CODE NO	ITEM	UNIT	TOTAL QUANTITIES	I000 20% STATE 80% FEDERAL	X02B-2A 20% STATE 80% FEDERAL
20100110	TREE REMOVAL (6 TO 15 UNITS DIAMETER)	UNIT	12	12	
20100500	TREE REMOVAL, ACRES	ACRE	2	2	
20200100	EARTH EXCAVATION	CU YD	48265	48265	
20400800	FURNISHED EXCAVATION	CU YD	6725	6725	
25000200	SEEDING, CLASS 2	ACRE	6.5	6.5	
X2510630	HEAVY DUTY EROSION CONTROL BLANKET	SQ YD	498	401	97
28000250	TEMPORARY EROSION CONTROL SEEDING	POUND	800	800	
28000300	TEMPORARY DITCH CHECKS	EACH	20	20	
28000400	PERIMETER EROSION BARRIER	FOOT	11062	11062	
28000500	INLET AND PIPE PROTECTION	EACH	24	24	
28100105	STONE RIPRAP, CLASS A3	SQ YD	205		205
28100107	STONE RIPRAP, CLASS A4	SQ YD	20	20	
28200200	FILTER FABRIC	SQ YD	225	20	205
30200650	PROCESSING MODIFIED SOIL 12"	SQ YD	12020	12020	
30201500	LIME	TON	231.5	231.5	
35102000	AGGREGATE BASE COURSE, TYPE B 8"	SQ YD	457	457	
40200800	AGGREGATE SURFACE COURSE, TYPE B	TON	772	772	
40600200	BITUMINOUS MATERIALS (PRIME COAT)	TON	1	1	
40600300	AGGREGATE (PRIME COAT)	TON	5	5	
40600980	BITUMINOUS SURFACE REMOVAL - BUTT JOINT	SQ YD	174	174	
40600990	TEMPORARY RAMP	SQ YD	29	29	
40800040	INCIDENTAL BITUMINOUS CONCRETE SURFACE	TON	20	20	
42300200	PORTLAND CEMENT CONCRETE DRIVEWAY PAVEMENT 6"	SQ YD	117	117	
X4073081	BITUMINOUS CONCRETE PAVEMENT (FULL-DEPTH), SUPERPAVE, 10"	SQ YD	6560	6560	
X4073136	BITUMINOUS CONCRETE PAVEMENT (FULL-DEPTH), SUPERPAVE, TYPE 1 12 3/4"	SQ YD	5000	5000	
44000030	BITUMINOUS SURFACE REMOVAL (VARIABLE DEPTH)	SQ YD	2679	2679	
44000100	PAVEMENT REMOVAL	SQ YD	10861	10861	
44000200	DRIVEWAY PAVEMENT REMOVAL	SQ YD	198	198	
44000400	GUTTER REMOVAL	FOOT	4823	4823	
48100500	AGGREGATE SHOULDERS, TYPE A 6"	SQ YD	1619	1619	
48202600	BITUMINOUS SHOULDERS SUPERPAVE 8"	SQ YD	1611	1611	

SUMMARY OF QUANTITIES			CONSTRUCTION TYPE CODE		
CODE NO	ITEM	UNIT	TOTAL QUANTITIES	I000 20% STATE 80% FEDERAL	X02B-2A 20% STATE 80% FEDERAL
50100100	REMOVAL OF EXISTING STRUCTURES	EACH	1		1
50105210	REMOVE EXISTING CULVERTS	FOOT	198	198	
50800105	REINFORCEMENT BARS	POUND	18570		18570
50800205	REINFORCEMENT BARS, EPOXY COATED	POUND	7550		7550
51500100	NAME PLATES	EACH	1		1
54003000	CONCRETE BOX CULVERTS	CU YD	173.4		173.4
54201480	PIPE CULVERTS, TYPE 2, CORRUGATED STEEL OR ALUMINUM CULVERT PIPE 15"	FOOT	254	254	
54215985	REINFORCED CONCRETE PIPE ELBOW 30"	EACH	1	1	
5422A024	PIPE CULVERTS, CLASS A, TYPE 2 24" (TEMPORARY)	FOOT	287	287	
5422A030	PIPE CULVERTS, CLASS A, TYPE 2 30" (TEMPORARY)	FOOT	104	104	
54248500	CONCRETE HEADWALLS	CU YD	1.2	1.2	
542A1069	PIPE CULVERTS, CLASS A, TYPE 2 24"	FOOT	206	206	
59100100	GEOCOMPOSITE WALL DRAIN	SQ YD	210		210
60500060	REMOVING INLETS	EACH	4	4	
* 63000000	STEEL PLATE BEAM GUARD RAIL, TYPE A	FOOT	1900	1900	△
63000025	STEEL PLATE BEAM GUARD RAIL, ATTACHED TO STRUCTURES	FOOT	75	75	△
* 63100167	TRAFFIC BARRIER TERMINAL TYPE 1, SPECIAL (TANGENT)	EACH	8	8	△
63200310	GUARDRAIL REMOVAL	FOOT	1050	1050	
63500105	DELINEATORS	EACH	14	14	
67000400	ENGINEER'S FIELD OFFICE, TYPE A	CAL MO	7	7	
67100100	MOBILIZATION	L SUM	1	1	
70100200	TRAFFIC CONTROL AND PROTECTION, STANDARD 701331	EACH	1	1	
70100450	TRAFFIC CONTROL AND PROTECTION, STANDARD 701201	L SUM	1	1	
70100500	TRAFFIC CONTROL AND PROTECTION, STANDARD 701326	L SUM	1	1	
70103815	TRAFFIC CONTROL SURVEILLANCE	CAL DA	15	15	
70300100	SHORT-TERM PAVEMENT MARKING	FOOT	62	62	
70301000	WORK ZONE PAVEMENT MARKING REMOVAL	SQ FT	5208	5208	
70500100	TEMPORARY STEEL PLATE BEAM GUARD RAIL, TYPE A	FOOT	562.5	562.5	
* 78000200	THERMOPLASTIC PAVEMENT MARKING - LINE 4"	FOOT	10098	10098	
* 78001110	PAINT PAVEMENT MARKING - LINE 4"	FOOT	9847	9847	
* 78100100	RAISED REFLECTIVE PAVEMENT MARKER	EACH	29	29	

ADDITIONAL
DATE-TIME
CON-SPEC
REF
REF

*SPECIALTY ITEMS

△ Rev. 6-6-06

PLOT DATE: *DATE-TIME*

SUMMARY OF QUANTITIES

FWP NO.	SECTION	COUNTY	TOTAL SHEETS	SHEET NO.
314	110-1VBR-1	MADISON	77	4
STA.		TO STA.		
CONTRACT NO.: 76549				

SUMMARY OF QUANTITIES			TOTAL QUANTITIES	CONSTRUCTION TYPE CODE	
CODE NO	ITEM	UNIT		I000 20% STATE 80% FEDERAL	X020-2A 20% STATE 80% FEDERAL
* 78200410	GUARDRAIL MARKERS, TYPE A	EACH	36	36	
* 78201000	TERMINAL MARKER - DIRECT APPLIED	EACH	10	10	
78300200	RAISED REFLECTIVE PAVEMENT MARKER REMOVAL	EACH	29	29	
X4066416	BITUMINOUS CONCRETE SURFACE COURSE, SUPERPAVE, MIX "C", N70	TON	526	526	
X4066490	BITUMINOUS CONCRETE SURFACE COURSE, SUPERPAVE, IL 9.5L (LOW ESAL)	TON	48	48	
X4066616	BITUMINOUS CONCRETE BINDER COURSE, SUPERPAVE, IL-19.0, N70	TON	226	226	
X7050167	TEMPORARY TRAFFIC BARRIER TERMINAL, TYPE 1, SPECIAL (TANGENT)	EACH	2	2	△
X0323013	TUBULAR STEEL GATE	EACH	1	1	
66600105	FURNISHING AND ERECTING RIGHT-OF-WAY MARKERS	EACH	14	14	
X0325445	RIGHT-OF-WAY AND PROPERTY CORNERS	EACH	7	7	
Z0064505	SECTION CORNER MARKERS	EACH	1	1	
70100460	TRAFFIC CONTROL AND PROTECTION, STANDARD 701306	L SUM	1	1	
70101835	TRAFFIC CONTROL AND PROTECTION, BLR 22	L SUM	1	1	

SUMMARY OF QUANTITIES				CONSTRUCTION TYPE CODE		
CODE NO	ITEM	UNIT	TOTAL QUANTITIES			

* SPECIALTY ITEMS

FIP ROUTE	SECTION	COUNTY	TOTAL SHEETS	SHEET NO
314	110-1VBR-1	MADISON	77	10

PLAN AND PROFILE OF MAINLINE
CONTRACT NO.: 76549

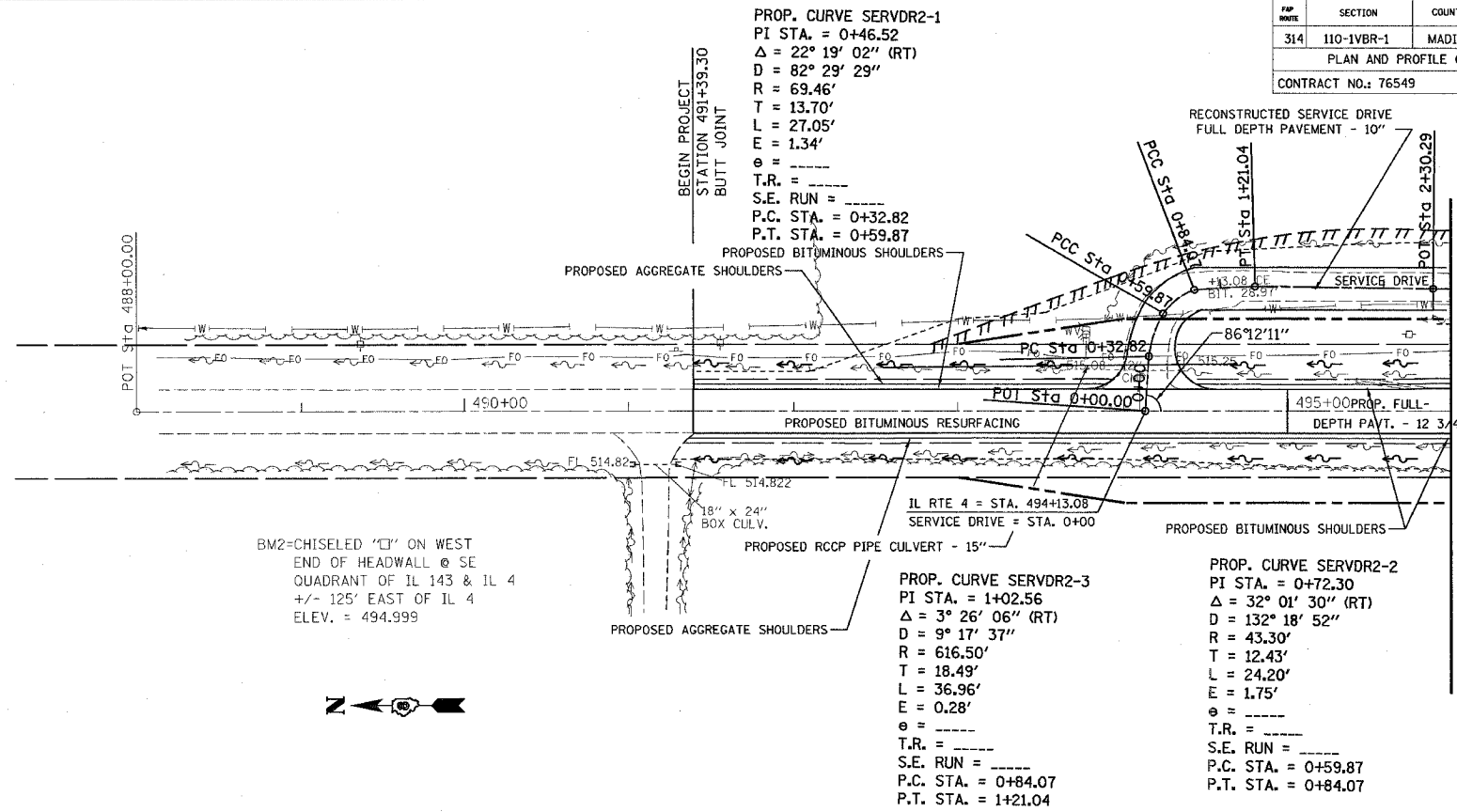

BM2=CHISELED "C" ON WEST END OF HEADWALL @ SE QUADRANT OF IL 143 & IL 4 +/- 125' EAST OF IL 4 ELEV. = 494.999

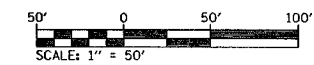

PLAN

DATE	BY

SURVEYED
 ALIGNMENT CHECKED
 PLAN CHECKED
 FILE NAME

PROFILE

DATE	BY

SURVEYED
 GRADES CHECKED
 PLAN CHECKED
 NOTES CHECKED

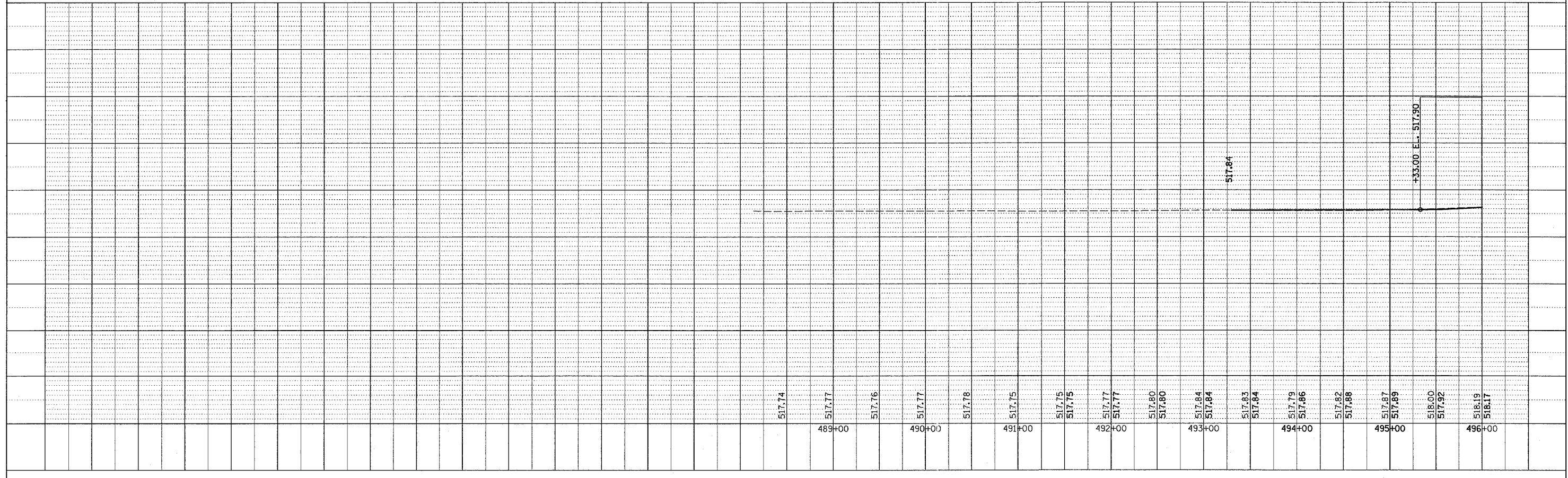

6/5/2006
 6/5/2006
 REF: 211-11e000220

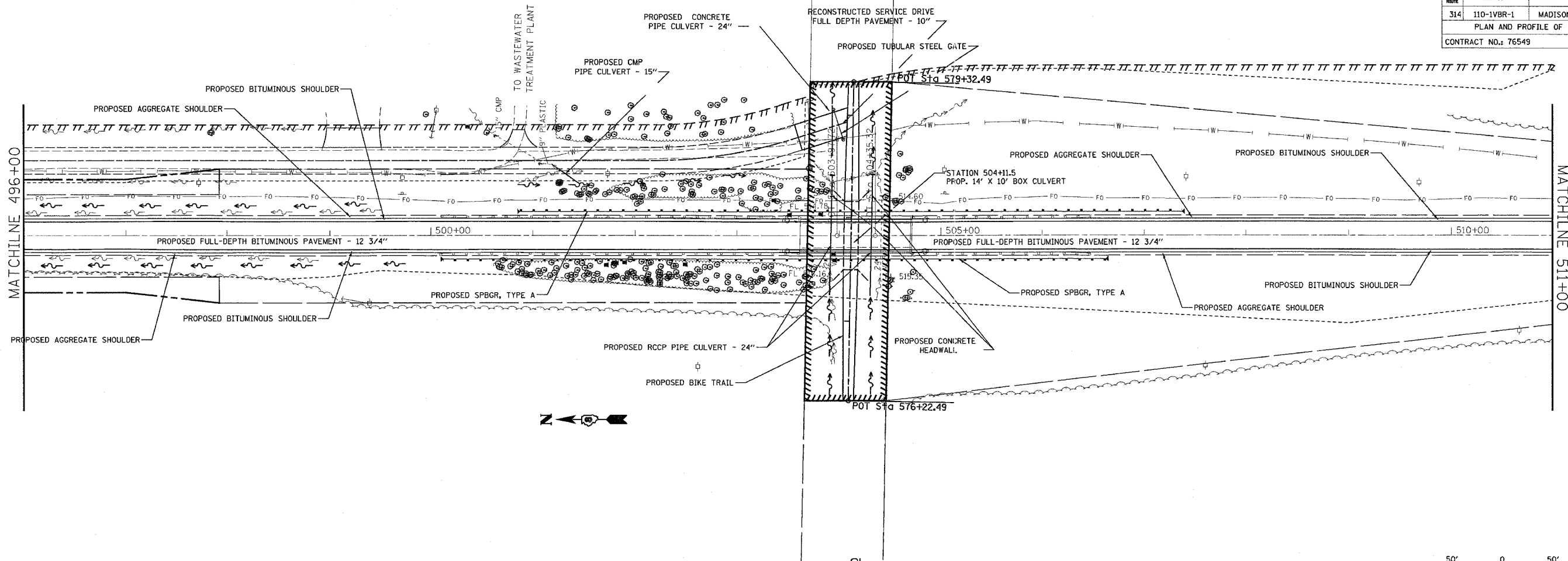

PLAN	SURVEYED	DATE
	BY	
	CHECKED	
	DATE	
	BY	
	CHECKED	
	DATE	

PROFILE	SURVEYED	DATE
	BY	
	CHECKED	
	DATE	
	BY	
	CHECKED	
	DATE	

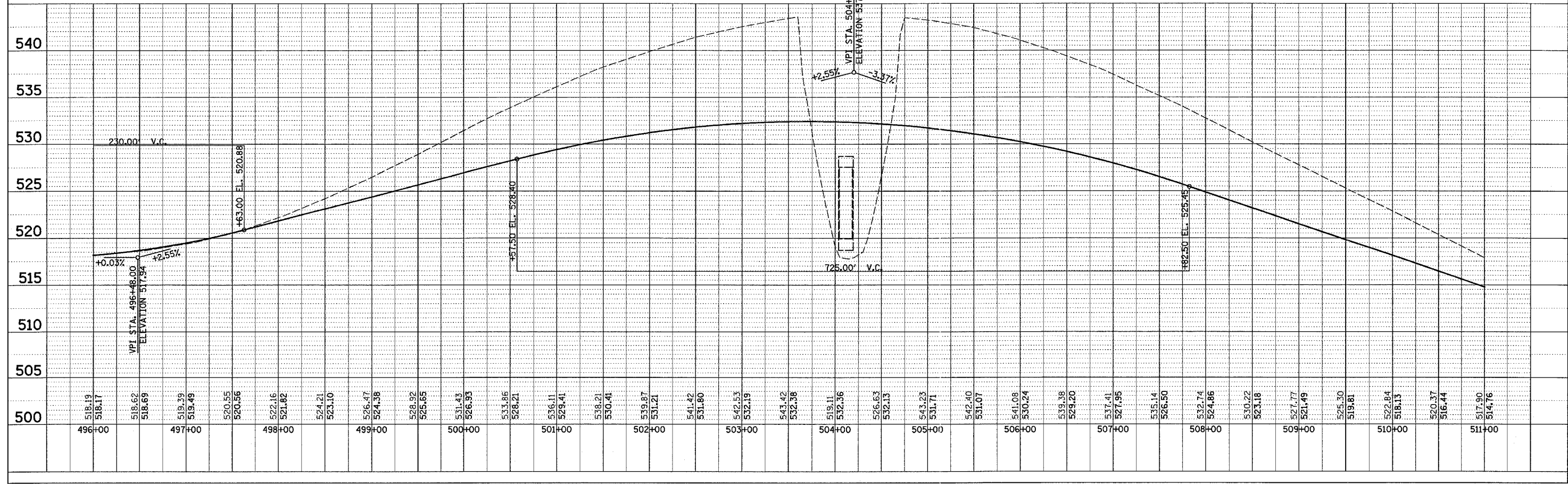
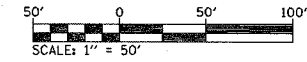

8/01/2006
6/5/2006
c:\p\projects\11000002\plan\p11000002.dgn
*REF: P11000002

PLAN	DATE	BY
REVISED		
ALIGNMENT CHECKED		
NOTE BOOK NO.		
FILE NAME		

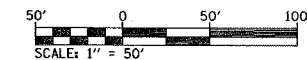
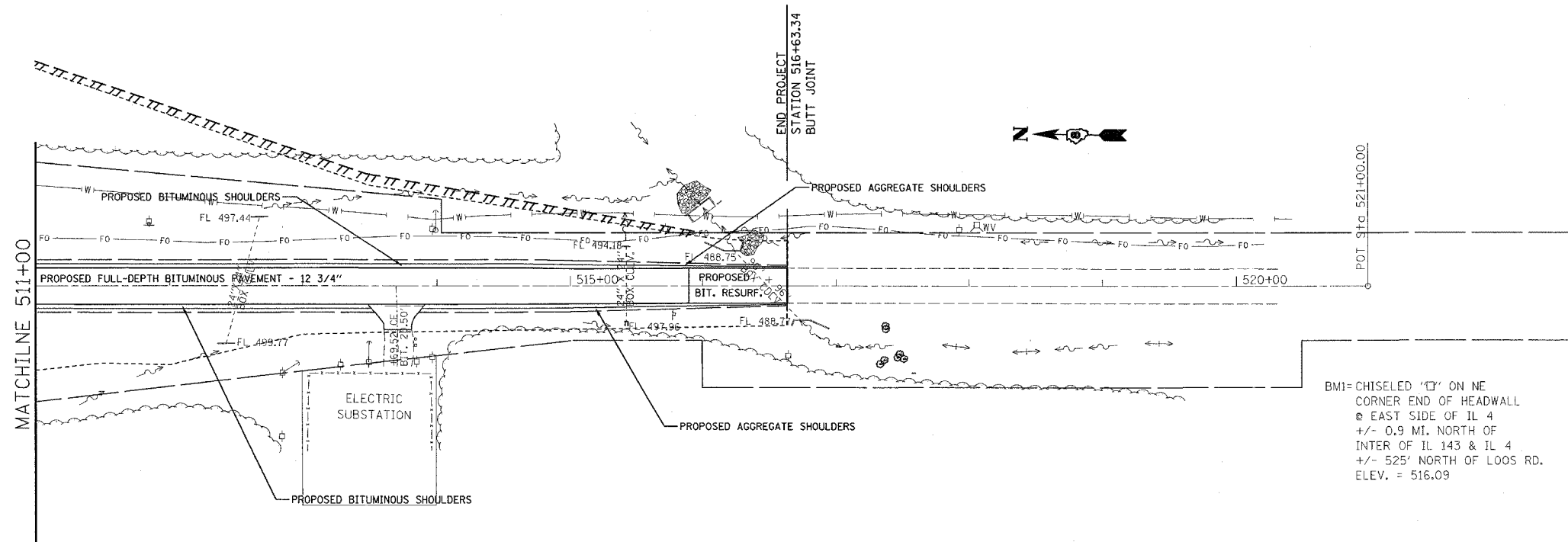

PROFILE	DATE	BY
REVISED		
GRADES CHECKED		
NOTE BOOK NO.		
STRUCTURE		
NOTATION		
CHWD		

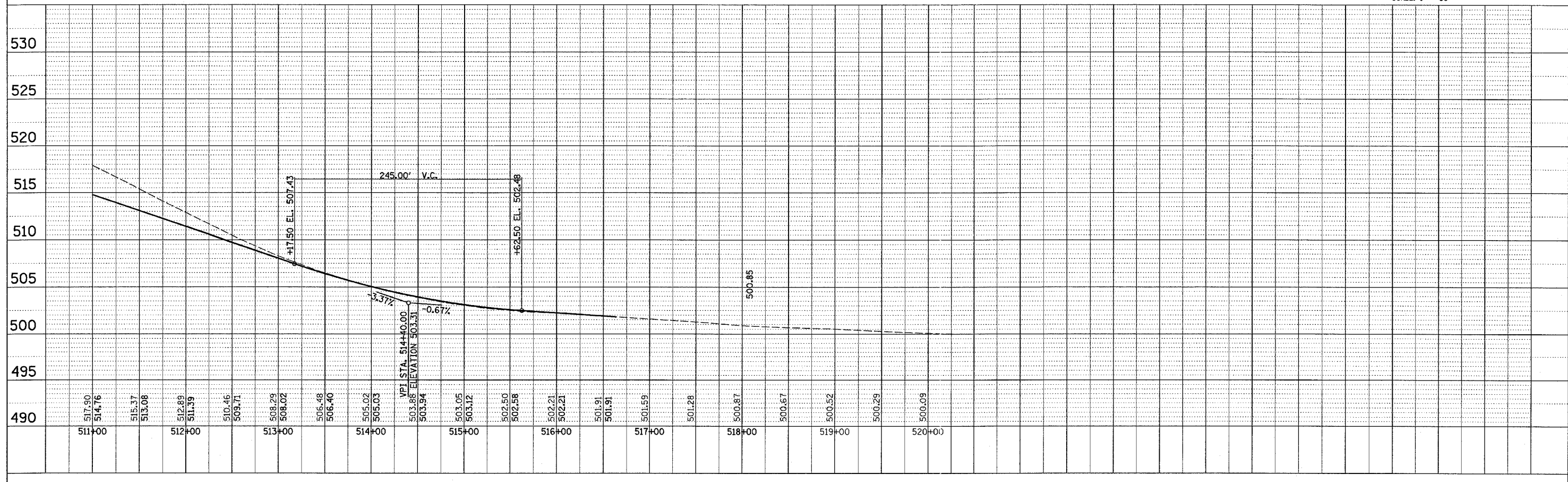

DATE: 6/5/2006
 6:15:20 PM
 REF: p13topo0802.dgn
 REF: p13topo0802.dgn

FIP	SECTION	COUNTY	TOTAL SHEETS	SHEET NO.
314	110-1VBR-1	MADISON	77	13
PLAN AND PROFILE OF RUNAROUND				
CONTRACT NO.: 76549				

PROP. CURVE EPRRA1-1
 PI STA. = 0+71.39
 $\Delta = 17^\circ 14' 43''$ (LT)
 $D = 12^\circ 10' 16''$
 $R = 470.75'$
 $T = 71.39'$
 $L = 141.69'$
 $E = 5.38'$
 $e =$
 $T.R. =$
 $S.E. RUN =$
 $P.C. STA. = 0+00.00$
 $P.T. STA. = 1+41.69$

PROP. CURVE EPRRA1-2
 PI STA. = 2+89.59
 $\Delta = 24^\circ 20' 22''$ (RT)
 $D = 12^\circ 48' 39''$
 $R = 447.25'$
 $T = 96.45'$
 $L = 189.99'$
 $E = 10.28'$
 $e =$
 $T.R. =$
 $S.E. RUN =$
 $P.C. STA. = 1+93.14$
 $P.T. STA. = 3+83.13$

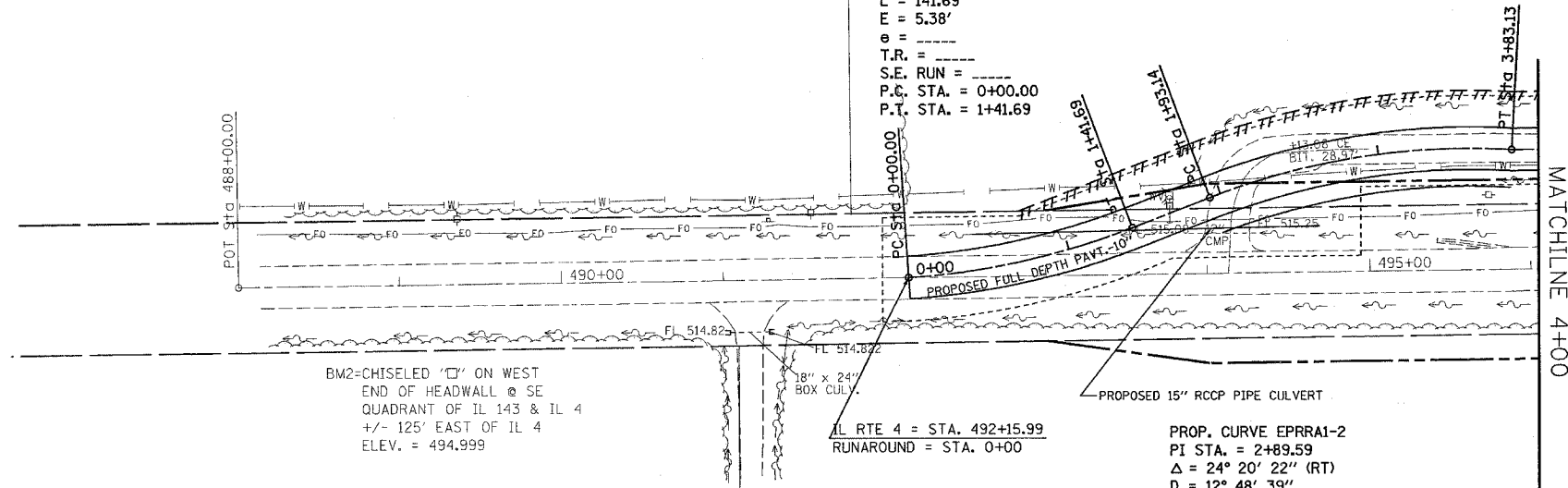

BM2=CHISELED 'Q' ON WEST
 END OF HEADWALL @ SE
 QUADRANT OF IL 143 & IL 4
 $\pm 125'$ EAST OF IL 4
 ELEV. = 494.999

AL RTE 4 = STA. 492+15.99
 RUNAROUND = STA. 0+00

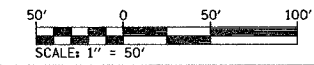

PLAN	DATE
SURVEYED	
ALIGNED	
CHECKED	
BY	
DATE	

PROFILE	DATE
SURVEYED	
GRADES CHECKED	
BY	
DATE	

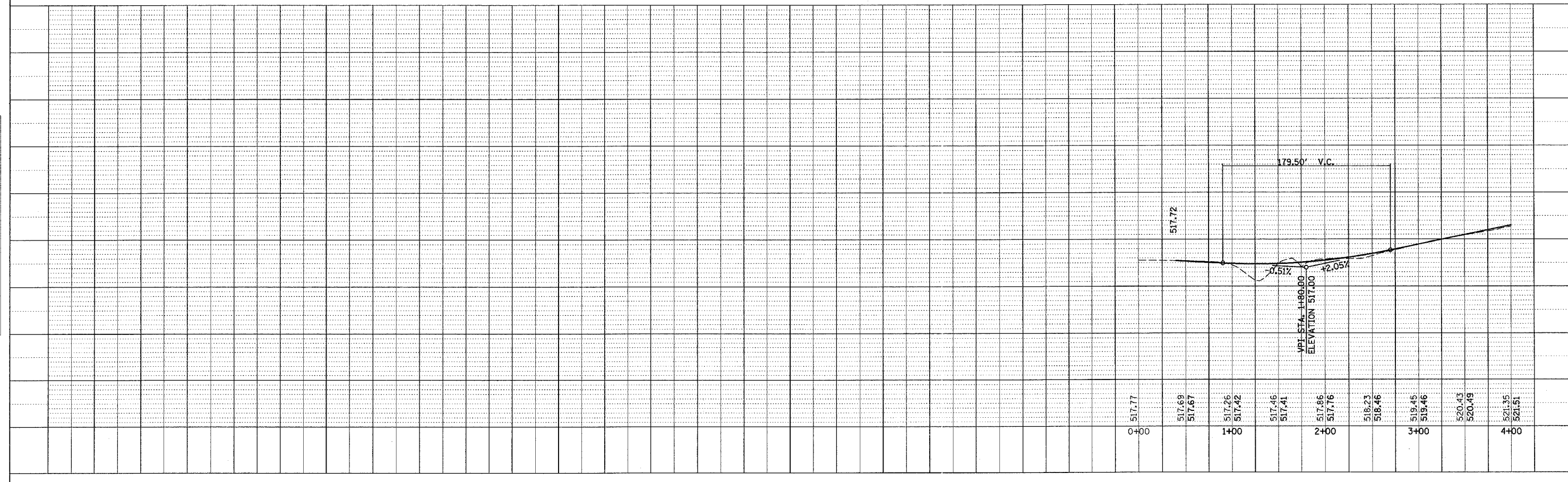

6/5/2006
 REF: p11-17 (060602)

APP. NO.	SECTION	COUNTY	TOTAL SHEETS	SHEET NO.
314	110-1VBR-1	MADISON	77	15
PLAN AND PROFILE OF RUNAROUND				
CONTRACT NO.: 76549				

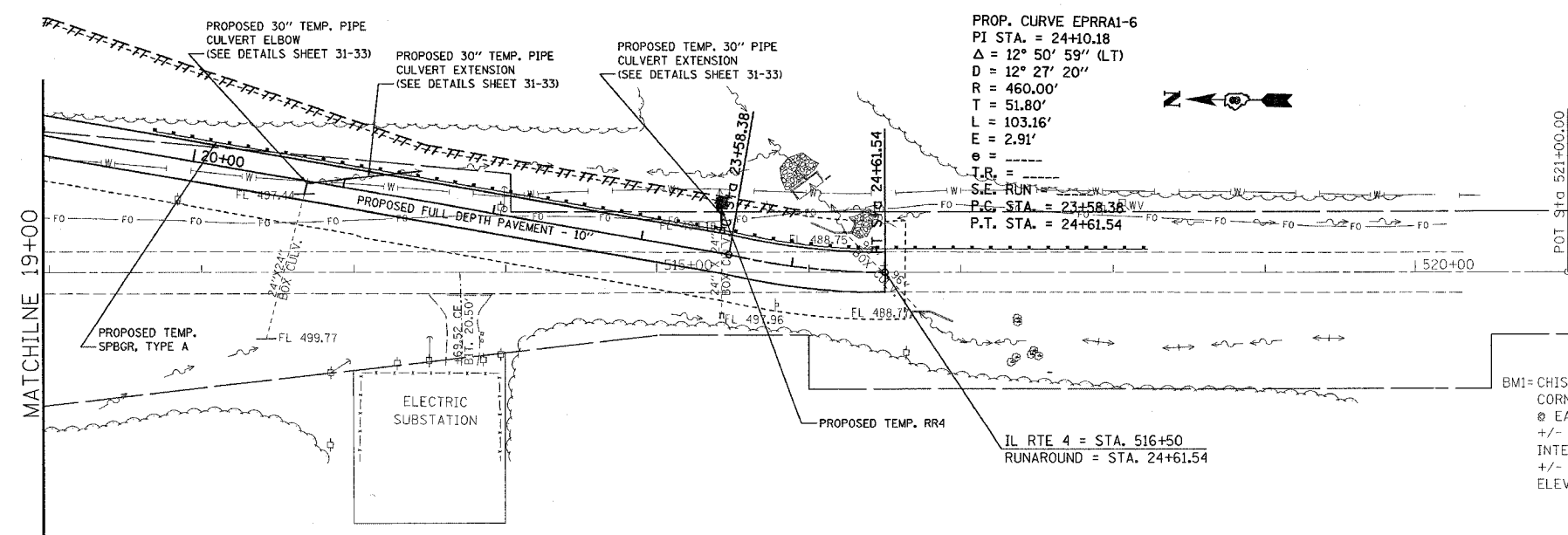

PROP. CURVE EPRA1-6
 PI STA. = 24+10.18
 $\Delta = 12^\circ 50' 59''$ (LT)
 $D = 12^\circ 27' 20''$
 $R = 460.00'$
 $T = 51.80'$
 $L = 103.16'$
 $E = 2.91'$
 $e =$
 $T.R. =$
 S.E. RUN =
 P.C. STA. = 23+58.38
 P.T. STA. = 24+61.54

BMI=CHISELED 'I' ON NE
 CORNER END OF HEADWALL
 @ EAST SIDE OF IL 4
 +/- 0.9 MI. NORTH OF
 INTER OF IL 143 & IL 4
 +/- 525' NORTH OF LOOS RD.
 ELEV. = 516.09

PLAN	DATE
APPROVED	
NOTE BOOK	
NO.	

PROFILE	DATE
APPROVED	
NOTE BOOK	
NO.	

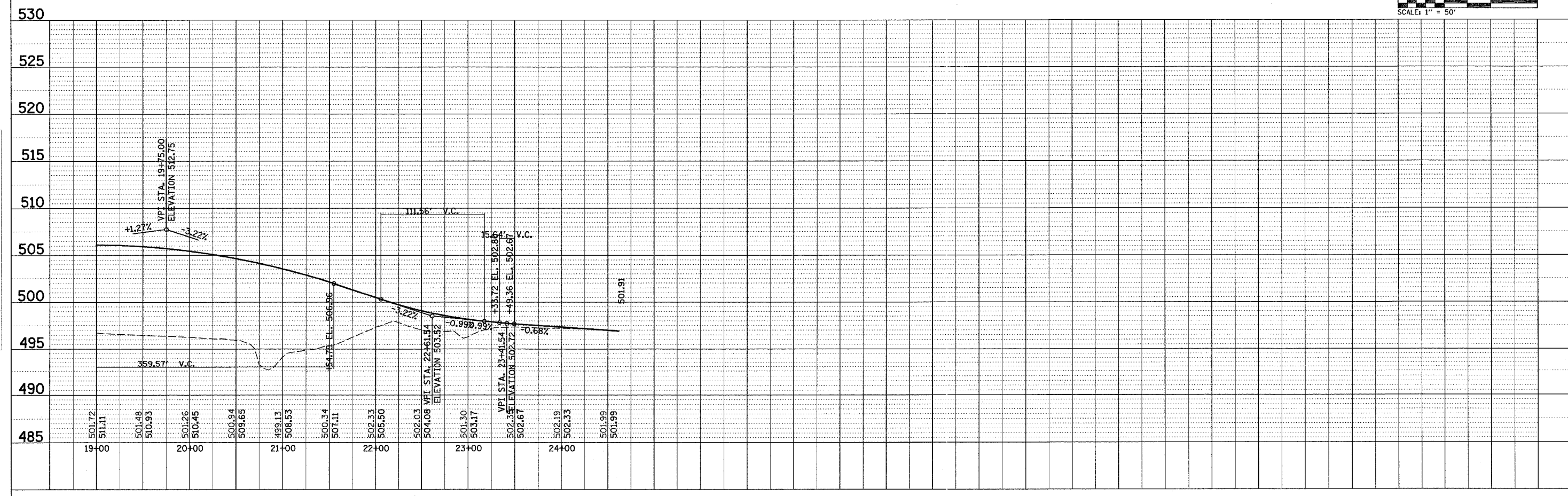

6/5/2006
 6:15:00
 6/5/2006