

FAP ROUTE	SECTION	COUNTY	TOTAL SHEETS	SHEET NO
314	110-1VBR-1	MADISON	77	9
STA.		TO STA.		
CONTRACT NUMBER: 76549				

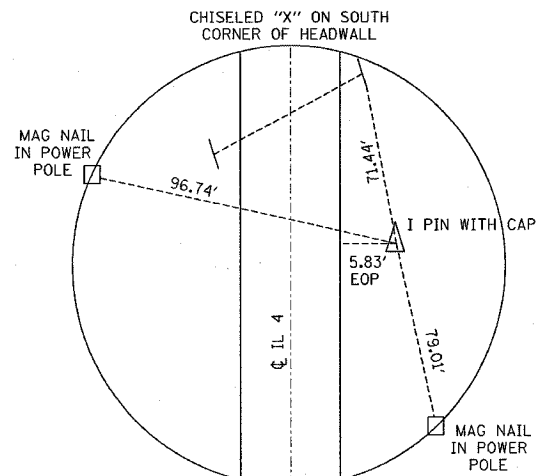

LOCATED ± 0.20 MILES NORTH OF INTERSECTION OF IL 143 & IL 4

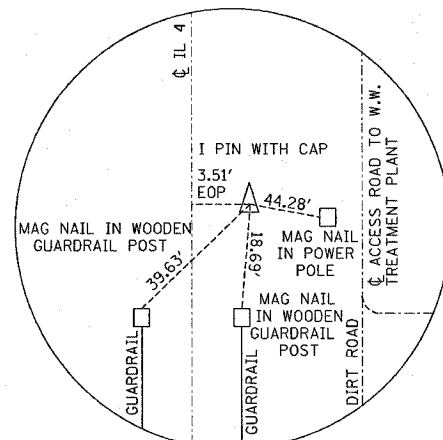

LOCATED ± 0.50 MILES NORTH OF INTERSECTION OF IL 143 & IL 4

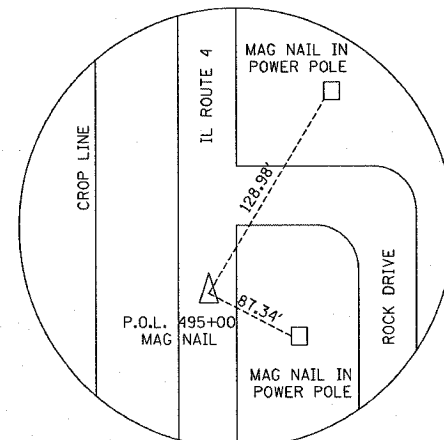

P.O.L. 495+00

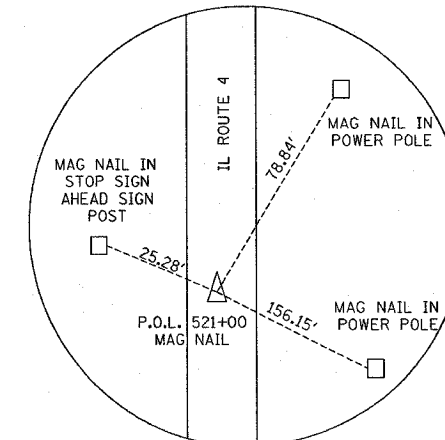

P.O.L. 521+00

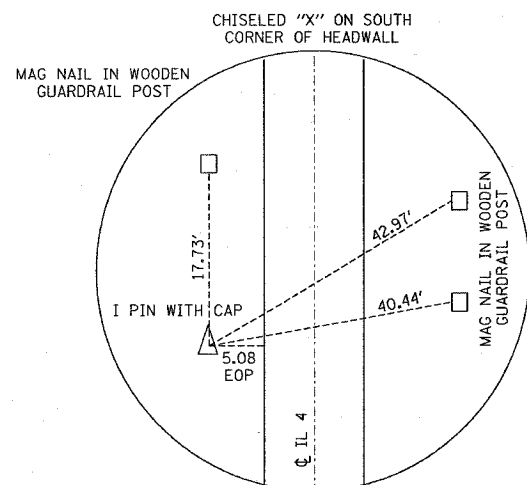

LOCATED ± 0.40 MILES NORTH OF INTERSECTION OF IL 143 & IL 4

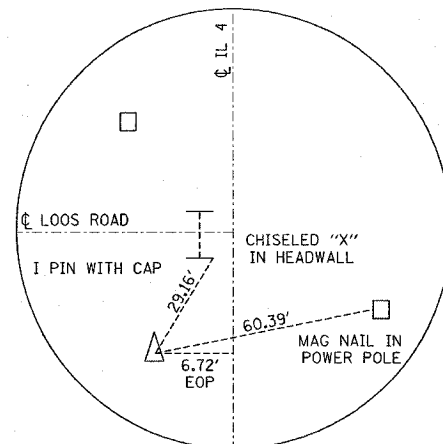

LOCATED ± 0.60 MILES NORTH OF INTERSECTION OF IL 143 & IL 4

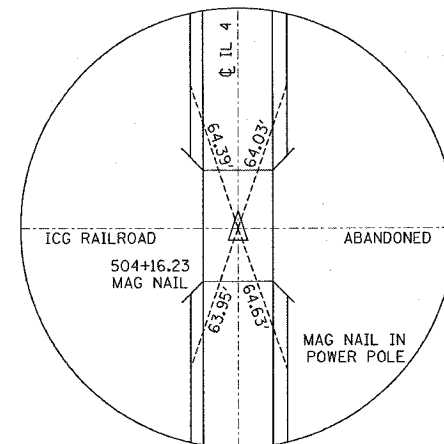

P.O.L. 504+16.45

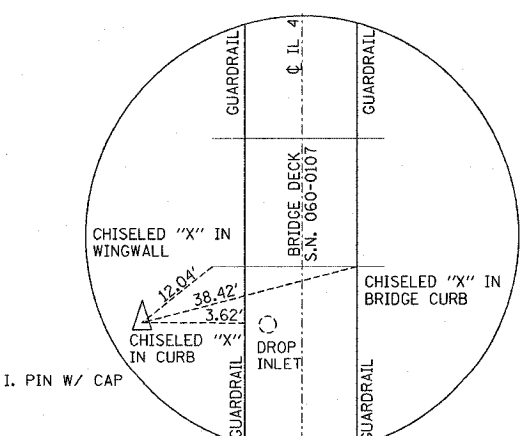

LOCATED ± 0.49 MILES NORTH OF INTERSECTION OF IL 143 & IL 4

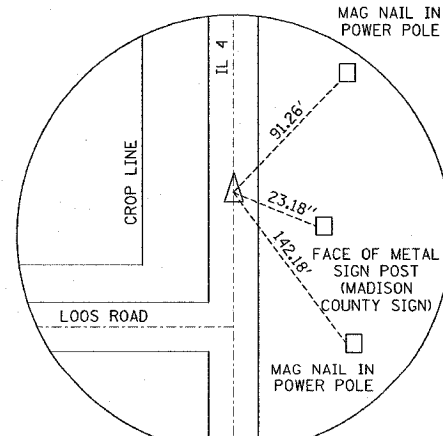

P.O.L. 488+00

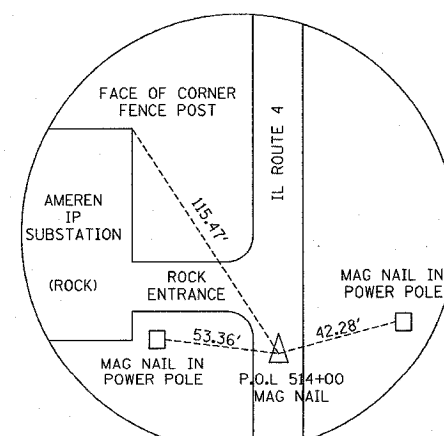

P.O.L. 514+00

PLOT DATE = 4/28/2006  
FILE NAME = c:\p\projects\110-1VBR-1\110-1VBR-1.dgn  
PLOT SCALE = 500000 / IN.  
REFERENCE = W110-1

REVISIONS	
NAME	DATE

ILLINOIS DEPARTMENT OF TRANSPORTATION  
**ALIGNMENT AND TIE POINTS**  
FAP ROUTE 314 (IL 4)  
SECTION 110-1VBR-1  
MADISON COUNTY  
DRAWN BY: