

F&P ROUTE	SECTION	COUNTY	TOTAL SHEETS	SHEET NO.
314	110-1VBR-1	MADISON	77	12
PLAN AND PROFILE OF MAINLINE				
CONTRACT NO.: 76549				

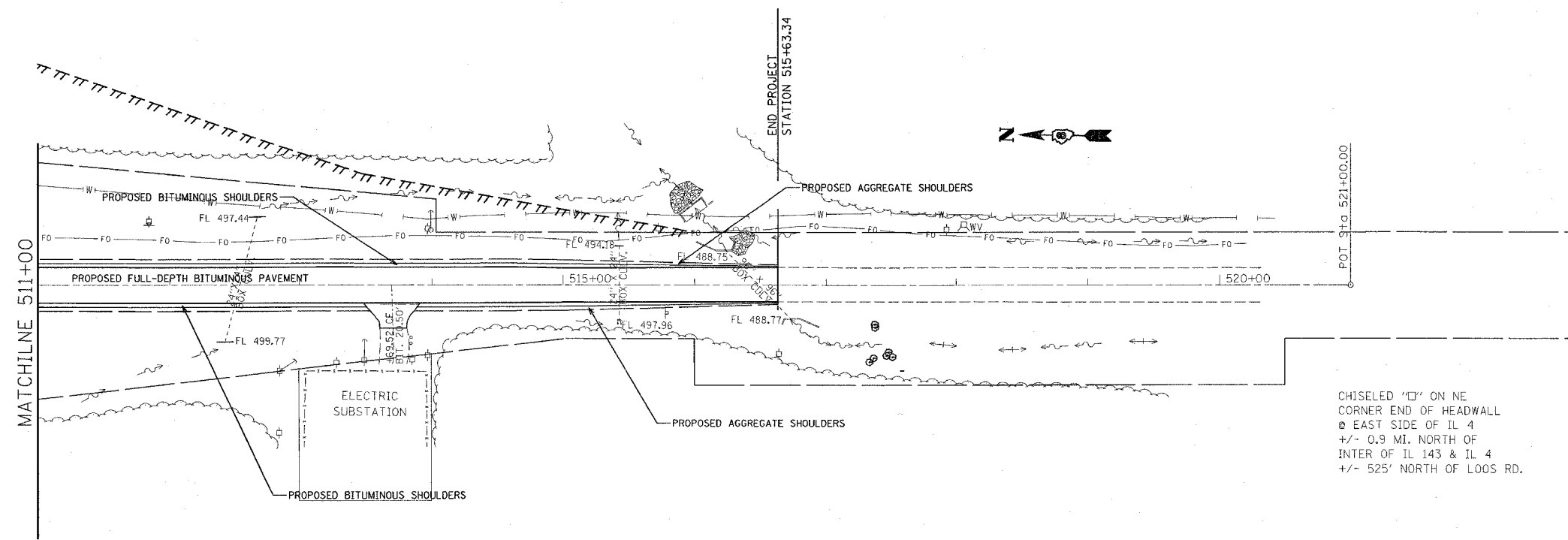

CHISELED "□" ON NE CORNER END OF HEADWALL
 @ EAST SIDE OF IL 4
 +/- 0.9 MI. NORTH OF INTER OF IL 143 & IL 4
 +/- 525' NORTH OF LOOS RD.

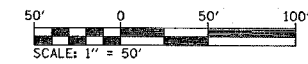

PLAN	DATE	BY
SURVEYED		
ALIGNED		
CHECKED		
NOTE BOOK NO.		
DATE		

PROFILE	DATE	BY
SURVEYED		
GRADES CHECKED		
NOTE BOOK NO.		
DATE		

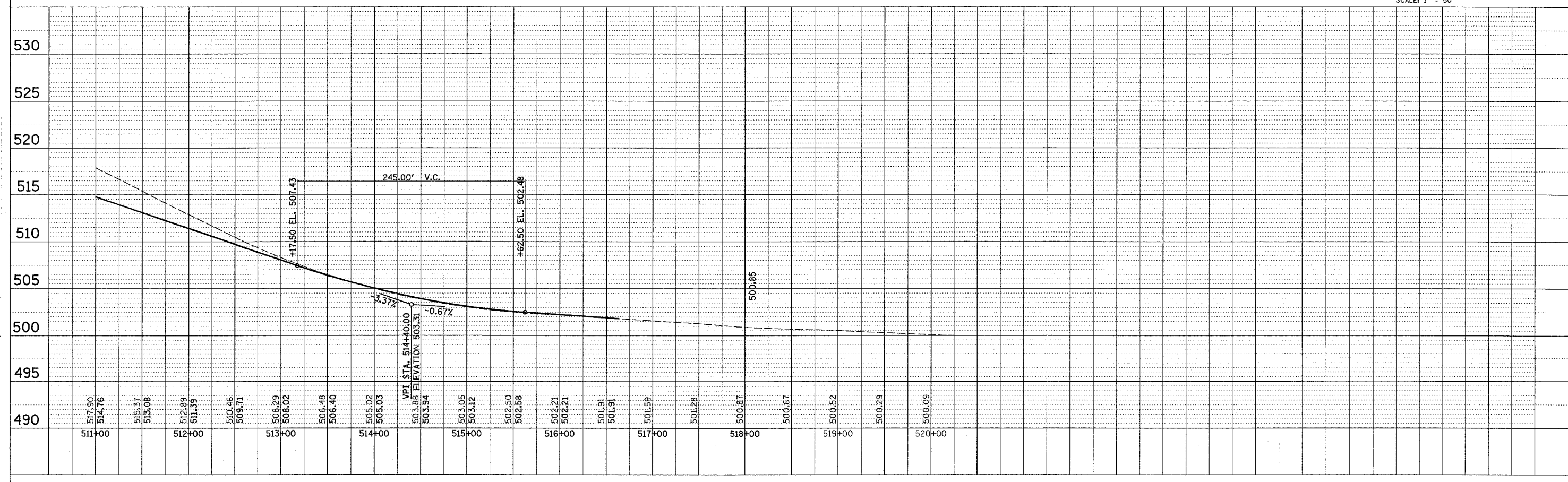

DATE: 3/28/2006
 3/28/2006
 REF: 1130pp000002