

CONTRACT NO.				
F.A. RTE.	SECTION	COUNTY	TOTAL SHEETS	SHEET NO.
314	110-1VBR-1	MADISON	77	268
STA.	TO STA.			
FED. ROAD DIST. NO.	ILLINOIS	FED. AID PROJECT		

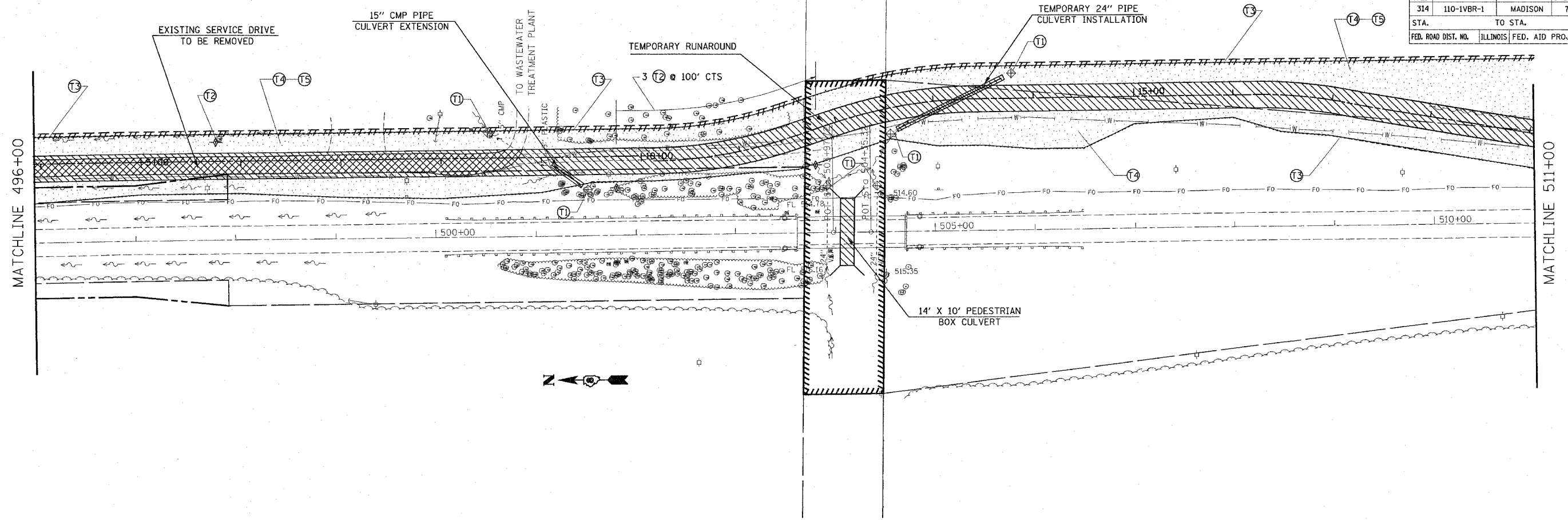

**SUGGESTED STAGE CONSTRUCTION**

**STAGE 1:**

1. STAGE 1 CONSTRUCTION SHALL CONSIST OF REMOVING THE EXISTING SERVICE DRIVE, CONSTRUCTING THE TEMPORARY RUNAROUND, CONSTRUCTING THE PEDESTRIAN BOX CULVERT, INSTALLING TEMPORARY CULVERTS, INSTALLING TEMPORARY GUARDRAIL, INSTALLING TEMPORARY EXTENSION OF CULVERTS, GRADING DITCHES, AND ANY ATTENDING EARTHWORK.
2. TRAFFIC CONTROL FOR THIS WORK SHALL BE DONE IN ACCORDANCE WITH THE APPLICABLE PORTIONS OF STANDARDS 701001, 701011, 701306, 701326.
3. THE TEMPORARY RUNAROUND SHALL CONSIST OF 1 3/4" SURFACE COURSE, AND A 8 1/4" BINDER COURSE.
4. BOTH LANES OF TRAFFIC ON FAP 314 SHALL BE OPEN TO TRAFFIC DURING PHASE 1 OF CONSTRUCTION.

**NOTES:**

1. THE CONTRACTOR SHALL MAINTAIN TEMPORARY ACCESS TO THE ELECTRIC SUBSTATION AND TO WASTE WATER TREATMENT PLANT LOCATED WITHIN THE LIMITS OF THE PROJECT.
2. TEMPORARY ACCESS SHALL BE MEASURED AND PAID FOR AT THE CONTRACT UNIT PRICE PER TON FOR AGGREGATE SURFACE COURSE TYPE B. WHEN USE OF THE AGGREGATE SURFACE COURSE TYPE B IS DISCONTINUED AS TEMPORARY ACCESS IT SHALL BE UTILIZED IN PERMANENT CONSTRUCTION. THE REUSE AND PLACEMENT SHALL BE AS DETERMINED BY THE ENGINEER.
3. REMOVAL AND REUSE OF TEMPORARY ACCESS MATERIALS SHALL BE CONSIDERED AS INCLUDED IN THE COST OF AGGREGATE SURFACE COURSE, TYPE B.
4. USE STANDARD TRAFFIC CONTROL AND PROTECTION EXCEPT WHERE NOTED.



**TEMPORARY EROSION CONTROL MEASURES**

- ⊕ T1 INLET AND PIPE PROTECTION
- ⊕ T2 TEMPORARY DITCH CHECK
- T3 PERIMETER EROSION BARRIER
- ▭ T4 TEMPORARY SEEDING
- ▭ T5 TEMPORARY MULCH METHOD 1

**NOTES:**

FOR SCHEDULE AND QUANTITIES OF PERMANENT EROSION CONTROL  
PAY ITEMS SEE ROADWAY PLANS.  
SEE STANDARD 280001 FOR TEMPORARY EROSION CONTROL SYSTEM DETAILS.

REVISIONS	
NAME	DATE

ILLINOIS DEPARTMENT OF TRANSPORTATION  
**STAGE I EROSION CONTROL**  
FAP ROUTE 314  
SECTION 110-1VBR-1  
MADISON COUNTY

SCALE: VERT. \_\_\_\_\_  
HORIZ. \_\_\_\_\_  
DATE \_\_\_\_\_ DRAWN BY \_\_\_\_\_  
CHECKED BY \_\_\_\_\_

PLT DATE = DATE  
FILE NAME = TITLE  
PLT SCALE = SCALE  
REFERENCE = REF