

F.A.U. ROUTE NO.	SECTION	COUNTY	TOTAL SHEETS	SHEET NO.
2774	99-00073-00-WR	COOK	116	58
STA. TO STA.	ILLINOIS		FED. AID PROJECT	
FED. ROAD DIST. NO. 1			CMM-7003 (750)	
CONTRACT NO. 83727				

SCALE: 1" = 40'

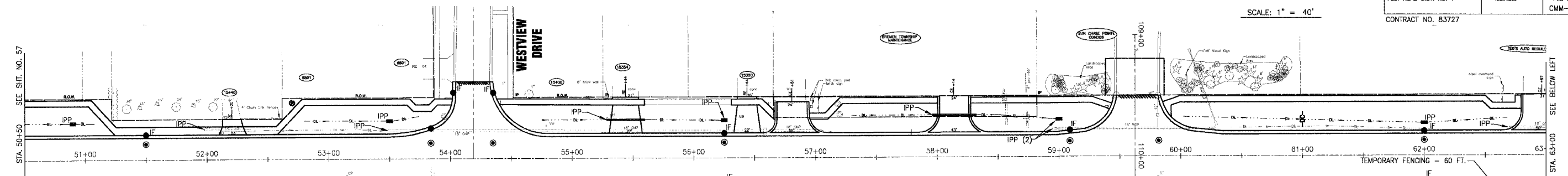

- LEGEND**
- DC — TEMPORARY DITCH CHECKS ROLLED EXCELSIOR
  - PB — PERIMETER EROSION BARRIER
  - IPP — INLET AND PIPE PROTECTION
  - IF — DRAINAGE STRUCTURE INLET FILTER
  - X-X-X-X-X — TEMPORARY FENCE

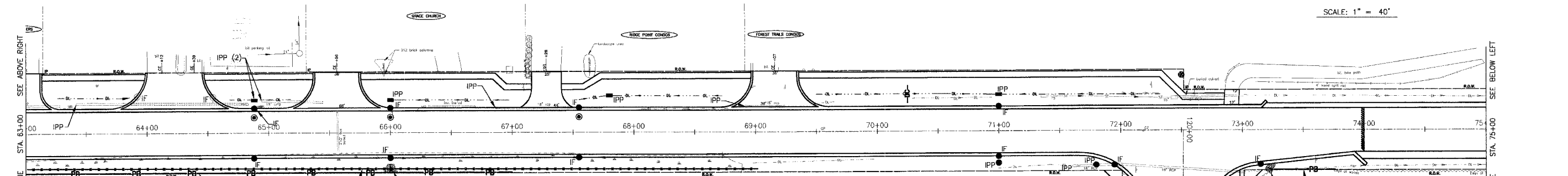
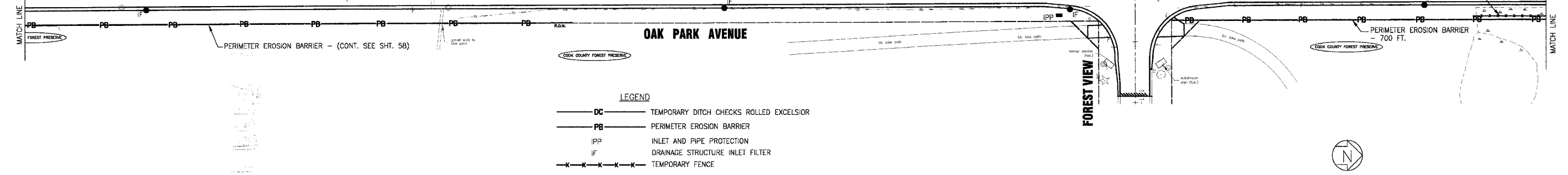

I:\OAKT\020146\DWG\20146-EROS.dwg  
 Plotted: 4-27-06 @ 3:37pm By: 231tkb  
 Copyright © 2004, By Baxter & Woodman, Inc.  
 State of Illinois Professional Design Firm 30-05  
 License No. 18-001217 - Expires 4-30-05

CONSULTANTS	REV.	DATE	DESCRIPTION
	1	4-28-06	PER IDOT AND COOK COUNTY COMMENTS

**BAXTER & WOODMAN**  
 Consulting Engineers

*Baxter & Woodman*  
 Crystal Lake, Illinois 815.459.1360  
 Burlington, Wisconsin 262.763.7854  
 Milwaukee, Illinois 708.478.5050  
 DeKalb, Illinois 815.787.3111  
 Grayslake, Illinois 847.323.5088  
 Rockford, Illinois 815.469.1551  
 Plainfield, Illinois 815.609.7425

**CITY OF OAK FOREST, ILLINOIS**  
**OAK PARK AVENUE PROJECT**

**TEMPORARY EROSION CONTROL PLAN**  
**OAK PARK AVENUE**  
**STA. 50+50 TO STA. 87+50**

DESIGNED BY	NJP	SCALE	HORIZ: 1"=40'
DRAWN BY	UKB	PROJECT NO.	020146
CHECKED BY	NJP	SHEET NO.	58 OF 116
DATE	1-20-05		

