

F.A.P. RTE.	SECTION	COUNTY	TOTAL SHEETS	SHEET NO
0369	97-000-25-00 BR	WILL	156	77
STA.	TO STA.			
FED. ROAD DIST. NO.	ILLINOIS	FED. AID PROJECT:		

D-91-467-97

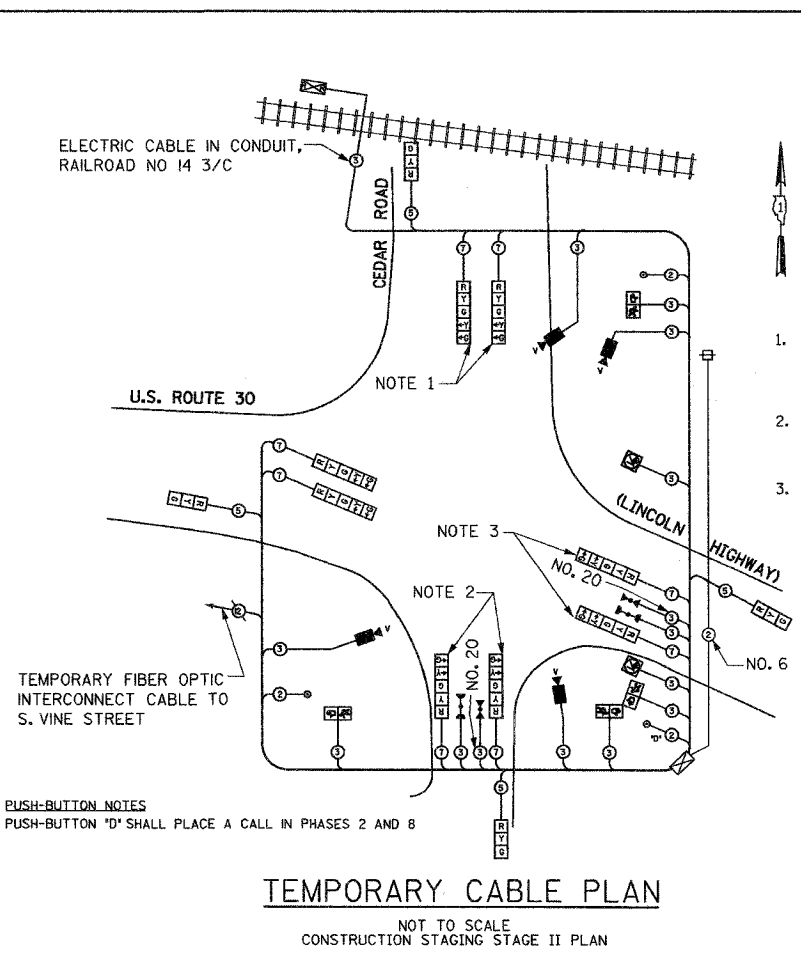
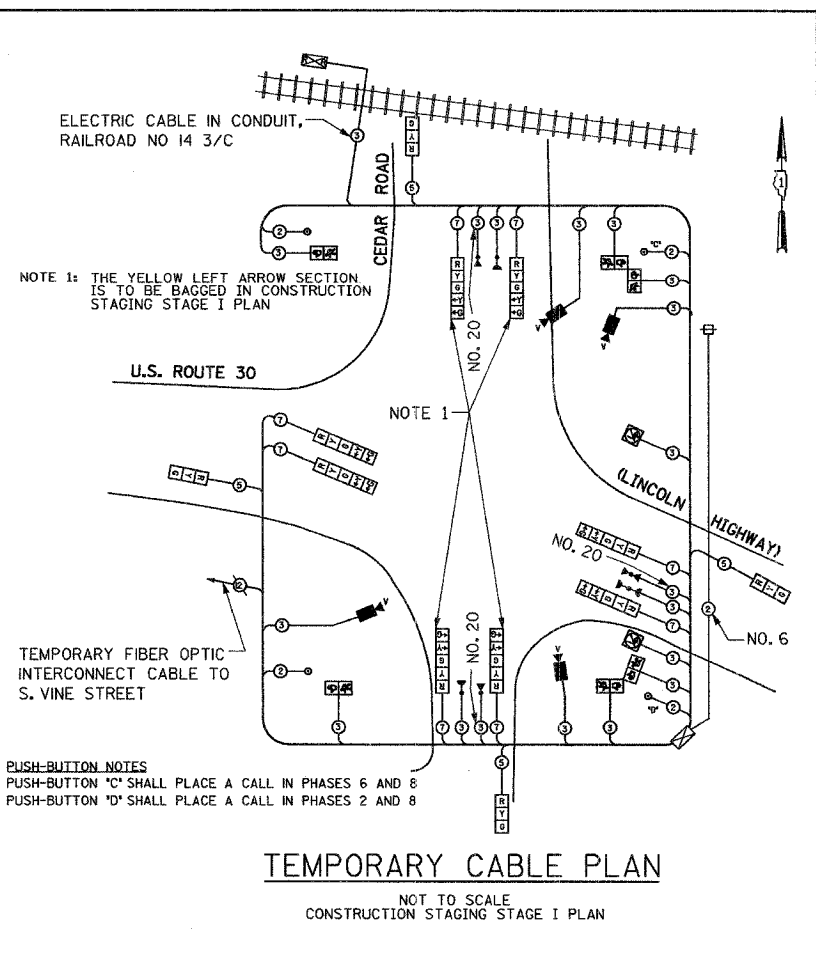
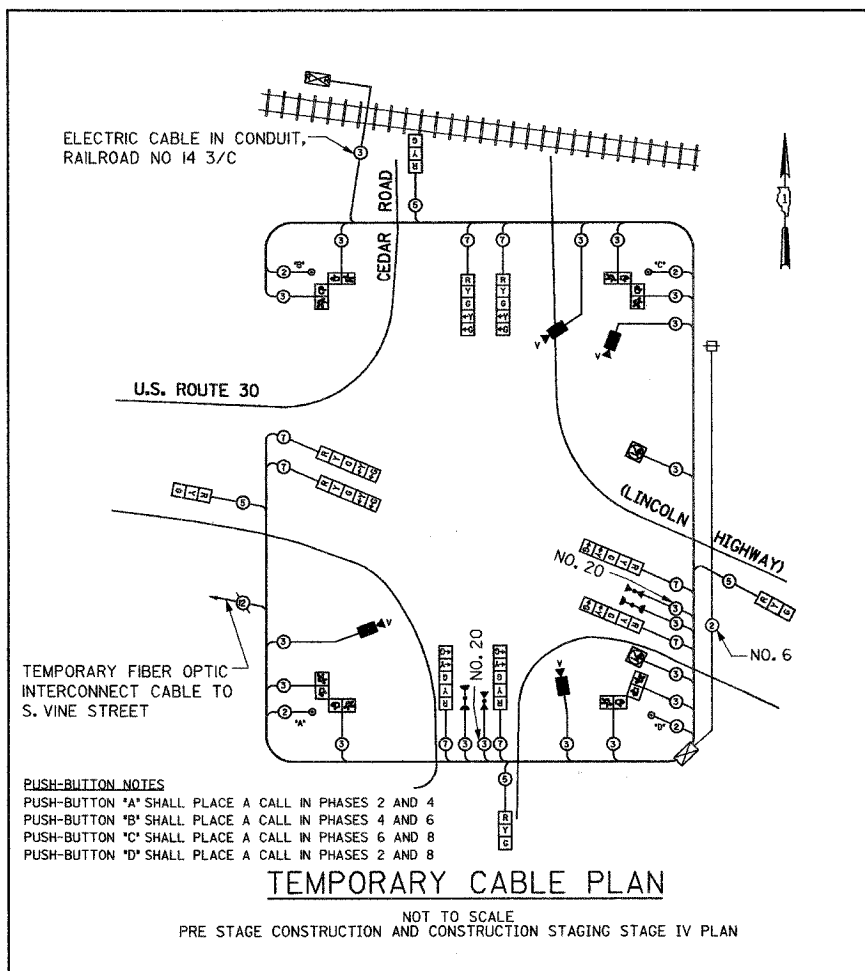

NOTES

1. THE GREEN AND YELLOW LEFT ARROW SECTIONS FOR THE NORTHBOUND DIRECTION OF TRAFFIC SHALL BE BAGGED IN CONSTRUCTION STAGE II PLAN.
2. THE YELLOW LEFT TURN ARROW SECTION FOR THE SOUTHBOUND DIRECTION OF TRAFFIC SHALL BE BAGGED IN CONSTRUCTION STAGE II PLAN.
3. THE GREEN AND YELLOW LEFT ARROW SECTIONS FOR THE EASTBOUND DIRECTION OF TRAFFIC SHALL BE BAGGED IN CONSTRUCTION STAGE II PLAN.

I.D.O.T. TRAFFIC SIGNAL INSTALLATION ELECTRICAL SERVICE REQUIREMENTS					TOTAL WATTAGE
TYPE	NO LAMPS	WATTAGE		%OPERATION	
SIGNAL (RED)	12	135	17	0.50	810.0
	12	135	25	0.25	405.0
	12	135	15	0.25	405.0
ARROW	16	135	12	0.10	216.0
PED. SIGNAL	8	90	25	1.00	720.0
CONTROLLER	1	100	100	1.00	100.0
ILLUM. SIGN	2		84	0.05	8.4
TOTAL =					2664.4

ENERGY COSTS TO:
VILLAGE OF NEW LENOX
701 WEST HAVEN AVENUE
NEW LENOX, ILLINOIS 60451

ENERGY SUPPLY CONTACT: MR. CRAIG TRIEMSTRE
PHONE: (815) 724-5607
COMPANY: COMED - JOLIET OFFICE

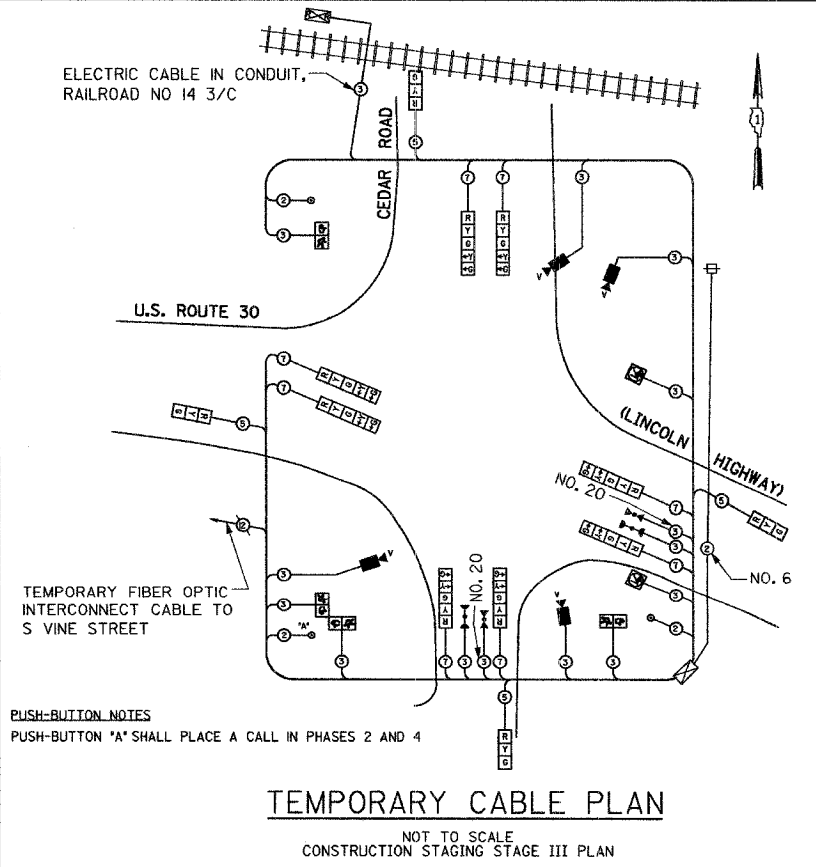

TEMPORARY CABLE DIAGRAM LEGEND

- TEMPORARY TRAFFIC SIGNAL SECTION OR PEDESTRIAN SIGNAL SECTION 12" (300mm)
- TEMPORARY CONTROLLER CABINET
- TEMPORARY SERVICE INSTALLATION
- INDICATES NUMBER OF CONDUCTORS IN CABLE. ALL CONDUCTORS TO BE NUMBER 14 AWG WIRE UNLESS OTHERWISE NOTED.
- EMERGENCY VEHICLE LIGHT DETECTOR
- CONFIRMATION BEACON
- VEHICLE DETECTOR, INDUCTION LOOP
- PEDESTRIAN PUSHBUTTON DETECTOR
- 12" (300mm) PEDESTRIAN SIGNAL SECTION
- VIDEO CAMERA ASSEMBLY
- RAILROAD CONTROLLER CABINET
- ILLUMINATED SIGN FIBER OPTIC

THE TRAFFIC SIGNAL CONTROL EQUIPMENT FOR THIS PROJECT SHALL BE "EAGLE" TO MATCH THE EXISTING ADJACENT SYSTEM.

GO GANDHI AND ASSOCIATES, INC.
ENGINEERS AND PLANNERS
6036 N. NORTHWEST HIGHWAY
SUITE 306
CHICAGO, ILLINOIS 60631 TEL. (773) 774-5990

REVISIONS	
NAME	DATE

ILLINOIS DEPARTMENT OF TRANSPORTATION

TEMPORARY CABLE PLAN
U.S. ROUTE 30 (LINCOLN HIGHWAY)
AT CEDAR ROAD
FOR ALL CONSTRUCTION STAGES

SCALE: N.T.S.
DATE: JULY 20, 2005

DRAWN BY: JEK/BB
DESIGNED BY: RRM
CHECKED BY: RRM/PKG