

STATE OF ILLINOIS
DEPARTMENT OF TRANSPORTATION
DIVISION OF HIGHWAYS
PLANS FOR PROPOSED
LOCAL AGENCY PAVEMENT PRESERVATION PROJECT
FAU 1375 (LIES ROAD) RESURFACING
SECTION: 04-00047-00-RS
GARY AVENUE TO SCHMALE ROAD (FAP 2561 TO FAU 2566)
PROJECT NO.: M-8003 (552)
VILLAGE OF CAROL STREAM
DUPAGE COUNTY
JOB NO.: C-91-113-06



LOCATION OF INDICATED SECTION THUS: -

INDEX OF SHEETS

SHEET NO.	TITLE
1	COVER SHEET
2	SUMMARY & SCHEDULE OF QUANTITIES, LEGEND, DETAILS AND GENERAL NOTES
3	INLET DETAIL, TYPICAL CROSS SECTION, MIXTURE REQUIREMENTS
4	LIES ROAD - STA 100+00 TO STA 123+85
5	LIES ROAD - STA 123+85 TO STA 153+60
6	LIES ROAD STRIPING PLAN
7	IDOT TYPICAL PAVEMENT MARKINGS
8	IDOT TRAFFIC CONTROL AND PROTECTION AT TURN BAYS AND OTHER PROTECTION STANDARDS
9	IDOT BUTT JOINT AND BITUMINOUS TAPER DETAILS
10	IDOT PAVEMENT MARKING LETTERS & SYMBOLS FOR TRAFFIC STAGING

STANDARD NO.

000001-04	STANDARD SYMBOLS, ABBREVIATIONS AND PATTERNS
442201-01	CLASS C AND D PATCHES
606001-02	CONCRETE CURB TYPE B AND COMBINATION CONCRETE CURB AND GUTTER
701301-02	LANE CLOSURE, 2L, 2W, SHORT TIME OPERATIONS
701606-04	URBAN LANE CLOSURE MULTILANE, 2W WITH MOUNTABLE MEDIAN
701701-04	URBAN LANE CLOSURE, MULTILANE INTERSECTION
780001-01	TYPICAL PAVEMENT MARKINGS
886001	DETECTOR LOOP INSTALLATIONS

PROJECT LOCATION LIES ROAD BEGIN RESURFACING: STA. 100+42

DESIGN DESIGNATION
LIES ROAD
LOCAL COLLECTOR

TRAFFIC DATA
LIES ROAD
POSTED OR DESIGN SPEED = 35 MPH
2005 ADT = 12,500

CITY & TOWNSHIP = CAROL STREAM - BLOOMINGDALE TOWNSHIP
SEC & 1/4 SEC NO. = SEC. 28 - E & W 1/4. SEC 29 - E & W 1/4

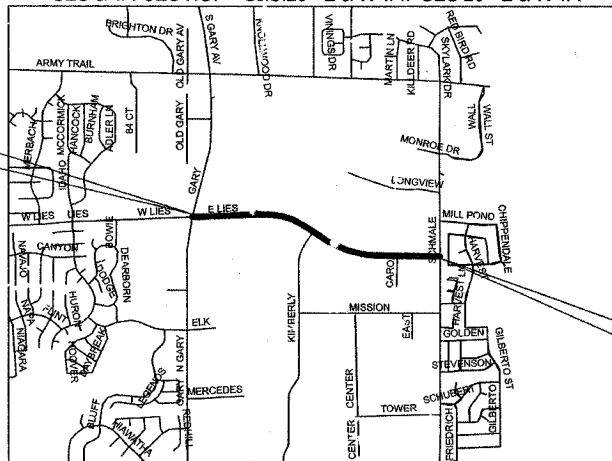

NO SCALE

LOCATION MAP

GROSS LENGTH OF PROJECT = 5318 LIN. FT. OR 1.01 MILES

NET LENGTH OF PROJECT = 5417 LIN. FT. OR 1.03 MILES

FULL SIZE PLANS HAVE BEEN PREPARED USING STANDARD ENGINEERING SCALES. REDUCED SIZED PLANS WILL NOT CONFORM TO STANDARD SCALES. IN MAKING MEASUREMENTS ON REDUCED SIZE PLANS, THE ABOVE SCALES SHALL BE USED.

CALL JULIE 1-800-892-0123
WITH THE FOLLOWING
COUNTY = DUPAGE
CITY & TOWNSHIP = CAROL STREAM - BLOOMINGDALE TOWNSHIP
SEC & 1/4 SEC NO. = SEC. 28 - E & W 1/4. SEC 29 - E & W 1/4
48 HOURS BEFORE YOU DIG
EXCLUDING SAT., SUN., & HOLIDAYS



ENGINEERING SERVICES
500 N. GARY AVENUE
60188
(630) 871 - 6220



William M. Chasnovich 1215105
PROJECT MANAGER
LICENSE EXPIRES 11-30-07

STATE OF ILLINOIS
DEPARTMENT OF TRANSPORTATION
DIVISION OF HIGHWAYS

APPROVED December 5, 2005 *William M. Chasnovich*
LOCAL AGENCY REPRESENTATIVE

APPROVED DECEMBER 21 2005
LOCAL ROADS ENGINEER

APPROVED DEC 21 2005
DEPUTY DIRECTOR OF ENGINEERING, REGION ENGINEER

FEDERAL AID DESIGN ENGINEER - ABIGAIL BRINKS 847-705-4233

CONTRACT NO 83832



ENGINEERING SERVICES
 500 N. GARY AVENUE
 60188
 (630) 871-6220

SUMMARY OF QUANTITIES

CODE NUMBER	PAY ITEM	UNIT	TOTAL QUANTITY (1000-2A)
40400100	BITUMINOUS MATERIALS (PRIME COAT)	GAL	3600
40600300	AGGREGATE (PRIME COAT)	TON	36
44000008	BITUMINOUS SURFACE REMOVAL, 2.5"	SY	36000
44001700	COMBINATION CURB AND GUTTER REMOVAL AND REPLACEMENT	FT	750
44201711	CLASS D PATCHES TYPE IV, 5"	SY	1000
44300100	AREA REFLECTIVE CRACK CONTROL TREATMENT	SY	36000
67100100	MOBILIZATION	LS	1
70102625	TRAFFIC CONTROL & PROTECTION, STANDARD 701606	LS	1
70102635	TRAFFIC CONTROL & PROTECTION, STANDARD 701701	LS	1
*78000100	THERMOPLASTIC PAVEMENT MARKING LETTERS & SYMBOLS	SF	375
*78000200	THERMOPLASTIC PAVEMENT MARKING LINE, 4"	FT	26100
*78000400	THERMOPLASTIC PAVEMENT MARKING LINE, 6"	FT	1100
*78000600	THERMOPLASTIC PAVEMENT MARKING LINE, 12"	FT	600
*78000650	THERMOPLASTIC PAVEMENT MARKING LINE, 24"	FT	350
*88600600	DETECTOR LOOP REPLACEMENT	FT	600
X4066426	BITUMINOUS CONCRETE SURFACE COURSE, SUPERPAVE, MIX D, N70	TON	4400
X4066770	LEVELING BINDER (MACHINE METHOD) SUPERPAVE N70, 0.75"-1.75"	TON	2200
Z0000600	ADJUSTING FRAMES FOR INLETS	EA	1
Z0048665	RAILROAD LIABILITY INSURANCE	LS	1
60262700	INLETS TO BE RECONSTRUCTED	EA	28
XX006470	TOPSOIL, SEED, AND STRAW	FT	520

* INDICATES SPECIALTY ITEMS

ABBREVIATIONS

GR	GRAVEL
CI	CAST IRON
DI	DUCTILE IRON
CL EL	CENTERLINE ELEVATION
P	POINT
G	GUTTER
C	CURB
BC	BACK OF CURB
EP	EDGE OF PAVEMENT
TF	TOP OF FRAME
TC	TOP OF CURB OR CONCRETE
CP	SURVEY CONTROL POINT
R	STRUCTURE TO BE RECONSTRUCTED
A	STRUCTURE TO BE ADJUSTED

LEGEND

EXISTING

---SA---SA---	SANITARY SEWER OR SERVICE	⊙ GAS	GAS SERVICE VALVE
---ST---ST---	STORM SEWER OR SERVICE	---	CENTER LINE
---	WATER MAIN	---	EASEMENT
---	WATER SERVICE	---	RIGHT OF WAY (ROW)
---	FORCE MAIN	---	TELEPHONE CABLE
---	PIPE UNDERDRAIN	---	TELEPHONE DUCT
---	PIPE DRAIN	---	TELEPHONE VAULT
⊙	MANHOLE	---	TELEPHONE RISER
⊙	CATCH BASIN	---	CABLE TELEVISION (BURIED)
⊙	INLET	---	CABLE T.V. RISER
⊙	DRYWELL	---	CABLE T.V. VAULT
⊙	END SECTION	---	UNDERGROUND ELECTRICAL
⊙	FIRE HYDRANT	---	ELECTRIC METER
⊙	WATER VALVE W/ BOX AND COVER	---	PAD MOUNTED TRANSFORMER
⊙	WATER VALVE VAULT	---	ELECTRIC VAULT
⊙	CLEANOUT	---	JUNCTION BOX
⊙	WATER SERVICE BOX	---	UTILITY POLE W/ GUY ANCHOR
⊙	WATER METER	---	UTILITY POLE W/ LIGHT
⊙	TO BE ABANDONED AND/OR REMOVED	---	LIGHT STANDARD
⊙	GAS LINE	---	MAIL BOX
⊙	GAS VALVE W/ BOX AND COVER	---	TRAFFIC SIGNAL POST W/ SIGNAL HEAD
⊙	GAS VALVE VAULT	---	HANDHOLE
⊙	GAS METER	---	PAVEMENT CORE LOCATION
⊙	GAS RISER		

PROPOSED

	BITUMINOUS SURFACE REMOVAL - BUTT JOINT
	CLASS D PATCHES, TYPE IV-5"
	XX SQ. YD.

GENERAL NOTES

- THE CONTRACTOR SHALL PROTECT AND CAREFULLY PRESERVE ALL SECTION OR SUBSECTION MONUMENTS OR PROPERTY OR REFERENCE MARKERS UNTIL THE OWNER, HIS AGENT OR AN AUTHORIZED SURVEYOR HAS WITNESSED OR OTHERWISE REFERENCED THEIR LOCATIONS.
- THE CONTRACTOR SHALL BE RESPONSIBLE FOR CONTACTING THE OWNERS OF ALL EXISTING UTILITIES SO THAT THE UTILITIES AND THEIR APPURTENANCES MAY BE LOCATED AND ADJUSTED OR MOVED, IF NECESSARY, PRIOR TO THE START OF CONSTRUCTION OPERATIONS. THE CONTRACTOR SHALL COOPERATE WITH ALL UTILITY OWNERS AS PROVIDED IN THE STANDARD SPECIFICATIONS.
- THE CONTRACTOR SHALL BE RESPONSIBLE FOR THE PROTECTION OF ALL UNDERGROUND OR SURFACE UTILITIES EVEN THOUGH THEY MAY NOT BE SHOWN ON THE PLANS. ANY UTILITY THAT IS DAMAGED DURING CONSTRUCTION SHALL BE REPAIRED TO THE SATISFACTION OF THE ENGINEER OR THE OWNER OR REPLACED. THIS WORK SHALL BE AT THE CONTRACTOR'S EXPENSE.
- ALL AGGREGATE USED ON THIS PROJECT SHALL BE CRUSHED GRAVEL OR CRUSHED STONE.
- ALL SAW CUTTING SHALL BE INCLUDED IN THE UNIT COST OF THE ITEM INDICATED FOR REMOVAL.
- ALL CONSTRUCTION PERSONNEL WILL BE REQUIRED TO WEAR A FLOURESCENT ORANGE VEST AT ALL TIMES WHILE ON THE CONSTRUCTION SITE. COMPLIANCE WITH THIS REQUIREMENT SHALL BE INCLUDED IN THE CONTRACT.
- NO STREET CLOSURES WILL BE ALLOWED.
- THE CONTRACTOR SHALL REPLACE ALL STREET SIGNS AND MAIL BOXES REMOVED DURING CONSTRUCTION AS NEAR AS POSSIBLE TO THEIR ORIGINAL LOCATION OR AS DETERMINED BY THE ENGINEER. THIS WORK SHALL BE INCLUDED IN THE CONTRACT.
- ALL OPEN HOLES, BROKEN PAVEMENT AND TRENCHES RESULTING FROM STRUCTURE ADJUSTMENTS, CURB REPAIRS OR STORM SEWER WORK SHALL BE BACKFILLED TO GRADE BY THE END OF THE DAY.
- BEFORE STARTING ANY EXCAVATION, THE CONTRACTOR SHALL CALL "JULIE" AT 800-892-0123 FOR FIELD LOCATIONS OF BURIED ELECTRICAL, TELEPHONE AND GAS FACILITIES. (48 HOURS NOTIFICATION IS REQUIRED)
- 10 FEET TRANSITIONS SHALL BE USED TO MATCH PROPOSED CURB AND GUTTER AND MEDIAN ITEMS OF WORK TO EXISTING CURB & GUTTERS AND MEDIANS IN THE FIELD, UNLESS OTHERWISE SHOWN. THE TRANSITIONS SHALL BE PAID FOR AT THE CONTRACT UNIT PRICE FOR THE PROPOSED ITEMS OF WORK SPECIFIED.
- THE CONTRACTOR SHALL COORDINATE CONSTRUCTION ACTIVITIES WITH THE UTILITY COMPANIES AND THE VILLAGE OF CAROL STREAM ENGINEERING SERVICES DEPARTMENT
- BARRICADES: THE CONTRACTOR SHALL PROVIDE AND INSTALL TWO (2) WEIGHTED SANDBAGS ON EACH TYPE I OR TYPE II BARRICADE USED - ONE (1) WEIGHTED SANDBAG ACROSS EACH BOTTOM RAIL.
- WHEN MILLED PAVEMENT IS OPEN TO TRAFFIC, THE MAXIMUM GRADE DIFFERENTIAL BETWEEN PASSES OF THE MILLING MACHINE SHALL NOT EXCEED 1 1/2 INCHES WHERE THE SPEED LIMIT IS 45 MPH OR LESS AND 1 INCH WHERE THE SPEED LIMIT IS GREATER THAN 45 MPH.
- BUTT JOINTS WILL BE INSTALLED AT THE ENDS OF ALL RESURFACING (WHERE RESURFACING MEETS EXISTING PAVEMENT), IN ACCORDANCE WITH THE "BUTT JOINT AND BITUMINOUS TAPER DETAILS" SHEET INCLUDED IN THE PLANS, UNLESS OTHERWISE SPECIFIED. BUTT JOINTS ARE BEING INCLUDED IN THE COST OF REMOVAL
- DRIVEWAYS SHALL REMAIN ACCESSIBLE DURING THE ENTIRE DURATION OF THE PROJECT.
- ALL BITUMINOUS MIXTURES SHALL BE QC/QA. HEAT SCARIFICATION AND ASPHALT MODIFIER SHALL BE QC/QA.
- THE CURB AND GUTTER REMOVAL AND REPLACEMENT AND PATCHING WILL NOT EXCEED THE QUANTITIES LISTED IN THE SUMMARY OF QUANTITIES

CURB AND GUTTER REMOVAL AND REPLACEMENT SCHEDULE

STATION BEGIN	STATION END	LOCATION	LENGTH
100+50	100+54	55' LT	4'
100+80	100+96	40' LT	16'
105+40	105+54	30' LT	14'
107+00	107+05	30' LT	4'
108+70	108+74	30' LT	4'
112+70	113+05	30' LT	35'
113+20	113+56	30' LT	36'
116+50	117+50	30' LT	100'
118+90	119+03	30' LT	13'
125+45	125+77	30' LT	32'
129+40	129+62	30' LT	22'
132+85	133+33	30' LT	48'
140+40	140+80	30' LT	40'
141+65	141+71	30' LT	6'
144+60	144+64	30' LT	4'
149+45	149+76	30' LT	21'
150+80	150+85	30' LT	5'
101+45	101+59	35' RT	14'
112+60	112+91	30' RT	31'
113+15	113+35	30' RT	20'
114+00	114+05	30' RT	5'
114+40	114+44	30' RT	4'
118+35	118+40	30' RT	5'
123+65	123+72	30' RT	7'
125+90	126+20	30' RT	30'
144+80	144+93	40' RT	13'
145+25	145+25	70' RT	17'
146+25	146+25	30' RT	44'
147+40	147+40	30' RT	13'

INLET REPAIR SCHEDULE

STATION	LOCATION	WORK TO BE DONE
101+70	LT	REPAIR
101+70	RT	ADJUST
104+80	LT	REPAIR
104+80	RT	REPAIR
107+95	LT	REPAIR
107+95	RT	REPAIR
111+10	LT	REPAIR
111+10	RT	REPAIR
115+50	RT	REPAIR
117+90	RT	REPAIR
120+70	RT	REPAIR
123+40	RT	REPAIR
126+20	RT	REPAIR
126+50	RT	REPAIR
127+45	LT	REPAIR
129+70	LT	REPAIR
131+50	LT	REPAIR
133+20	LT	REPAIR
135+00	LT	REPAIR
136+80	LT	REPAIR
140+80	LT	REPAIR
143+55	LT	REPAIR
143+55	RT	REPAIR
144+95	RT	REPAIR
145+20	RT	REPAIR
145+50	RT	REPAIR
147+70	LT	REPAIR
147+70	RT	REPAIR
149+80	LT	REPAIR
149+80	RT	REPAIR
153+10	LT	REPAIR
153+10	RT	REPAIR

REVISIONS

NO.	DATE	DESCRIPTION
1	11/21/05	PER FEDERAL AID DESIGN ENGINEER
2	12/22/05	PER FEDERAL AID DESIGN ENGINEER
3	4/13/2006	SUMMARY OF QUANTITIES REVISIONS

REFER TO EQUIPMENT MANUFACTURER'S SHOP DRAWING

PLAN SHEET DESIGNATION

COVER	G - GENERAL
	H - HAZARDOUS MATERIALS
	C - CIVIL
	L - LANDSCAPE
	S - STRUCTURAL
	A - ARCHITECTURAL
	I - INTERIORS
	Q - EQUIPMENT
	F - FIRE PROTECTION
	P - PLUMBING
	M - MECHANICAL
	E - ELECTRICAL
	T - TELECOMMUNICATIONS
	R - RESOURCE

PROJECT NO.:	M-8003 (552)
DWG FILE:	LIES ROAD
SCALE:	N/A
DRAWING DATE:	9/30/05
DESIGNED BY:	JB
DRAWN BY:	JE
CHECKED BY:	BC
PLOTTED BY:	MS

VILLAGE OF CAROL STREAM
 ILLINOIS

LIES ROAD (LAPP)
 PROJECT

SHEET TITLE

SUMMARY & SCHEDULE OF QUANTITIES, LEGEND, DETAILS AND GENERAL NOTES

FILE NO.	SECTION	COUNTY	TOTAL SHEETS	SHEET NO.
1375	04-00047-00-RS	DUPAGE	10	5
ILLINOIS PROJECT: M-8003 (662)				
CONTRACT NO.: 83832				

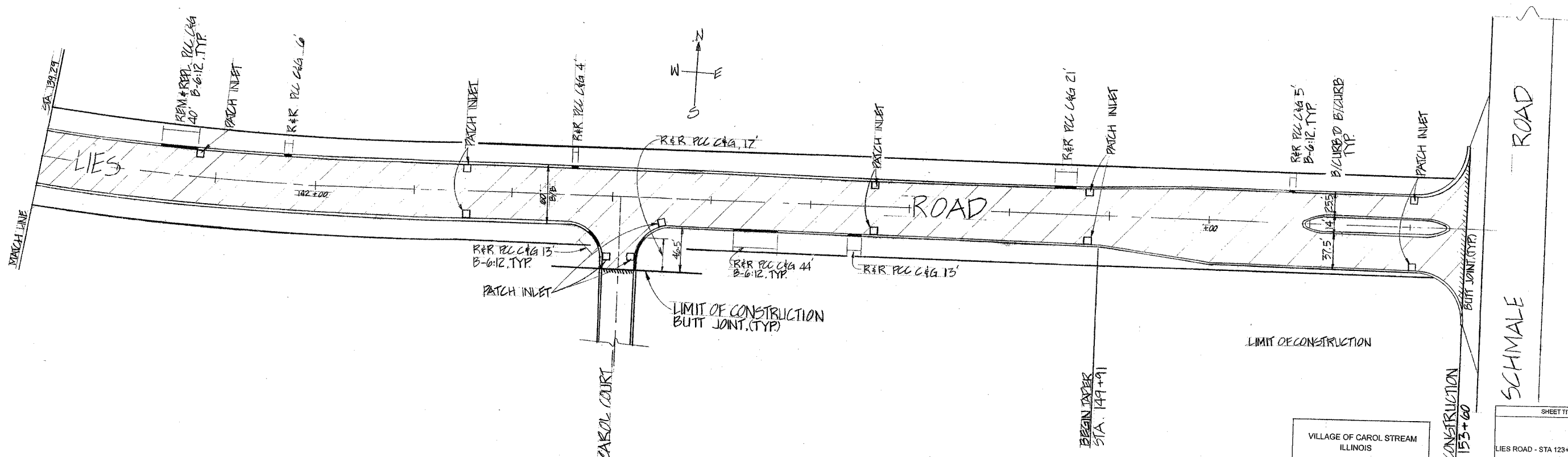
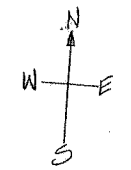
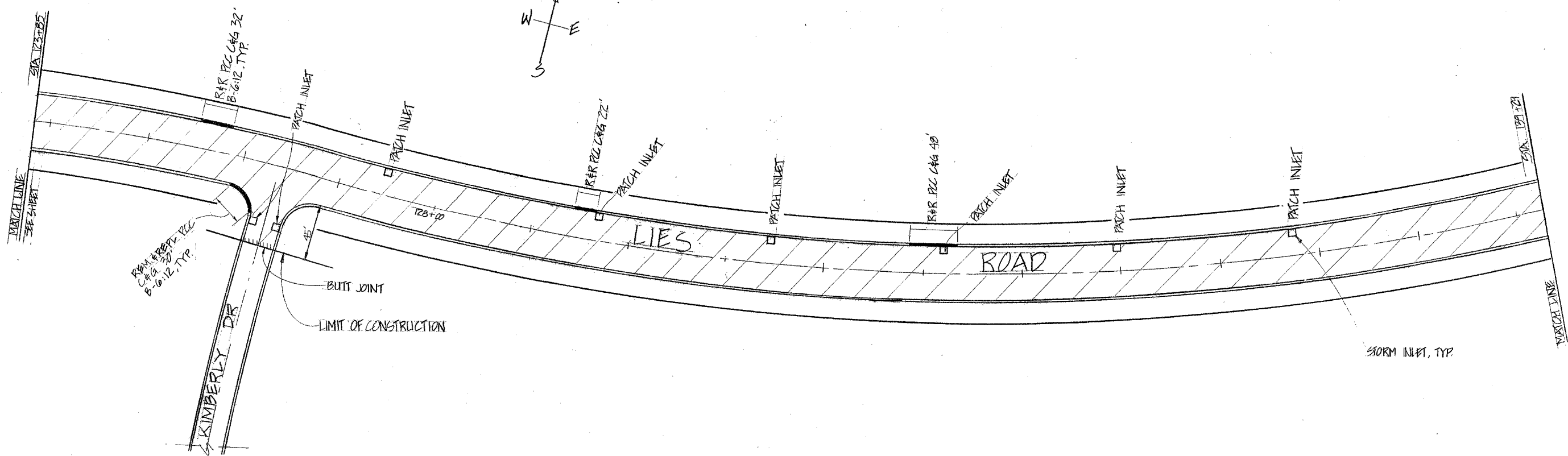
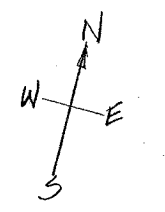

PROJECT NO.:	M-8003 (662)
DWG FILE:	LIES ROAD
SCALE:	1"=60'
DRAWING DATE:	9/30/05
DESIGNED BY:	MS
DRAWN BY:	MS
CHECKED BY:	MS
PLOTTED BY:	MS

VILLAGE OF CAROL STREAM
ILLINOIS

LIES ROAD (LAPP)
PROJECT

END CONSTRUCTION
STA. 153+60

SHEET TITLE
LIES ROAD - STA 123+85 TO STA 153+60
5 OF 10

PLAN ROUTE NO. 1375	SECTION 04-00047-00-RS	COUNTY DUPAGE	TOTAL SHEETS 10	SHEET NO. 6
ILLINOIS PROJECT: M-8003 (652)				
CONTRACT NO.: 83832				

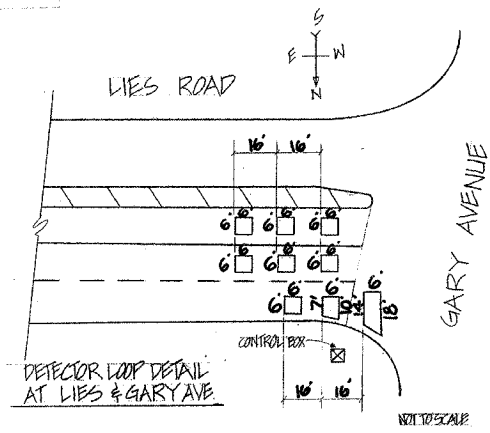
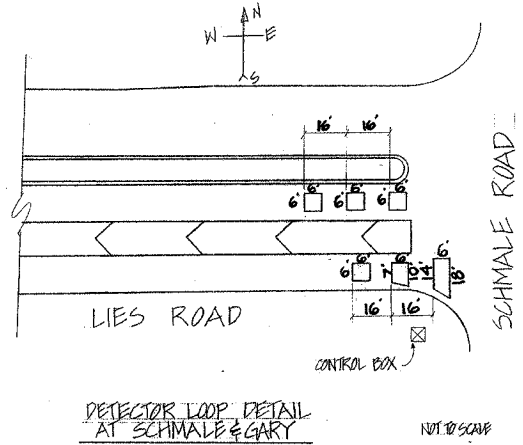
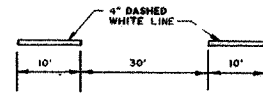
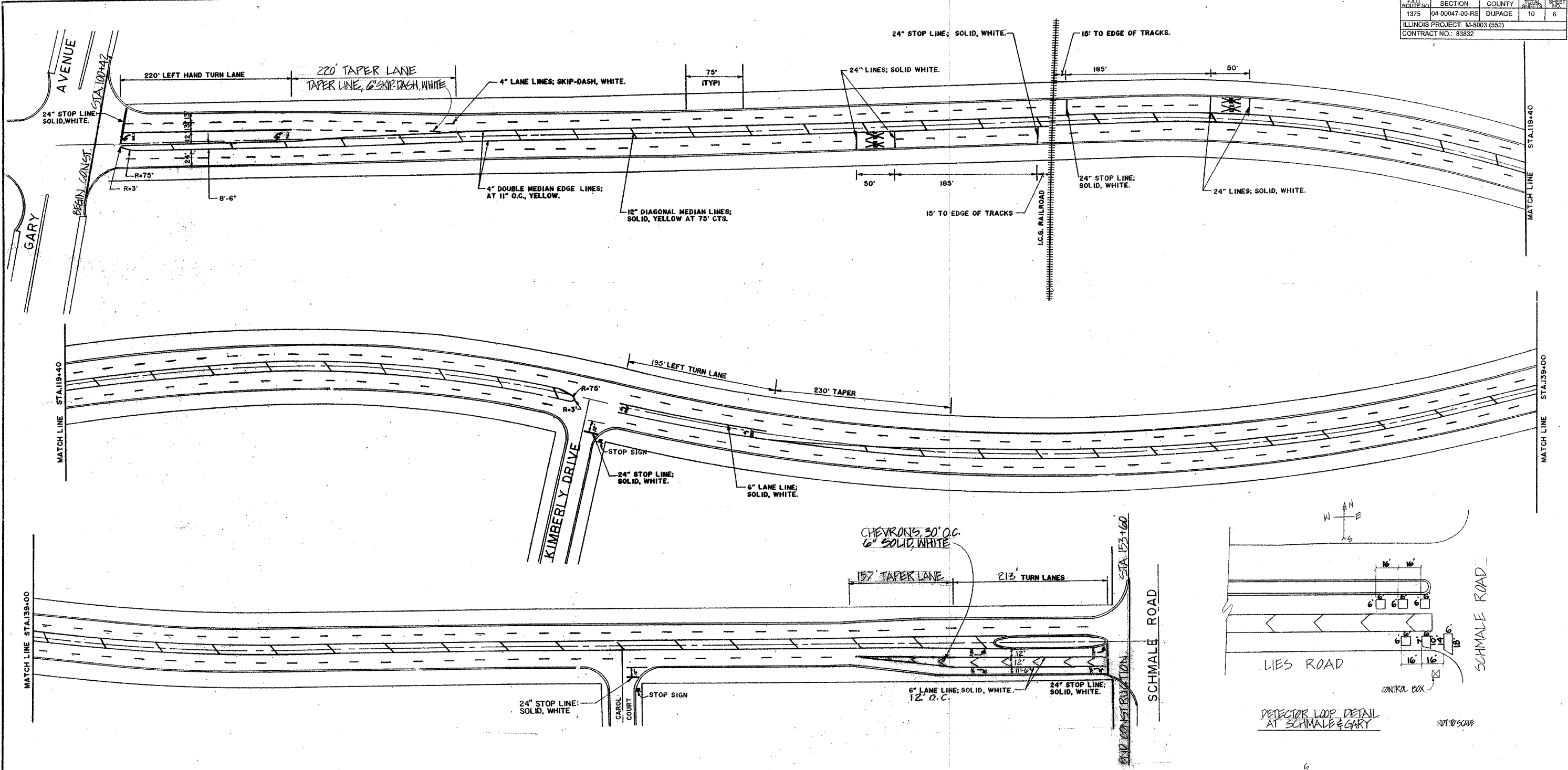

PROJECT NO.	M-8003 (652)
DWG FILE	LIES ROAD
SCALE	1"=50'
DRAWING DATE	8/30/06
DESIGNED BY	JR
DRAWN BY	JR
CHECKED BY	MR
PLOTTED BY	MR
VILLAGE OF CAROL STREAM ILLINOIS	
LIES ROAD (LAPP) PROJECT	
SHEET TITLE	
LIES ROAD - STRIPING PLAN	
6 OF 10	



ENGINEERING SERVICES
500 N. GARY AVENUE
60188
(630) 871-6220

REVISIONS
DESCRIPTION
DATE
NO.

* REFER TO EQUIPMENT MANUFACTURER'S SHOP DRAWING

PLAN SHEET DESIGNATION

- COVER
- G - GENERAL
- H - HAZARDOUS MATERIALS
- C - CIVIL
- L - LANDSCAPE
- S - STRUCTURAL
- A - ARCHITECTURAL
- I - INTERIORS
- Q - EQUIPMENT
- F - FIRE PROTECTION
- P - PLUMBING
- M - MECHANICAL
- E - ELECTRICAL
- T - TELECOMMUNICATIONS
- R - RESOURCE

PROJECT NO.: M-8003 (552)
DWG FILE: LIES ROAD
SCALE: N/A
DRAWING DATE: 9/30/05
DESIGNED BY: JB
DRAWN BY: JB
CHECKED BY: BC
PLOTTED BY: MS

VILLAGE OF CAROL STREAM
ILLINOIS

LIES ROAD (LAPP)
PROJECT

SHEET TITLE

IDOT DISTRICT 1
TYPICAL PAVEMENT
MARKINGS

7 OF 10

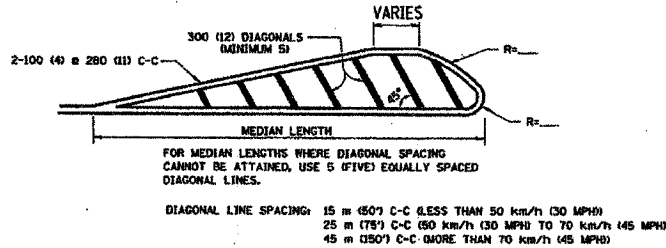
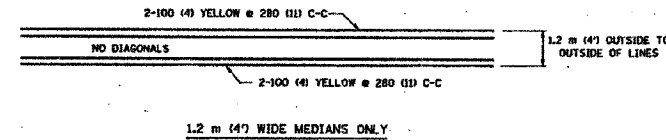
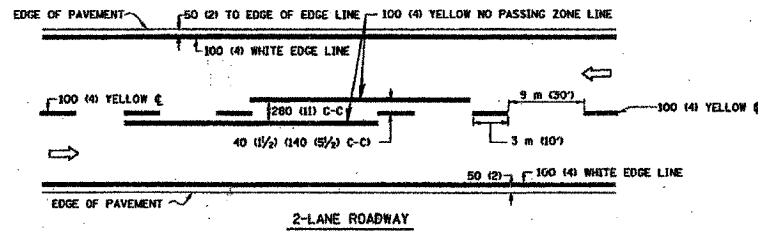

DIAGONAL LINE SPACING: 15 m (50') C-C (LESS THAN 50 km/h (30 MPH))
25 m (75') C-C (50 km/h (30 MPH) TO 70 km/h (45 MPH))
45 m (150') C-C (MORE THAN 70 km/h (45 MPH))

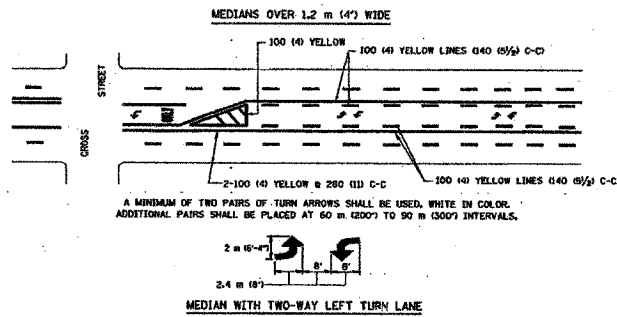
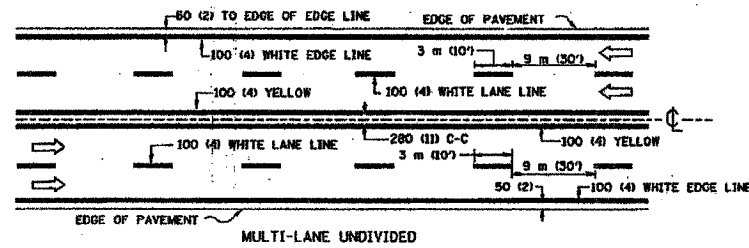

TYPICAL PAINTED MEDIAN MARKING

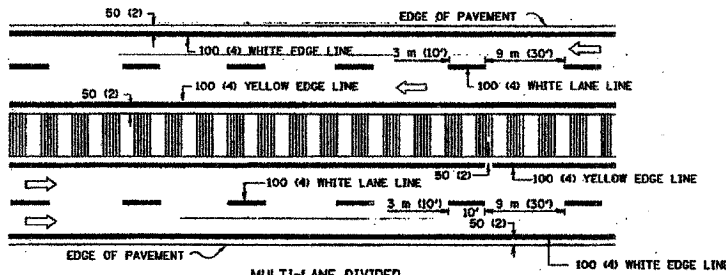

TYPICAL LANE AND EDGE LINE MARKING

TYPICAL LANE AND EDGE LINE MARKING

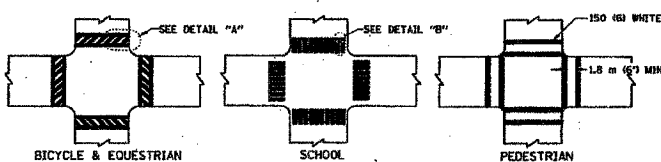

TYPICAL CROSSWALK MARKING

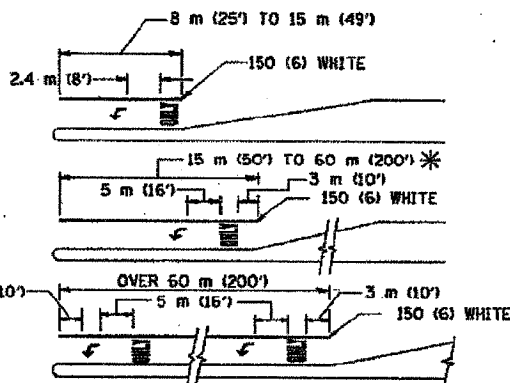

FULL SIZE LETTERS 2.4 m (8') AND ARROWS SHALL BE USED.
AREA = 1.5 m² (15.6 SQ. FT.) AREA = 1.9 m² (20.8 SQ. FT.)

* TURN LANES IN EXCESS OF 120 m (400') IN LENGTH MAY HAVE AN ADDITIONAL SET OF ARROW - "ONLY" INSTALLED MIDWAY BETWEEN THE OTHER TWO SETS OF ARROW - "ONLY".

TYPICAL LEFT (OR RIGHT) TURN LANE

TYPICAL TURN LANE MARKING

TYPE OF MARKING	WIDTH OF LINE	PATTERN	COLOR	SPACING / REMARKS
CENTERLINE ON 2 LANE PAVEMENT	100 (4)	SKIP-DASH	YELLOW	3 m (10') LINE WITH 9 m (30') SPACE
CENTERLINE ON MULTI-LANE UNDIVIDED PAVEMENT	2 @ 100 (4)	SOLID	YELLOW	280 (11) C-C
NO PASSING ZONE LINES FOR ONE DIRECTION FOR BOTH DIRECTIONS	100 (4) 2 @ 100 (4)	SOLID SOLID	YELLOW YELLOW	140 (55/2) C-C FROM SKIP-DASH CENTERLINE 280 (11) C-C OMIT SKIP-DASH CENTERLINE BETWEEN
LANE LINES	100 (4)	SKIP-DASH SKIP-DASH	WHITE WHITE	3 m (10') LINE WITH 9 m (30') SPACE
DOTTED LINES (EXTENSIONS OF CENTER, LANE OR TURN LANE MARKINGS)	SAME AS LINE BEING EXTENDED	SKIP-DASH	SAME AS LINE BEING EXTENDED	600 (21) LINE WITH 1.8 m (6') SPACE
EDGE LINES	100 (4)	SOLID	YELLOW-LEFT WHITE-RIGHT	OUTLINE MOUNTABLE MEDIANS IN YELLOW; EDGE LINES ARE NOT USED NEXT TO BARRIER CURB
TURN LANE MARKINGS	150 (6) LINE; FULL SIZE LETTERS & SYMBOLS (2.4 m (8'))	SOLID	WHITE	SEE TYPICAL TURN LANE MARKING DETAIL
TWO WAY LEFT TURN MARKING	2 @ 100 (4) EACH DIRECTION 2.4 m (8') LEFT ARROW	SKIP-DASH AND SOLID IN PAIRS	YELLOW WHITE	3 m (10') LINE WITH 9 m (30') SPACE FOR SKIP-DASH; 140 (55/2) C-C BETWEEN SOLID LINE AND SKIP-DASH LINE SEE TYPICAL TWO-WAY LEFT TURN MARKING DETAIL
CROSSWALK LINES (PEDESTRIAN & DIAGONALS (BIKE & EQUESTRIAN) & LONGITUDINAL BARS (SCHOOL))	2 @ 150 (6) 300 (12) @ 45° 300 (12) @ 90°	SOLID SOLID SOLID	WHITE WHITE WHITE	NOT LESS THAN 1.8 m (6') APART 600 (21) APART SEE TYPICAL CROSSWALK MARKING DETAILS.
STOP LINES	600 (24)	SOLID	WHITE	PLACE 1.2 m (4') IN ADVANCE OF AND PARALLEL TO CROSSWALK, IF PRESENT; OTHERWISE, PLACE AT DESIRED STOPPING POINT, PARALLEL TO CROSSROAD CENTERLINE, WHERE POSSIBLE
PAINTED MEDIANS	2 @ 100 (4) WITH 300 (12) DIAGONALS @ 45°	SOLID	YELLOW; TWO WAY TRAFFIC WHITE; ONE WAY TRAFFIC	280 (11) C-C FOR THE DOUBLE LINE SEE TYPICAL PAINTED MEDIAN MARKING.
GORE MARKING AND CHANNELIZING LINES	200 (8) WITH 300 (12) DIAGONALS @ 45°	SOLID	WHITE	DIAGONALS: 4.5 m (15') C-C (LESS THAN 50 km/h (30 MPH)) 5 m (16') C-C (50 km/h (30 MPH) TO 70 km/h (45 MPH)) 9 m (30') C-C (OVER 70 km/h (45 MPH))
RAILROAD CROSSING	600 (24) TRANSVERSE LINES; "RR" 15 1.8 m (6') LETTERS; 400 (16) LINE FOR "X"	SOLID	WHITE	SEE STATE STANDARD 7800D AREA OF: "R"=0.33m ² (3.6 SQ. FT.) EACH "X"=5.0 m ² (54.0 SQ. FT.)
SHOULDER DIAGONALS	300 (12) @ 45°	SOLID	WHITE - RIGHT YELLOW - LEFT	15 m (50') C-C (LESS THAN 50 km/h (30 MPH)) 25 m (75') C-C (50 km/h (30 MPH) TO 70 km/h (45 MPH)) 45 m (150') C-C (OVER 70 km/h (45 MPH))

FOR FURTHER DETAILS ON PAVEMENT MARKING REFER TO STANDARD SPECIFICATIONS FOR ROAD AND BRIDGE CONSTRUCTION AND STATE STANDARD 7800D.

REVISIONS	NAME	DATE
1	EVERS	03-19-00
2	T. RAMMACHER	10-27-04
3	ALEX HOUSEH	10-03-06
4	T. RAMMACHER	01-06-00

ILLINOIS DEPARTMENT OF TRANSPORTATION
DISTRICT ONE
TYPICAL PAVEMENT
MARKINGS
SCALE: NONE
DATE: 3/25/02
DRAWN BY: CADD
CHECKED BY:

All dimensions are in millimeters (inches) unless otherwise shown.

PLAN ROUTE NO.	SECTION	COUNTY	SHEETS	SHEET
1375	04-00047-00-RS	DUPAGE	10	10
ILLINOIS PROJECT: M-8003 (552)				
CONTRACT NO.: 83832				



Carol Stream
© 1996 Village of Carol Stream

ENGINEERING SERVICES
500 N. GARY AVENUE
60188
(630) 871 - 6220

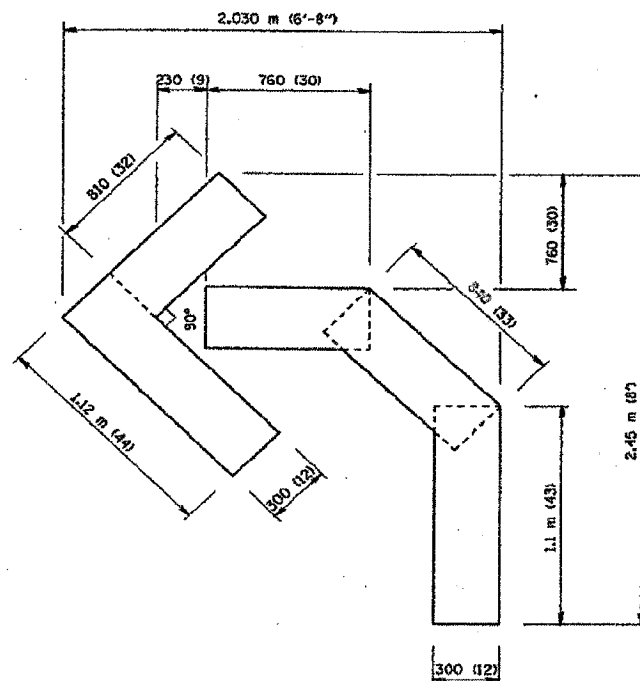
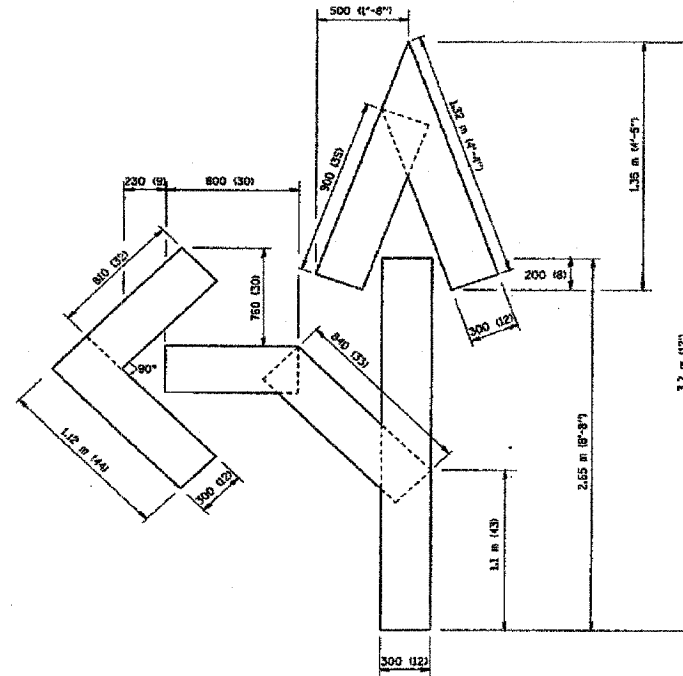
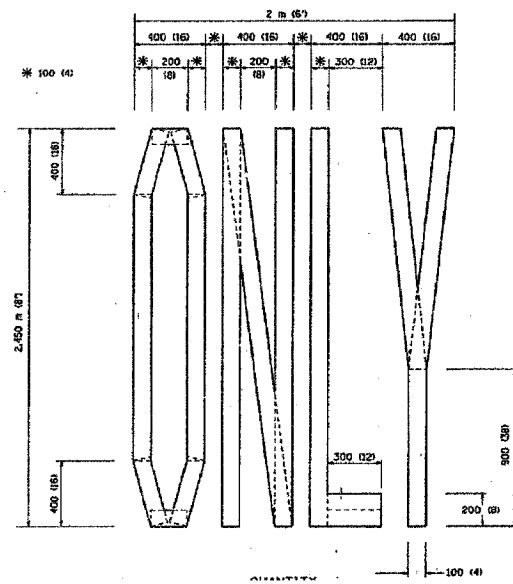

NO.	DATE	REVISIONS DESCRIPTION

* REFER TO EQUIPMENT MANUFACTURER'S SHOP DRAWING

PLAN SHEET DESIGNATION

COVER
G - GENERAL
H - HAZARDOUS MATERIALS
C - CIVIL
L - LANDSCAPE
S - STRUCTURAL
A - ARCHITECTURAL
I - INTERIORS
Q - EQUIPMENT
F - FIRE PROTECTION
P - PLUMBING
M - MECHANICAL
E - ELECTRICAL
T - TELECOMMUNICATIONS
R - RESOURCE

PROJECT NO.:	M-8003 (552)
DWG FILE:	LIES ROAD
SCALE:	N/A
DRAWING DATE:	9/30/05
DESIGNED BY:	JB
DRAWN BY:	JB
CHECKED BY:	BC
PLOTTED BY:	MS

VILLAGE OF CAROL STREAM
ILLINOIS

LIES ROAD (LAPP)
PROJECT

SHEET TITLE

IDOT PAVEMENT MARKING
LETTERS & SYMBOLS
FOR TRAFFIC STAGING

All dimensions are in millimeters (inches) unless otherwise shown.

ILLINOIS DEPARTMENT OF TRANSPORTATION

PAVEMENT MARKING
LETTERS AND SYMBOLS
FOR TRAFFIC STAGING

REVISIONS	
NAME	DATE
T. RAMMACHER	09/18/94
J. OBERLE	06/01/96
T. RAMMACHER	06/05/96
T. RAMMACHER	11/04/97
T. RAMMACHER	03/02/98
E. GOMEZ	08/28/00

SCALE: NONE
DATE: 11/20/01

DRAWN BY CADD
CHECKED BY